



411 - 445 Standale Plaza NW
Walker, Michigan 49534

Property Overview

- Great Visibility
- 27,950 Vehicles per day on Lake Michigan Drive at Standale Plaza
- 1,600 SF End Cap Available and (2) 2,000 SF Spaces Available.
- Standale Plaza near Grand Valley State University with over 23,000 students.
- Ample parking surface lot



For More Information

Todd Leinberger, MBA

O: 616 242 1114

toddl@naiwwm.com

Lease Overview

Standale Plaza NW
Walker, Michigan 49534

Lease Information

Lease Type: Modified Gross

Terms: 60 Months

Availability

SUITE	RENTABLE SF	RATE / SF / YR	MONTHLY RENT
Suite 411	1,600 SF	\$17.00	\$2,266.67
Suite 445	2,000 SF	\$11.00	\$1,833.33
Suite 443	2,000 SF	\$11.00	\$1,833.33

STANDALE PLAZA / SOUTH BUILDING



STANDALE PLAZA / NORTH BUILDING

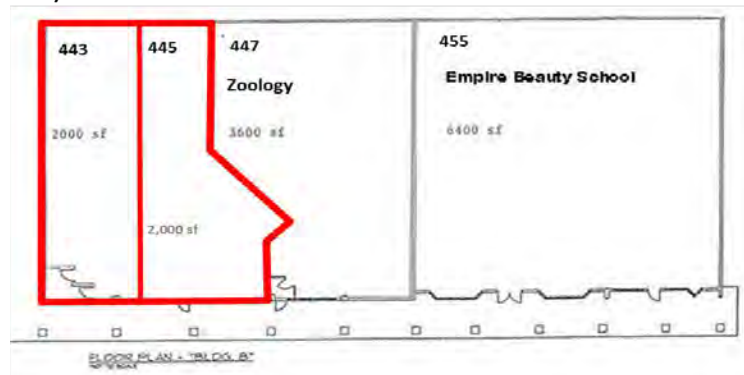

Additional Photos

Standale Plaza NW
Walker, Michigan 49534

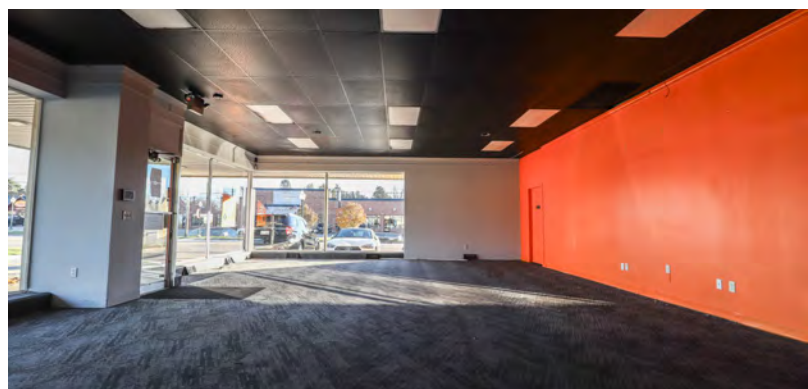

Additional Photos

Standale Plaza NW
Walker, Michigan 49534



Location Map

Standale Plaza NW
Walker, Michigan 49534

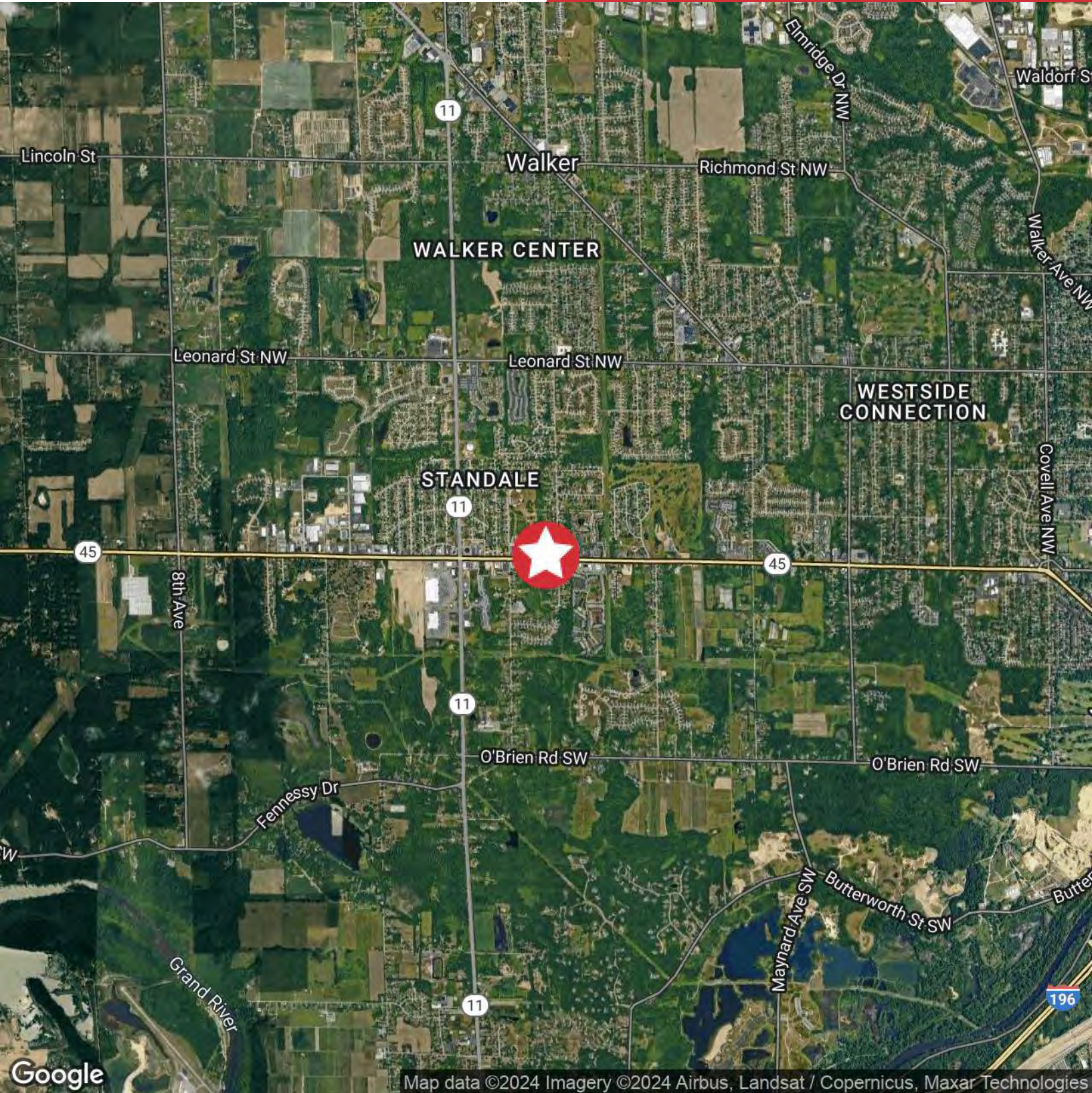

Google

Map data ©2024 Imagery ©2024 Airbus, Landsat / Copernicus, Maxar Technologies

Retailer Map

Standale Plaza NW
Walker, Michigan 49534

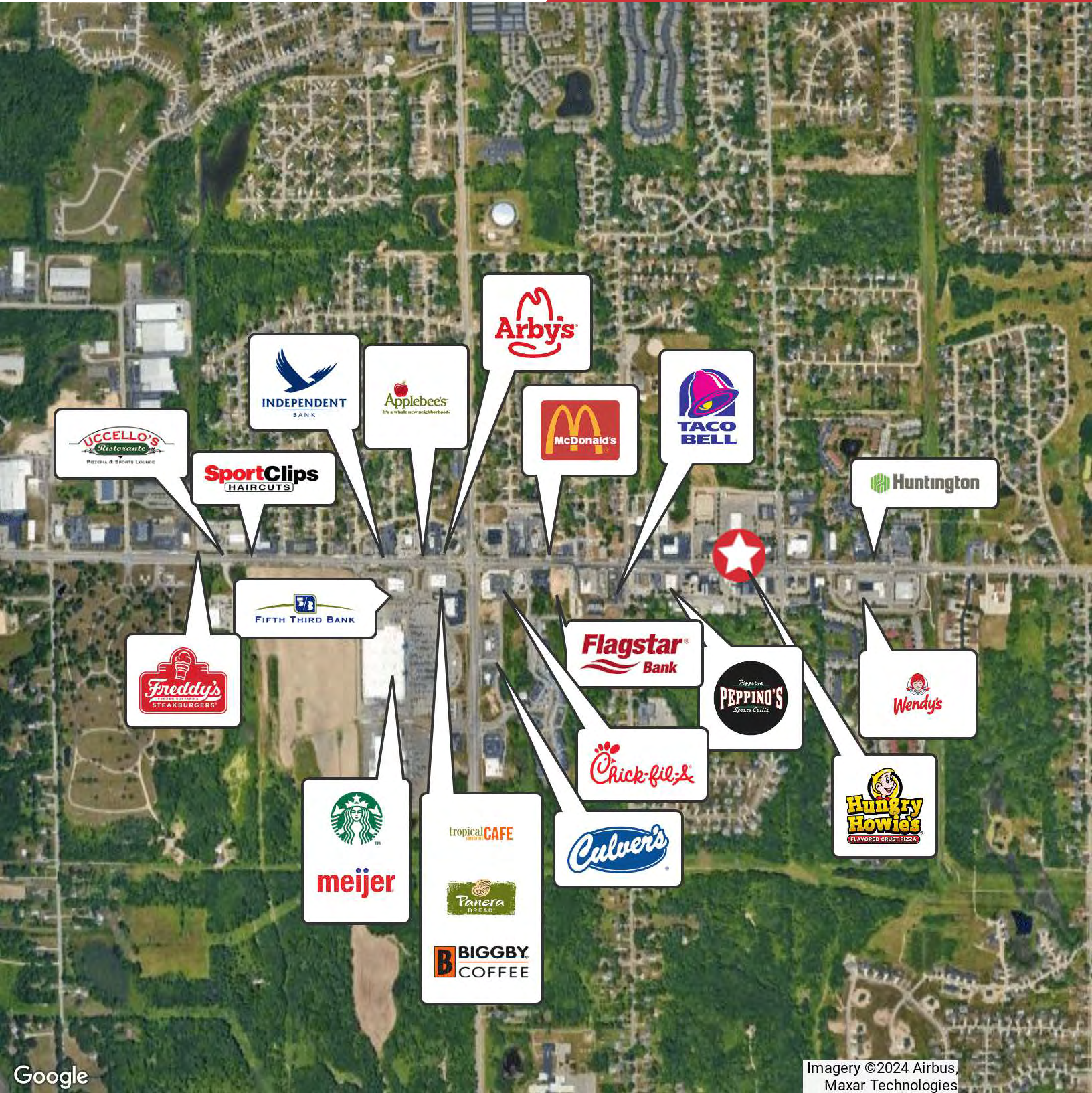

Google

Imagery ©2024 Airbus,
Maxar Technologies

Demographics Map & Report

Standale Plaza NW
Walker, Michigan 49534

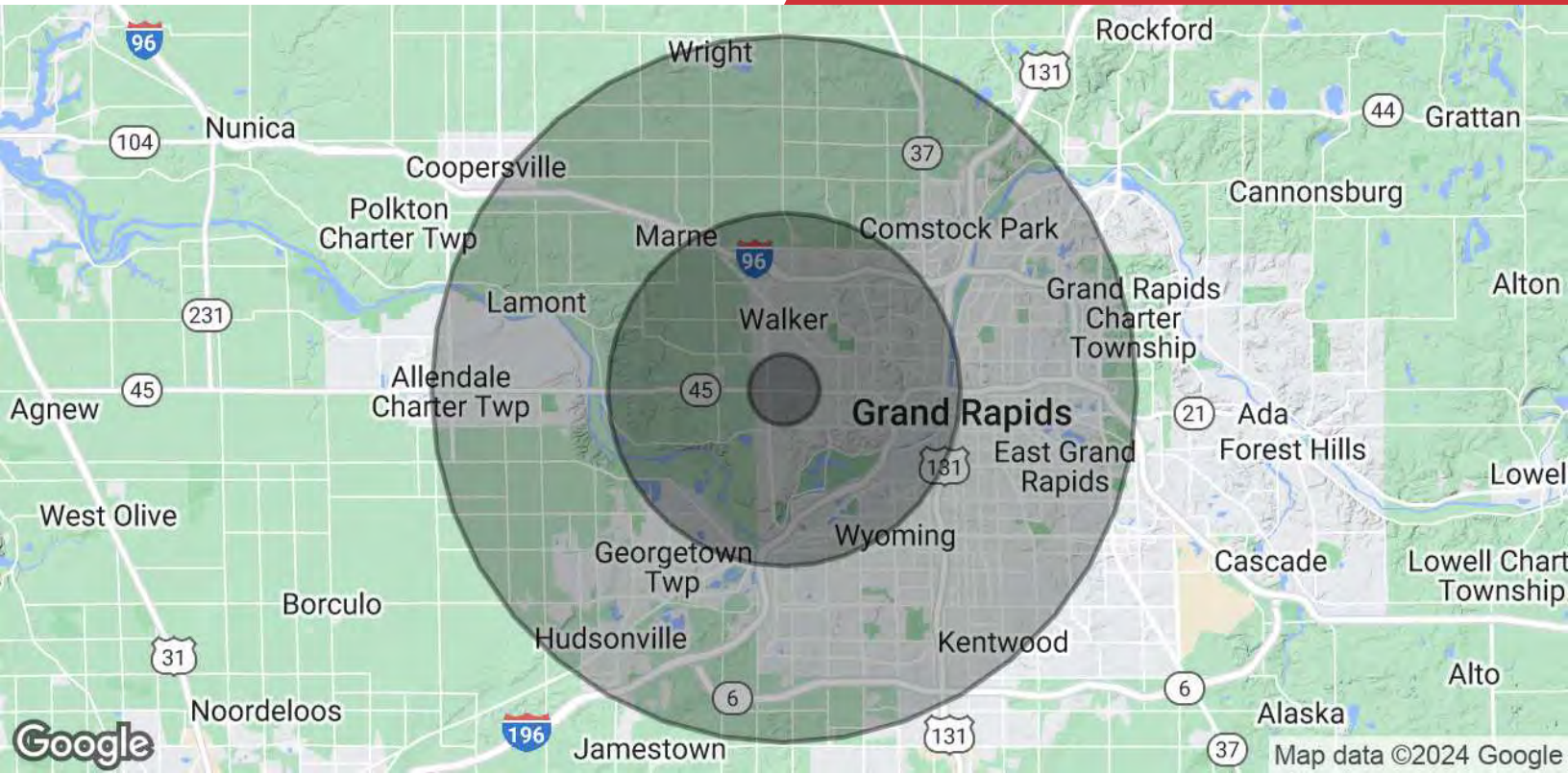

POPULATION	1 MILE	5 MILES	10 MILES
Total Population	7,077	117,847	524,169
Average Age	39	38	38
Average Age (Male)	38	37	37
Average Age (Female)	39	39	38
HOUSEHOLDS & INCOME	1 MILE	5 MILES	10 MILES
Total Households	3,205	47,107	202,647
# of Persons per HH	2.2	2.5	2.6
Average HH Income	\$83,987	\$87,127	\$93,966
Average House Value	\$298,510	\$276,772	\$302,801

* Demographic data derived from 2020 ACS - US Census

West Michigan Overview

West Michigan Advantage

West Michigan is a growing region of more than 1.5 million people and is located between Detroit and Chicago. More than 130 international companies are located in West Michigan as well as four of Forbes Largest Private Companies. The businesses and community leaders have set in motion an unprecedented level of growth and investment throughout the region that has made West Michigan a destination for business success. West Michigan has a vibrant, big-city feel in Grand Rapids while retaining smaller-city charm in its neighborhoods, boutique shopping areas, and tree-lined streets - all combined in a virtual playground of arts, culture and natural beauty.

Quality Of Life

West Michigan has a vibrant, big-city feel in Grand Rapids while retaining smaller-city charm in its neighborhoods.

Grand Rapids Ranking

- #1 Fastest Growing US Economy
-HeadlightData
- #19 Best Cities in the US
- USNews
- #3 Big Cities with the Healthiest Markets
-SmartAsset
- #4 Housing Markets to Watch 2017
- Trulia
- #5 Best Large Cities to Start a Business
- WalletHub

Entertainment

More than 1.5 million people take advantage of sporting events and live performances every year. West Michigan offers a variety of landscapes which allows for a greater sense of adventure. Lake Michigan has 18 world-class beaches and 288 miles of bike trails.

Skilled Workforce

Out of the 1.5 million residents that live in West Michigan, half are under the age of 35. This is a great opportunity for both employers and college graduates. With the high supply of skilled workers and high demand for jobs, it is easy to understand why the region is a destination for business success.

Arts & Culture

West Michigan is known for their arts and culture. Aside from many museums, the city hosts ArtPrize—a unique, open art competition that gives away the world's largest art prize. Other attractions include Frederik Meijer Gardens, Grand Rapids Ballet, Civic Theatre, and Symphony.