

BARKLEY

VILLAGE

Retail Leasing

OVERVIEW



TALBOT
GROUP

A Growing Urban Village.

Barkley Village is conveniently located just 15 minutes from every corner of Bellingham.

250

Acre
Property

193,000

SF Retail with Daily Essentials
and Regional Anchors

328

Residential Units, Entitled
for 3,000 Additional Units

235,000

In the MSA with 97,000
Bellingham Residents

100

Businesses in
Walking Distance

300,000

SF Class A Office Owned

—
Additional office onsite: Janicki,
Bellingham School District,
medical & financial services





At the Center of a Dynamic Region.

Bellingham is a top 5 multi-sport destination in the state of Washington and widely known for world class mountain biking, water sports, hiking and skiing.

+3.42M

Visitors to Whatcom County Annually

90 miles north of Seattle on the I-5 corridor, 50 miles to Vancouver and 50 miles to Mount Baker



DAILY TRAFFIC COUNTS

I-5 @ Sunset ~ 61,000

Sunset @ Woburn ~ 42,000

Woburn @Barkley ~ 30,000

BARKLEY VILLAGE

Newmarket Street Retail



NEWMARKET STREET

44,347 SF OF RETAIL + HAGGEN GROCERY

BARKLEY
VILLAGE

*
**HAGGEN
GROCERY**

PARKING

▲ 387 surface parking ▲

▲
**WOBURN
STREET**

2915

2925

2945

2955

NEWMARKET

**EVENT
PLAZA**

2930

OVER
FLOW

2940

2950

BARKLEY BOULEVARD

PARKING

117 surface + 34 Newmarket street

Rail Trail



Barkley Village Retail Refined



First Phase of Renovation Underway

- Updated building façade
- Enhanced patio dining
- Upgraded common areas
- Activated open space and link to regional trail system

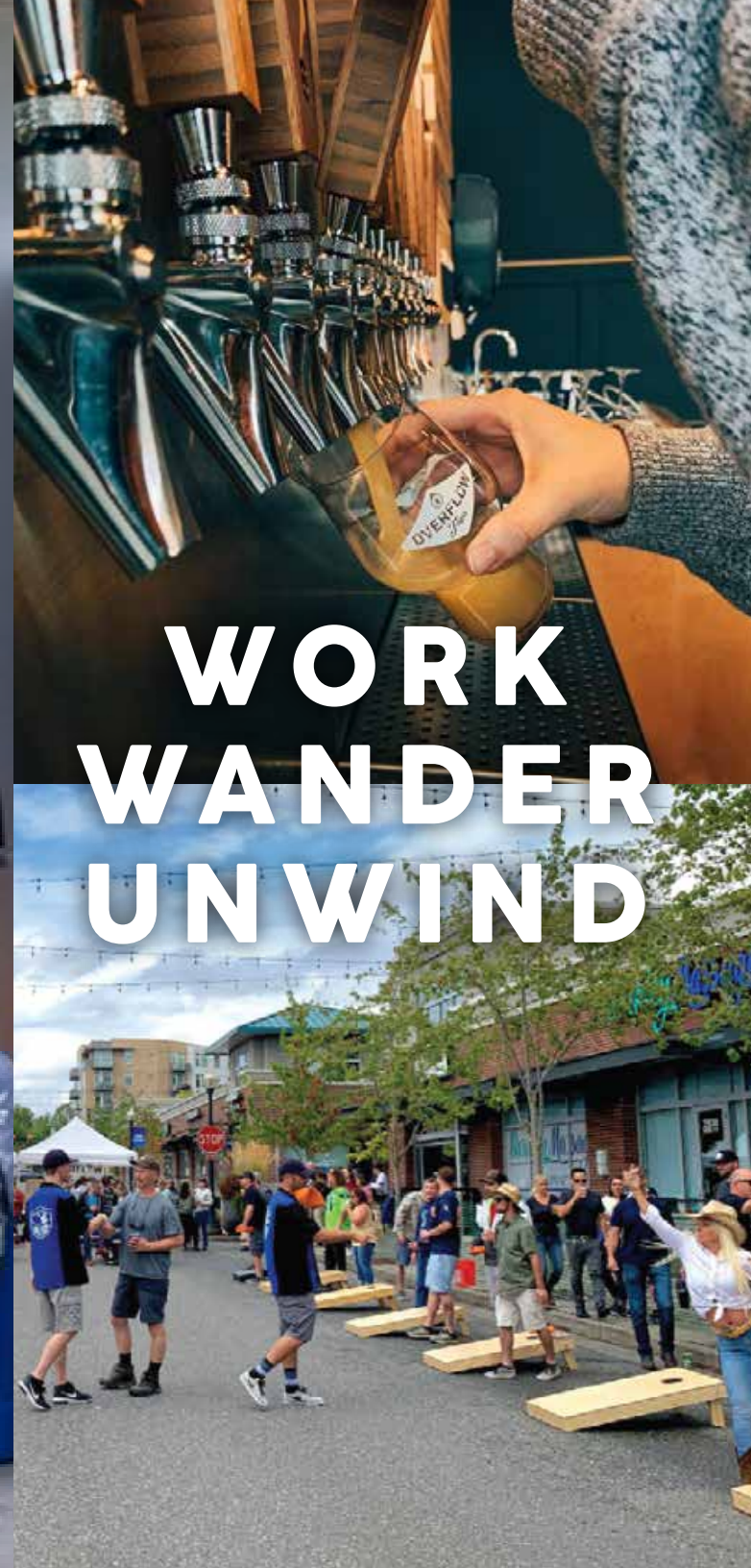

**WORK
WANDER
UNWIND**

2930 NEWMARKET STREET

Suite 111

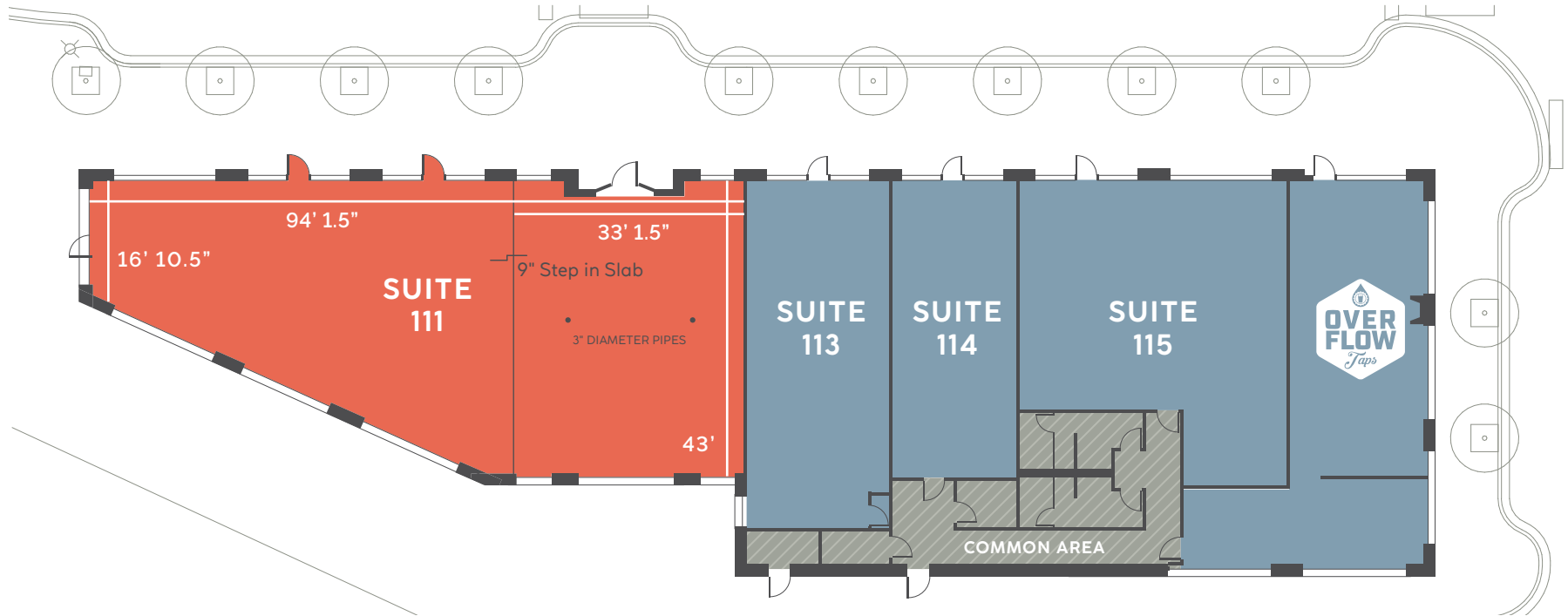

Location Key

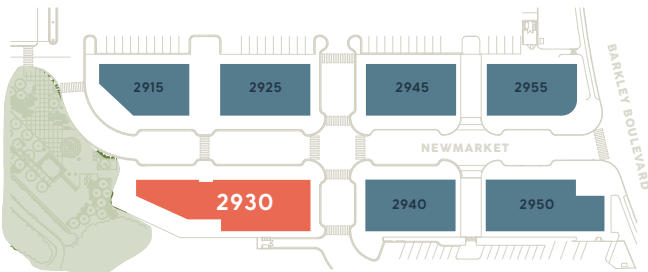

QUICK OVERVIEW

Restaurant opportunity with
expansive patio opportunity
Rentable SF: 3,635 SF

2930 Newmarket St
Suite 111
Bellingham, WA 98225

2930 NEWMARKET STREET

Suite 113

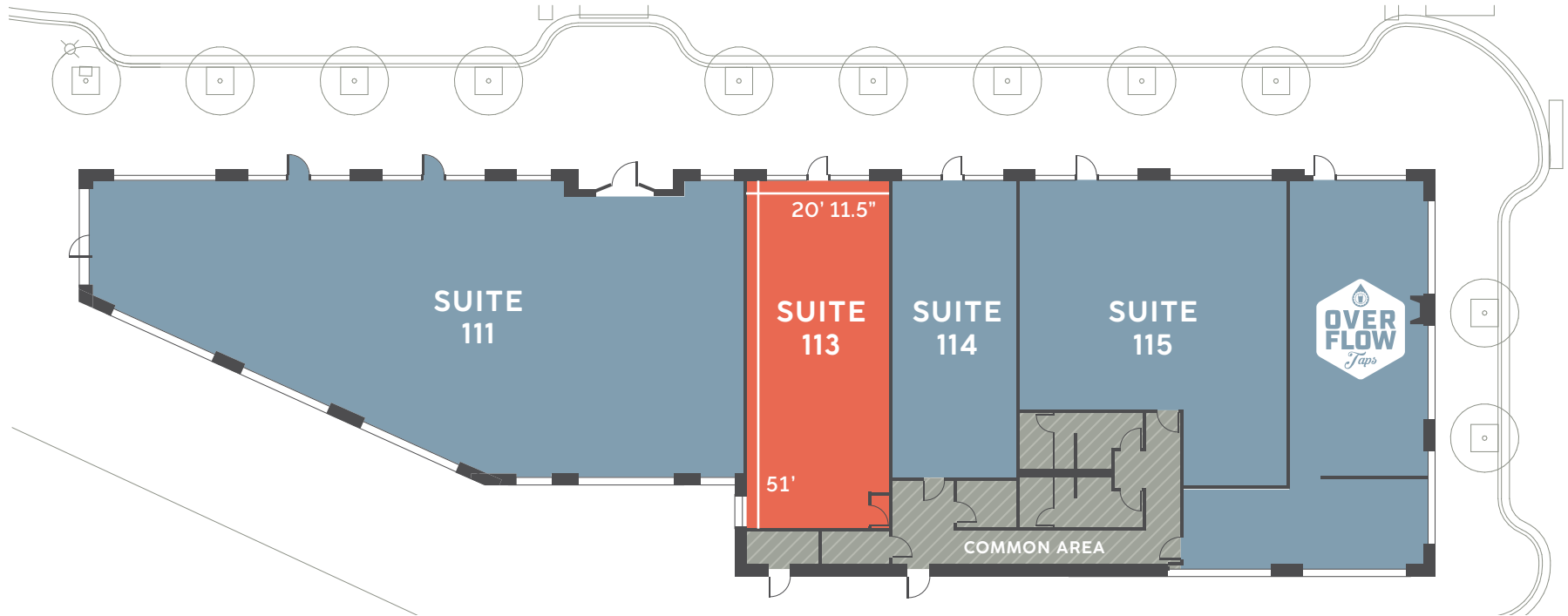

Location Key

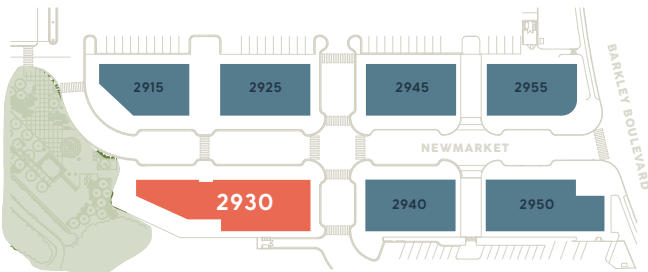

QUICK OVERVIEW

Restaurant opportunity with
shared bathroom

Rentable SF: 1,297 SF

2930 Newmarket St
Suite 113
Bellingham, WA 98225

2930 NEWMARKET STREET

Suite 114

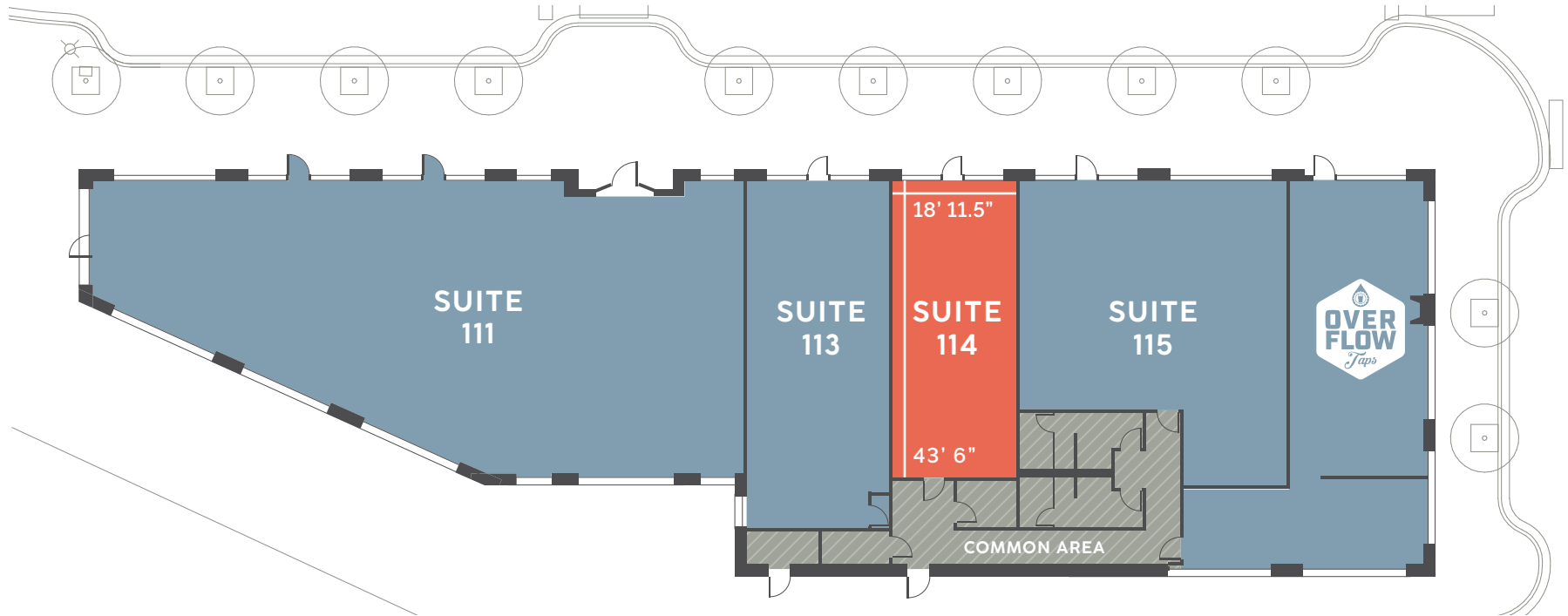

Location Key

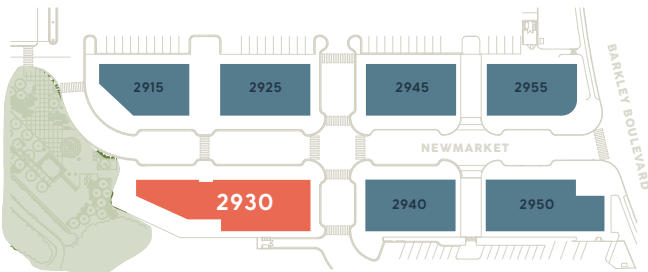

QUICK OVERVIEW

Retail opportunity with shared bathroom; Delivered in vanilla shell condition

Rentable SF: 1,018 SF

2930 Newmarket St
Suite 114
Bellingham, WA 98225

2930 NEWMARKET STREET

Suite 115

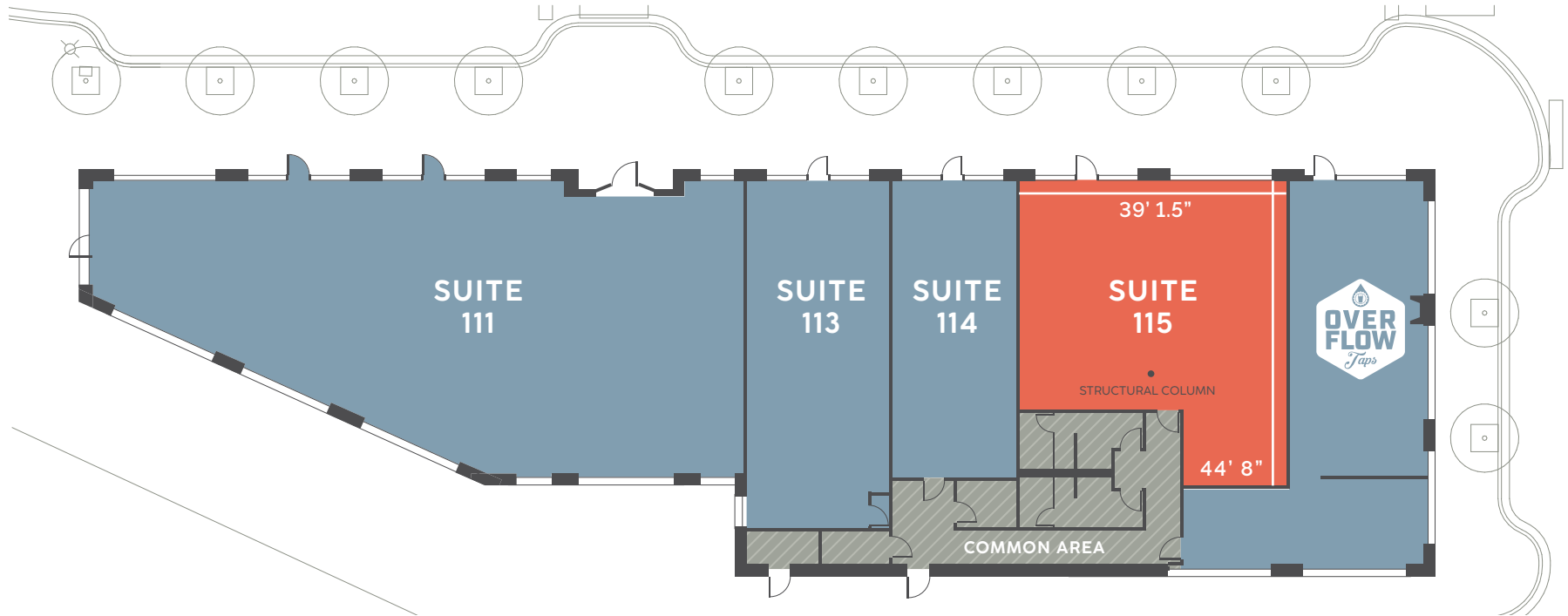

Location Key

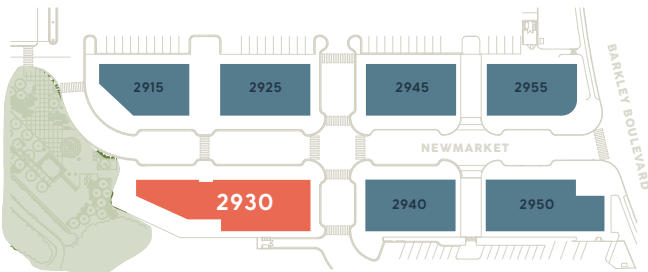

QUICK OVERVIEW

Retail opportunity with shared bathroom; Delivered in vanilla shell condition and new storefront/entry

Rentable SF: 1,811 SF

2930 Newmarket St
Suite 115
Bellingham, WA 98225

2955 NEWMARKET STREET

Suite 107

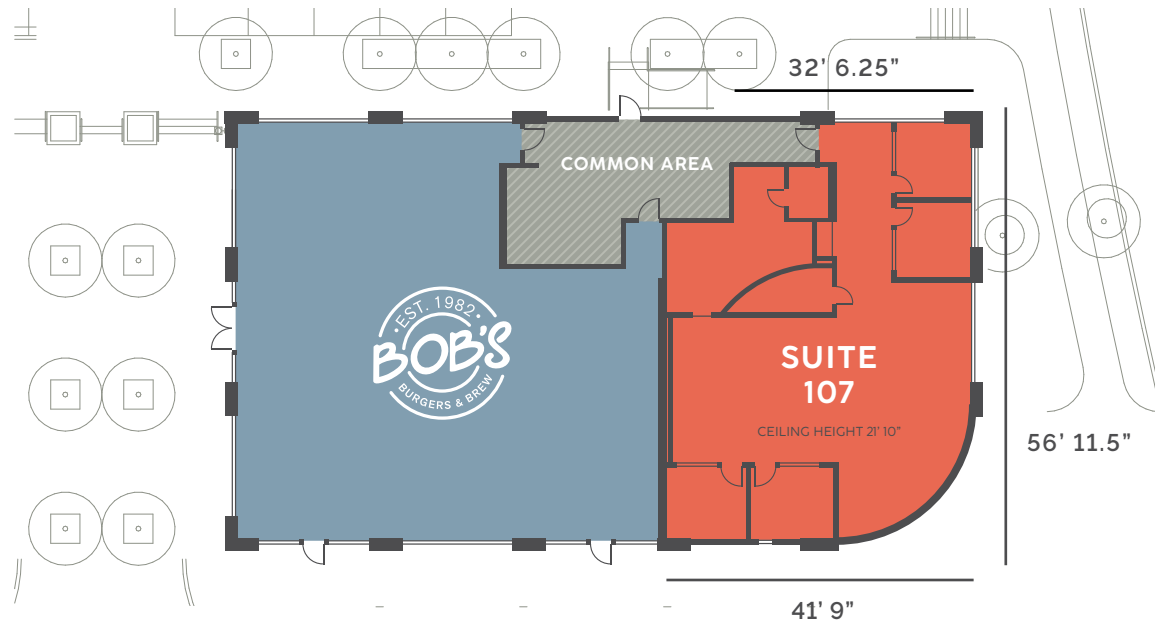

Location Key

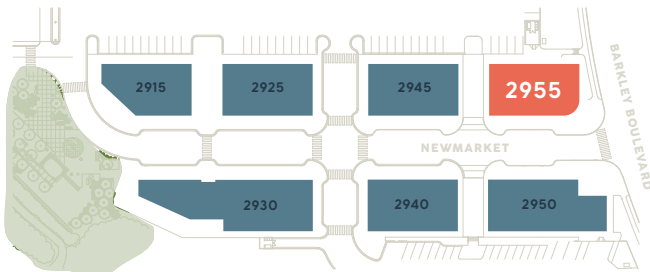

QUICK OVERVIEW

Retail opportunity; Delivered with existing improvements

Rentable SF: 2,476 SF

2955 Newmarket St
Suite 107
Bellingham, WA 98225



BarkleyVillage.com

For More Information
GAGE COMMERCIAL
REAL ESTATE, LLC

Tracy Carpenter

Broker/Owner
360.303.2608
tracy@gagecre.com

Greg Martineau, CCIM

Broker/Owner
360.820.4645
greg@gagecre.com



©2025 The Talbot Group. All rights reserved. This information has been obtained from sources believed reliable but has not been verified for accuracy or completeness. You should conduct a careful, independent investigation of the property and verify all information. Any reliance on this information is solely at your own risk. The Talbot Group name and logo are service marks of The Talbot Group. All other marks displayed on this document are the property of their respective owners, and the use of such logos does not imply any affiliation with or endorsement of The Talbot Group. Photos herein are the property of their respective owners. Use of these images without the express written consent of the owner is prohibited.