



5400 E Memorial Rd #150 Edmond, OK 73013

Property Highlights:

- Available: 5,458 SF
- Building A, Floor 1
- Class A Corporate Office
- Turn Key Condition
- 11 Exec Offices, 8 cubicles, Training Room, Conference, Break Room, Shower

Terms:

- Rate: \$26.00/SF
- Type: Full Service
- Term Remaining: 2 Years

Proximity:

- I-35 Access: 2 min
- Downtown Edmond: 10 min
- Downtown OKC: 15 min
- Will Rogers Airport: 20 min



FLOOR PLAN

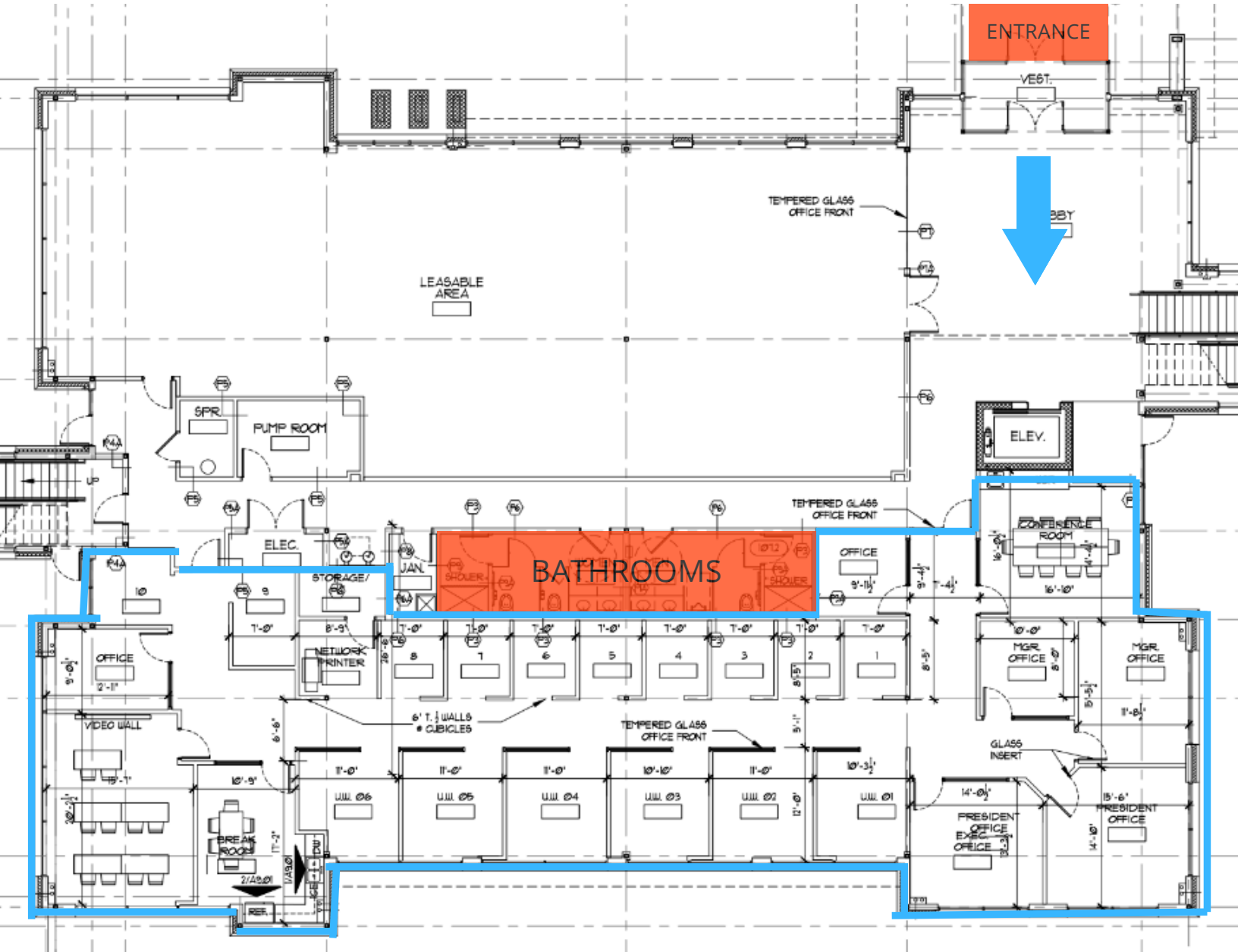

INTERIOR PHOTOS



MARKET AERIAL

