

JOEL MENDOZA  
JMENDOZA@CBI-COMMERCIAL.COM  
310.943.8532  
CA DRE# 02091159



6816 HOLLYWOOD BLVD,  
HOLLYWOOD, CA 90028



HOLLYWOOD × HIGHLAND

AVAILABLE FOR LEASE  
ON THE HOLLYWOOD WALK OF FAME



# OPPORTUNITY OVERVIEW

 Rent: \$13,000 / Month MG

PROPERTY ADDRESS	6816 Hollywood Blvd.
CITY, STATE, ZIP	Los Angeles, CA 90028
SIZE	Approx. 1,600SF + 400sf basement + 500sf bonus mezzanine
LEASE TYPE	Modified Gross
AVAILABLE	September 1st

This prime, west of Highland, retail unit sits along the Hollywood Walk Of Fame at one of the busiest pedestrian intersections in the United States.

Perfectly located in the epicenter of the Hollywood Tourist District, this versatile space offers endless possibilities and unparalleled exposure to over 10 million visitors a year.





# PROPERTY DESCRIPTION

Offering unbeatable exposure, unparalleled foot traffic, and unrivaled exposure, this is a unique opportunity for trend-setting retailers, experiential /immersive retail concepts, and emerging brands to launch their flagship store in the heart of the Hollywood tourist district.

With the FIFA World Cup, Super Bowl, and 2028 Olympics coming to LA over the next few years, Hollywood is expected to see a massive boom in tourism.

Surrounded by global brands, unsurpassed foot traffic, and over 10 million visitors a year, now is the chance to establish your concept in one of the most iconic and well-known retail corridors in the world.





# PROPERTY HIGHLIGHTS

- Located at the intersection of Hollywood & Highland on the **HOLLYWOOD WALK OF FAME**
- High Visibility/Exposure
- 16 Feet of Frontage on the Walk of Fame
- Two new high-profile tenants recently signed
- High Ceilings & Bonus 500sf mezzanine
- Parking Available at additional cost





## 6 //EQUIPMENTS// COMMERCIAL BROKERS INTERNATIONAL

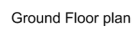

Address: 6816 Hollywood Blvd, Los Angeles, CA

Date: 8-25-2020



Address: 6816 Hollywood Blvd, Los Angeles, CA



# ON THE BLOCK





4 //ON THE BLOCK// COMMERCIAL BROKERS INTERNATIONAL

4 //ON THE BLOCK// COMMERCIAL BROKERS INTERNATIONAL



# NEARBY TENANTS/RETAILERS







LISTED BY:

JOEL MENDOZA

CA DRE #02091159

JMENDOZA@CBI-COMMERCIAL.COM

310.943.8532



COMMERCIAL  
BROKERS  
INTERNATIONAL

11766 WILSHIRE BOULEVARD, SUITE 1120, LOS ANGELES,  
CA, 90025, UNITED STATES  
CA DRE #01523713  
(310) 943-8530  
INFO@CBICOMMERCIAL.COM