

### SITE DATA

#### TOTAL BLDG AREA

TOTAL RETAIL BLDG AREA 174,280± S.F.  
 TOTAL USEABLE MEZZ. AREA 1,366± S.F.

#### PARKING SPACES

TOTAL RETAIL BLDG PKG PROV. 704 SPACES  
 TOTAL OUTLOT PKG PROV. 105 SPACES  
 TOTAL PARKING PROVIDED 809 SPACES

**NOTE:**  
 THIS SITE PLAN IS SCHEMATIC AND IS PROVIDED TO SHOW APPROXIMATE ACREAGE AND LOCATIONS OR SIZES OF A BUILDING (OR BUILDINGS) THAT WILL FIT ON THIS SITE. CHANGES MAY BE REQUIRED ONCE A FINAL SURVEY WITH CURRENT BOUNDARIES, EASEMENTS, RIGHT-OF-WAYS AND DIMENSIONS OR AFTER FINAL REVIEW IS COMPLETED.

THE INFORMATION CONTAINED HEREIN IS BELIEVED TO BE CORRECT AND IS OBTAINED FROM RESOURCES WE REGARD AS RELIABLE. WE ASSUME NO LIABILITY FOR ERRORS OR OMISSIONS HEREIN. ALL DIMENSIONS ARE APPROXIMATE.

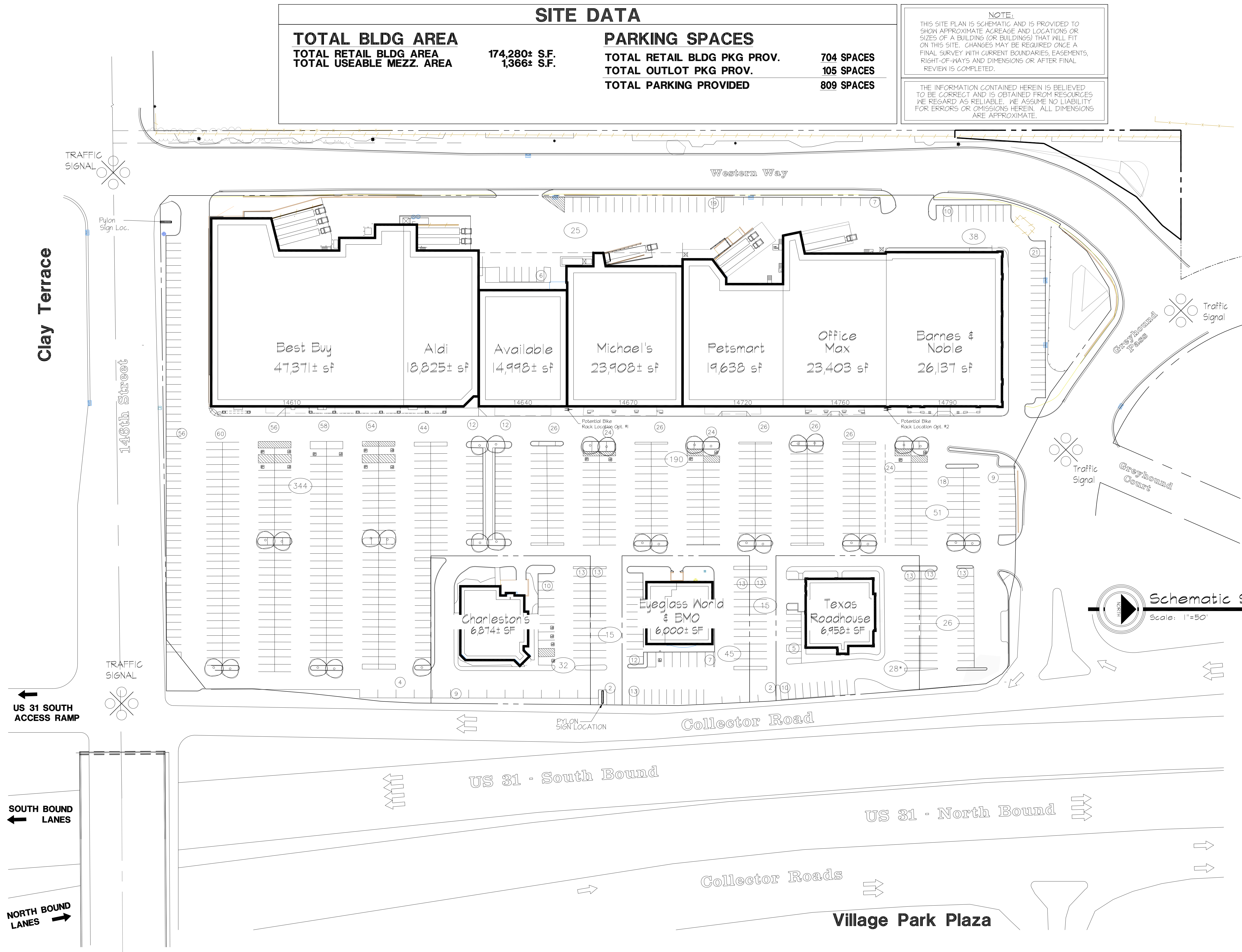

**LEECH-HENSLEY ARCHITECTS INC.**  
 7905 E. 102nd St., Fishers, IN 46038  
 MO 317 842 1931 Fax 317 842 7994

**DATE**  
 February 8, 2024

**Preliminary**

FILE - DATE - TIME  
 4805\_Plan01g 6-24-04 4:58:12 pm EST  
 PLOT SCALE DRAWN BY:  
 NTS APPICAS

**Schematic Site Plan**  
 Scale: 1"=50'

**Greyhound Plaza**  
 at Greyhound Pass  
 WESTFIELD, INDIANA  
 developed by:  
 The Broadbent Company

**SCHEME #**  
 92

**PROJECT NO.**  
 9805

Clay Terrace

US 31 SOUTH ACCESS RAMP

SOUTH BOUND LANES

NORTH BOUND LANES

Village Park Plaza