

For Lease



355 E. Douglas Road
Oldsmar, FL 34677



Kyle Kidd

Vice President
+1 813 225 2027
kyle.kidd@colliers.com

Tom Quinlan

Vice President
+1 813 605 4462
tom.quinlan@colliers.com

Dominic Hewitt

Senior Associate
+1 813 871 8503
dominic.hewitt@colliers.com

4830 West Kennedy Blvd.
Suite 300
Tampa, FL 33609
P: +1 813 221 2290



Property Overview

- Easy access to major arterials like SR-580, SR-586, US-19 and The Suncoast Expressway.
- Move-In Ready Space
- Heavy 3 Phase Power
- Outdoor Storage
- Availability – Immediately
- Inquire for Lease Rate

Building Size:	21,000 SF
Lot Size:	1.56 Acres
Year Built:	1984
Office SF:	3,428 SF
Warehouse SF:	17,572 SF
Loading:	10 Grade Level Doors, Several Oversized (14'x14')
Clear Height:	11'-17'
Power:	3 phase, 1,000 Amps
Outside Storage:	Fenced & Lit
Zoning:	M1



Floor Plan

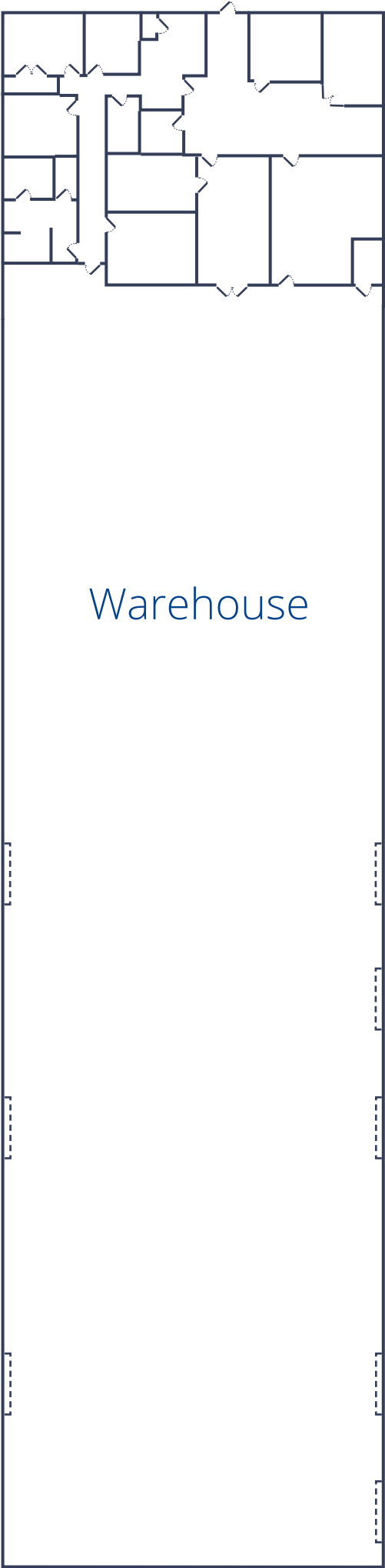

Warehouse





Interior



Location Overview

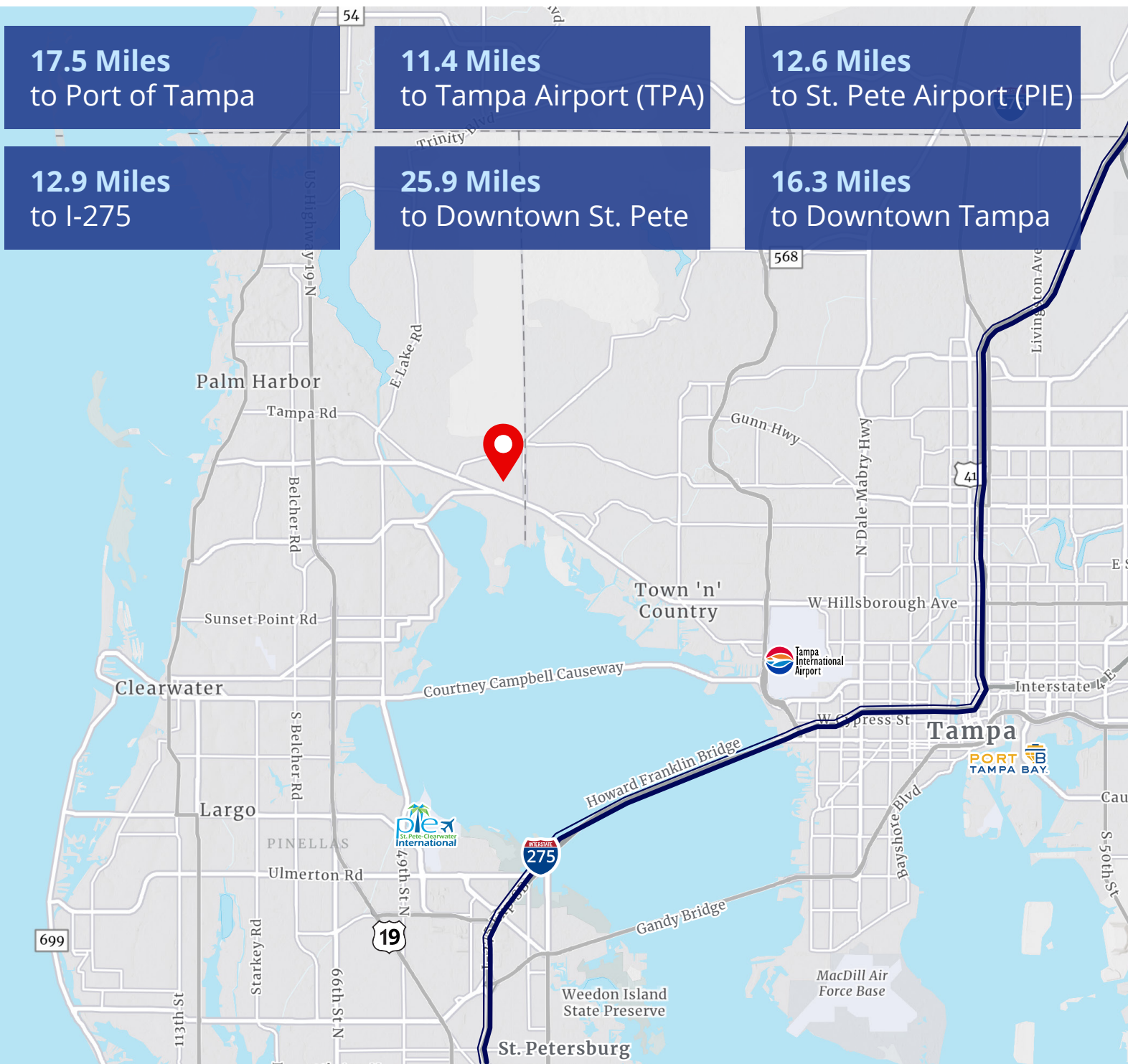

Kyle Kidd
Vice President
+1 813 225 2027
kyle.kidd@colliers.com

Tom Quinlan
Vice President
+1 813 605 4462
tom.quinlan@colliers.com

Dominic Hewitt
Senior Associate
+1 813 871 8503
dominic.hewitt@colliers.com

4830 West Kennedy Blvd.
Suite 300
Tampa, FL 33609
P: +1 813 221 2290

This document has been prepared by Colliers for advertising and general information only. Colliers makes no guarantees, representations or warranties of any kind, expressed or implied, regarding the information including, but not limited to, warranties of content, accuracy and reliability. Any interested party should undertake their own inquiries as to the accuracy of the information. Colliers excludes unequivocally all inferred or implied terms, conditions and warranties arising out of this document and excludes all liability for loss and damages arising there from. This publication is the copyrighted property of Colliers and/or its licensor(s). ©2025. All rights reserved.

