

FOR SALE

± 2,600 SF BLDG

LARGE PRIVATE YARD



11592 ANABEL AVENUE, GARDEN GROVE, CA 92843

PROPERTY HIGHLIGHTS

- **Building Size:** ± 2,600 SF
- **Lot Size:** ± 6,739 SF
- **Power:** 240V, 3 Phase (verify)
- **Celing Height:** 10'-12' Feet
- New Insulation and HVAC system throughout the Warehouse
- Two (2) 10'x10' Ground Level Doors (Drive-Thru Access)
- LED Lighting
- Large Private Yard
- **Zoning:** M-1 Zoning-Automotive & Manufacturing
- Proximity to the 22 Fwy
- Roof Repaired in 2022
- New Asphalt in 2022
- Renovated Restrooms 2022

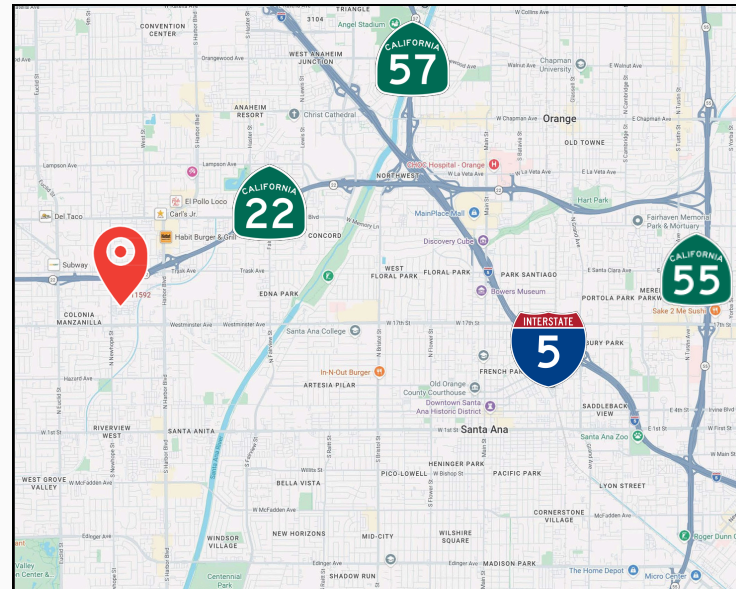

TOM GONZALEZ
Senior Vice President
(714) 704-4554 (Direct)
tomg@ashwillassociates.com
CA DRE Lic. 01487226

Disclaimer: This Information contained herein is believed reliable but not guaranteed. Photos may be digitally altered or artistic renderings. All trademarks and images are the property of their respective owners. Buyers and Tenants should verify information independently.



CORP. DRE LIC. 01291393

FOR SALE

± 2,600 SF BLDG

LARGE PRIVATE YARD

BUILDING SKETCH

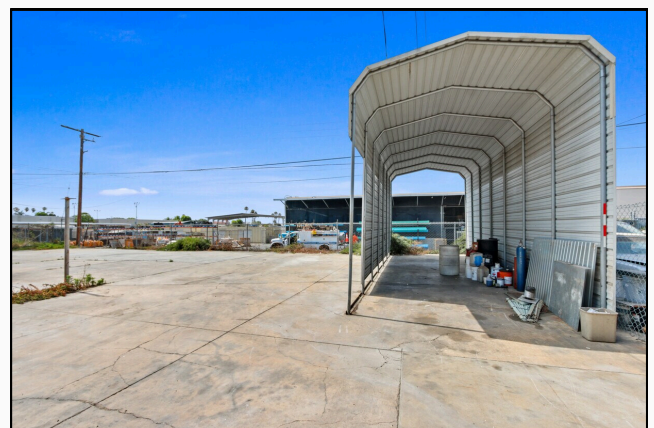
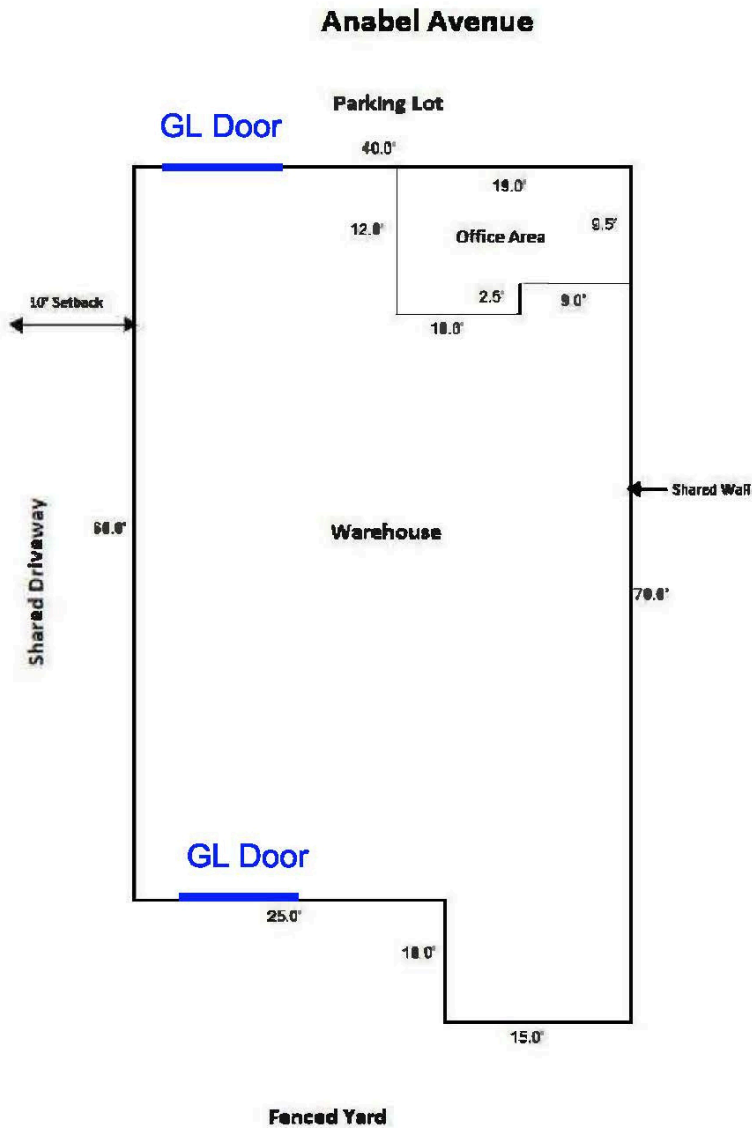

TOM GONZALEZ
Senior Vice President
(714) 704-4554 (Direct)
tomg@ashwillassociates.com
CA DRE Lic.01487226

Disclaimer: This Information contained herein is believed reliable but not guaranteed. Photos may be digitally altered or artistic renderings. All trademarks and images are the property of their respective owners. Buyers and Tenants should verify information independently.

Ashwill Associates
COMMERCIAL REAL ESTATE

CORP. DRE LIC.01291393