

**FOR LEASE**

Owned and Operated by



# CAPITAL COMMERCE CENTER

1312 Capital Blvd, Suite 101, Reno, NV

**±15,336 SF**



**LEASING INFO  
& CONTACT**

**Steve Kucera, SIOR, CCIM**

**775.470.8866**

**[steve.kucera@kidder.com](mailto:steve.kucera@kidder.com)**

**Lic # S.0172550**



This is not an offer or acceptance of an offer to lease space. A lease will only be offered or made in a written agreement signed by landlord. No representation or warranty of any kind is made by landlord unless set forth in a written definitive lease executed by the landlord.

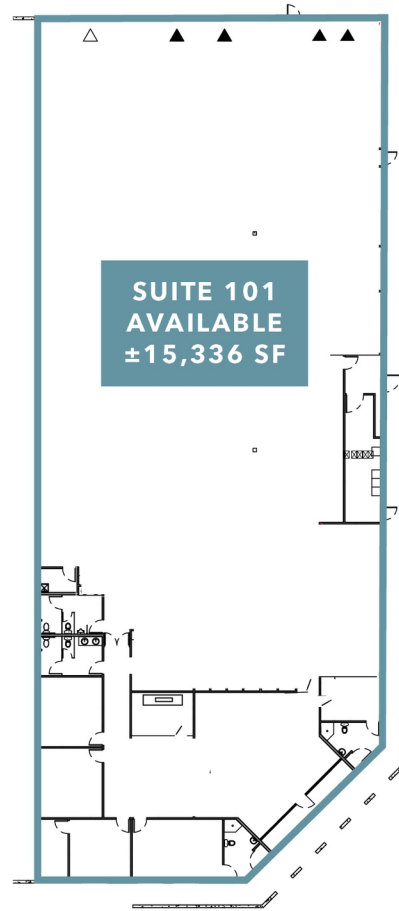
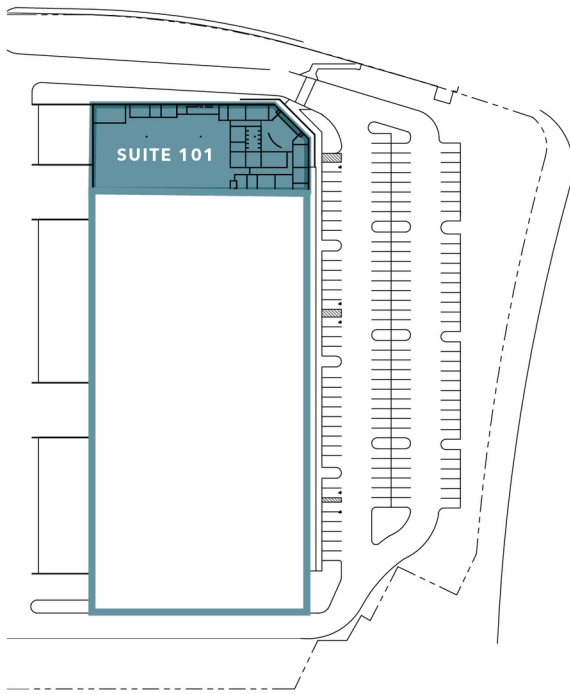

**Property Highlights**

<b>Lease Rate</b>	Negotiable
<b>Est. OPEX</b>	\$0.19/mo psf
<b>Available Space</b>	±15,336 SF
<b>Office Space</b>	±2,321 SF
<b>Dock-High Door</b>	4
<b>Drive-In Door</b>	1
<b>Clear Height</b>	24'
<b>Column Spacing</b>	50' x 50'
<b>Sprinklers</b>	ESFR
<b>Power</b>	200 amps 480/277 volts, 3-phase (TBV)
<b>Lighting</b>	LED Warehouse
<b>Built</b>	2004
<b>Zoned</b>	Industrial (I)

