

**7,815**  
**SQUARE FEET**  
**AVAILABLE**  
**FOR LEASE**

**INDUSTRIAL / FLEX**  
**UNITS**

**IDEAL LOCATION**  
**JUST OFF ROUTE 130**



OWNED BY

**Camber**  
**Real Estate**  
**Partners**

**AVAILABLE FOR LEASE**

**1819 UNDERWOOD BLVD**

**MILLSIDE INDUSTRIAL PARK | Delran, NJ**

**Scott Mertz, SIOR**  
+1 856 802 6529  
scott.mertz@naimertz.com

**NAI Mertz**  
21 Roland Avenue | Mount Laurel, NJ 08054  
+1 856 234 9600 | naimertz.com

**NAIMertz**  
COMMERCIAL REAL ESTATE SERVICES, WORLDWIDE

**AVAILABLE FOR LEASE**

# 1819 UNDERWOOD BLVD

MILLSIDE INDUSTRIAL PARK | Delran, NJ

## CURRENT AVAILABILITIES

### UNIT 2

- 7,815 SF - 2,180 SF office / 5,635 SF warehouse
- (2) 8'x10' dock doors
- 18' ceiling heights

**OFFICE SPACE CAN BE REMOVED**

## BUILDING DESCRIPTION

- 41,301 SF multi-tenanted, industrial/flex building
- 3.43 acre lot
- Tailgate and drive-in loading
- 18'± clear ceiling height
- 208/120v, 200a, 3 Phase electrical service
- Wet sprinkler system
- Located in Millside Industrial Park
- Just off of Route 130

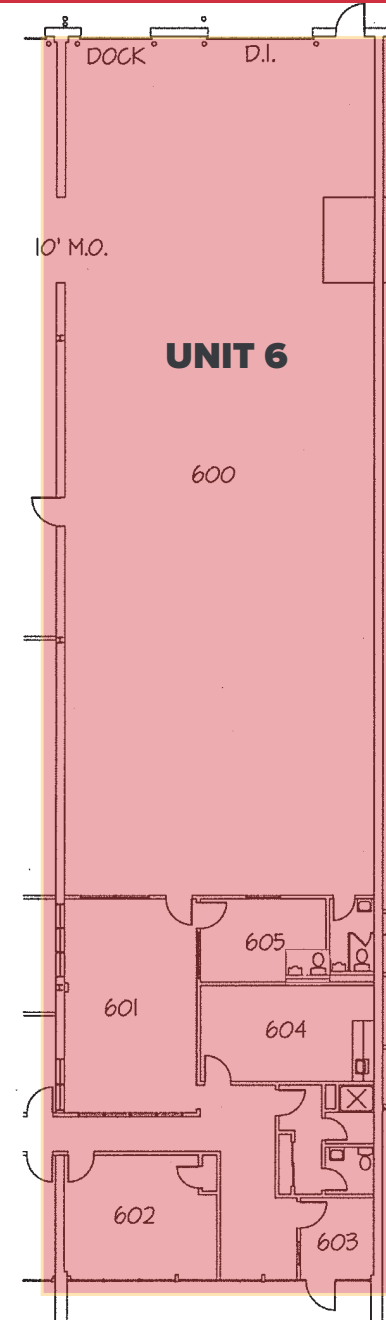

# LOCATION INFORMATION



## AVAILABLE FOR LEASE 1819 UNDERWOOD BLVD

MILLSIDE INDUSTRIAL PARK | Delran, NJ

### Distance to

Route 130	0.5 mi
Route 73	4.5 mi
I-295 (Exit 43)	5.5 mi
Tacony-Palmyra Bridge	6.5 mi
Betsy Ross Bridge	7.5 mi
NJ Turnpike (Exit 4)	10 mi
Center City Philadelphia	13 mi

OWNED BY

**Camber  
Real Estate  
Partners**

### Scott Mertz, SIOR

+1 856 802 6529

scott.mertz@naimertz.com

### NAI Mertz

21 Roland Avenue | Mount Laurel, NJ 08054

+1 856 234 9600 | naimertz.com

NO WARRANTY OR REPRESENTATION, EXPRESS OR IMPLIED, IS MADE AS TO THE ACCURACY OF THE INFORMATION CONTAINED HEREIN, AND THE SAME IS SUBMITTED SUBJECT TO ERRORS, OMISSIONS, CHANGE OF PRICE, RENTAL OR OTHER CONDITIONS, PRIOR SALE, LEASE OR FINANCING, OR WITHDRAWAL WITHOUT NOTICE, AND OF ANY SPECIAL LISTING CONDITIONS IMPOSED BY OUR PRINCIPALS NO WARRANTIES OR REPRESENTATIONS ARE MADE AS TO THE CONDITION OF THE PROPERTY OR ANY HAZARDS CONTAINED THEREIN ARE ANY TO BE IMPLIED.

**NAI Mertz**

COMMERCIAL REAL ESTATE SERVICES, WORLDWIDE