



385 Viger Avenue West

NEW TURNKEY SPACE DOWNTOWN

- 15,000 sq. ft. of exquisitely built-out & furnished space available immediately
- Ample interior parking
- 1-minute walk from Square-Victoria–OACI metro station entrance
- High capacity HVAC

CBRE

cogir
IMMOBILIER



THE HUMANITI EXPERIENCE

Humaniti proudly invites you to join this unique leading-edge landmark building. The five-floor state-of-the-art office tower offers incredible services and amenities.

FEATURES AND AMENITIES



AVAILABLE FOR IMMEDIATE OCCUPANCY

- 15,000 sq. ft. of built out and furnished space available immediately
- AA Class office building, eligible for LEED Silver Certification
- Well Building Standard Certification targeted, impacting human health and wellbeing, through air, water, nourishment, light, fitness, comfort, and mind
- Prominent signage opportunity on building façade
- Floor to ceiling windows with views of Place Riopelle
- Access to the Marriott Hotel conference center within the Humaniti Complex
- Access to the underground pedestrian network
- In vicinity to multiple of the finest dining establishments the city has to offer
- In proximity to the REM and bike path network

1 st Floor	Leased	
2 nd Floor	15,134 sq. ft.	Available
3 rd Floor	Leased	
4 th Floor	Leased	
5 th Floor	Leased	
TOTAL:	15,134 sq. ft.	

LEASE TERMS AND CONDITIONS

Base rent	Please call listing agents
Additional rent (2023 est.)	\$21.17 per sq. ft.
Tenant inducement	Pending term
Parking (underground)	Per tenant needs

FLOOR PLATE

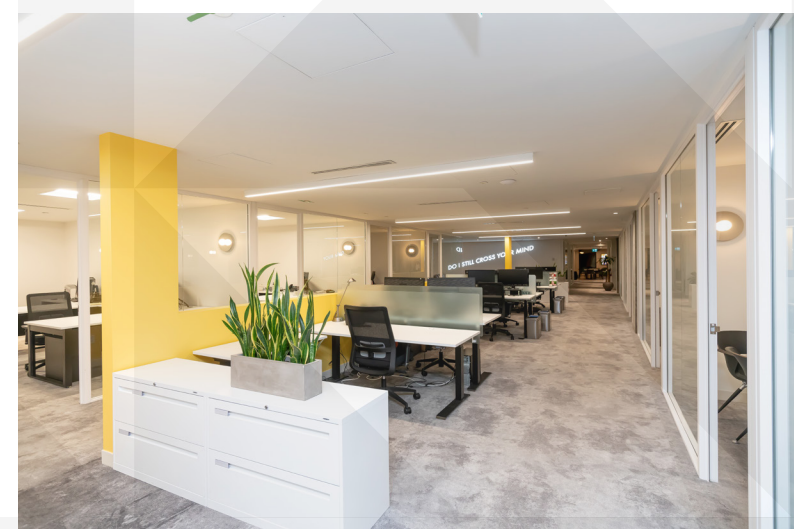
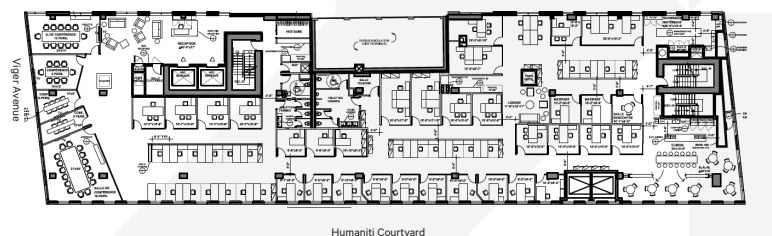

A UNIQUE LOCATION

IN THE HEART OF THE QUARTIER INTERNATIONAL, A VIBRANT HUB OF MONTREAL

The Quartier International plays a major role in the development of Montreal's urban landscape with more than 30 pieces of public art, including La Joute by Riopelle, Le Miroir aux alouettes by Ferron, and Éolienne V by Daudelin. The effervescence that animates the area attracted over 60 international organizations, such as the International Civil Aviation Organization, the World Trade Center Montréal, the Palais des congrès, and the Caisse de dépôt et placement du Québec.

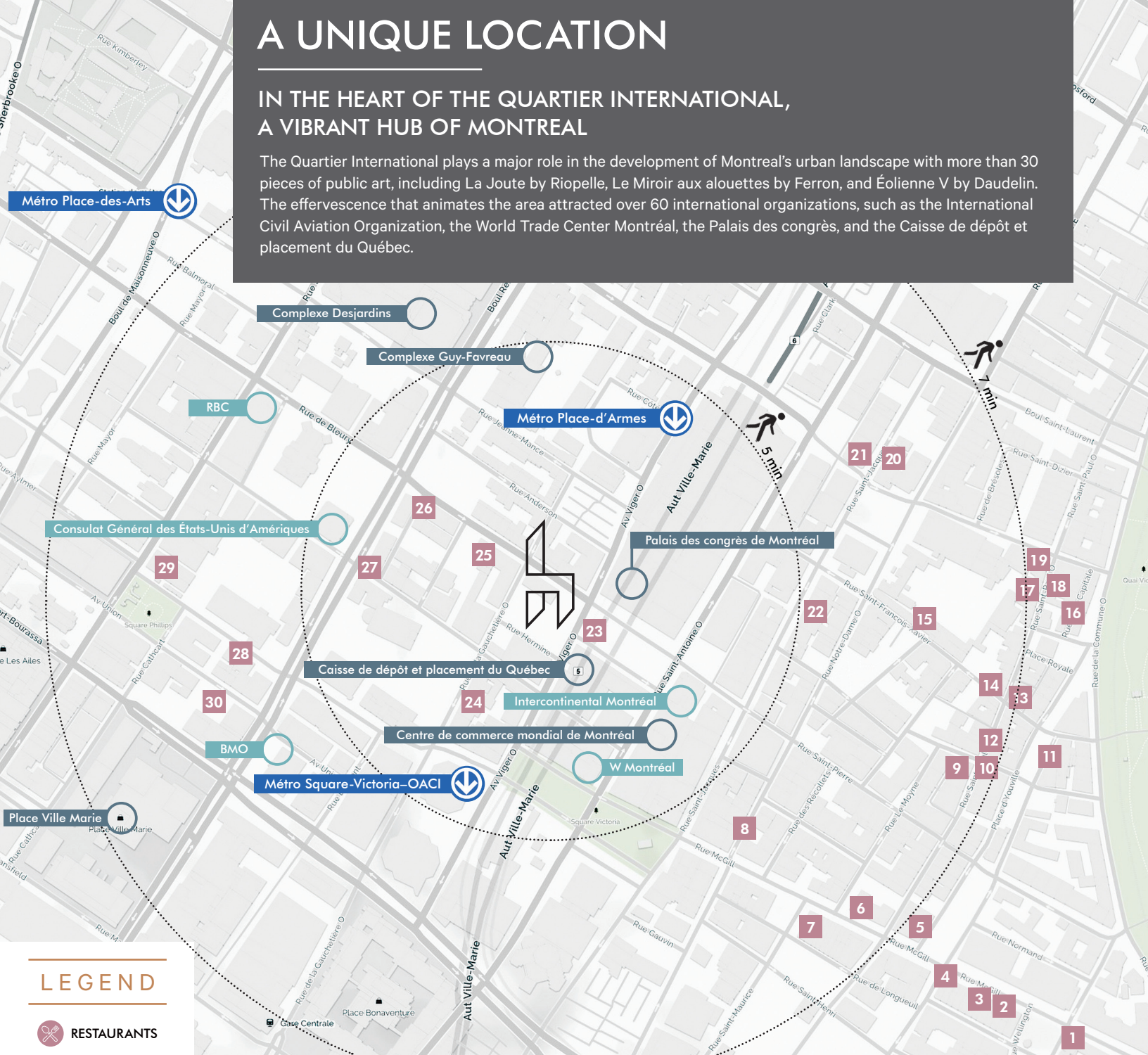

LEGEND



RESTAURANTS

- | | | | | | |
|-------------------------|---------------------|--------------------------|-------------------------|----------------------------|------------------------|
| 1. Jellyfish Montreal | 6. Helena | 11. Gibbys | 16. Seasalt | 21. Brasserie 701 | 26. Monsieur Resto+Bar |
| 2. Le Cartet | 7. Holder | 12. Barroco | 17. Sinclair Restaurant | 22. L'Assommoir Notre-Dame | 27. Copper Branch |
| 3. Restaurant Graziella | 8. Fish Bone | 13. Stash Café | 18. Méchant Boeuf | 23. Toqué | 28. Jatoba |
| 4. HÂ | 9. Olive & Gourmand | 14. Garde Manger | 19. Manfiaboco | 24. Fiorellino | 29. Pizza Il Focolaio |
| 5. Hambar | 10. Pyrénées | 15. Restaurant Bonaparte | 20. Rosewood | 25. Tiradito | 30. Escondite |

Erica Deschênes
CBRE Limitée
Vice President
Real Estate Broker
514.375.0238
erica.deschenes@cbre.com

David Cervantes
CBRE Limitée
Executive Vice President
Real Estate Broker
514.906.1056
david.cervantes@cbre.com
Real Estate Broker carrying out his activities with the
business corporation David Garcia-Cervantes Real Estate
Brokerage Inc.

Joseph Telio
Cogir Management
Vice President
Real Estate Broker
450.766.2454
jtelio@cogir.net

Nicolas Poirier
Cogir Management
Senior Leasing Director
Real Estate Broker
450.766.8746
npoirier@cogir.net

CBRE Limitée, Real Estate Agency
1250 René-Lévesque Boulevard West, Suite 2800 | Montreal, Quebec | H3B 4W8 | www.cbre.ca

Cogir Management Corporation, Real estate Agency
7250 Taschereau Boulevard, Suite 200 | Brossard, Quebec | J4W 1M9

This disclaimer shall apply to CBRE Limited, Real Estate Agency, and to all other divisions of the Corporation, to include all employees and independent contractors ("CBRE"). The information set out herein, including, without limitation, any projections, images, opinions, assumptions and estimates obtained from third parties (the "Information") has not been verified by CBRE, and CBRE does not represent, warrant or guarantee the accuracy, correctness and completeness of the Information. CBRE does not accept or assume any responsibility or liability, direct or consequential, for the information or the recipient's reliance upon the Information. The recipient of the Information should take such steps as the recipient may deem necessary to verify the Information prior to placing any reliance upon the Information. The Information may change and any property described in the Information may be withdrawn from the market at any time without notice or obligation to the recipient from CBRE. CBRE and the CBRE logo are the service marks of CBRE Limited and/or its affiliated or related companies in other countries. All other marks displayed on this document are the property of their respective owners. All Rights Reserved.