

**3333 / 3343 DURAHART STREET
RIVERSIDE, CA 92507**

**FOR LEASE
± 8,712 SF - ± 17,424 SF
INDUSTRIAL W/YARD**



JACKIE BEAUCHAMP

(951) 684-1251 | jbeauchamp@mcgre.com

DRE License # #01461175 | #01899258



**MARTIN
COMMERCIAL
GROUP**
Commercial Real Estate Services

WWW.MCGRE.COM



**3333 / 3343 DURAHART STREET
RIVERSIDE, CA 92504**

**FOR LEASE
± 8,712 SF - ± 17,424 SF
INDUSTRIAL W/YARD**



PROPERTY HIGHLIGHTS

3333 Durahart Street, Riverside

- ±8,712 SF Industrial Unit w/ Fenced Yard
- Street
- Reception + 5 Offices
- 4 Private Interior Restroom(s)
- 2 Ground Level Loading Doors
- Power: 200A, 3P/4W (Verify)
- Ample Parking /Private Parking Lot
- 17' Warehouse Clearance
- BMP – Light Industrial Zone (verify)

3343 Durahart Street, Riverside

- ±8,712 SF Industrial Unit w/ Fenced Yard
- Reception + 3 Offices
- 3 Private Interior Restroom(s)
- Power: (Verify)
- Ample Parking
- 17' Warehouse Clearance
- BMP – Light Industrial Zone (verify)



**MARTIN
COMMERCIAL
GROUP**
Commercial Real Estate Services

The information contained herein has been obtained from sources we deem reliable. While we have no reason to doubt its accuracy, we do not guarantee it.

**CORPORATE OFFICE: 1495 E. WARNER AVENUE ~ SANTA ANA, CA 92705
Orange County 714-241-1141
Inland Empire: 951-684-1251**

**3333 / 3343 DURAHART STREET
RIVERSIDE, CA 92507**

**FOR LEASE
± 8,712 SF - ± 17,424 SF
INDUSTRIAL W/YARD**

SITE PLAN



WWW.MCGRE.COM

JACKIE BEAUCHAMP
(951) 684-1251 | jbeauchamp@mcgre.com
DRE License # #01461175 | #01899258



**MARTIN
COMMERCIAL
GROUP**
Commercial Real Estate Services

3333 / 3343 DURAHART STREET
RIVERSIDE, CA 92507

FOR LEASE
± 8,712 SF - ± 17,424 SF
INDUSTRIAL W/YARD

FLOOR PLANS

3343 Durahart Street ± 8,712 SF

3333 Durahart Street ± 8,712 SF

Combined: ± 17,424 SF

Each Yard ± 3,000 SF (Separately Fenced)

The information contained herein has been obtained from sources we deem reliable. While we have no reason to doubt its accuracy, we do not guarantee it.

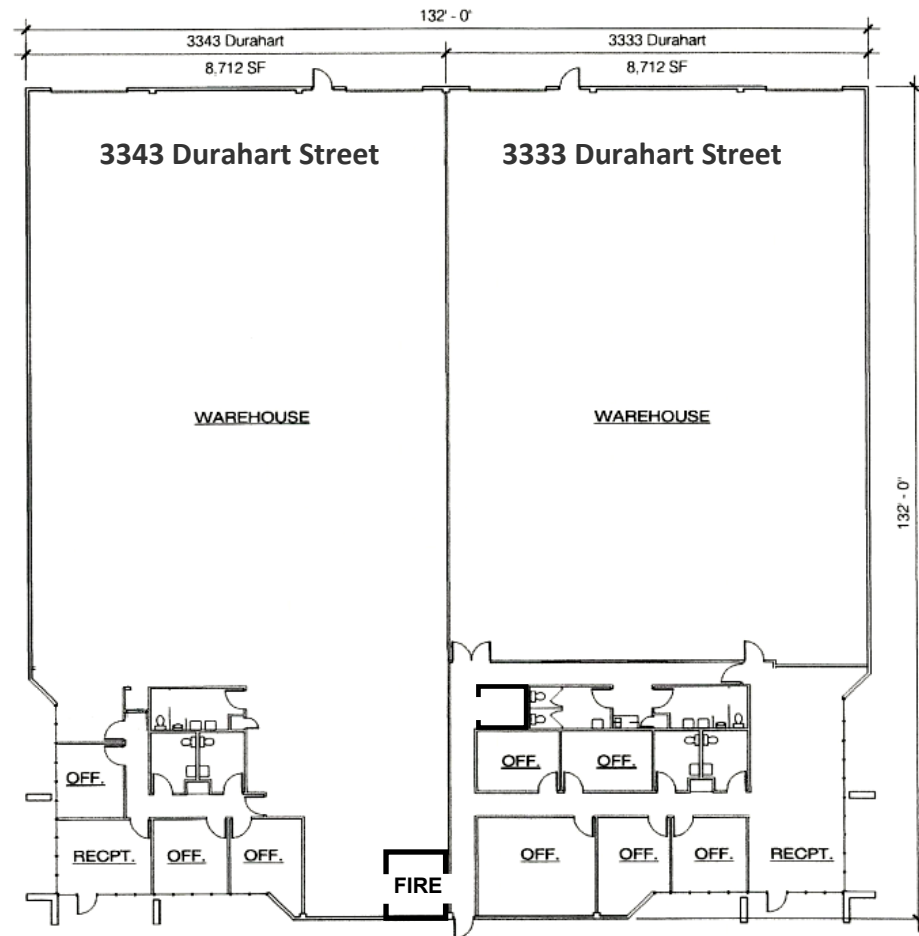

WWW.MCGRE.COM

JACKIE BEAUCHAMP

(951) 684-1251 | jbeauchamp@mcgre.com

DRE License # #01461175 | #01899258



**MARTIN
COMMERCIAL
GROUP**
Commercial Real Estate Services

3333 / 3343 DURAHART STREET
RIVERSIDE, CA 92507

FOR LEASE
± 8,712 SF - ± 17,424 SF
INDUSTRIAL W/YARD

AVAILABILITY

SUITE	SQ. FT.	BASE RENT	CAM	DESCRIPTION	AVAIL. DATE
3333 Durahart Street	8,712	\$10,890.00 / Month (1.25MG)	\$1,045.00 / Month (Includes water and CAM)	Reception + 5 offices, Warehouse and 4 Restrooms, 2 Ground Level Loading Doors, Fenced Yard, Private Parking Lot	12/1/2025
3343 Durahart Street	8,712	\$10,455.00 / Month (1.20MG)	\$1,045.00 / Month (Includes water and CAM)	Reception + 3 Offices, Warehouse and 3 Restrooms, 2 Ground Level Loading Doors, Fenced Yard	1/1/2026

WWW.MCGRE.COM

JACKIE BEAUCHAMP

(951) 684-1251 | jbeauchamp@mcgre.com

DRE License # #01461175 | #01899258



**MARTIN
COMMERCIAL
GROUP**
Commercial Real Estate Services