

# SKY DECK

AT DEL MAR HIGHLANDS

2<sup>nd</sup> Gen Restaurant/Bar Space Available

**12841 El Camino Real,  
San Diego, CA 92130**

Sky Deck is the newest culinary destination in North County, San Diego. With several different restaurants, a cocktail bar and three breweries, it's the perfect place for a date night, weekend happy hour or dinner with friends. Sky Deck is the perfect place for all tastes, offers from all over the world, everyone can find their perfect meal. While food and drinks from around the world may be the highlights, that's not all Sky Deck has to offer. The Sky Deck also boasts beautiful views and stunning architecture, the perfect backdrop for a romantic evening. Get ready for sunsets and delicious date nights under the Sky Deck's signature roof!





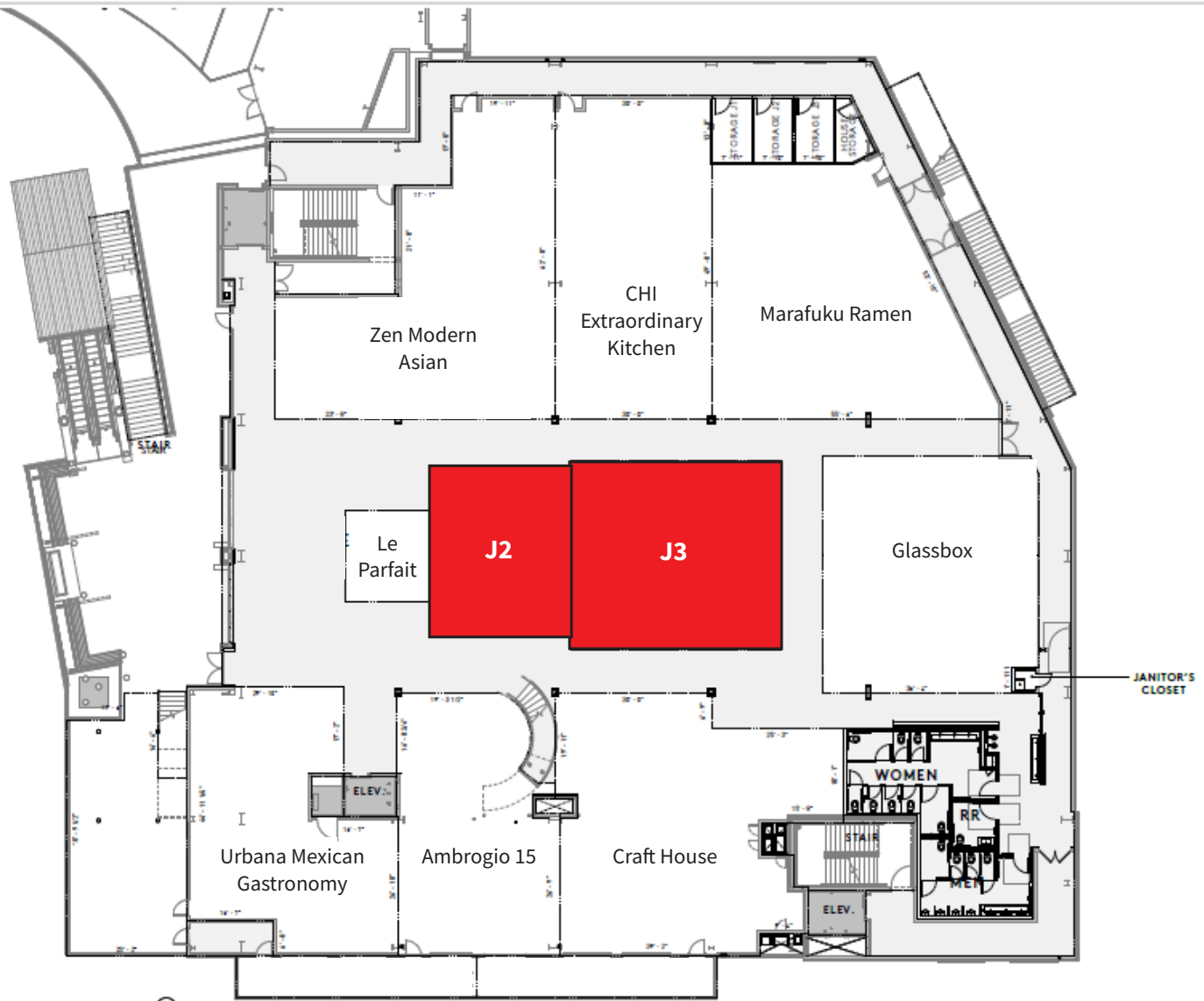

LEVEL 2: SKYDECK

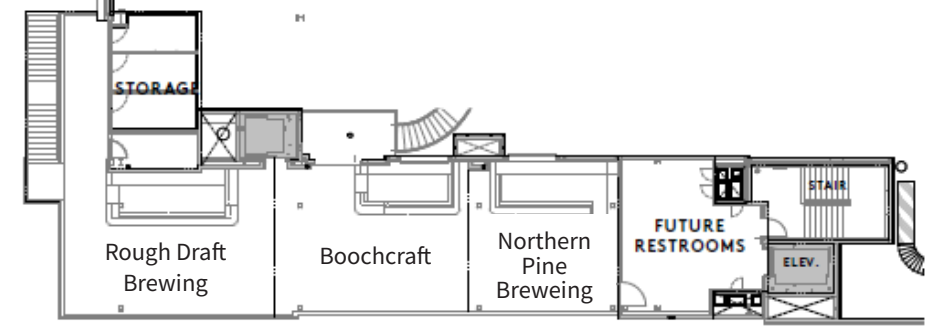

LEVEL 3: BREWER'S DECK

**Available**

Suite	Sq. Ft.
J2/J3	2,316 SF

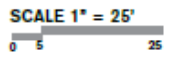

SCALE 1" = 25'

SKYDECK LEASING PLAN



bluemercury  
makeup • skincare • spa

cinépolis  
LUXURY CINEMAS

FedEx

nékter  
JUICE BAR

JIMBO'S

HANDEL'S  
JEWELRY & CRYSTALS SINCE 1871

LOLO

tucci.  
BOUTIQUE

RITE  
AID

Ralphs  
fresh fare

MENDOCINO FARMS  
sandwich market

WILLIAM & SONS  
JEWELERS

CLUB PILATES

Spitz & Co's  
make. eat. art & drink.

unleashed  
by PETCO

PEPPERON'S  
ITALIAN RESTAURANT

STARBUCKS

PANDA EXPRESS  
CHINESE KITCHEN

restore  
HYPER WELLNESS • CRYOTHERAPY

happyjaron.

iTAN  
SUN • SKIN • SPA

THE SHADE STORE

VUORI

URBAN  
PLATES

Steak  
48

CeramCafe Art Lounge  
print your own ceramic, mugs, clay personalized more...

STRETCH LAB

dirty dogs  
and meow

The Dance Academy  
Del Mar  
ignite the passion

SALTED  
BARBER

lulu nails

BEVERLY HILLS  
REJUVENATION CENTER

sweetgreen

pressed

perلمانclinic++

ATELIER  
OPTICA

REVEL  
FIT CLUB

EUROPEAN  
WAY  
CENTER



## For leasing inquiries

**Brian J. Quinn**  
Senior Vice President  
+1 858 352 2902  
brian.quinn@jll.com  
RE# 01009041

**Bryan A. Cunningham**  
Senior Vice President  
+1 858 410 6326  
bryan.cunningham@jll.com  
RE# 01348498

Although information has been obtained from sources deemed reliable, JLL does not make any guarantees, warranties or representations, express or implied, as to the completeness or accuracy as to the information contained herein. Any projections, opinions, assumptions or estimates used are for example only. There may be differences between projected and actual results, and those differences may be material. JLL does not accept any liability for any loss or damage suffered by any party resulting from reliance on this information. If the recipient of this information has signed a confidentiality agreement with JLL regarding this matter, this information is subject to the terms of that agreement. ©2023. Jones Lang LaSalle IP, Inc. All rights reserved.

