

# OFFICE/WAREHOUSE SPACE FOR SALE

I-430 & COLONEL GLENN | LITTLE ROCK, AR

Commercial  
Realty LLC

New  
Construction



## Contact Us:

**JACQUELINE BOYETTE**

M: 501.519.4008 | D: 501.219.0919

[jboyette@commercialrealtyllc.com](mailto:jboyette@commercialrealtyllc.com)

## Commercial Realty, LLC

#1 Remington Drive, Suite 100

Little Rock, Arkansas 72204

501.219.0919

The statements, terms and conditions set forth in this advertisement are deemed reliable but not guaranteed and remain, at all times, subject to change by the property owner(s) without notice. The property owner(s) reserve the right, at its sole and absolute discretion to adjust the price and remove the property from the market at any time without notice. The property owner(s) reserves the right to reject any and all offers and transactions are subject to the execution of the definitive agreements. Commercial Realty, LLC makes no guarantees, representations or warranties regarding its accuracy.



# Property Info

#9 Remington Drive | Little Rock, AR

Commercial  
Realty LLC

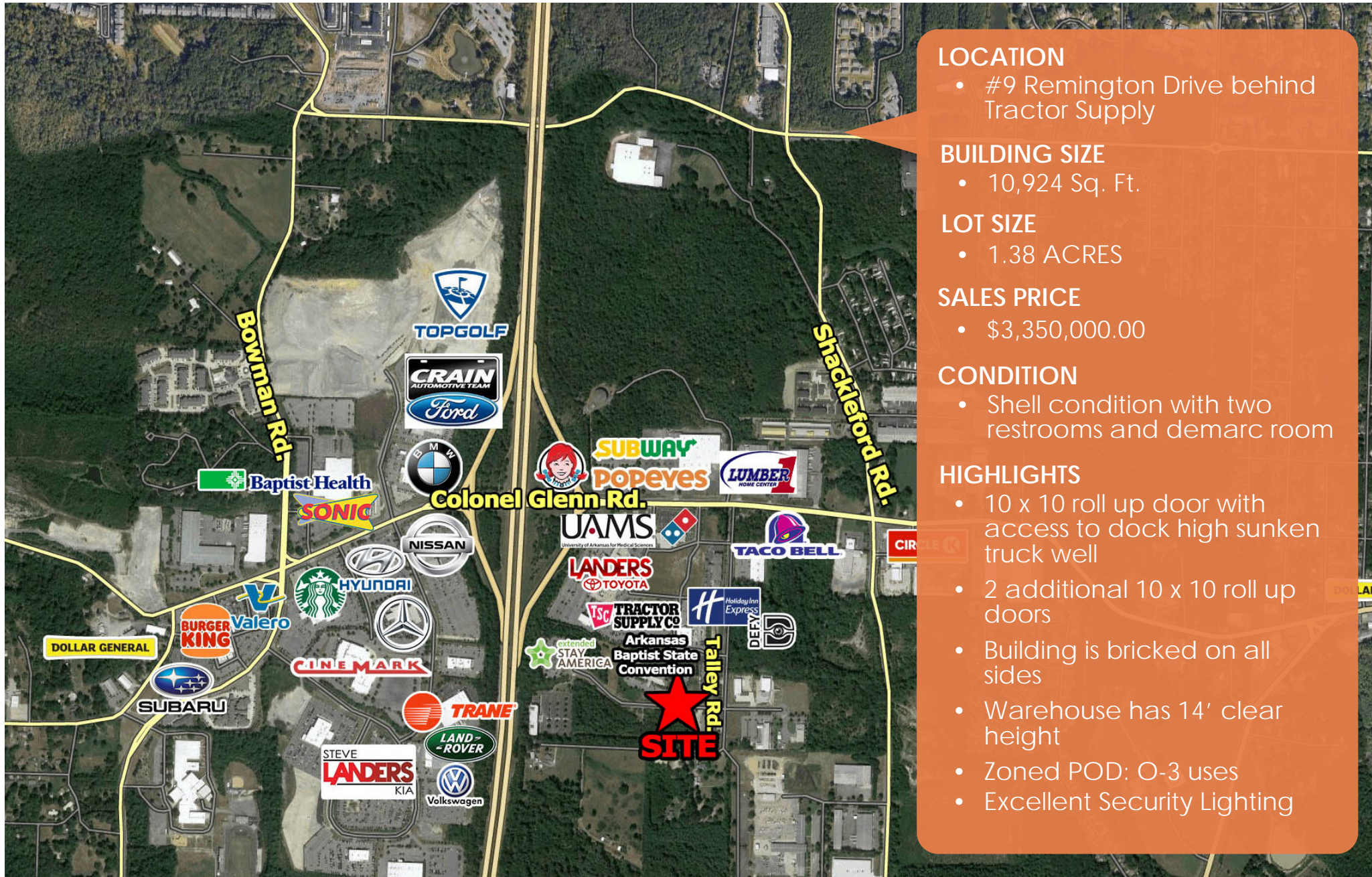

## LOCATION

- #9 Remington Drive behind Tractor Supply

## BUILDING SIZE

- 10,924 Sq. Ft.

## LOT SIZE

- 1.38 ACRES

## SALES PRICE

- \$3,350,000.00

## CONDITION

- Shell condition with two restrooms and demarc room

## HIGHLIGHTS

- 10 x 10 roll up door with access to dock high sunken truck well
- 2 additional 10 x 10 roll up doors
- Building is bricked on all sides
- Warehouse has 14' clear height
- Zoned POD: O-3 uses
- Excellent Security Lighting



# Floor Plan

#9 Remington Drive | Little Rock, AR

Commercial  
Realty<sup>LLC</sup>

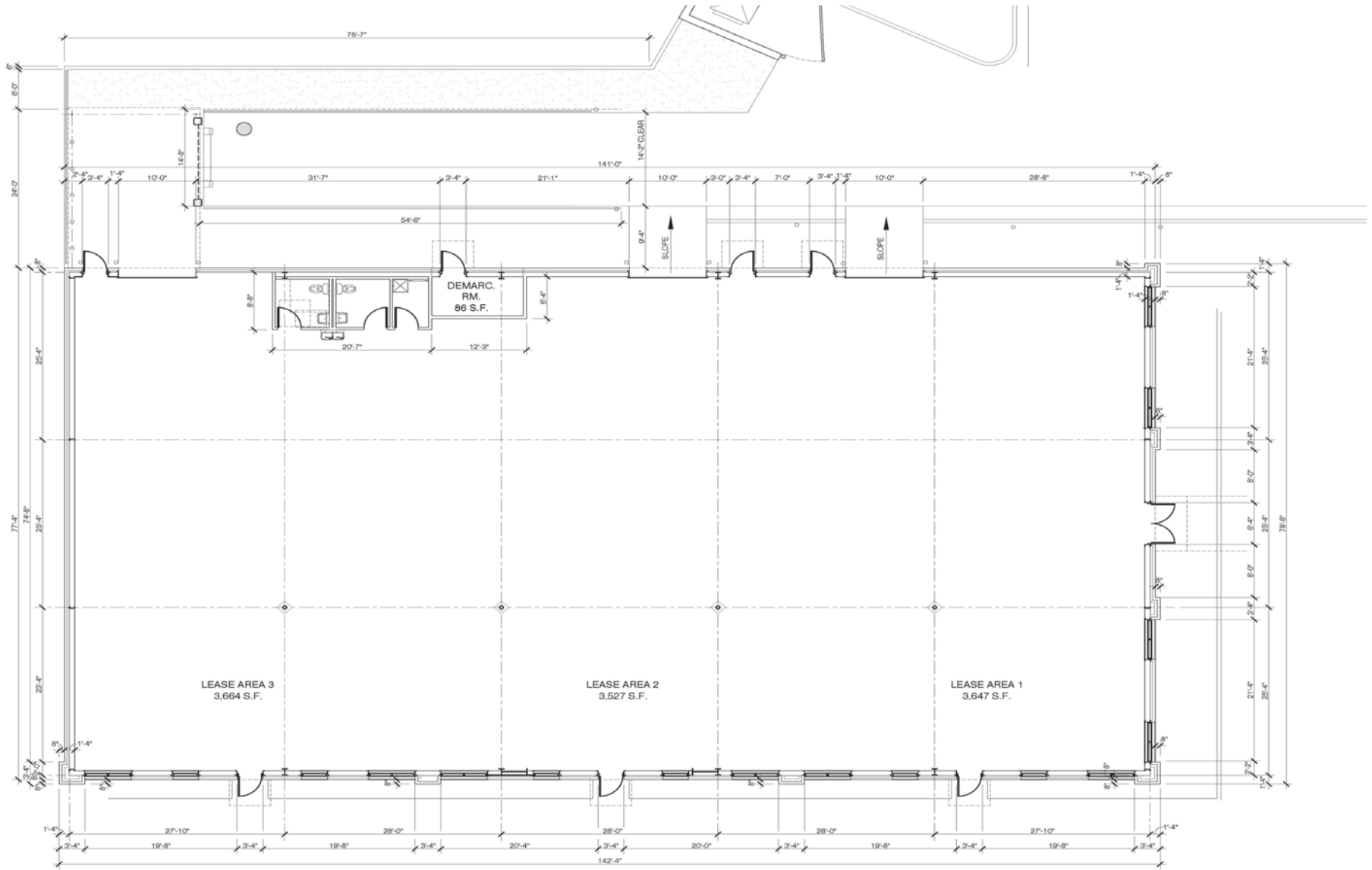

FLOOR PLAN-LOT #18

1/8" = 1'-0" TOTAL BUILDING AREA= 10,924 SQUARE FEET  
(minus) DEMARCATION ROOM @ 86 SQUARE FEET  
TOTAL LEASABLE AREA= 10,838 SQUARE FEET



# SITE PLAN

#9 Remington Drive | Little Rock, AR

Commercial  
Realty LLC

