



# Macedo Business Park

## Office Space For Lease

25 & 27 Minneakoning Road, Flemington  
Hunterdon County, New Jersey, 08822

### PROPERTY DESCRIPTION

Macedo Business Park is the premier industrial/office/flex campus within beautiful Hunterdon County, NJ. The park consists of three buildings totaling 161,000 SF, 2 story steel, concrete, and red brick office/industrial buildings with tinted aluminum windows. Immaculately maintained. Onsite property management. Located within 1 mile from Route 31 and within a market with significant new commercial and residential developments.

### AVAILABLE OFFICE SPACE

#### **(Bldg. II #25)**

Suite 100: ± 940 SF

Suite 201: ±3,340 SF

#### **(Bldg. I #27)**

Suite 102: ±3,285 SF

Suite 102.5: ± 1,880 SF

Suite 201: 2,524 SF (Move-In Condition)

Suite 202: 4,160 SF

Suite 203: 4,586 SF

} Can be combined

} Can be combined

### RENTAL RATES

Upon request, subject to use and creditworthiness

### CAM & REAL ESTATE TAXES

\$3.91 psf projected 2026

### ZONING

1-2 Major Industrial Zoning District.

## FOR ADDITIONAL INFORMATION CONTACT EXCLUSIVE LEASING AGENT

**Joel Tomlinson**

**Asst. VP – Retail Brokerage**

**908.604.6900 x 108**

**[jtomlinson@silbertrealestate.com](mailto:jtomlinson@silbertrealestate.com)**

# SILBERT

REALTY & MANAGEMENT COMPANY, INC.

152 Liberty Corner Road  
Suite 203  
Warren, NJ 07059

*No warranty or representation, express or implied, is made to the accuracy or completeness of the information contained herein and same is submitted subject to errors, omissions, change of price, rental or other conditions, withdrawal without notice, and to any special listing conditions imposed by the property owner. As applicable, Silbert Realty & Management make no representation as to the condition of the property (or properties marketed) in question.*



Visit Our Website: [WWW.SilbertRealEstate.com](http://WWW.SilbertRealEstate.com)

# 27 Minneakoning Road –1<sup>st</sup> Floor Leasing Plan

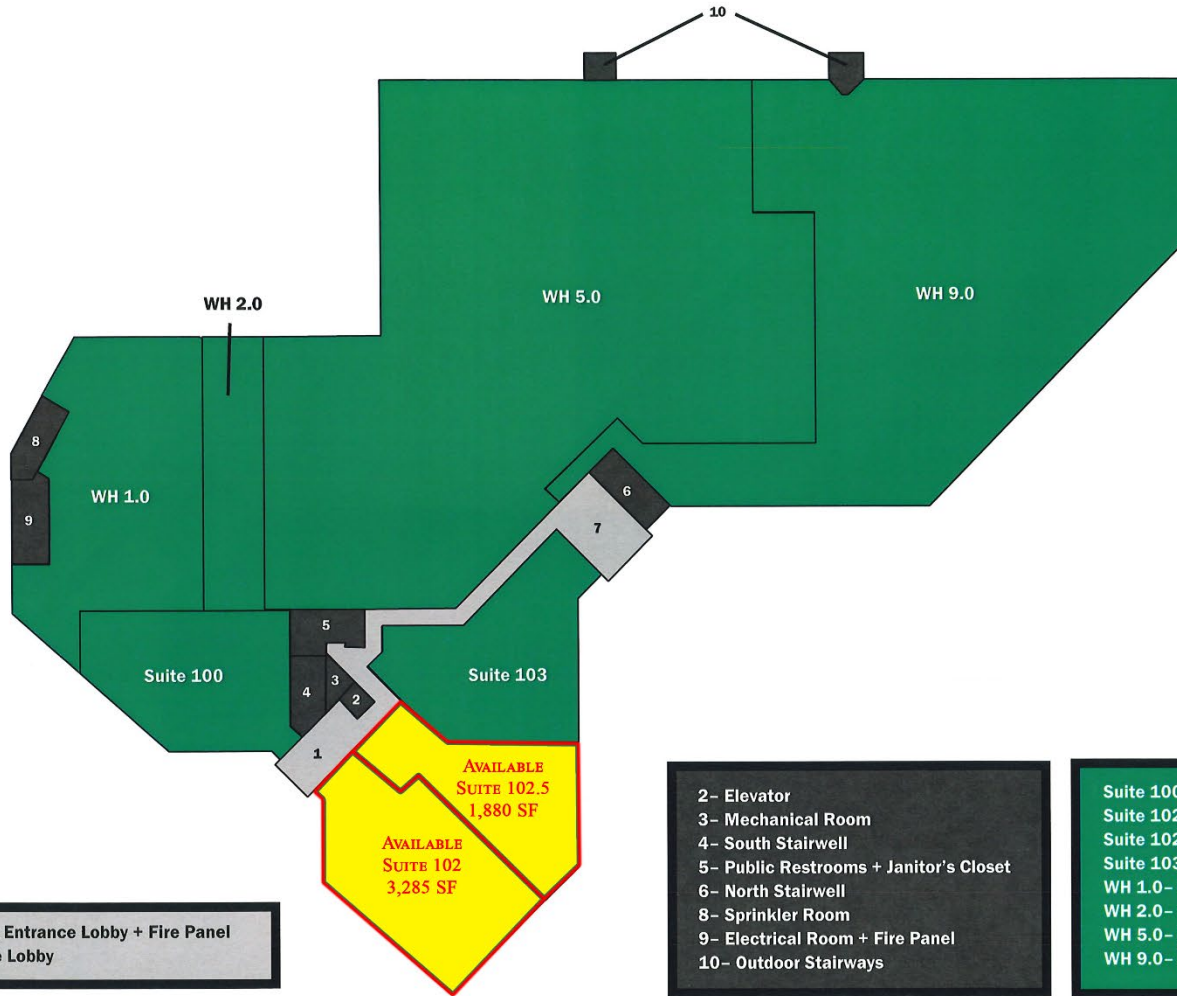

1- Minneakoning Entrance Lobby + Fire Panel  
7- River Entrance Lobby

2- Elevator  
3- Mechanical Room  
4- South Stairwell  
5- Public Restrooms + Janitor's Closet  
6- North Stairwell  
8- Sprinkler Room  
9- Electrical Room + Fire Panel  
10- Outdoor Stairways

Suite 100- Wm Stothoff Co. Office  
Suite 102- VACANT  
Suite 102.5- VACANT  
Suite 103- Turner  
WH 1.0- Moss Landscaping  
WH 2.0- Turner  
WH 5.0- Macedos Construction  
WH 9.0- AJG Packaging

# 27 Minneakoning Road – 2<sup>nd</sup> Floor Leasing Plan



1- Minneakoning Upper Lobby  
7- River Upper Lobby

2- Elevator  
3- Mechanical Room + Roof Access  
4- South Stairwell  
5- Public Restrooms + Janitor's Closet  
6- North Stairwell

Suite 201- Available For Lease  
Suite 202- Available For Lease  
Suite 203- Available For Lease

# 25 Minneakoning Road –1<sup>st</sup> Floor Leasing Plan



1- West Entrance Lobby  
7- East Entrance Lobby

2- Elevator  
3- West Stairwell  
4- Storage  
5- Public Restrooms  
6- Janitor's Closet  
8- East Stairwell  
17- Sprinkler Room  
18- Electrical Room + Fire Panel  
19- Outdoor Stairways

Suite 100- VACANT  
Suite 100.5- Opportunity Equipment  
Suite 101- Waltron, Bull, & Roberts  
Suite 102- Dentist  
WH 1.0- Corporate Furniture Services  
WH 3.0- Waltron, Bull & Roberts  
WH 5.0- Macedo Pumping Co.  
WH 6.0- Macedos Construction

# 25 Minneakoning Road -2<sup>nd</sup> Floor Leasing Plan

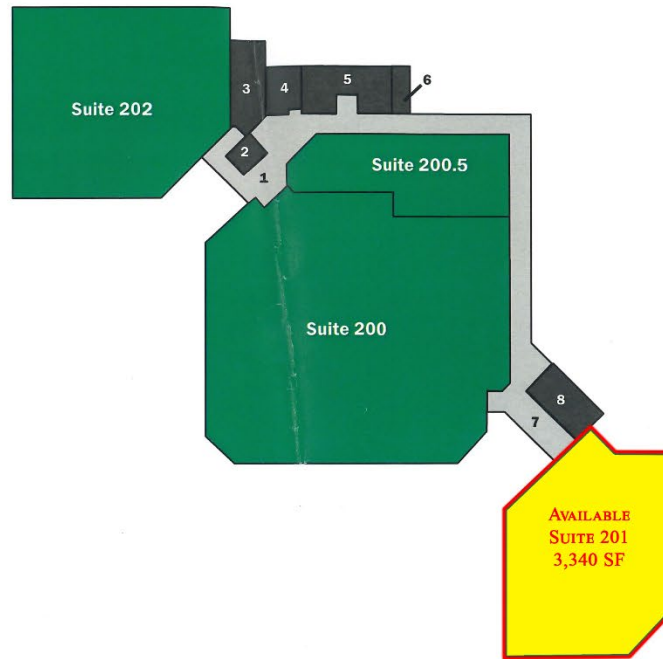

1- West Upper Lobby  
7- East Upper Lobby

2- Elevator  
3- West Stairwell  
4- Storage + Roof Access  
5- Public Restrooms  
6- Janitor's Closet  
8- East Stairwell

Suite 200- Macedos Construction Office  
Suite 200.5- Macedos Construction Gym  
Suite 201- VACANT  
Suite 202- Master Martini

# Regional Trade Aerial

