

# 747 & 751 ORCHARD LAKE RD PONTIAC, MICHIGAN

INDUSTRIAL FOR SALE  
15,112 Square Feet Available



**SIGNATURE  
ASSOCIATES**  
KNOW SIGNATURE | KNOW RESULTS

## TWO BUILDING PACKAGE



### 747 ORCHARD LAKE ROAD

- 9,114 square feet available
- 2,000 square feet of office
- 16' clear height
- (2) 12x14 grade level doors
- Zoned Industrial
- 200 amps, 240 volts, 3-phase

### 751 ORCHARD LAKE ROAD

- 5,998 square feet available
- 1,560 square feet of office
- 1,053 square foot mezzanine above office area
- 15' clear height
- (3) 12x14 grade level doors
- Zoned Industrial

### OVERALL PROPERTY

- Located on a 3.170-acre site
- Fenced yard/parking
- Quick access to Telegraph Road, M-59 and I-75
- 747 Orchard Lake is currently under lease until July 2028, 751 Orchard Lake is vacant
- Sale Price: \$1,100,000 (\$120.69/sq. ft.)



For more information, please contact:

**KRIS PAWLOWSKI**  
(248) 359 3801  
kpawlowski@signatureassociates.com

**SIGNATURE ASSOCIATES**  
One Towne Square, Suite 1200  
Southfield, MI 48076  
www.signatureassociates.com

# 747 & 751 Orchard Lake Road – Pontiac, MI

## Industrial For Sale

15,112  
Square Feet  
AVAILABLE

### Site Plan



For more information, please contact:

**KRIS PAWLOWSKI**  
(248) 359 3801  
kpawlowski@signatureassociates.com

**SIGNATURE ASSOCIATES**  
One Towne Square, Suite 1200  
Southfield, MI 48076  
www.signatureassociates.com

# 747 & 751 Orchard Lake Road – Pontiac, MI

Industrial For Sale

15,112  
Square Feet  
AVAILABLE

## Floor Plan 747 Orchard Lake

ORCHARD LAKE ROAD

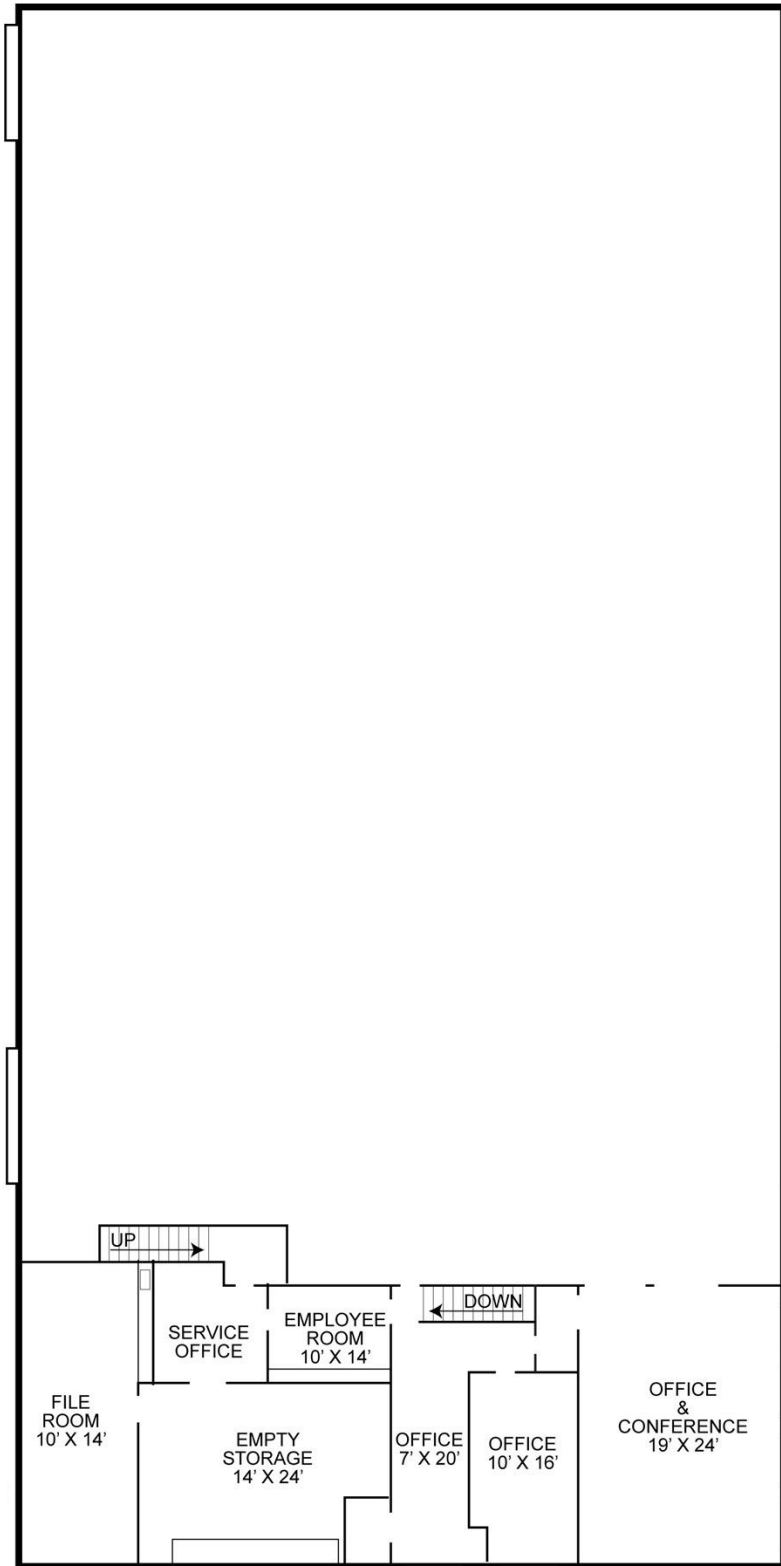

For more information, please contact:

**KRIS PAWLOWSKI**  
(248) 359 3801  
kpawlowski@signatureassociates.com

**SIGNATURE ASSOCIATES**  
One Towne Square, Suite 1200  
Southfield, MI 48076  
www.signatureassociates.com

# 747 & 751 Orchard Lake Road – Pontiac, MI

## Industrial For Sale

15,112  
Square Feet  
AVAILABLE

Aerial



For more information, please contact:

**KRIS PAWLOWSKI**  
(248) 359 3801  
kpawlowski@signatureassociates.com

**SIGNATURE ASSOCIATES**  
One Towne Square, Suite 1200  
Southfield, MI 48076  
www.signatureassociates.com

Information is subject to verification and no liability for errors or omissions is assumed. Price is subject to change and listing withdrawal.