



Approved
Median Break

5.5 acres

Gloucester
Moose Lodge

LAND FOR LEASE

US 17 & MOOSE LODGE ROAD

GLoucester, VA

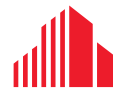

CUSHMAN &
WAKEFIELD

THALHIMER

US 17 & MOOSE LODGE RD.

Gloucester, VA



Property Features

- Size: 5.5 Acres
- Annual Lease Rate: \$350,000/year
- Zoning: B-1
- Access: VDOT approved median break with permits for construction

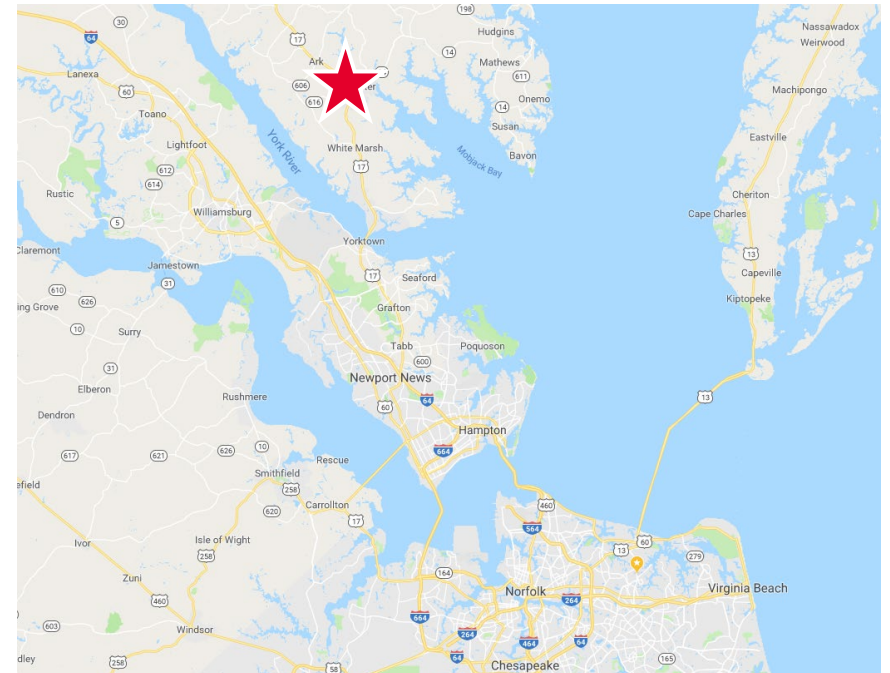

US 17 & MOOSE LODGE RD.

Gloucester, VA

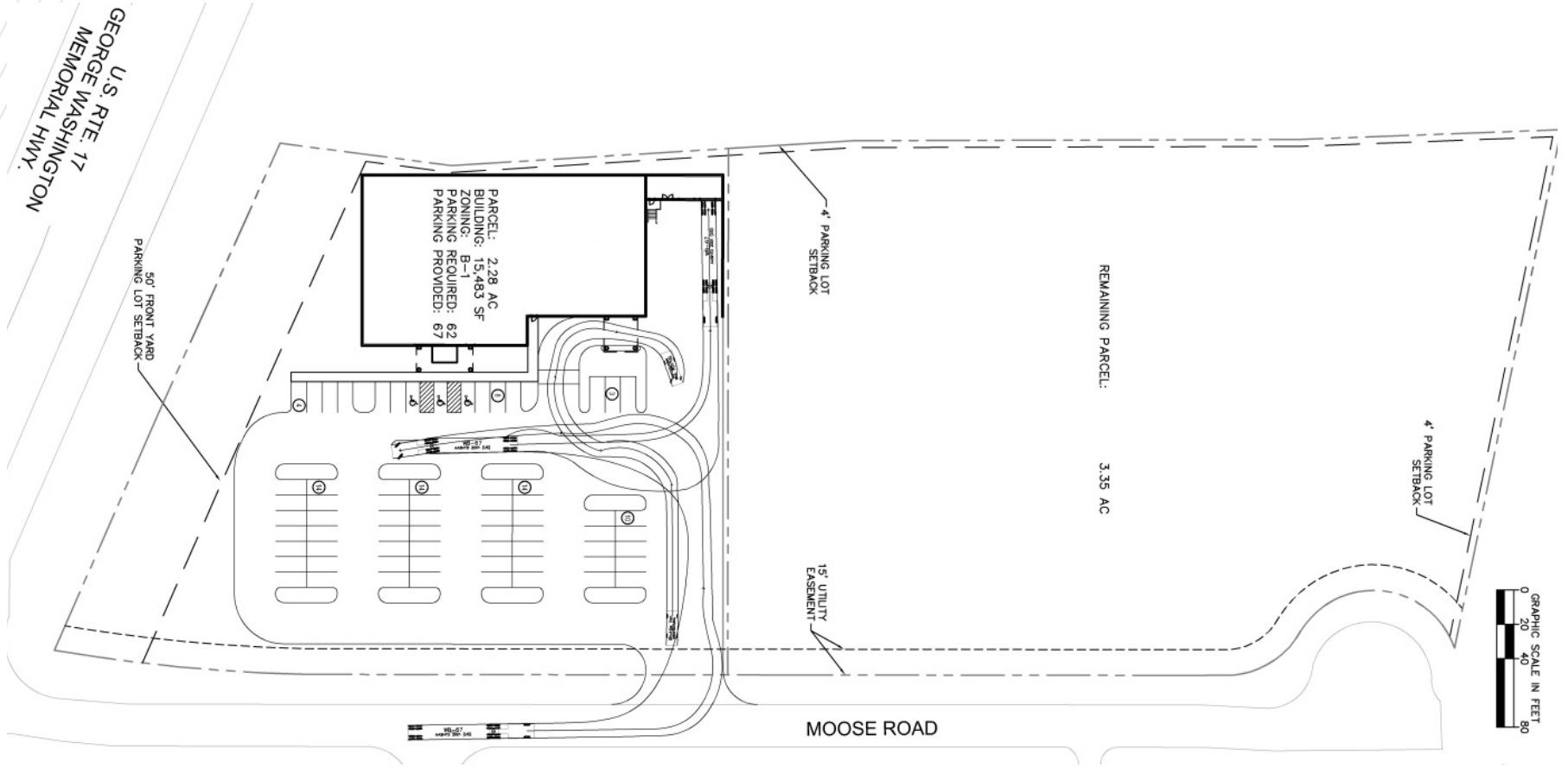



Approved
Median Break

Moose Rd.

5.5
Acres

Moose
Lodge



George Washington Memorial Hwy. - 30,000 VPD

Fox Mill Centre Pkwy.

FOR MORE INFORMATION, CONTACT:

CHRIS ROUZIE
Executive Vice President
757 869 2309
chris.rouzie@thalhimer.com

MATT LAFLE
Vice President
757 213 4148
matt.lafler@thalhimer.com

One BayPort Way
Suite 100
Newport News, VA 23606
thalhimer.com

Independently Owned and Operated / A Member of the Cushman & Wakefield Alliance

Cushman & Wakefield | Thalhimer © 2026. No warranty or representation, express or implied, is made to the accuracy or completeness of the information contained herein, and same is submitted subject to errors, omissions, change of price, rental or other conditions, withdrawal without notice, and to any special listing conditions imposed by the property owner(s). As applicable, we make no representation as to the condition of the property (or properties) in question.

