



# Aspen Creek Padsite

W. Tucson (E. 121st St. S) & S. Aspen (S. 145<sup>th</sup> E. Ave.), Broken Arrow, OK



## Features

- 1.515 Acre Platted Lot
- All Utilities to Site – Sewer, Water, Gas, Electric
- Stormwater Detention Completed
- Zoned Commercial Heavy (CH)/PUD 284
- Adjacent to The Shoppes at Aspen Creek
- High Growth Corridor in South Broken Arrow
- Fits +/- 8,400 SqFt Building

## OWASSOLANDTRUST

**Brian Beam, CCIM** ■ brianbeam@owassolandtrust.com  
Office: (918) 376-6536 ■ Cell: (918) 859-5584 ■ Fax: (918) 376-6836

**Bob Parker, CCIM** ■ bob.parker@owassolandtrust.com  
Office: (918) 376-6545 ■ Cell: (918) 605-5865 ■ Fax: (918) 376-6845



# W. Tucson (E. 121st St. S) & S. Aspen (S. 145<sup>th</sup> E. Ave.)

## Conceptual Site Plan

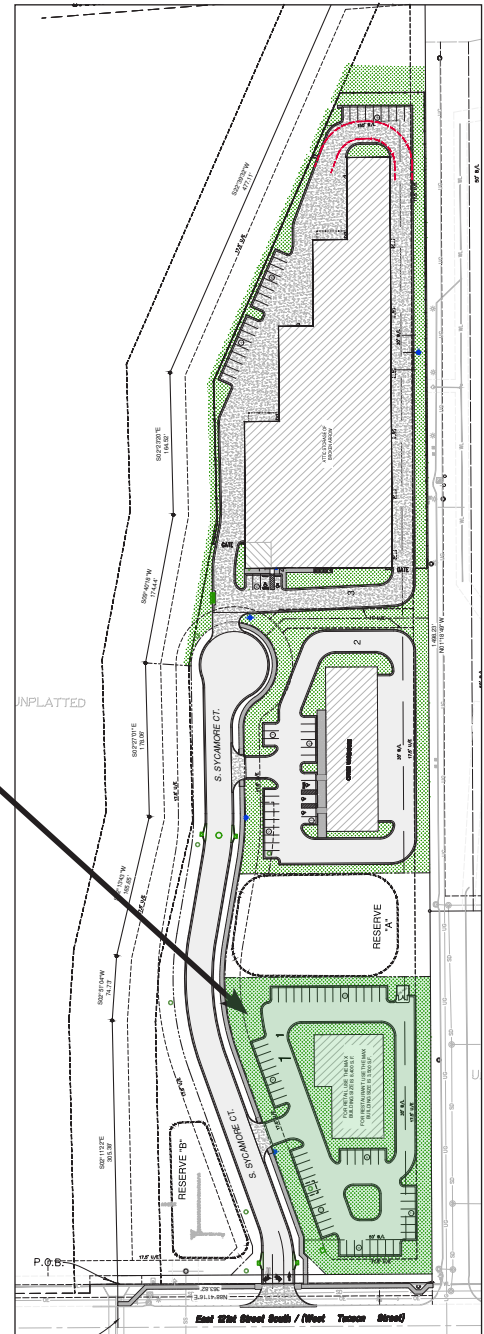
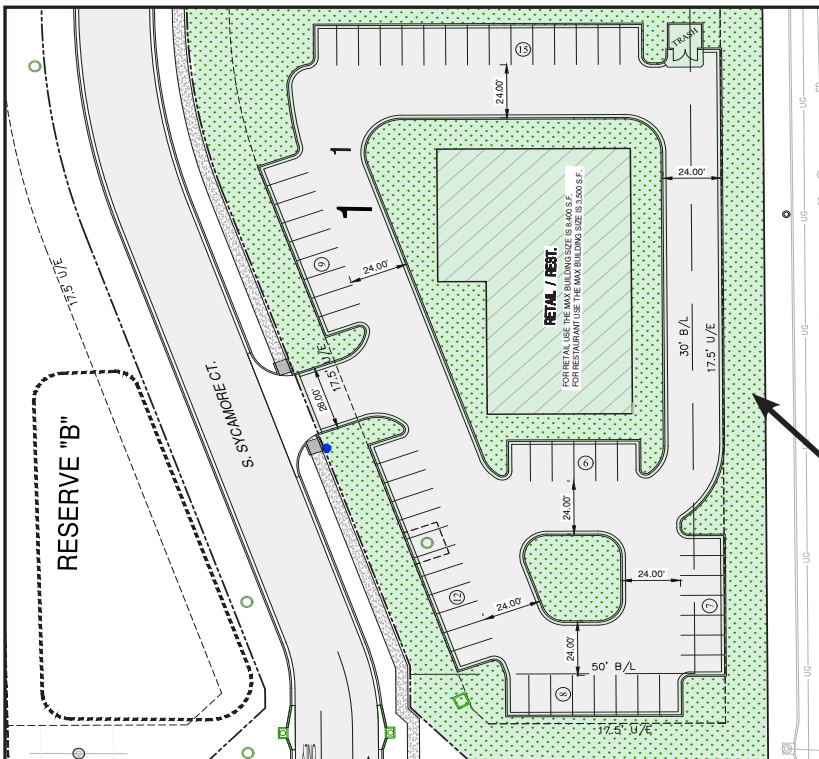

12150 E. 96th Street North  
Suite 200, Owasso, OK 74055

**Brian Beam, CCIM** ■ [brianbeam@owassolandtrust.com](mailto:brianbeam@owassolandtrust.com)  
Office: (918) 376-6536 ■ Cell: (918) 859-5584 ■ Fax: (918) 376-6836

**Bob Parker, CCIM** ■ [bob.parker@owassolandtrust.com](mailto:bob.parker@owassolandtrust.com)  
Office: 918-376-6545 ■ Cell: 918-605-5865 ■ Fax: 918-376-6845