

NEW - TO - MARKET

15620 FIGUEROA STREET, LOS ANGELES, CA 90248

GREAT OVERSIZED GROUND LEVEL DOOR BUILDING WIHT A FENCED YARD

FANTASTIC CENTRAL LOCATION NEAR THE 91, 105, 110, & 405 FWYs

AVAILABLE FOR LEASE

6,423 ± SF BUILDING

4,137 ± SF WAREHOUSE

2,286 ± SF OFFICE



PROPERTY FEATURES

- + 6,423 Square Feet of Building
- + 4,137 Square Feet of Warehouse Space
- + 2,286 Square feet of Office Space
- + 14' Clear Height
- + Oversized Ground Level Door (10' W X 12' H)
- + Fenced and Secured Yard
- + Ample Parking
- + Easy Access to the 91, 105, 110, & 405 FWYs
- + 10 Miles from LA/LB Ports
- + 10 Miles from LAX Airport



**REALTY
ADVISORY
GROUP, INC.**

EST. 1995

RAGINC.COM

JIMABBOTT, JR. (213) 892-8881 x 368 | JWABBOTT@RAGINC.COM | ID:01870203

CORPORATE HQ: 545 SOUTH FIGUEROA STREET, SUITE 1209, LOS ANGELES, CA 90071
CORPORATE ID: 01301202

Neither owner nor broker make any representations or warranties as to the accuracy or completeness of any evaluations materials, including building dimensions, any assumptions and resulting projections or that actual results will conform to any projections contained herein. Owner and broker expressly disclaim any liability for representations or warranties, expressed or implied, contained in this brochure, or in any other written, oral, or other communications transmitted or made available to prospective buyers, including and without limitation to, electronic brochures, computer disks containing files with floor plans, financial data and projections, etc.

15620 FIGUEROA STREET, LOS ANGELES, CA 90248

AVAILABLE FOR LEASE

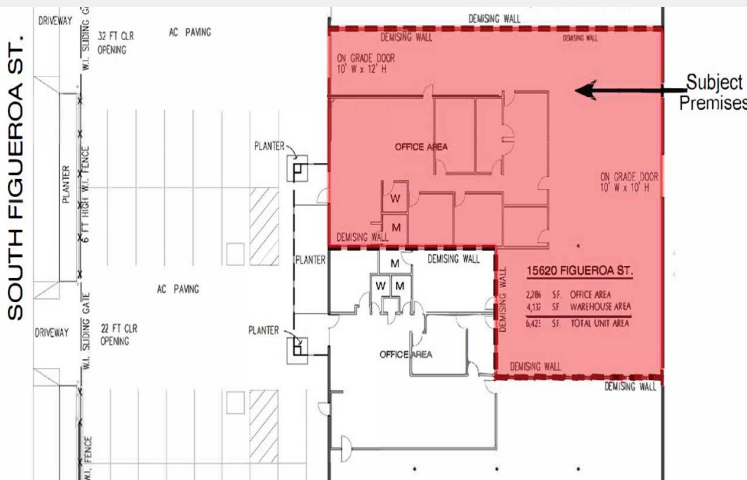
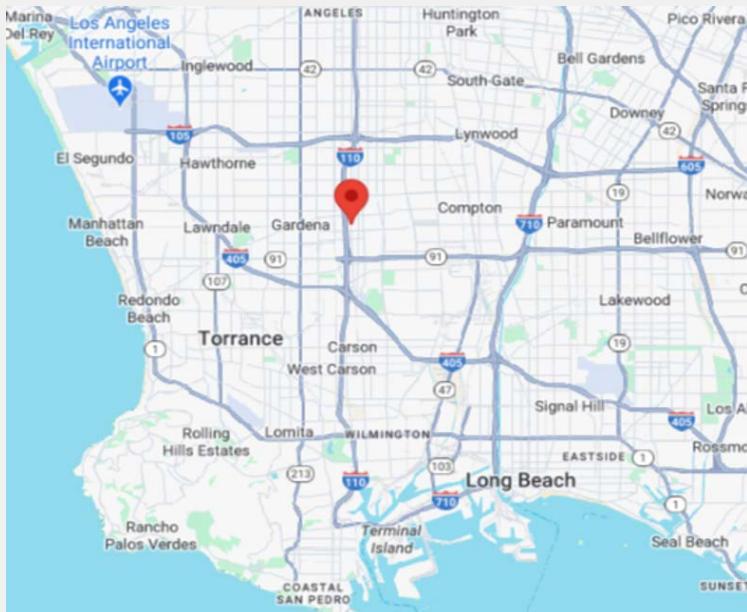

PROPERTY FEATURES

- + 6,423 SF OF BUILDING
- + 4,137 SF OF WAREHOUSE (14' CLEAR)
- + 2,286 SF OF OFFICE AREA
- + OVERSIZED GROUND LEVEL DOOR (10' W x 12' H)
- + ZONING: LCM1*
- + INDUSTRIAL PARK ENVIRONMENT WITH EXPERIENCED OWNERSHIP AND MANAGEMENT
- + ONLY ONE COLUMN
- + IMMEDIATE ACCESS TO 91/105/110/405 FWYs
- + AMPLE PARKING

CONTACT

JIM ABBOTT, JR. (213) 892-8881 x 368 | JWABBOTT@RAGINC.COM | ID:01870203



RAGINC.COM

CORPORATE HQ: 545 SOUTH FIGUEROA STREET, SUITE 1209, LOS ANGELES, CA 90071
CORPORATE ID: 01301202

Neither owner nor broker make any representations or warranties as to the accuracy or completeness of any evaluations materials, including building dimensions, any assumptions and resulting projections or that actual results will conform to any projections contained herein. Owner and broker expressly disclaim any liability for representations or warranties, expressed or implied, contained in this brochure, or in any other written, oral, or other communications transmitted or made available to prospective buyers, including and without limitation to, electronic brochures, computer disks containing files with floor plans, financial data and projections, etc.

SOUTH FIGUEROA ST.

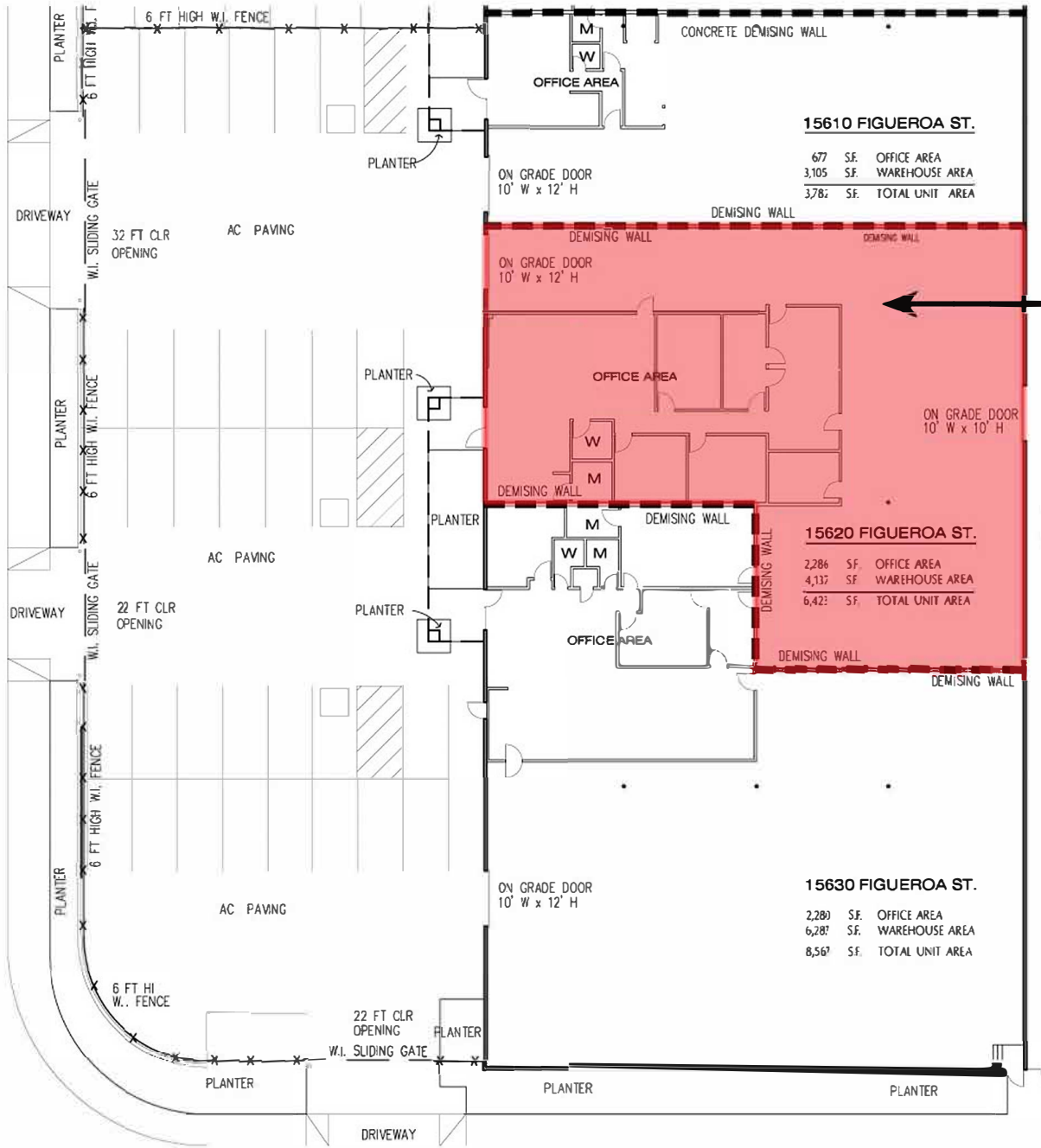

15610 FIGUEROA ST.

677	SF.	OFFICE AREA
3,105	SF.	WAREHOUSE AREA
3,782	SF.	TOTAL UNIT AREA

15620 FIGUEROA ST.

2,286	SF.	OFFICE AREA
4,137	SF.	WAREHOUSE AREA
6,423	SF.	TOTAL UNIT AREA

15630 FIGUEROA ST.

2,280	SF.	OFFICE AREA
6,287	SF.	WAREHOUSE AREA
8,567	SF.	TOTAL UNIT AREA

Subject Premises

157th STREET

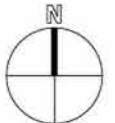

SCALE: 1" = 30'

GARDENA BUSINESS PARK - BUILDING 3

15610 - 15620 - 15630 FIGUEROA STREET - GARDENA, CALIFORNIA