

# FIVE LABS BUILDING

4115 W. Spruce St. | Tampa, FL 33607

FOR LEASE



**TMC**  
THE MAHR COMPANY

## PROPERTY DETAILS

- Prime Westshore Location
- Ample Parking & Competitive Rates
- Easy Ingress/Egress
- Less than 1 mile to International Plaza Mall
- Very close proximity to Tampa International Airport
- Great professional mix of tenants
- Convenient access to all main Roadways to Pinellas County and all points North South East and West

### 2nd Floor Available Suites:

- Suite 203: 2,381 SF
- Suite 202: 1,805 SF
- Suite 206: 3,430 SF



Interior photos are of Suite 205



**PARKING RATIO:**  
4:1,000

**RENTAL RATE:**  
\$27.50/SF  
Full Service

**LEASE TERM:**  
Negotiable  
Short Term Welcome

**BUILDING SIZE:**  
2 Stories;  
31,256 RSF

# FIVE LABS BUILDING FLOOR PLANS

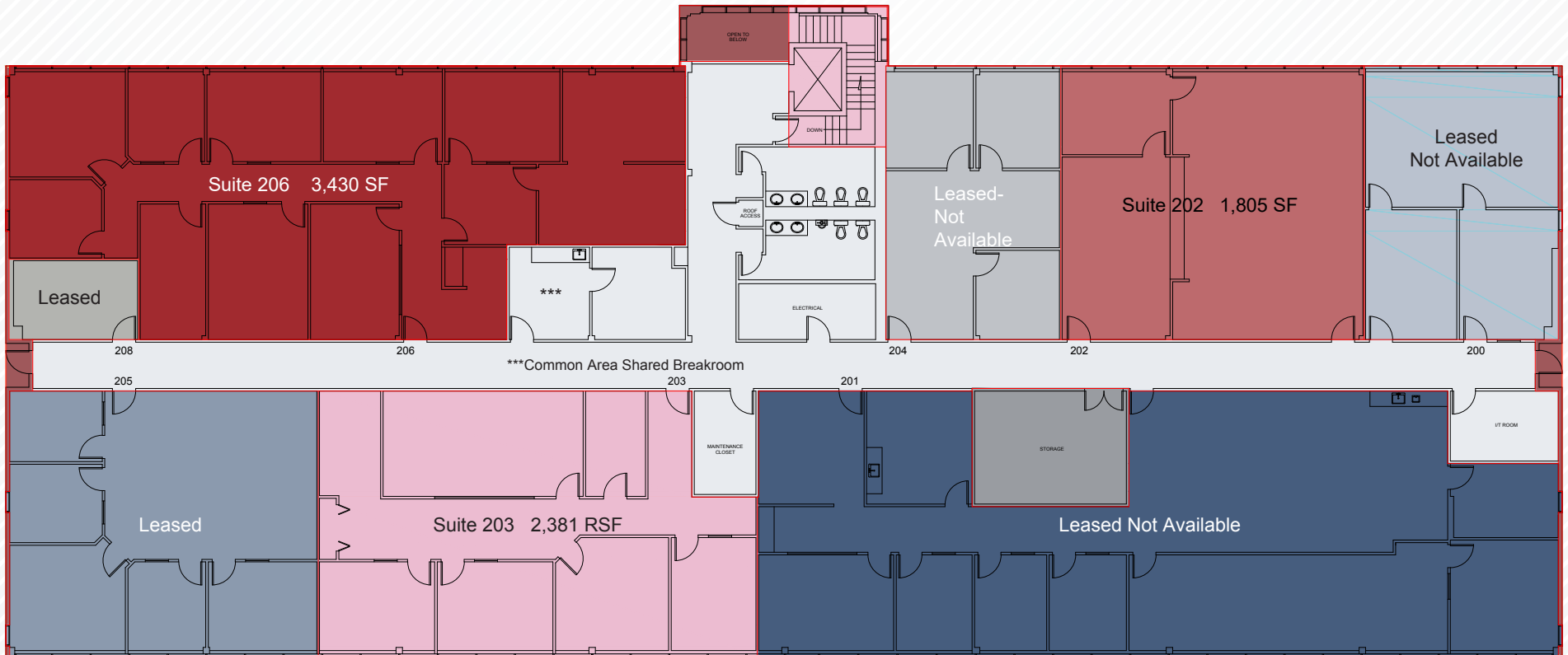

\*Not to scale

## Method A (2017) - Tenant Rentable Areas

ANSI/BOMA Z65.1 - 2017 Office Standard

- |  |   |
|--|---|
| <span style="display: inline-block; width: 15px; height: 10px; background-color: #f4a460; border: 1px solid black;"></span> -Building Service Area - 312 Square Feet | <span style="display: inline-block; width: 15px; height: 10px; background-color: #e0e0e0; border: 1px solid black;"></span> -Boundary Area - 15,453 Square Feet       |
| <span style="display: inline-block; width: 15px; height: 10px; background-color: #f0f0f0; border: 1px solid black;"></span> -Floor Service Area - 2,630 Square Feet  | <span style="display: inline-block; width: 15px; height: 10px; background-color: #808080; border: 1px solid black;"></span> -Exterior Gross Area - 15,663 Square Feet |
| <span style="display: inline-block; width: 15px; height: 10px; background-color: #d3d3d3; border: 1px solid black;"></span> -Vertical Penetrations - 230 Square Feet |   |
| <span style="display: inline-block; width: 15px; height: 10px; background-color: #c0c0c0; border: 1px solid black;"></span> -Suite 200 - 1,158 Square Feet           | <span style="display: inline-block; width: 15px; height: 10px; background-color: #4682b4; border: 1px solid black;"></span> -Suite 205 - 1,783 Square Feet            |
| <span style="display: inline-block; width: 15px; height: 10px; background-color: #4682b4; border: 1px solid black;"></span> -Suite 201 - 4,052 Square Feet           | <span style="display: inline-block; width: 15px; height: 10px; background-color: #800000; border: 1px solid black;"></span> -Suite 206 - 3,430 Square Feet            |
| <span style="display: inline-block; width: 15px; height: 10px; background-color: #800000; border: 1px solid black;"></span> -Suite 202 - 1,805 Square Feet           | <span style="display: inline-block; width: 15px; height: 10px; background-color: #a9a9a9; border: 1px solid black;"></span> -Suite 208 - 228 Square Feet              |
| <span style="display: inline-block; width: 15px; height: 10px; background-color: #ffb6c1; border: 1px solid black;"></span> -Suite 203 - 2,381 Square Feet           |   |
| <span style="display: inline-block; width: 15px; height: 10px; background-color: #a9a9a9; border: 1px solid black;"></span> -Suite 204 - 1,041 Square Feet           |   |



4950 W Kennedy Blvd.  
Suite 301  
Tampa, FL 33609  
813.835.4888

**Amy Cox**  
813.205.2427  
acox@mahrcompany.com

**Thomas Grandoff**  
813.299.0399  
tgrandoff@mahrcompany.com

[tmc-themahrcompany.com](http://tmc-themahrcompany.com)

*The material contained herein together with and including but not limited to all attachments, images, exhibits, url's, and documents is based in part upon information supplied by the owner of the property, their representative(s) or agents, and in part upon information obtained by TMC The Mahr Company from sources it deems reliable. Summaries of any documents are not intended to be comprehensive or all inclusive but rather only outlines of some of the provisions contained therein. No warranty or representation, expressed or implied, is made as to the accuracy or completeness of the information contained herein, and same is submitted subject to errors, omissions, change of price, term, rates, rental or other conditions, withdrawal without notice, unavailability of proposed space, and to any other conditions imposed by building owners, their representative(s) or agents. The recipient of this information must rely on their own due diligence, investigation, evaluation and judgment as to the advisability of this transaction.*



## PROPERTY LOCATION

4115 W Spruce St. is ideally located in the Westshore Business District. Located on W Spruce St. on the NE Corner of the intersection of W. Spruce St. & Lois Ave.

Based in Tampa Bay Florida | Statewide Emphasis | National Network