

SITE DATA

TOTAL BLDG AREA

PHASE I BLDG AREA	86,634 S.F.
PHASE II BLDG AREA	58,347 S.F.
PHASE III BLDG AREA	9,986 S.F.
TOTAL BLDG AREA	154,967 S.F.

PARKING SPACES

TOTAL PARKING REQ'D	620 SPACES
TOTAL PARKING PROVIDED	680 SPACES

NOTE:

THIS SITE PLAN IS SCHEMATIC AND IS PROVIDED TO SHOW APPROXIMATE ACREAGE AND LOCATIONS OR SIZES OF A BUILDING (OR BUILDINGS) THAT WILL FIT ON THIS SITE. CHANGES MAY BE REQUIRED ONCE A FINAL SURVEY WITH CURRENT BOUNDARIES, EASEMENTS, RIGHT-OF-WAYS AND DIMENSIONS OR AFTER FINAL ZONING REVIEW IS COMPLETED.

THE INFORMATION CONTAINED HEREIN IS BELIEVED TO BE CORRECT AND IS OBTAINED FROM SOURCES WE REGARD AS RELIABLE. WE ASSUME NO LIABILITY FOR ERRORS OR OMISSIONS HEREIN. ALL DIMENSIONS ARE APPROXIMATE.

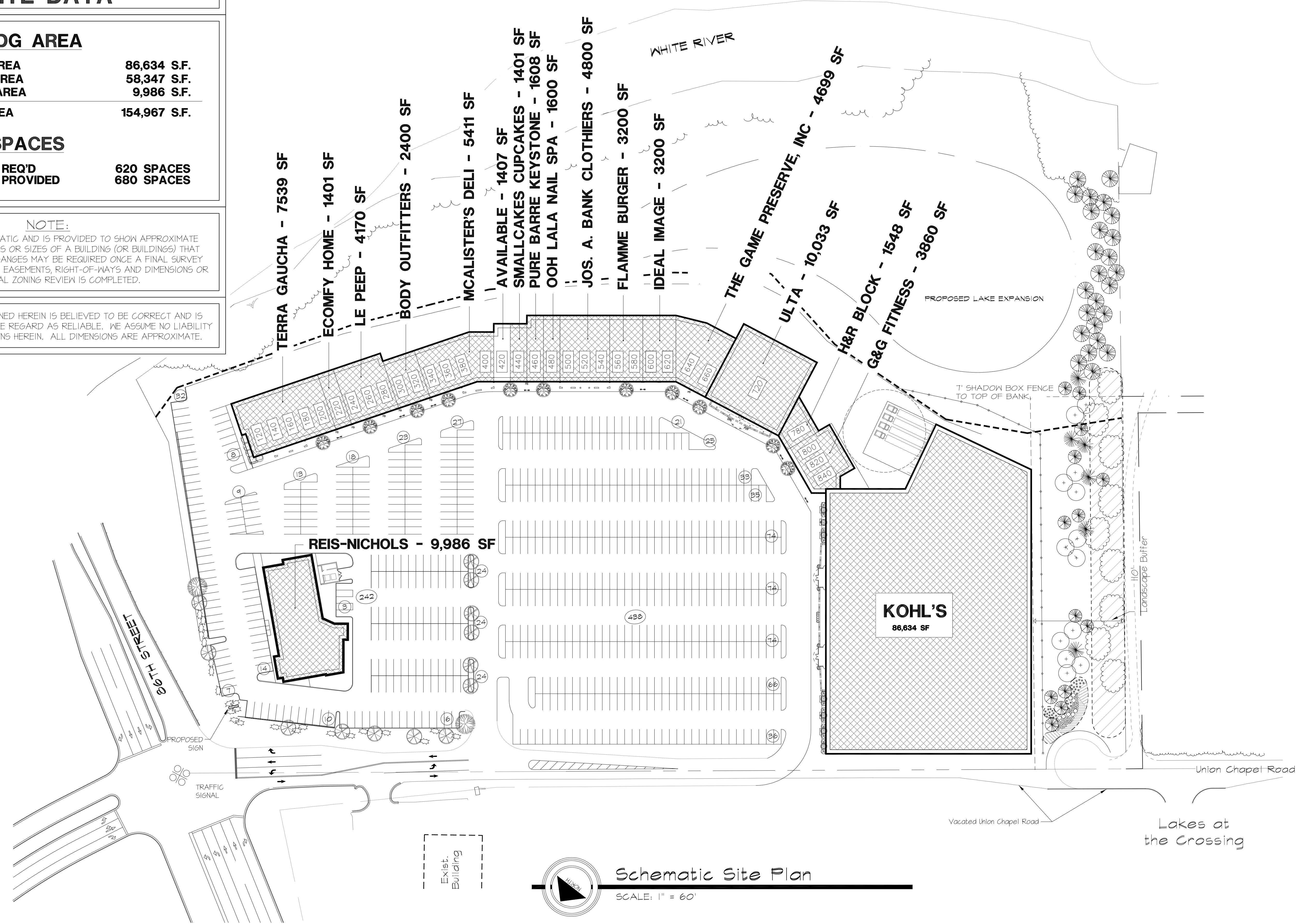

Schematic Site Plan

SCALE: 1" = 60'

LEECH ARCHITECTS, INC.
7785 E. 126TH STREET
FISHERS, INDIANA 46038
TELEPHONE 317.842.1931

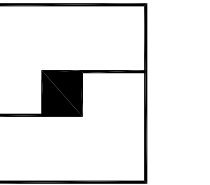

DATE

December 26, 2024

FILE - DATE - TIME	4917-94.dwg 10-22-02 1:35:04 pm EST
PLOT SCALE	DRAWN BY:
1/8" = 1'-0"	CAS

Fashion Mall Commons

8487 Union Chapel Road
SUITES 100-1060
INDIANAPOLIS, INDIANA

The Broadbent Company
17 E Washington Street, Suite 300
INDIANAPOLIS, INDIANA 46204
(317) 257-2500

Scheme #

66

PROJECT NO.
9317