



THE
KINGDOM
CARE
CENTER

"We are together"



OUR MISSION

The 11700 Building will serve as the base of operations for the Kingdom Care Center (KCC), a project of Kingdom Global Community Development Corporation (KGCDC).



Kingdom Global Community Development Corporation exists to serve, support and strengthen communities locally and globally. The KCC will be a Regional Resource Hub dedicated to improving the quality of life for children, adults and families that live in the Prince George's, Montgomery and Howard County Region. We will accomplish this mission through a multi-sector approach of public and private partnerships to address disparities that exist in health, employment, education, and economic well-being.







PRESS PLAY

OUR IMPACT

STORY





During the height of the pandemic, Kingdom Global Community Development Corporation and its founding organization, Kingdom Fellowship AME (KFAME) Church, launched

Kingdom Cares to address the food insecurity being experienced by our neighbors, families and friends. Since April 2020, Kingdom Cares has secured numerous public-private partnerships, raising over \$1.5 Million in funding. As a result, Kingdom Cares has served thousands of Prince George's and Montgomery County Maryland residents in crisis. On a mission to end Hunger in our region, Kingdom Cares has served over 180,000 households, 380,000 individuals, distributing over 4.9M pounds of food in seven locations across two counties, Prince George's and Montgomery. In addition, Kingdom Cares was selected to be the East Montgomery County Services Consolidation Hub for food, diapers, and critical community supports. Our leaders and volunteers have worked together to

distribute over 200,000 diapers and feminine hygiene products to women and children. Kingdom Cares, through collaborative partnerships, has implemented health initiatives in Prince George's and Montgomery County aimed at those living at risk for COVID, diabetes, high blood pressure, hypertension and obesity.

Each week, we continue to feed thousands of individuals and families suffering from food insecurity. This summer alone, we've distributed 327,297 of food to 19,967 households and 69,566 individuals now. Our team of over 200 active volunteers have worked diligently, giving more than 7900 service hours of their time. Kingdom Cares has continued to extend its support globally through our mission work overseas in South and West Africa through our partnership with Pastor Keith Links and Pastor Abendigo Ondoga. Our foot print in the Region includes our Community Placemaking events: Enclaves Community Day, the Kids Bike Rodeo, Stuff the Truck, National Night Out, and our very own Community Health Fair. These events bring people together and connect them to community resource partners that provide services that help make life better.

OUR COMMUNITY PARTNERS

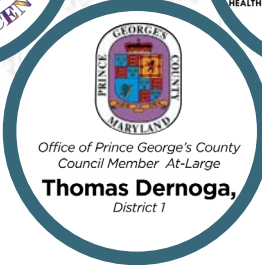
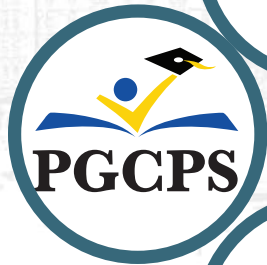

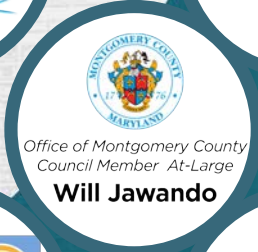

Office of Montgomery County
Council Member At-Large
Will Jawando



Office of Prince George's County
Council Member At-Large
Calvin Hawkins, II

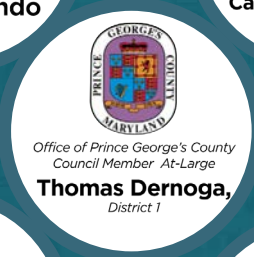

Office of Prince George's County
Council Member At-Large
Thomas Dernoga,
District 1



LEVEL 3

Healthcare
Services

LEVEL 2

Education Services
& Support

LEVEL 1

Social Services

LEVEL 6

Administrative

LEVEL 5

Economic
Empowerment

LEVEL 4

Economic Stability

THE KINGDOM CARE CENTER

BUILDING DESIGN

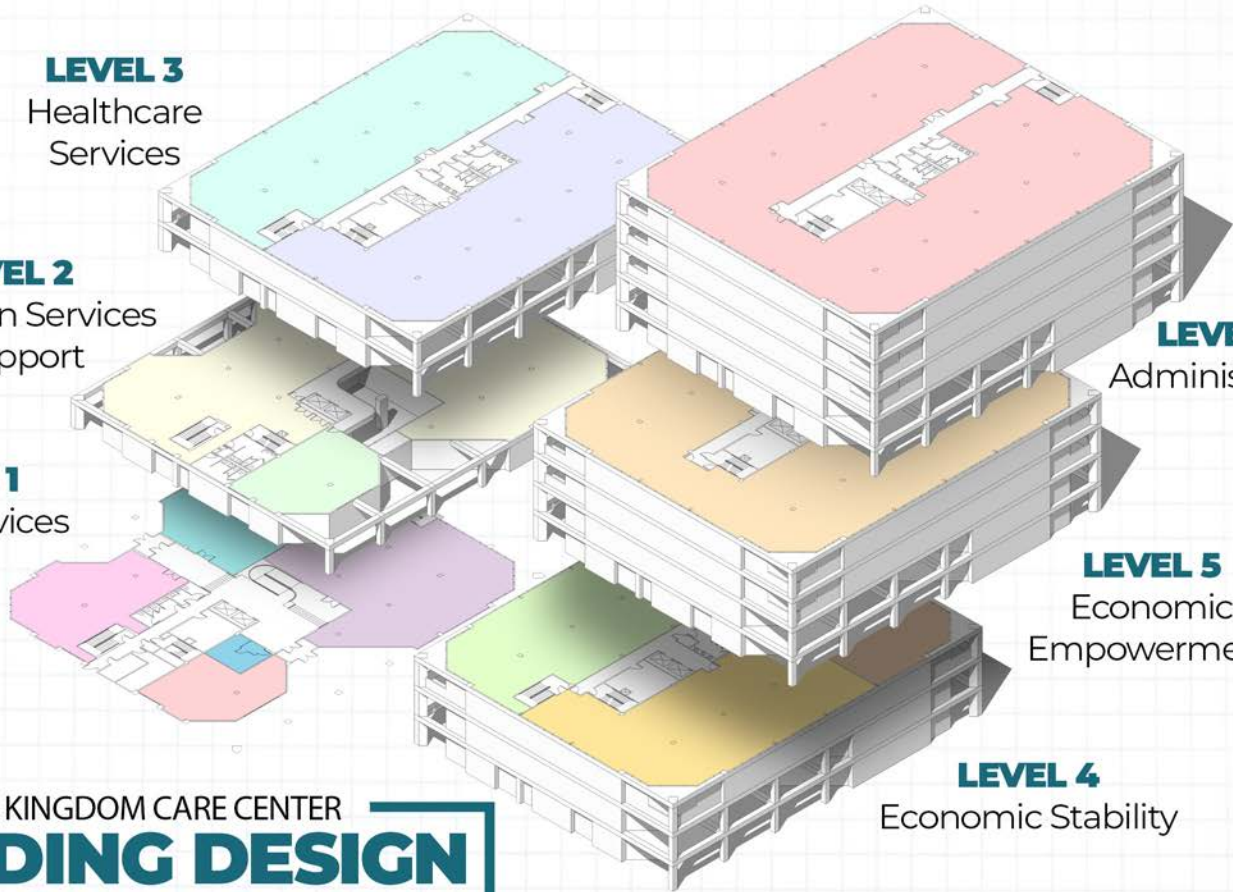

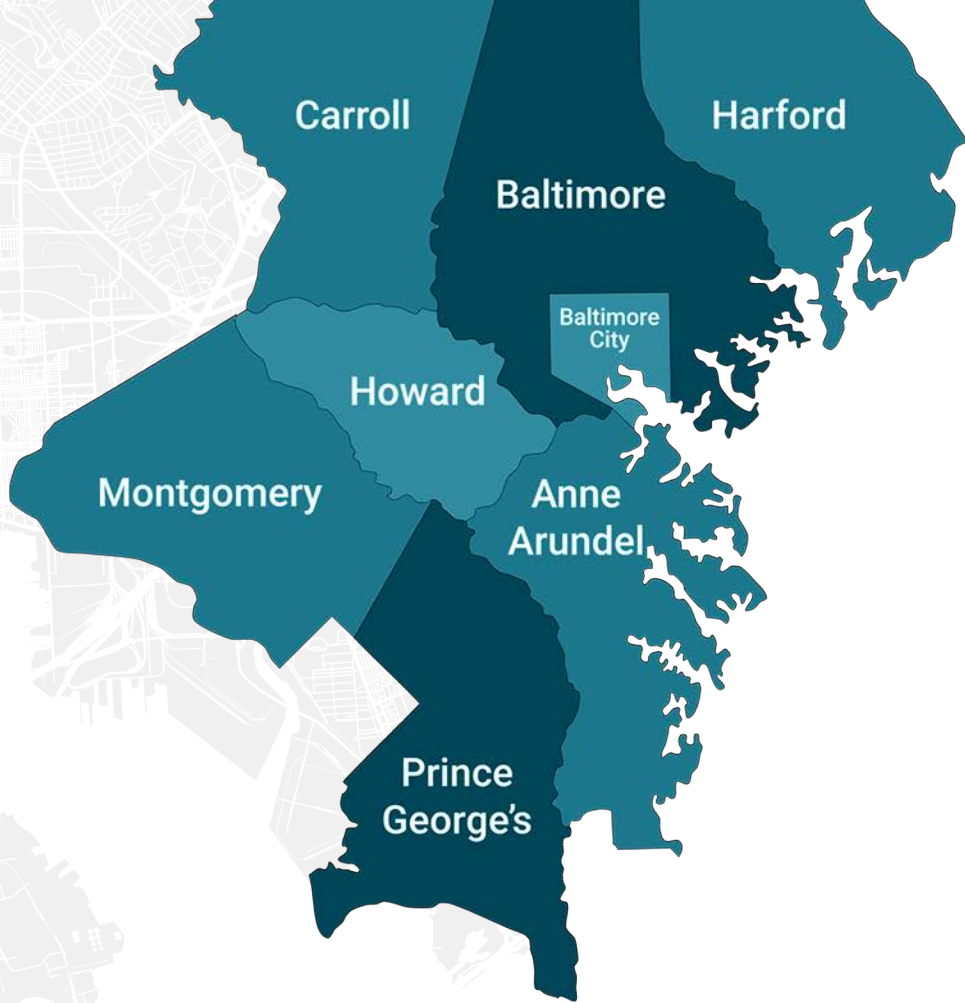

THE KINGDOM CARE CENTER

BUILDING LOCATION

**THE SITE IS
LOCATED WITHIN
A 10 MILE RADIUS
OF MONTGOMERY,
PRINCE GEORGE'S AND
HOWARD COUNTIES.**

It has an outstanding vehicular access to I-95 and is one exit from both the Washington Beltway (I-495) and the Inter-County Connector (Route 200).



Managing Partners

Kingdom Cares is committed to serving and strengthening communities through strategic partnerships. We will also be a Founding Partner operating the first and second floors with the welcome center, client choice fresh food market, clothing center and family waiting area.

Community Services & Partnerships

Kingdom Cares will partner with private, public, and faith-based entities in the Washington Metropolitan Area to create a premiere regional campus where residents living in Northern Prince George's County and Eastern Montgomery County may access critical services and support.

Operating space will be leased to Resident Partners to provide services to those living in Prince George's, Montgomery, and Howard counties.



SCOPE

- Floors 1-3 are being entirely demolished.
- The building core systems are being updated and replaced, including new elevator systems, all new HVAC systems, a new roof and painting/upgrades of the building exterior. A new two-story lobby with a connecting stair to the 2nd floor will be provided.

CONSTRUCTION SCOPE

SCOPE

- The first and second floors will include improvements for a Welcome Center, clothing store, children's playroom and a conference center.
- The first floor will also include a fresh food market, including a new loading area, storage and prep areas as well as the pantry space.



PHASE 1

PHASE 2

ESTIMATED BUDGET

\$750K PROFESSIONAL SERVICES
(Architect, Legal, Permits, Etc.)

\$12.75M BASE BUILDING & CONSTRUCTION
(Fire, Life, Safety Build-Out)

\$13.5M TOTAL BUDGET

SOURCE OF FUNDS

\$2M FEDERAL APPROPRIATION

\$11.5M STATE OF MARYLAND

\$13.5M TOTAL SOURCE OF FUNDS

\$750K POND REMOVAL

\$500K LOADING DOCK

\$3.25M FLOOR 3-4 BUILDOUT ALLOWANCE

\$325K SOFT DESIGN

\$4.15M TOTAL COST

PROJECT TEAM

**KINGDOM GLOBAL
COMMUNITY DEVELOPMENT
CORPORATION**
- OWNER

**DELON HAMPTON
ASSOCIATES**
- CIVIL ENGINEER

**LINCOLN PROPERTY
COMPANY**
- CONSTRUCTION MANAGER

GREENMAN-PEDERSEN, INC. -
MECHANICAL/ELECTRICAL
- STRUCTURAL ENGINEER

DECEDER GROUP
- ARCHITECT

**CORENIC CONSTRUCTION
GROUP, LLC**
- GENERAL CONTRACTOR

THE KINGDOM GLOBAL COMMUNITY
DEVELOPMENT CORPORATION

BOARD OF DIRECTORS

REV. MATTHEW L. WATLEY, CHAIR

JOHNINE BARNES HARLEY, VICE-CHAIR

BENJAMIN FINELY, TREASURER

STEVEN F. MYERS, SECRETARY

CARL L. CHAPMAN, SR.

MONICA HAMMOND

MICHELLE LAWRENCE JAWANDO

REV. LOXLEY O'CONNOR

REV. KENDRA M. SMITH

KIYO TYSON, ESQ.

PAUL BRATHWAITE

A LOOK INSIDE

A modern front lobby with a curved staircase, a textured wall, and a large orange armchair.

FRONT LOBBY

A second-floor interior featuring a curved wooden wall, a reception desk, and a seating area.

SECOND FLOOR





FRONT LOBBY



FRESH MARKET - WAREHOUSE



FRESH MARKET - FRONT



CLOTHING STORE





**HOW CAN YOU
SUPPORT?**

- 
- Join with us in this movement to make life better for Maryland residents by becoming a Kingdom Care Center Champion.
 - Donors who make a gift of any amount will be recognized as a Kingdom Care Center Champion. KCC Champions will be invited to a special ribbon-cutting and will be recognized for their kindness in making this new center possible.
 - Additional campaign recognition opportunities also remain. For More Information contact: Rev. Kendra M. Smith, Executive Director, Kingdom Global Community Development Corporation at **revsmith@kingdom.global**.



KINGDOM
CARES

"We are together"