



Commercial Land for Sale

SEC of HWY 141
& Beaverbrook Blvd.
Grimes, Iowa
50111

Prime Development Land for Sale in Grimes

Up to 10.39 acres of commercial land for sale in Grimes with convenient access to Highway 141 and I-80/35; located adjacent to multiple single-family and multi-family housing developments, retail, office, commercial, and hospitality.

Address SEC of HWY 141 & Beaverbrook Blvd.

Location Grimes, Iowa 50111

Size +/- 1.3 - 10.39 acres

Sale price \$10.00-\$17.00/SF

Property information

- Controlled Intersection
- Located in Grimes on the SEC of Highway 141 and NE Beaverbrook, north of Menards
- Immediately east of the 50-acre sports complex – Grimesplex (opening Fall 2023)

Aaron Hyde
Senior Vice President
JLL Des Moines
+1 515 953 8834
aaron.hyde@jll.com

Meredith Young
Vice President
JLL Des Moines
+1 515 419 2963
meredith.young@jll.com



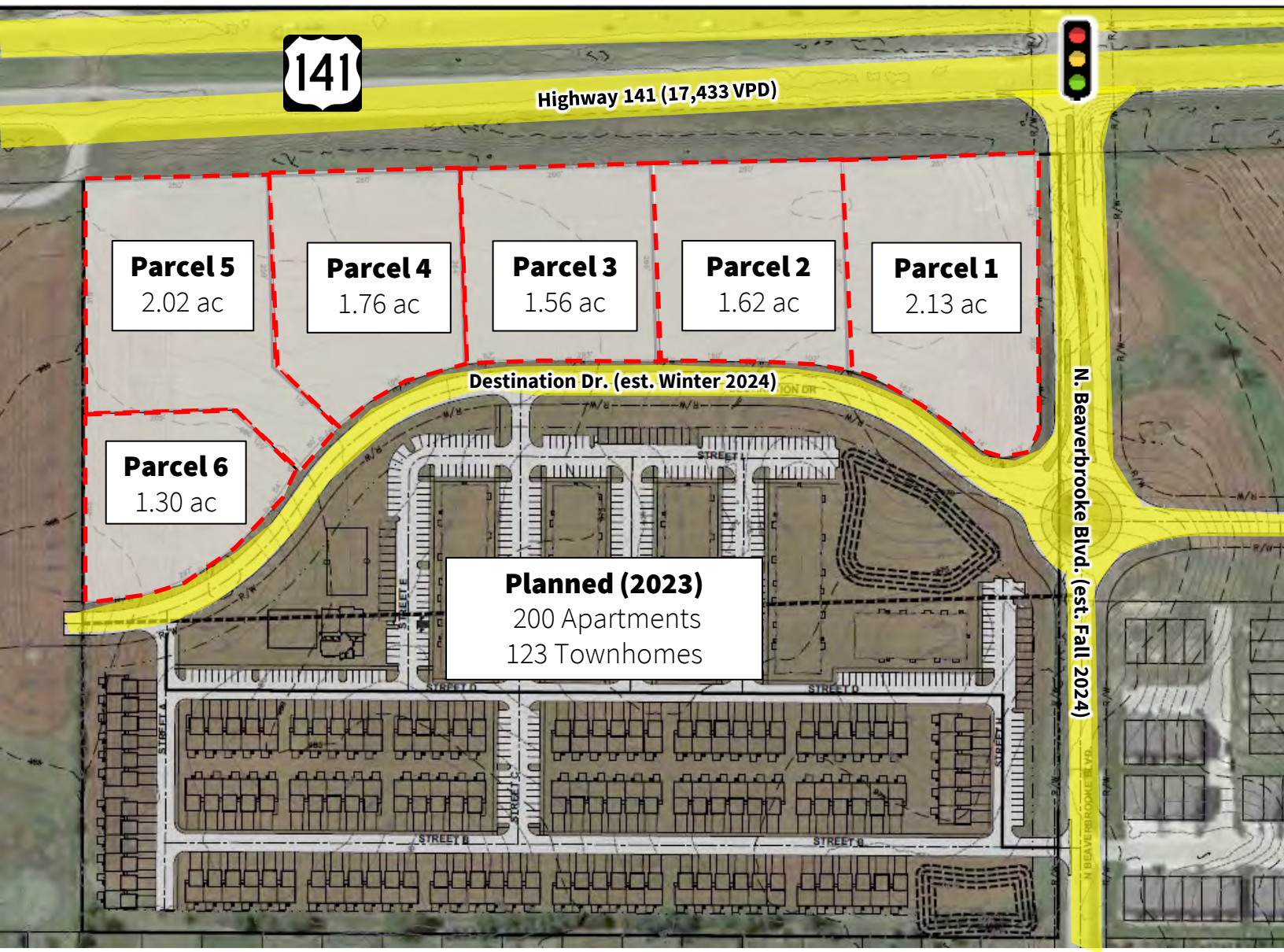

Availabilities

Parcel #	Property	Sale Price PSF
1	2.13 acres	\$17.00/SF
2	1.62 acres	\$13.00/SF
3	1.56 acres	\$13.00/SF
4	1.76 acres	\$13.00/SF
5	2.02 acres	\$12.00/SF
6	1.30 acres	\$10.00/SF

Although information has been obtained from sources deemed reliable, JLL does not make any guarantees, warranties or representations, express or implied, as to the completeness or accuracy as to the information contained herein. Any projections, opinions, assumptions or estimates used are for example only. There may be differences between projected and actual results, and those differences may be material. JLL does not accept any liability for any loss or damage suffered by any party resulting from reliance on this information. If the recipient of this information has signed a confidentiality agreement with JLL regarding this matter, this information is subject to the terms of that agreement. ©2023. Jones Lang LaSalle IP, Inc. All rights reserved.

Location



Demographics

	1 Mile	3 Miles	5 Miles
Population	5,579	29,876	67,448
Households	2,153	10,985	25,459
Average HH Income	\$108,807	\$103,934	\$103,661

Traffic counts

Highway 141	17,433 VPD
E 1 st Street	21,800 VPD
I-80/35	85,069 VPD

JLL contacts

Aaron Hyde

Senior Vice President

JLL Des Moines

+1 515 593 8834

aaron.hyde@jll.com

Meredith Young

Vice President

JLL Des Moines

+1 515 419 2963

meredith.young@jll.com

Although information has been obtained from sources deemed reliable, JLL does not make any guarantees, warranties or representations, express or implied, as to the completeness or accuracy as to the information contained herein. Any projections, opinions, assumptions or estimates used are for example only. There may be differences between projected and actual results, and those differences may be material. JLL does not accept any liability for any loss or damage suffered by any party resulting from reliance on this information. If the recipient of this information has signed a confidentiality agreement with JLL regarding this matter, this information is subject to the terms of that agreement. ©2023. Jones Lang LaSalle IP, Inc. All rights reserved.

