



For Lease

\$15/ SF, NNN
Call for details

Contact:

Mike Thomas

Senior Vice President
+1 503 807 0454
mike.thomas@colliers.com

Karen Lisignoli

Associate
+1 503 740 1679
karen.lisignoli@colliers.com



Colliers | Portland
851 SW Sixth Avenue, Suite 1600
Portland, OR 97204
P: +1 503 223 3123

Hawthorn Woods Office Park

5635 NE Elam Young Parkway, Suite 100
Hillsboro, OR 97124

Highlights

- 7,665 SF office available
- 24/7 building access
- Mix of privates and open work stations
- Multiple conference rooms
- Separate break room and work room
- Locally owned and managed
- Ample off-street parking; 3.7/1,000 ratio
- 5 minute walk to Hawthorn Farm MAX Station
- Across the street from Intel Hawthorn Farm Campus
- Near Hawthorn Farm Athletic Club
- Commercial amenities within walking distance, like Hidden Creek Park West and Orenco Station
- **Available Now**



Nicely maintained landscaping



5 minute walk to Trimet MAX light rail station



Ample parking at 3.7/1,000 SF



Close to two Intel campuses



Childcare, medical, and financial services on Elam Young Parkway



10 minute walk to Hidden Creek Park



Walkable to nearby commercial services



Close to the Hillsboro Airport



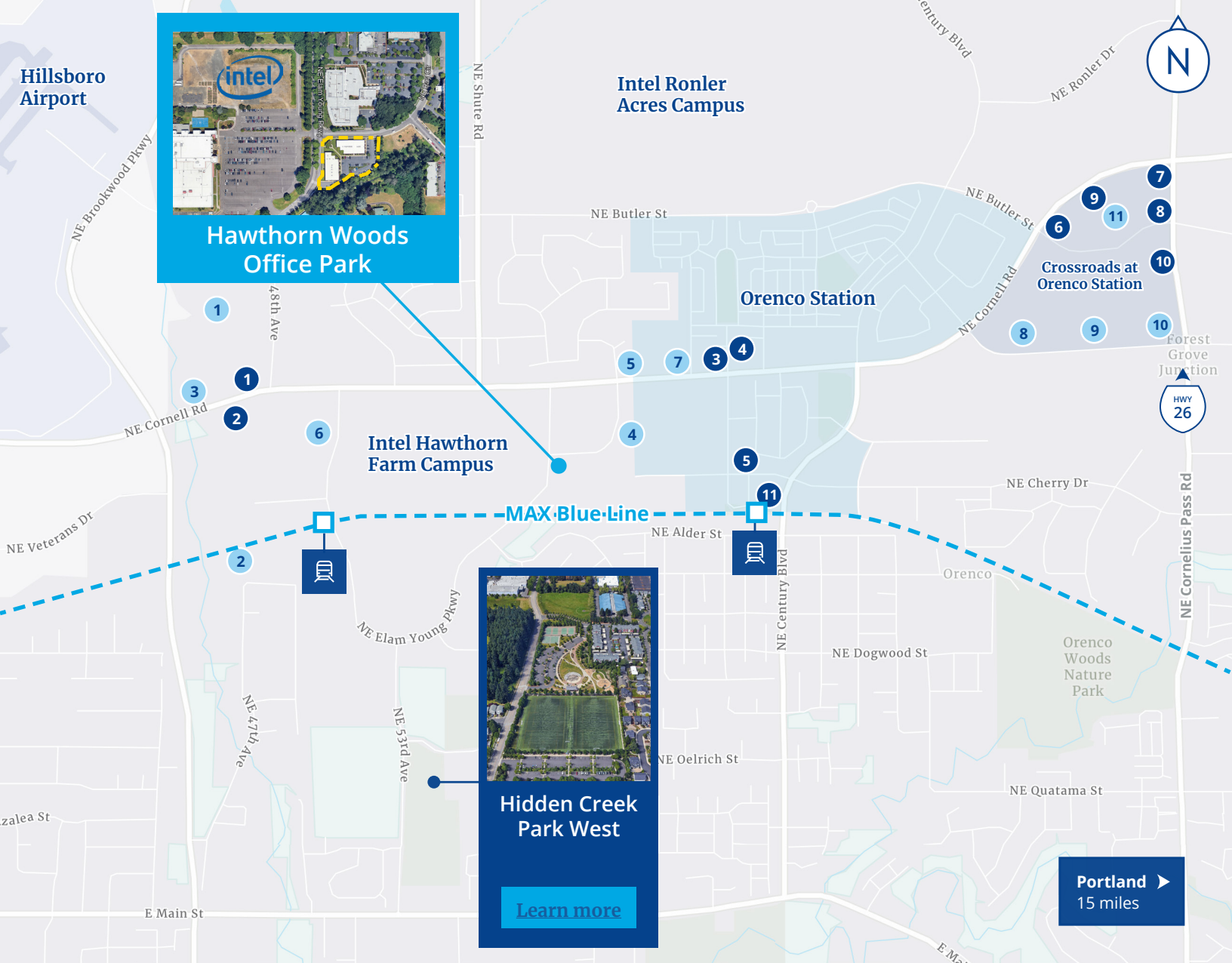

Area Amenities

- | | |
|-------------------------------------|-------------------------------|
| 1 Costco & Costco Gas Station | 1 McDonald's |
| 2 Hawthorn Farm Athletic Club & Spa | 2 Chipotle Mexican Grill |
| 3 Fedex Office | 3 Yuki Japanese |
| 4 Holiday Inn | 4 Swagat Indian Cuisine |
| 5 New Seasons | 5 Salam Persian |
| 6 La Petite Academy | 6 Panera Bread |
| 7 Hillsboro Farmers' Markets | 7 BJ's Restaurant & Brewhouse |
| 8 Walgreens | 8 Starbucks |
| 9 WinCo Foods | 9 Copper River Restaurant |
| 10 Kohl's | 10 Burger King |
| 11 SpringHill Suites by Marriott | 11 La Provence Boulangerie |

Orenco Station

High density residential, boutique retail, restaurants, personal & professional services

Crossroads at Orenco Station

Anchored retail, restaurants, banking, hotel, fuel station

Floor Plan

Available November 1, 2024:
Suite 100 - 7,665 SF

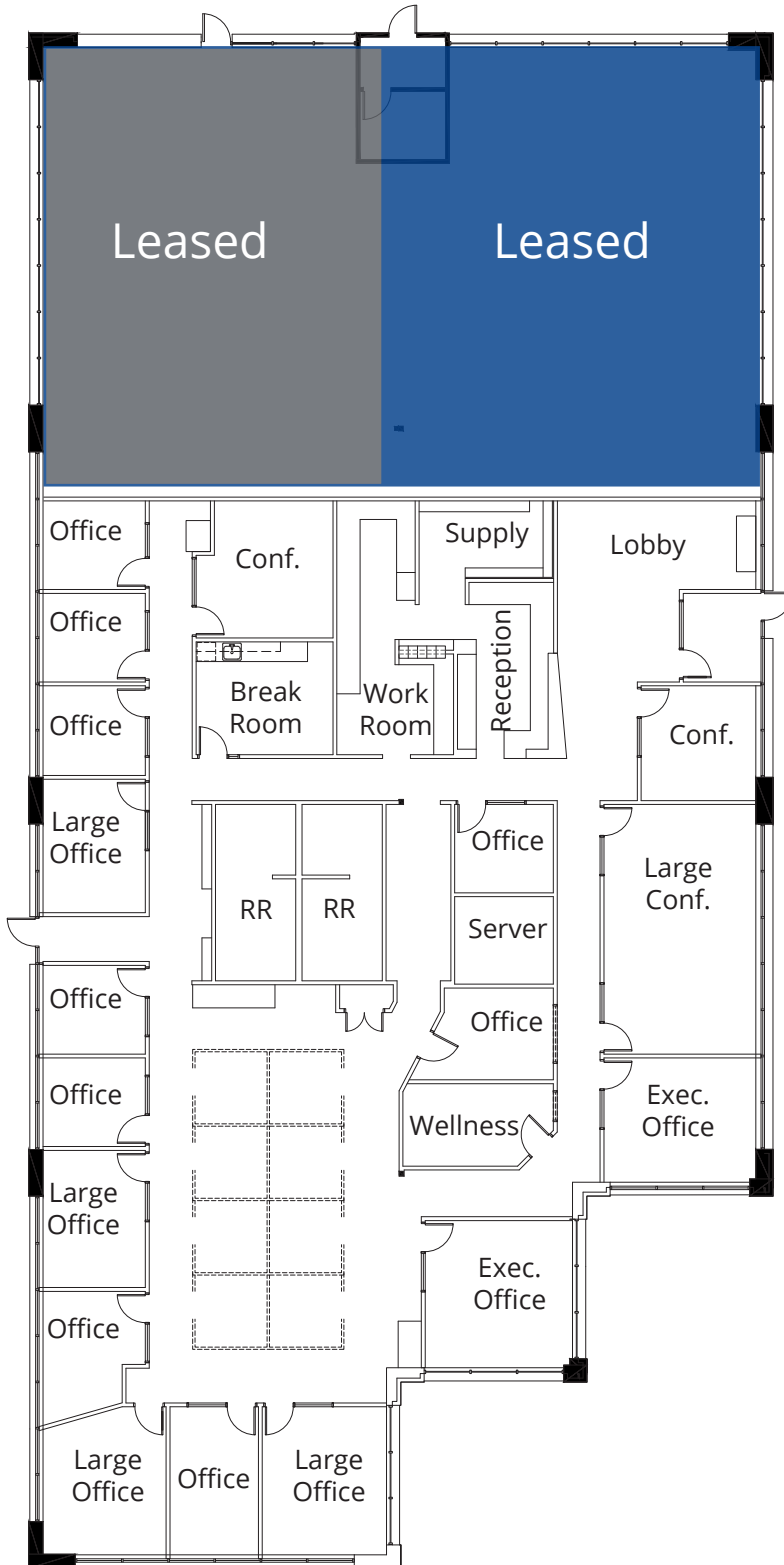

5635 NE Elam Young | Hillsboro, Oregon





Contact:

Mike Thomas

Senior Vice President
+1 503 807 0454
mike.thomas@colliers.com

Karen Lisignoli

Associate
+1 503 740 1679
karen.lisignoli@colliers.com



Colliers | Portland

851 SW Sixth Avenue, Suite 1600
Portland, OR 97204
+1 503 223 3123

Accelerating success.