

Constitution Blvd.

Mall Dr.

Milham Rd.

Crossroads Regional Mall

Burlington

To I-94

S. Westnedge Ave.







# SOUTHLAND MALL



Dunham's



Blain's FARM & FLEET



Celebration! Cinema



Marshall Music Co.

Google

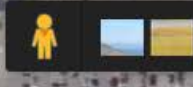

J L Hudson Dr

Ruth St

JCPenny Dr

Mall Dr

Westnedge Ave

Longview Ct

Lywood Dr

Victoria Ct

Date St

Village Green Ct

Constitution Blvd

ML King Dr

Rainbow Ave

Rainbow Ct

Independence Dr



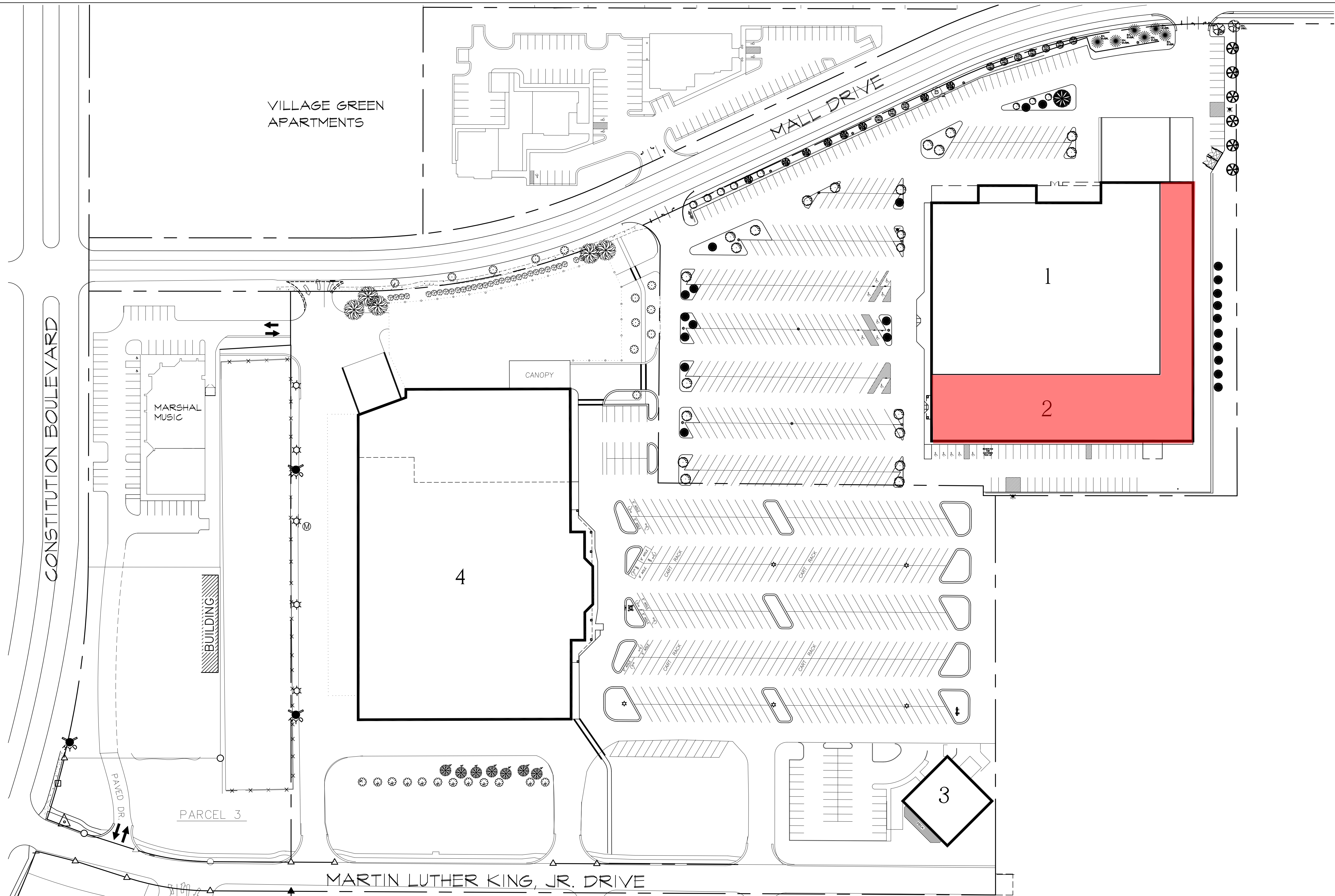

**CROSSROADS CENTRE II SITE PLAN KEY**

NO.	TENANT	FRONTAGE	S.F. AREA
1	DUNHAMS SPORTS	212'-0"	62,100
2	AMERICAN FREIGHT	82'-4"	36,136
3	THE TANGY CRAB	NOT OWNED	36,136
4	BLAINS FARM & FLEET	NOT OWNED	108,590

THE GENERAL CONTRACTOR REVIEW ALL THE CONNECTIONS BETWEEN THESE PLANS AND SPECIFICATIONS AND TO CORRECT THE DISCREPANCY IN THE REPRESENTATIVE DIMENSIONS, IF SUCH DISCREPANCIES DO NOT ARISE CORRECTLY IN THE INDICATED SIZE.

**CROSSROADS CENTRE II  
OVERALL SITE PLAN  
MALL DRIVE  
PORTAGE, MICHIGAN**

MEYER C. WEINER CO.  
700 MALL DRIVE  
PORTAGE, MICHIGAN 49782  
PHONE 269.323.2441  
FAX 269.323.3262

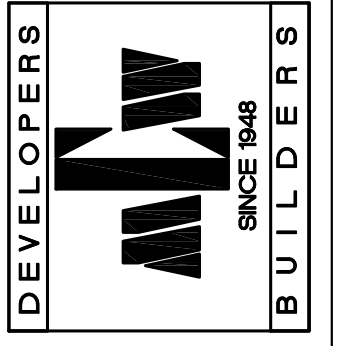

REVISIONS:

DATE: .  
PROJECT: .

**SD1.0**

**CLEAR HEIGHT: 29'**

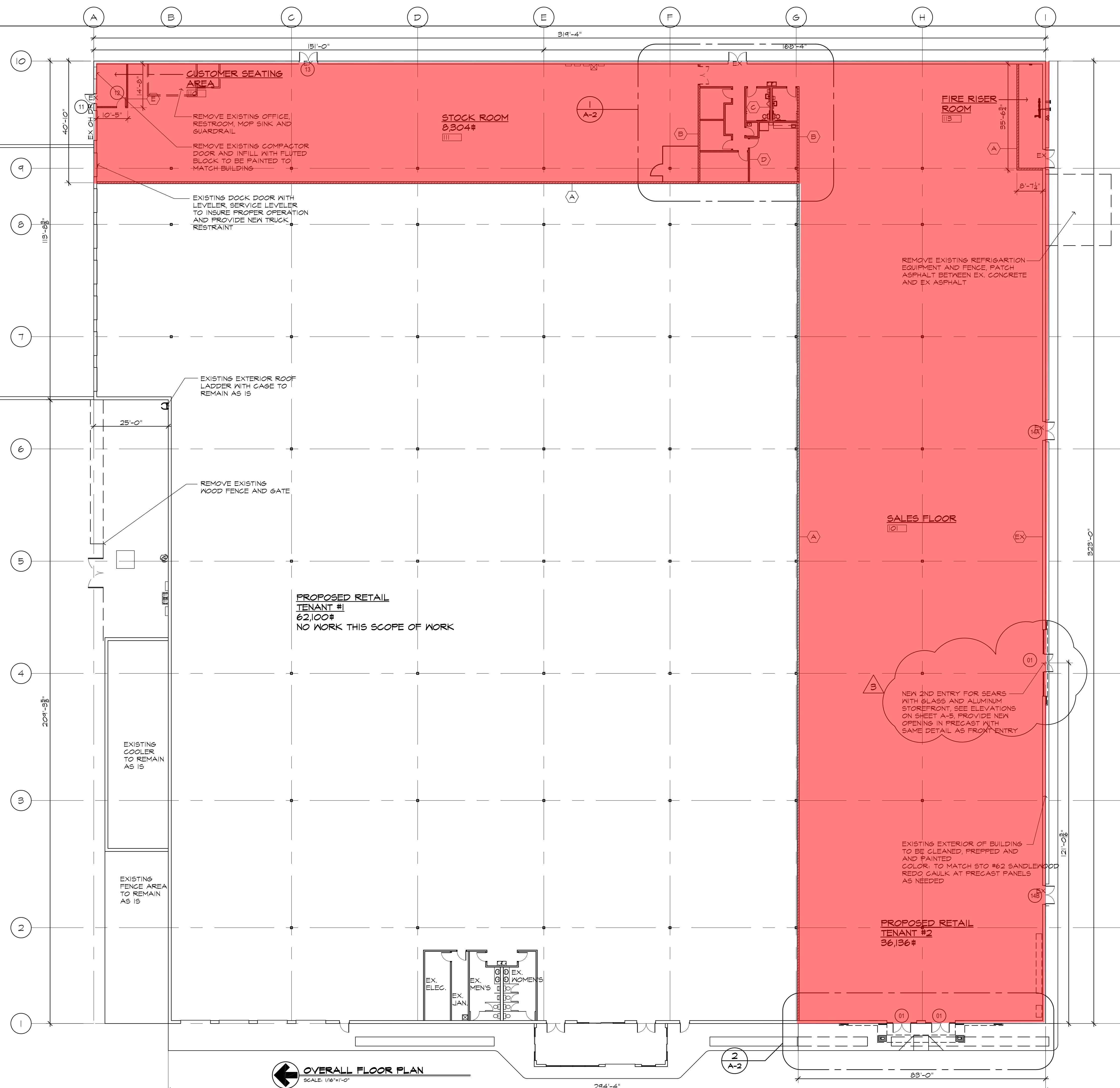

**OVERALL FLOOR PLAN**  
SCALE: 1/8"=1'-0"

**TENANT IMPROVEMENTS FOR:**  
SEARS OUTLET  
669 MALL DRIVE  
PORTAGE, MI 49024

8120 MOORSBRIDGE RD.  
PORTAGE, MICHIGAN 49024  
PHONE 269.323.3500  
FAX 269.323.3768  
DESIGN C/M BUILD

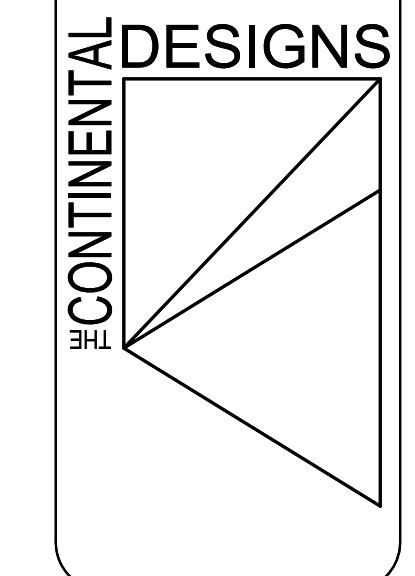

**REVISIONS:**  
REVIEW 05.21.13  
PERMITS 07.03.13  
REVISION #1 07.16.13  
REVISION #3 09.23.13

DATE: 05.09.13  
PROJECT: 1249

**A-1**

THE GENERAL CONTRACTOR AND/OR ALL SUB-CONTRACTORS SHALL BE RESPONSIBLE FOR VERIFYING ALL DIMENSIONS AND CONDITIONS OF THE EXISTING STRUCTURE. IT IS THE CONTRACTOR'S RESPONSIBILITY TO VERIFY ALL DIMENSIONS AND CONDITIONS OF THE EXISTING STRUCTURE. THE CONTRACTOR SHALL BE RESPONSIBLE FOR VERIFYING ALL DIMENSIONS AND CONDITIONS OF THE EXISTING STRUCTURE. THE CONTRACTOR SHALL BE RESPONSIBLE FOR VERIFYING ALL DIMENSIONS AND CONDITIONS OF THE EXISTING STRUCTURE.