



Riverside County Parcel Report

APN(s):280270023

DISCLAIMER

Maps, permit information and data are to be used for reference purposes only. Map features are approximate, and are not necessarily accurate to surveying or engineering standards. The County of Riverside makes no warranty or guarantee as to the content (the source is often third party), accuracy, timeliness, or completeness of any of the data provided, and assumes no legal responsibility for the information contained on this map. Any use of this product with respect to accuracy and precision shall be the sole responsibility of the user.

MAPS/IMAGES

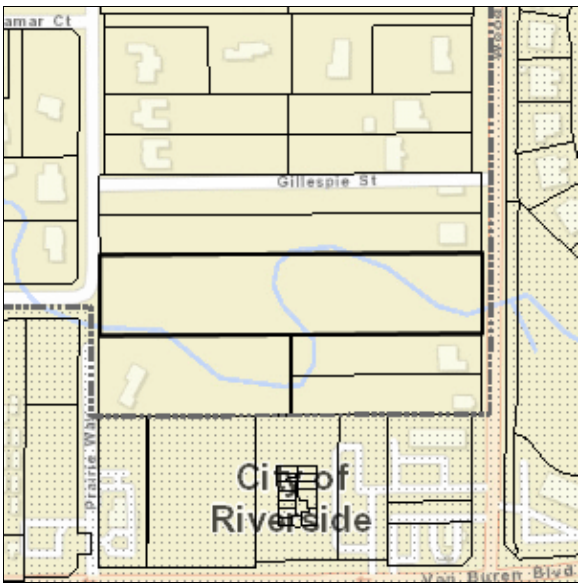

PARCEL

APN	280-270-023-2	Supervisory District	Boundaries for Districts 2, 4 and 5 will be updated in January, 2023. Boundaries for Districts 1 and 3 will be updated in January, 2025. KEVIN JEFFRIES, DISTRICT 1
Previous APN	280270023 113300304,113300305,113300306,113300308,11, more	Township/Range	T3SR4W SEC 19 SE
Owner Name	NOT AVAILABLE ONLINE	Elevation	1612 ft
Address		Thomas Bros. Map Page/Grid	PAGE: 746, GRID: D3
Mailing Address	280270023 2848 DATE ST APT 303 HONOLULU HI 96816	Indian Tribal Land	NOT IN A TRIBAL LAND
Legal Description	280270023 Recorded Book/Page: MB 12/80 Subdivision Name: OLIVE GROVE PARK NO 2 Lot/Parcel: 11 Block: Tract Number:	City Boundary	NOT IN A CITY
		City Spheres of influence	RIVERSIDE

Lot Size	280270023 Recorded lot size is 3.93 acres	March Joint Powers Authority	NOT IN THE JURISDICTION OF THE MARCH JOINT POWERS AUTHORITY
Property Characteristics	280270023 Year Constructed: Baths: Bedrooms: Construction Type: Garage Type: Property Area (sq ft): Roof Type: Stories: Pool: NO Central Cool: NO Central Heat: NO	County Service Area	NOT IN A COUNTY SERVICE AREA
Annexation Date	N/A	LAFCO Case	N/A
Proposals	N/A		

PLANNING more...			
Specific Plans	NOT IN A SPECIFIC PLAN	Historic Preservation Districts	NOT IN A HISTORIC PRESERVATION DISTRICT
Land Use Designations	RC-VLDR	Agricultural Preserve	NOT IN AN AGRICULTURAL PRESERVE
General Plan Policy Overlays	N/A		
Area Plan (RCIP)	Lake Mathews / Woodcrest	Airport Influence Areas	MARCH AIR RESERVE BASE
General Plan Policy Areas	NOT IN A GENERAL PLAN POLICY AREA	Airport Compatibility Zones	MARCH AIR RESERVE BASE, ZONE D
Zoning Classifications (ORD. 348)	A-1-1 W-2-M-1	Zoning Districts and Zoning Areas	WOODCREST DIST
Zoning Overlays	NOT IN A ZONING OVERLAY	Community Advisory Councils	WOODCREST MAC
Enviromental Justice Communities	NOT IN AN ENVIRONMENTAL JUSTICE COMMUNITY		
Residential Permit Stats			
N/A			

ENVIRONMENTAL more...			
CVMSHCP (Coachella Valley Multi-Species Habitat Conservation Plan) Plan Area	NOT IN A COACHELLA VALLEY MSHCP FEE AREA	WRMSHCP (Western Riverside County Multi-Species Habitat Conservation Plan) Cell Group	NOT IN A CELL GROUP
CVMSHCP (Coachella Valley Multi-Species Habitat Conservation Plan) Conservation Area	NOT COACHELLA VALLEY CONSERVATION AREA	WRMSHCP Cell Number	NOT IN A CELL NUMBER
CVMSHCP Fluvial Sand Transport Special Provision Areas	NOT IN A FLUVIAL SAND TRANSPORT SPECIAL PROVISION AREA	HANS/ERP (Habitat Acquisition and Negotiation Strategy/Expedited Review Process)	NOT IN A HANS/ERP PROJECT
WRMSHCP (Western Riverside County Multi-Species Habitat Conservation Plan) Plan Area	WESTERN RIVERSIDE COUNTY	Vegetation (2005)	URBAN INTERFACE MAPPING UNIT URBAN OR DEVELOPMENT MAPPING UNIT WILLOW MAPPING UNIT

Fire			
Fire Hazard Classification (Ord. 787)	NOT IN A FIRE HAZARD ZONE	Fire Responsibility Area	NOT IN A FIRE RESPONSIBILITY AREA

DEVELOPMENT FEES

CVMSHCP (Coachella Valley Multi-Species Habitat Conservation Plan) Fee Area (Ord 875)	NOT IN A COACHELLA VALLEY MSHCP FEE AREA	RBBD (Road & Bridge Benefit District)	NOT IN A ROAD BRIDGE BENEFIT DISTRICT
WRMSHCP (Western Riverside County Multi-Species Habitat Conservation Plan) Fee Area (Ord. 810)	WESTERN RIVERSIDE COUNTY	DIF (Development Impact Fee Area Ord. 659)	LAKE MATHEWS, AREA 7
Western TUMF (Transportation Uniform Mitigation Fee Ord. 824)	IN OR PARTIALLY WITHIN A TUMF FEE AREA	SKR Fee Area (Stephenâ€™s Kagaroo Rat Ord. 663.10)	IN OR PARTIALLY WITHIN THE SKR FEE AREA
Eastern TUMF (Transportation Uniform Mitigation Fee Ord. 673)	NOT IN THE EASTERN TUMF FEE AREA	DA (Development Agreements)	NOT IN A DEVELOPMENT AGREEMENT

TRANSPORTATION more...

Circulation Element Ultimate Right-of-Way	IN OR PARTIALLY WITHIN A CIRCULATION ELEMENT RIGHT-OF-WAY	Road Book Page	53
		Transportation Agreements	NOT IN A TRANS AGREEMENT
		CETAP (Community and Environmental Transportation Acceptability Process) Corridors	NOT IN A CETAP CORRIDOR

HYDROLOGY

Flood Plan Review	*MAYBE REQUIRED, CONTACT RIVERSIDE COUNTY FLOOD CONTROL TO VERIFY	Watershed	SANTA ANA RIVER
Water District	WESTERN MUNICIPAL WATER DISTRICT		
Flood Control District	RIVERSIDE COUNTY FLOOD CONTROL DISTRICT		

GEOLOGIC

Fault Zone	NOT IN A FAULT ZONE	Paleontological Sensitivity	LOW POTENTIAL (L): FOLLOWING A LITERATURE SEARCH, RECORDS CHECK AND A FIELD SURVEY, AREAS MAY BE DETERMINED BY A QUALIFIED VERTEBRATE PALEONTOLOGIST AS HAVING LOW POTENTIAL FOR CONTAINING SIGNIFICANT PALEONTOLOGICAL RESOURCES SUBJECT TO ADVERSE IMPACTS.
Faults	NOT IN A FAULT LINE		
Liquefaction Potential	NOT IN A LIQUEFACTION AREA		
Subsidence	NOT IN A SUBSIDENCE AREA		

MISCELLANEOUS

School District	RIVERSIDE UNIFIED
Communities	WOODCREST
Lighting (Ord. 655)	NOT IN A PALOMAR OBSERVATORY ZONE
Census Tract	420.05
Farmland	URBAN-BUILT UP LAND
Special Notes	NO SPECIAL NOTES
Tax Rate Areas	088007 - CO FREE LIBRARY 088007 - CO STRUCTURE FIRE PROTECTION 088007 - CO WASTE RESOURCE MGMT DIST 088007 - CSA 152 088007 - FLOOD CONTROL ADMIN 088007 - FLOOD CONTROL ZN 2 088007 - GENERAL 088007 - GENERAL PURPOSE 088007 - MWD WEST 1302999

088007 - NW MOSQUITO & VECTOR CNTL DIST
088007 - RIV CO REGIONAL PARK & OPEN SP
088007 - RIV CORONA RESOURCE CONSERVATION
088007 - RIVERSIDE CITY COMMUNITY COLLEGE
088007 - RIVERSIDE CO OFC OF EDUCATION
088007 - RIVERSIDE UNIFIED SCHOOL
088007 - SO. CALIF,JT(19,30,33,36,37,56)
088007 - WESTERN MUNICIPAL WATER
088007 - WMWD IMP DIST 1

Department of Enviromental Health Permits				
Septic Permits				
Record Id	Application Date	Plan Check Approved Date	Final Inspection Date	Approved Date
N/A	N/A	N/A	N/A	N/A
Well Water Permits				
Record Id	PE	Permit Paid Date	Permit Approved Date	Well Finaled Date
N/A	N/A	N/A	N/A	N/A
PLUS PERMITS & CASES				
Administrative Cases				
Case		Case Description		Status
N/A	N/A			N/A
Building and Safety Cases				
Case		Case Description		Status
N/A	N/A			N/A
Code Cases				
Case		Case Description		Status
N/A	N/A			N/A
Fire Cases				
Case		Case Description		Status
FHAZ0005602				Closed - Verified Non-Billable
FHAZ0109929				Closed - Verified Non-Billable
FHAZ0207879				Closed - Verified Non-Billable
FHAZ0309411				Closed - Verified Non-Billable
FHAZ0506325				Closed - Verified Non-Billable
FHAZ0601179				Closed - Verified Non-Billable
FHAZ0706966				Closed - Verified Non-Billable
FHAZ0801870				Closed - Verified Non-Billable

FHAZ1006685	Closed - Verified Non-Billable
FHAZ1206781	Closed - Verified Non-Billable
FHAZ1305298	Closed - Verified Non-Billable
FHAZ1407565	Closed - Verified Non-Billable
FHAZ1505467	Closed - Verified Non-Billable
FHAZ1511088	Closed - Verified Non-Billable
FHAZ1608900	Closed - Verified Non-Billable
FHAZ1707579	Closed - Verified Non-Billable
FHAZ1806783	Closed - Verified Non-Billable
FHAZ1905015	Closed-Verified Billable
FHAZ9101402	Closed - Verified Non-Billable
FHAZ9500487	Closed - Verified Non-Billable
FHAZ9604177	Closed - Verified Non-Billable
FHAZ9700623	Closed - Verified Non-Billable
FHAZ9800229	Closed - Verified Non-Billable

Planning Cases

Case	Case Description	Status
N/A	N/A	N/A

Survey Cases

Case	Case Description	Status
N/A	N/A	N/A

Transportation Cases

Case	Case Description	Status
IP990091	MS3763 CITY RIV/CO RIV-WOOD RD N VAN BUREN S JFK	COMPLETED