



S U B L E A S E



**Boston
Children's
Hospital**

2,886 SF SHELL SPACE
available IMMEDIATELY

500 FAUNCE CORNER | NORTH DARTMOUTH, MA



2,886 SF of SHELL SPACE available
for **SUBLEASE**
from **BOSTON CHILDREN'S**



LOCATION
Junction of I-95 and Rt. 140

PARKING
5.0 / 1,000 SF

GAS
Eversource

ELECTRIC
Eversource

WATER
Town of North Dartmouth

CURRENT CONDITION
Shell

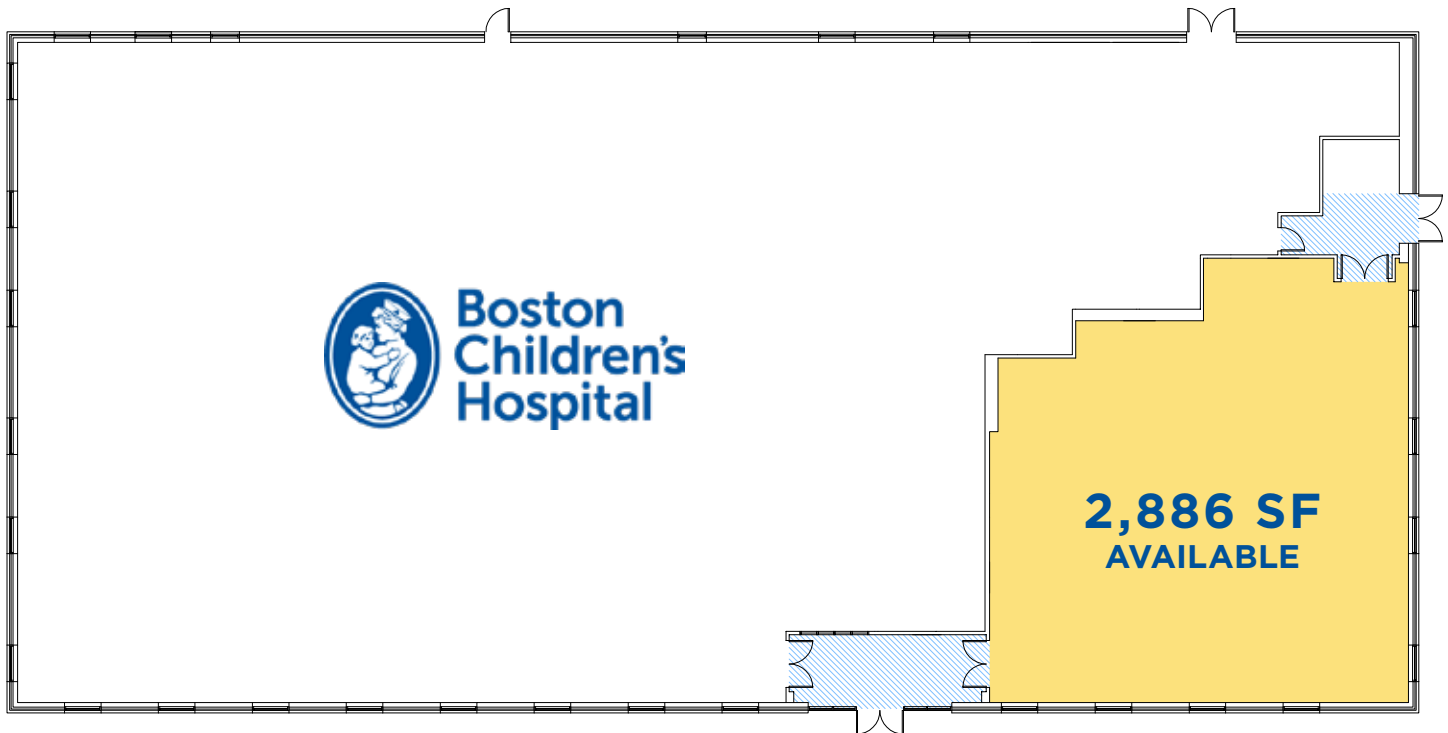

225 Franklin Street, 33rd Floor
Boston, MA 02110

FRANK NELSON
Executive Managing Director
617.863.8617
fnelson@ngkf.com

MIKE GREELEY
Managing Director
617.863.8618
mgreeley@ngkf.com

BLAKE MCLAUGHLIN
Director
617.863.8543
bmclaughlin@ngkf.com