



Earn 10% broker commission in Raleigh.



**One Bank of America Plaza**

421 Fayetteville Street | Suite 1100 | Raleigh, NC 27601

## Opening September 23

The One Bank of America business center offers spectacular views and a standout location in Raleigh's central business district. Situated on the 11th-floor of a class-A downtown office property, the business center is surrounded by numerous off-site facilities and overlooks City Plaza. It is within walking distance of a convention center, the Progress Energy Center for the Performing Arts, Wake County Justice Center, and is within 20 miles of Research Triangle Park. The business center has on-site parking and several parking lots adjacent to the building. Raleigh, North Carolina's capital city, is known for its proximity to several major universities and colleges. Raleigh is well-placed geographically as a gateway to commercial markets throughout the state and beyond.

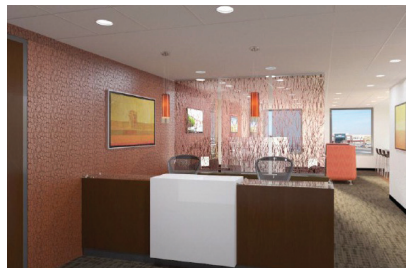

### Commission Sample 1

1 exterior office

Client pays \$1,330 a month

Total commission  
(12-month term) = \$1,560

### Commission Sample 2

3-4 person exterior office with view

Client pays \$2,590 a month

Total commission  
(12-month term) = \$3,108

**Interiors starting at \$540**

**Exteriors starting at \$830**

Contact Kacey Starzyk at 919-904-9766 or e-mail [kacey.starzyk@regus.com](mailto:kacey.starzyk@regus.com).

Offers subject to availability. Services available on an a la carte basis. 10% commission on new agreements up to 12 months. Samples reflect current free rent promotion. Two months free on 12-month term.

1500 locations | 600 cities | 100 countries