

2181 E. WALTON BLVD.
AUBURN HILLS, MICHIGAN



**SIGNATURE
ASSOCIATES**
KNOW SIGNATURE | KNOW RESULTS

INDUSTRIAL/OFFICE FOR LEASE
2,250 – 4,500 Square Feet Available



PROPERTY FEATURES

- 4,500 square feet available for lease
 - First floor: 2,250 square foot office suite with existing floor plan available for lease
 - Second floor 2,250 square foot office suite with open floor plan available for lease
- Suites can be leased separately
- Immediate access to I-75
- Tenant improvement allowance to be determined on case-by-case basis
- Private suite bathrooms
- Monument and building signage available
- Warehouse/storage space could also be made available to a tenant – 22' clear height
- Possible sale of entire 24,500 square foot building



For more information, please contact:

KRIS PAWLOWSKI
(248) 359 3801
kpawlowski@signatureassociates.com

DAN MORROW
(248) 799 3144
dmorrow@signatureassociates.com

SIGNATURE ASSOCIATES
One Towne Square, Suite 1200
Southfield, MI 48076
www.signatureassociates.com

2181 E. Walton Blvd. – Auburn Hills, Michigan

Industrial/Office For Lease

2,250 - 4,500
Square Feet
AVAILABLE

First Floor

2,250 square foot office suite available for lease (suite 200)



For more information, please contact:

KRIS PAWLOWSKI
(248) 359 3801
kpawlowski@signatureassociates.com

DAN MORROW
(248) 799 3144
dmorrow@signatureassociates.com

SIGNATURE ASSOCIATES
One Towne Square, Suite 1200
Southfield, MI 48076
www.signatureassociates.com

2181 E. Walton Blvd. – Auburn Hills, Michigan

Industrial/Office For Lease

2,250 - 4,500
Square Feet
AVAILABLE

Second Floor

2,250 square foot office suite available for lease (suite 400)



For more information, please contact:

KRIS PAWLOWSKI
(248) 359 3801
kpawlowski@signatureassociates.com

DAN MORROW
(248) 799 3144
dmorrow@signatureassociates.com

SIGNATURE ASSOCIATES
One Towne Square, Suite 1200
Southfield, MI 48076
www.signatureassociates.com

2181 E. Walton Blvd. – Auburn Hills, Michigan

Industrial/Office For Lease

2,250 - 4,500
Square Feet
AVAILABLE

Site Plan

AVAILABILITY		
UNIT	TOTAL SF	RATE
1 st Floor Suite	2,250	\$12.00 G+E
2 nd Floor Suite	2,250	\$12.00 G+E

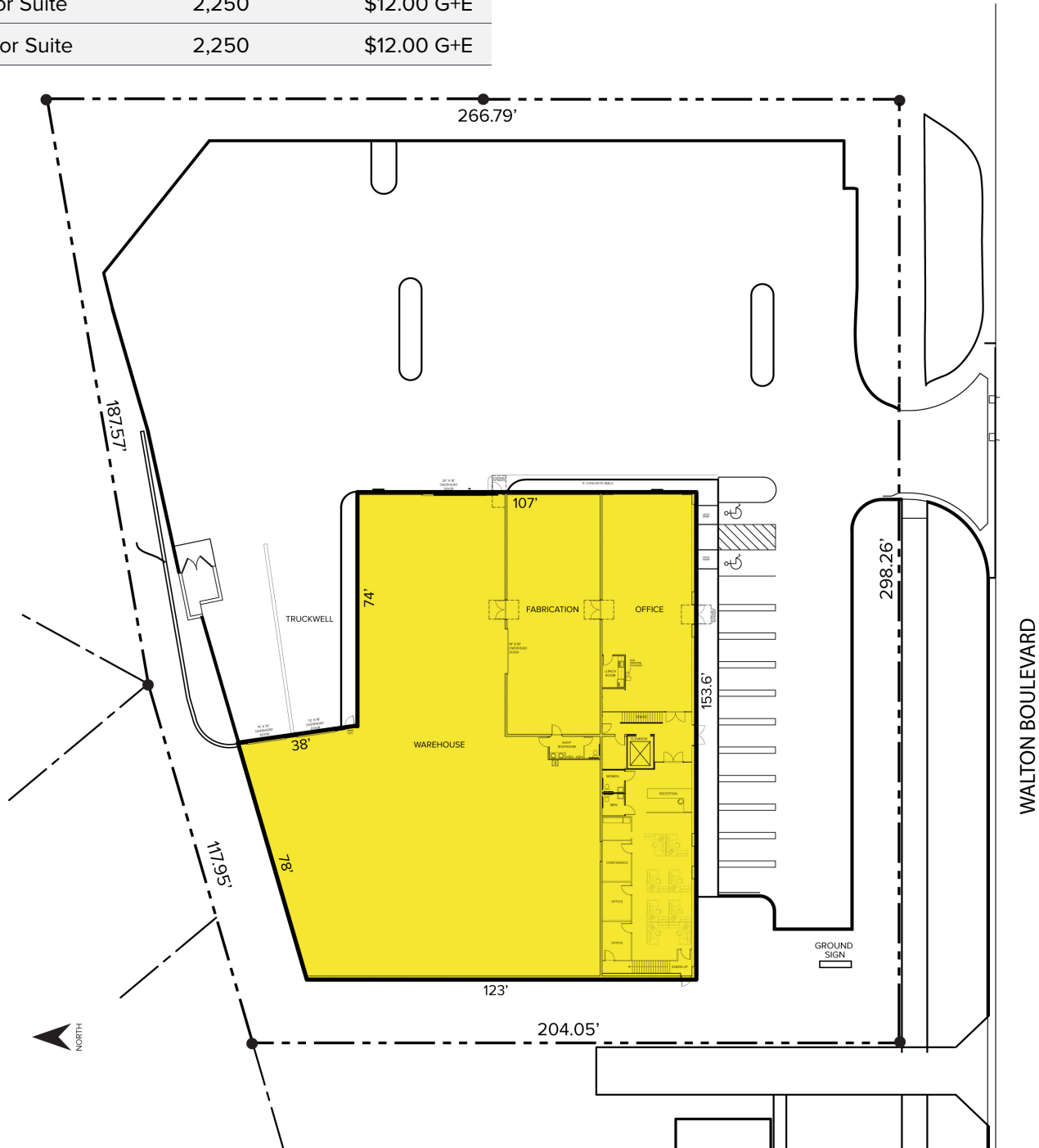

For more information, please contact:

KRIS PAWLOWSKI
(248) 359 3801
kpawlowski@signatureassociates.com

DAN MORROW
(248) 799 3144
dmorrow@signatureassociates.com

SIGNATURE ASSOCIATES
One Towne Square, Suite 1200
Southfield, MI 48076
www.signatureassociates.com

2181 E. Walton Blvd. – Auburn Hills, Michigan

Industrial/Office For Lease

2,250 - 4,500
Square Feet
AVAILABLE

Floor Plan

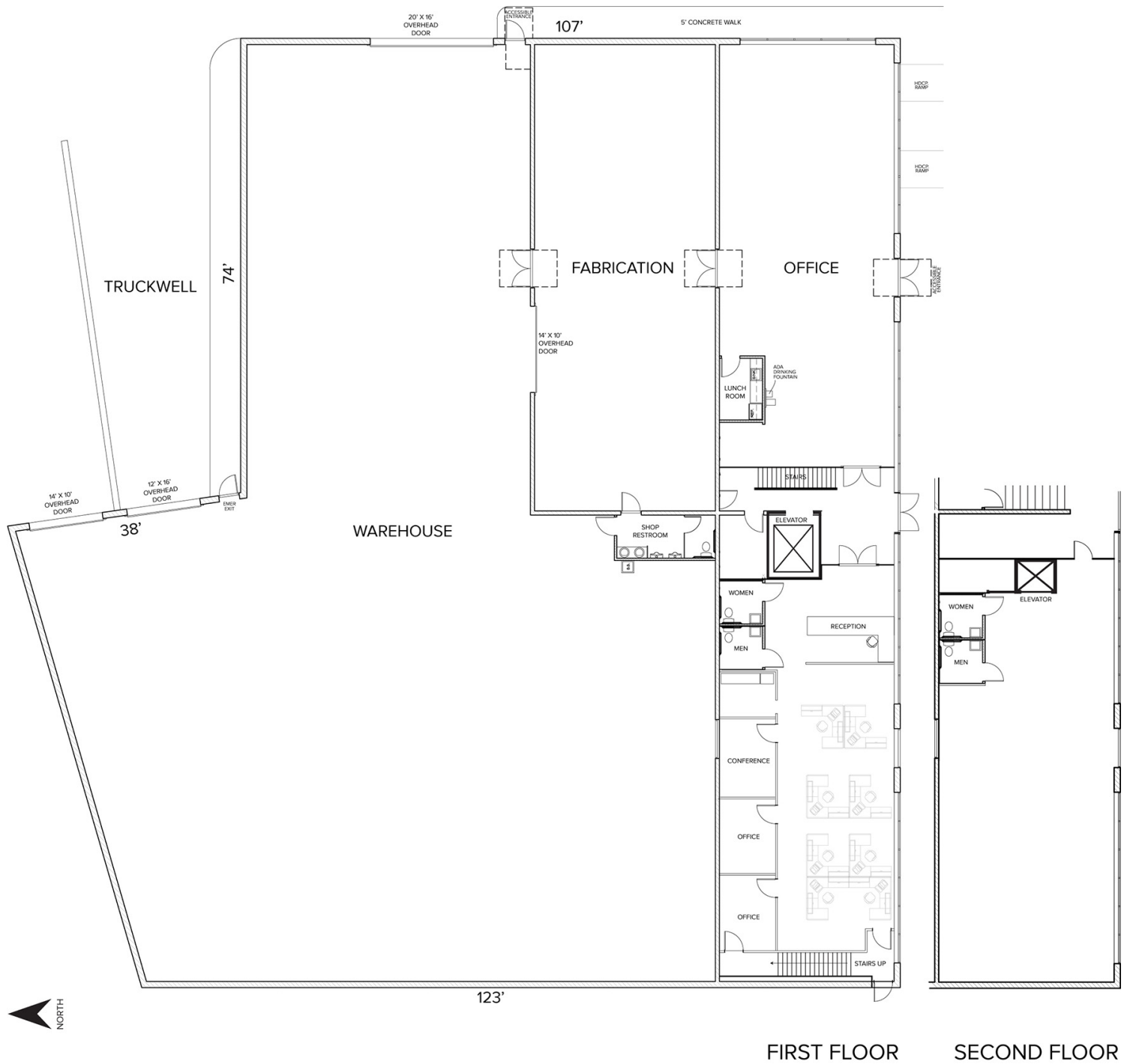

For more information, please contact:

KRIS PAWLOWSKI
(248) 359 3801
kpawlowski@signatureassociates.com

DAN MORROW
(248) 799 3144
dmorrow@signatureassociates.com

SIGNATURE ASSOCIATES
One Towne Square, Suite 1200
Southfield, MI 48076
www.signatureassociates.com

2181 E. Walton Blvd. – Auburn Hills, Michigan

Industrial/Office For Lease

2,250 - 4,500
Square Feet
AVAILABLE

Aerial



For more information, please contact:

KRIS PAWLOWSKI
(248) 359 3801
kpawlowski@signatureassociates.com

DAN MORROW
(248) 799 3144
dmorrow@signatureassociates.com

SIGNATURE ASSOCIATES
One Towne Square, Suite 1200
Southfield, MI 48076
www.signatureassociates.com