

CODE SURVEY IBC-2015 & IFC - 2015
 BUILDING CLASSIFICATION: S-1 OFFICE/WAREHOUSE
 ZONING: C-4 COMMERCIAL
 EXISTING AREA : 18,475 SQ. FT.
 AFFECTED AREA : 581 SQ. FT.

CONSTRUCTION TYPE: III-B, ONE STORY, SPRINKLED

OCCUPANT LOAD
 OFFICE & OTHER AREAS 680 / 100 = 7 OCCUPANTS
 WAREHOUSE 17,795 / 500 = 36 OCCUPANTS
 106 TOTAL OCCUPANTS

FIRE EXTINGUISHERS: PER NFPA CODE 1/3000 S.F.
 = 1 PROVIDED AT NEW AREA,
 TYPE 2 A 10 B C

- LEGEND:**
- ▭ EXISTING WALL TO REMAIN
 - ▬ 2x4 WOOD STUDS AT 16" O.C WITH 5/8" GYPSUM BOARD AT EACH SIDE.
 - FIRE EXTINGUISHER

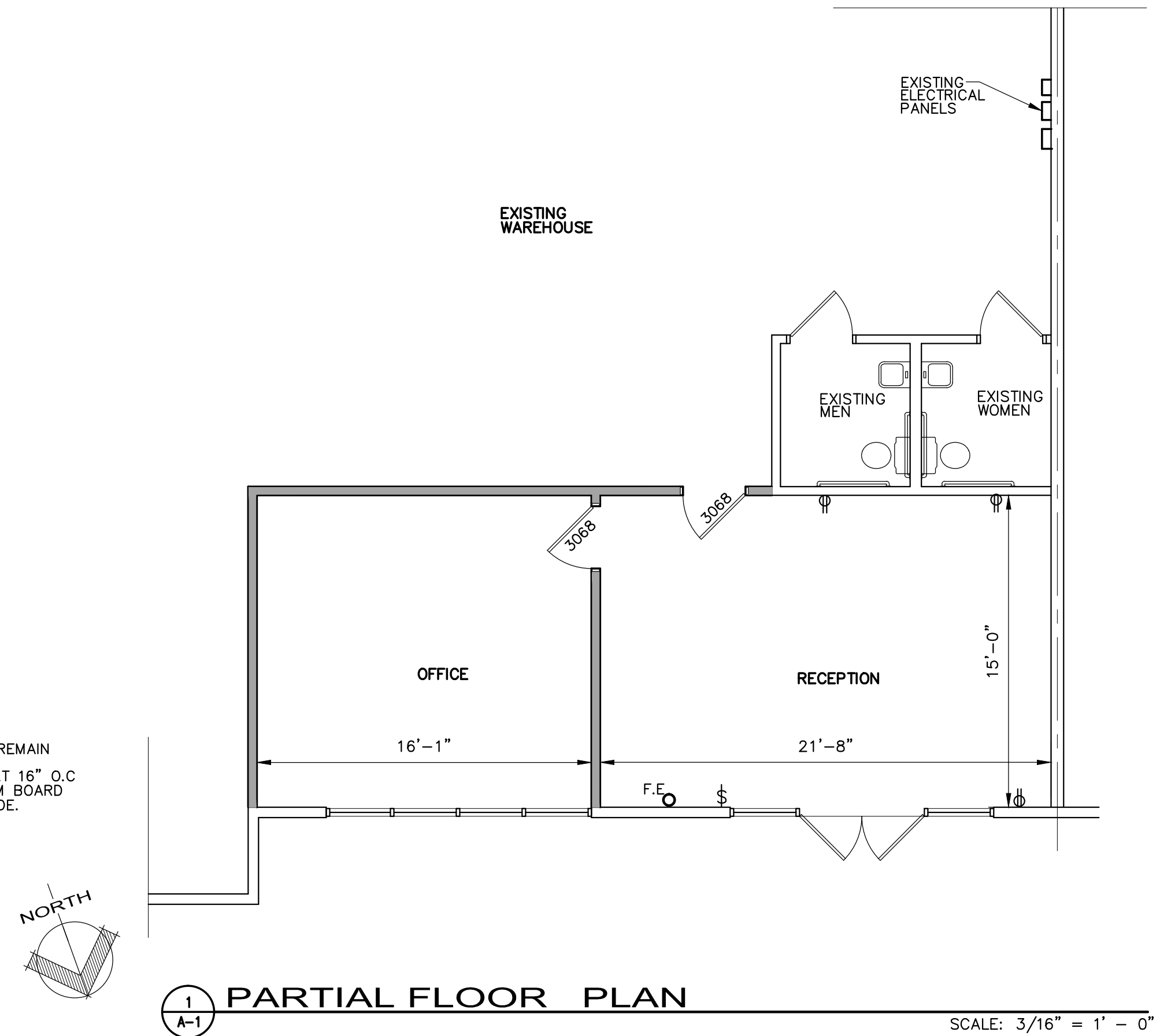
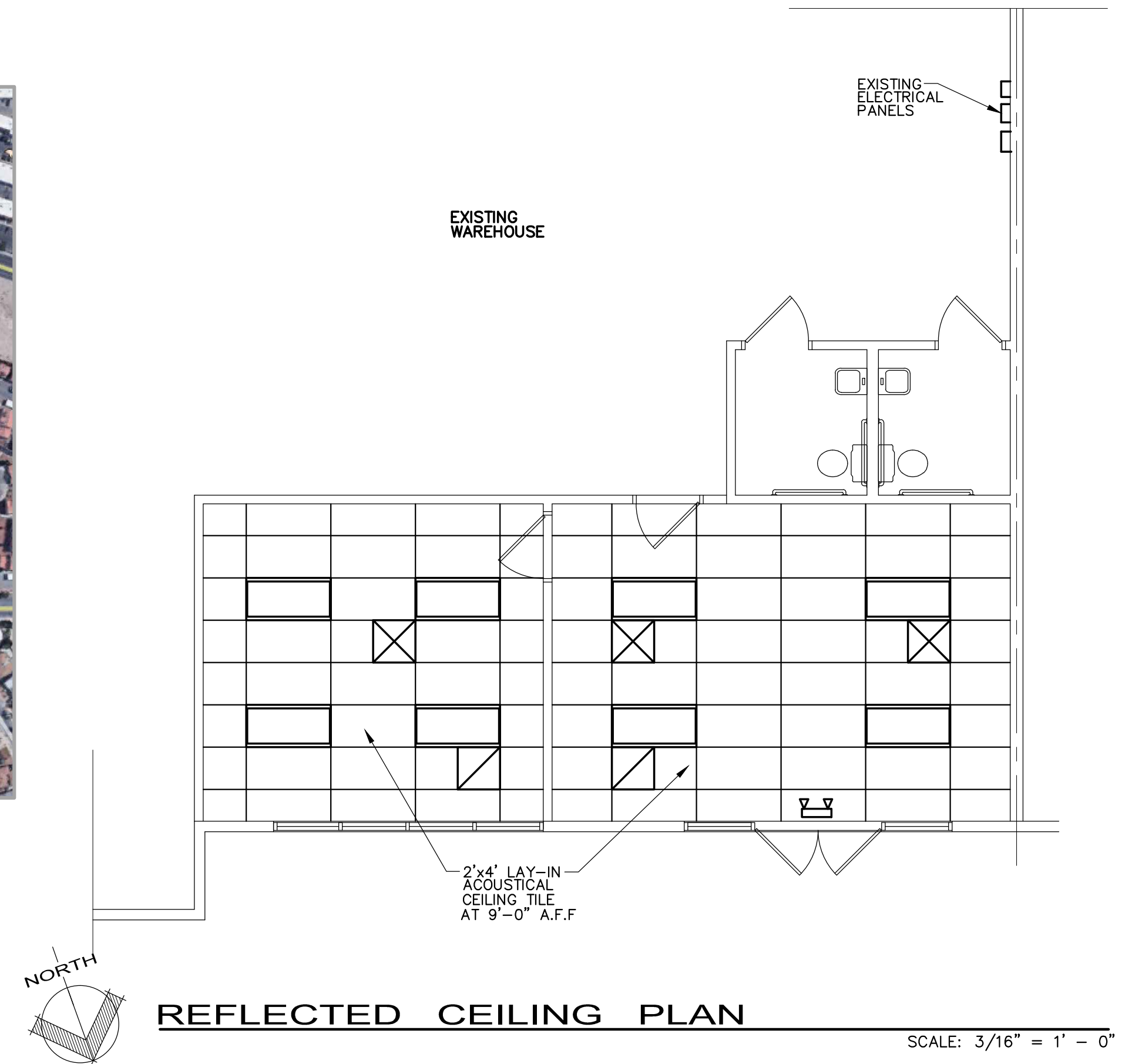

REVISIONS

PROJECT NUMBER:	
DRAWING NO.:	
DATE:	08-15-20
FILE:	

OWNER
X X X X X

PROJECT NAME
 INTERIOR ALTERATIONS TO
11540 PELLICANO STE. B
 EL PASO, TEXAS

J L J DESIGNS
 CELL (915) 329-4346
 9434 VISCOUNT BLVD. SUITE 148
 EL PASO, TEXAS. 79925

SHEET TITLE
FLOOR PLAN
A-1
 SHT. 01 OF 01