

**FOR LEASE** Industrial Space Near Charlotte Douglas Airport

# 11,710 SF INDUSTRIAL LEASE AVAILABLE

3830 Rose Lake Drive, Charlotte, NC 28217

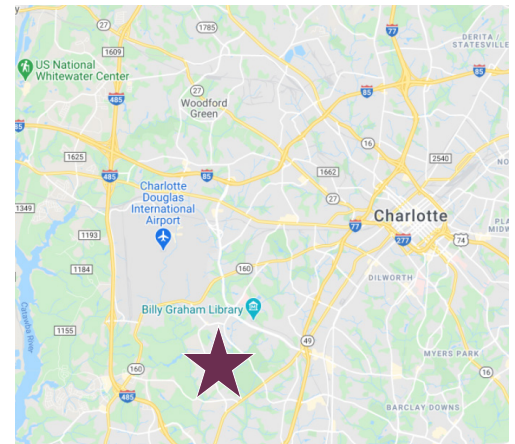

## Space Profile

Size: **11,710 SF**

Rate: **Call for Pricing**

Availability: **30 days**

Lease Term: **5-7 years**

Layout: **Two private offices, a conference room, and break area**

## Key Highlights

- **Fenced Truck Court**
- 16' Clear Height
- Two dock high doors
- One drive-in door
- One Big Ass fan

**For more information, please contact:**

**Colin Reed**  
+1 704 414 7453  
creed@savills.us

**Tommy Beecher**  
+1 704 831 3484  
tbeecher@savills.us

[savills.us](http://savills.us)





## FOR LEASE Industrial Space Near Charlotte Douglas Airport



**For more information, please contact:**

**Colin Reed**  
+1 704 414 7453  
[creed@savills.us](mailto:creed@savills.us)

**Tommy Beecher**  
+1 704 831 3484  
[tbeecher@savills.us](mailto:tbeecher@savills.us)

[savills.us](https://www.savills.us)





## FOR LEASE Industrial Space Near Charlotte Douglas Airport

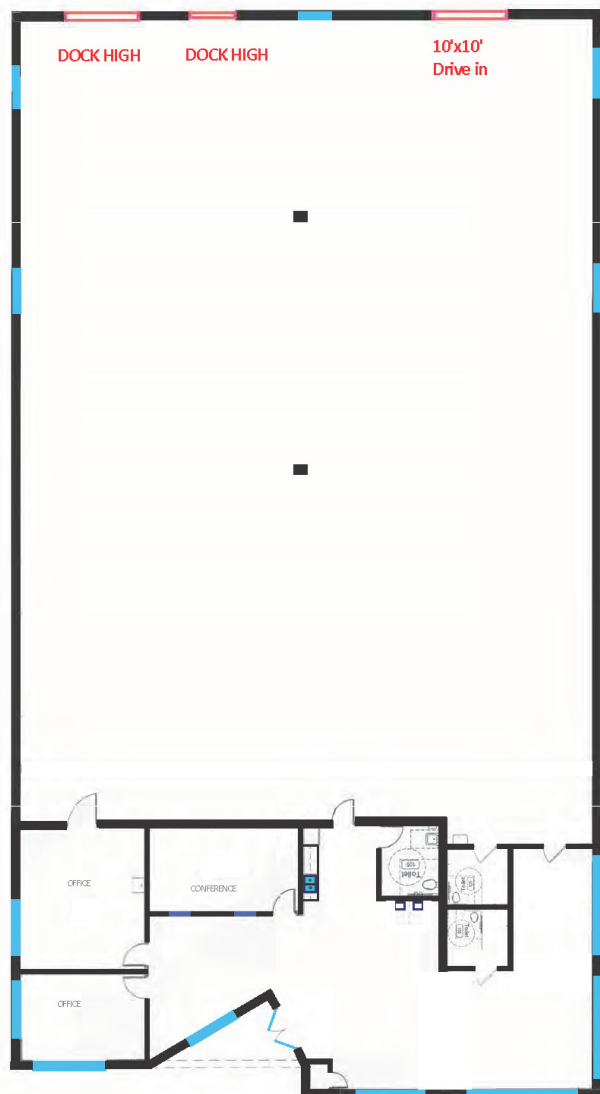

SAVILLS CHARLOTTE  
Carillon Tower - 227 W. Trade Street, Suite 1450, Charlotte, NC 28202

All information furnished regarding property for sale, rental or financing is from sources deemed reliable. No presentation is made as to the accuracy thereof and it is submitted to errors, omissions, change of price, rental or other conditions, prior sale, lease or financing, or withdrawal without notice.

[savills.us](http://savills.us)

