

For Lease

# Downtown Reno Street Retail



LOGIC

**SUBJECT**

101 N. Virginia St.  
Reno, NV 89501

**Ian Cochran, CCIM**

Partner  
775.225.0826  
icochran@logicCRE.com  
B.0145434.LLC

**Greg Ruzzine, CCIM**

Partner  
775.450.5779  
gruzzine@logicCRE.com  
BS.0145435

**Grace Keating**

Associate  
775.870.7806  
gkeating@logicCRE.com  
S.0198962

# Listing Snapshot



**Negotiable**  
Lease Rate



**± 14,000 - 28,000 SF**  
Available Square Footage



**Street-Level + Basement**  
Retail Space

## Property Highlights

- 1st floor street-level retail space along N. Virginia St.
- Basement-level bowling alley, restaurant, and bar space with grease interceptor, hood, and kitchen equipment
- Basement features six (6) individual bowling lanes, seating area, lounge, and dining area
- Frontage along N. Virginia St. at W. 1st St. with a walk score of 94
- Located just north of the Truckee River district and 1 block east of Century Theaters along the downtown Casino corridor
- Neighboring two major Reno developments
- Surrounding tenants include The Arch Reno Wedding Chapel, Bruka Theater, and Wild River Grille

## Demographics

	1-mile	3-mile	5-mile
2025 Population	21,425	140,104	249,117
2025 Average Household Income	\$79,671	\$87,875	\$100,661
2025 Total Households	11,642	60,845	104,257



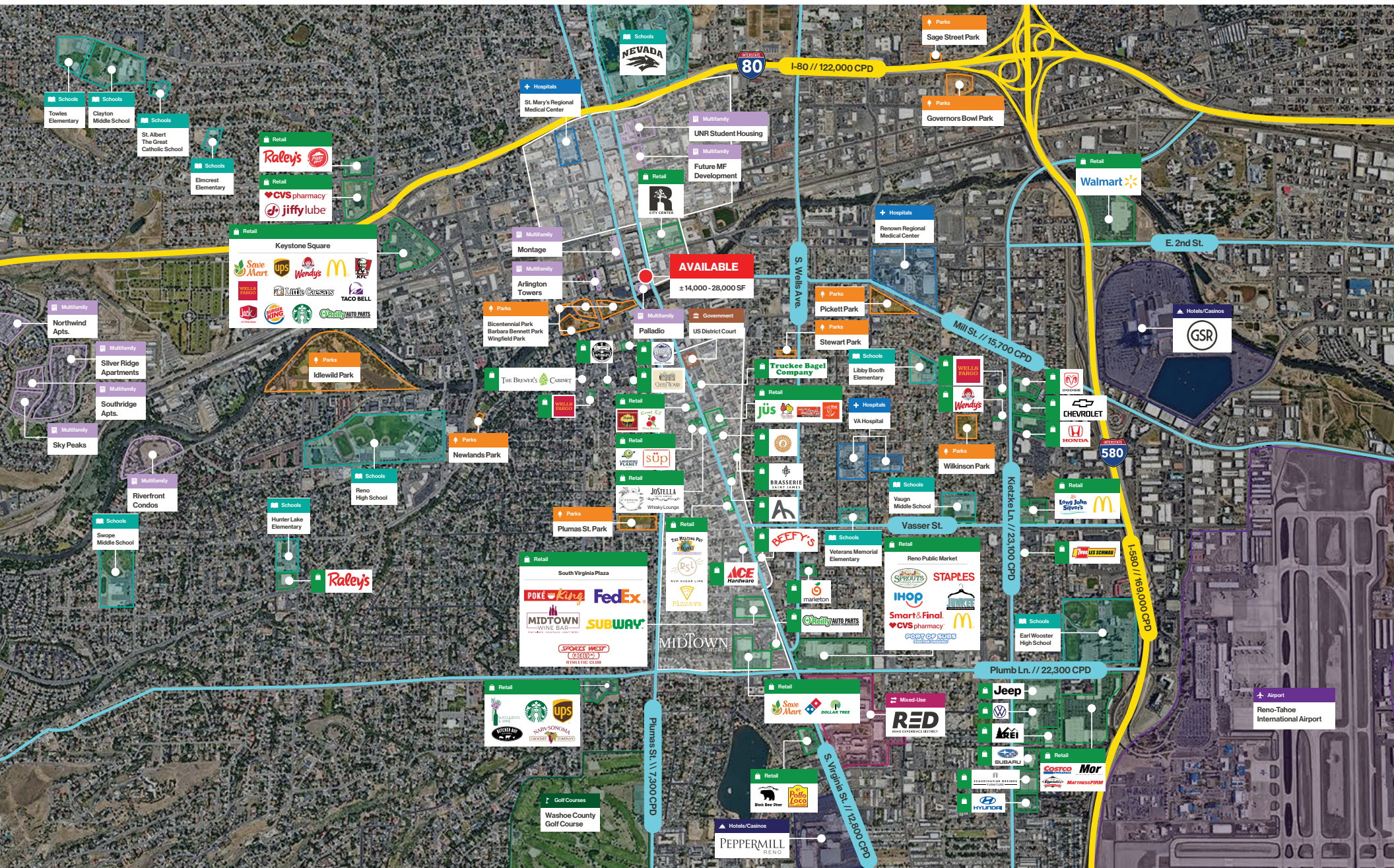

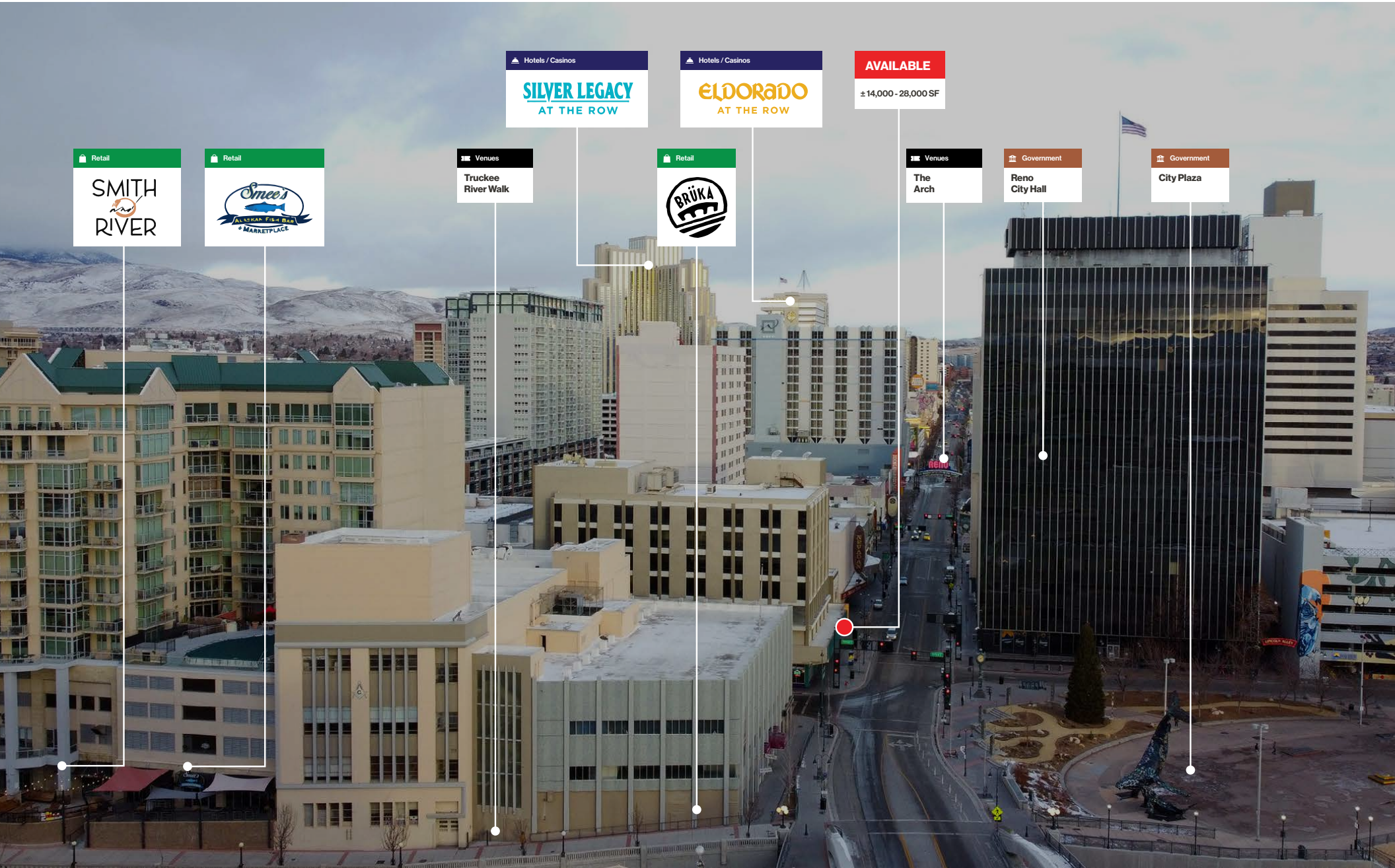

Retail

SMITH RIVER

Retail

Snee's  
ALASKAN FISH BAR & MARKETPLACE

Venues

Truckee River Walk

Retail

BRÜKA

Hotels / Casinos

SILVER LEGACY  
AT THE ROW

Hotels / Casinos

ELDORADO  
AT THE ROW

AVAILABLE

±14,000 - 28,000 SF

Venues

The Arch

Government

Reno City Hall

Government

City Plaza

Floor Plan | Basement | ± 14,000 SF

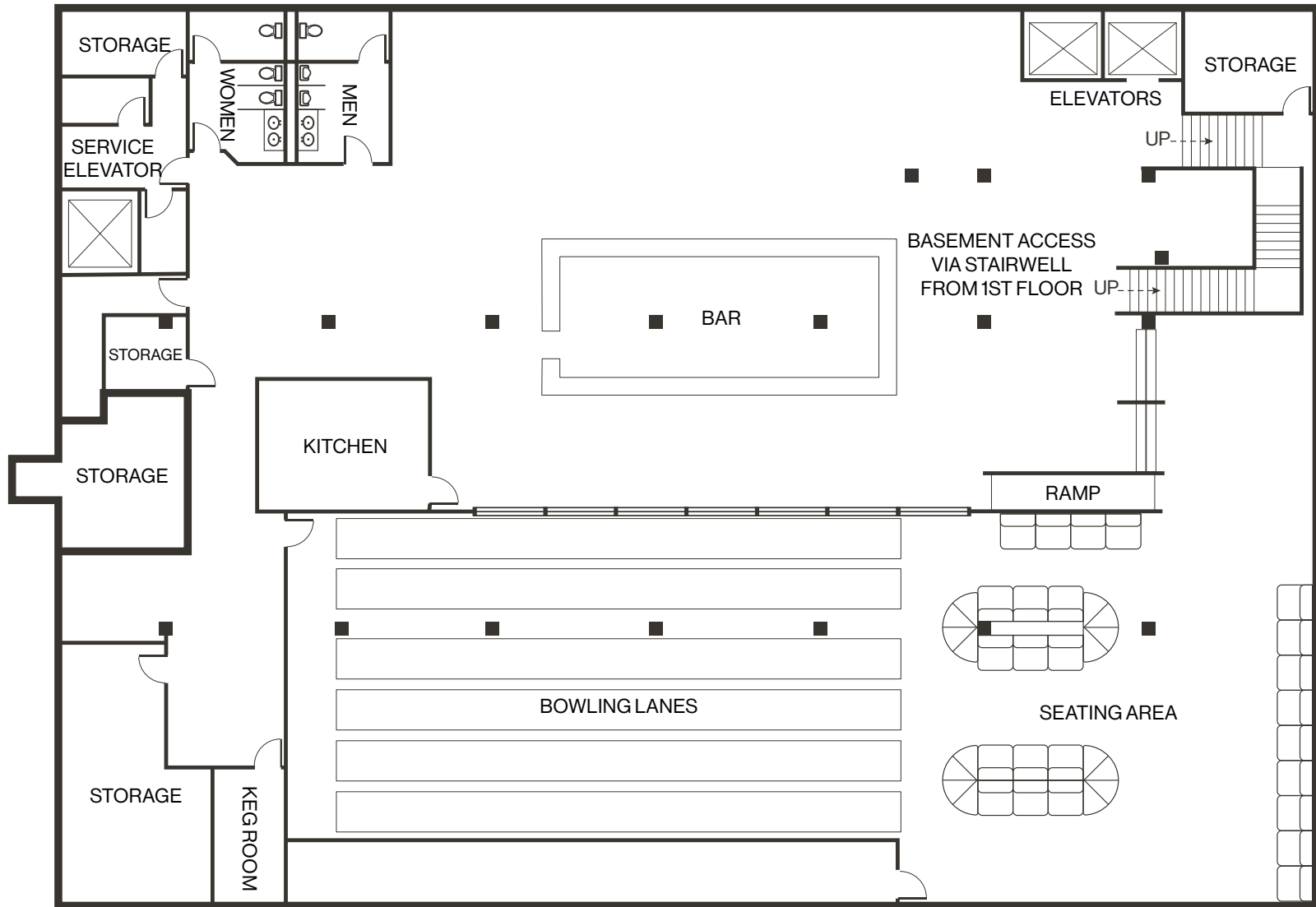

Floor Plan | First Floor | ± 14,000 SF

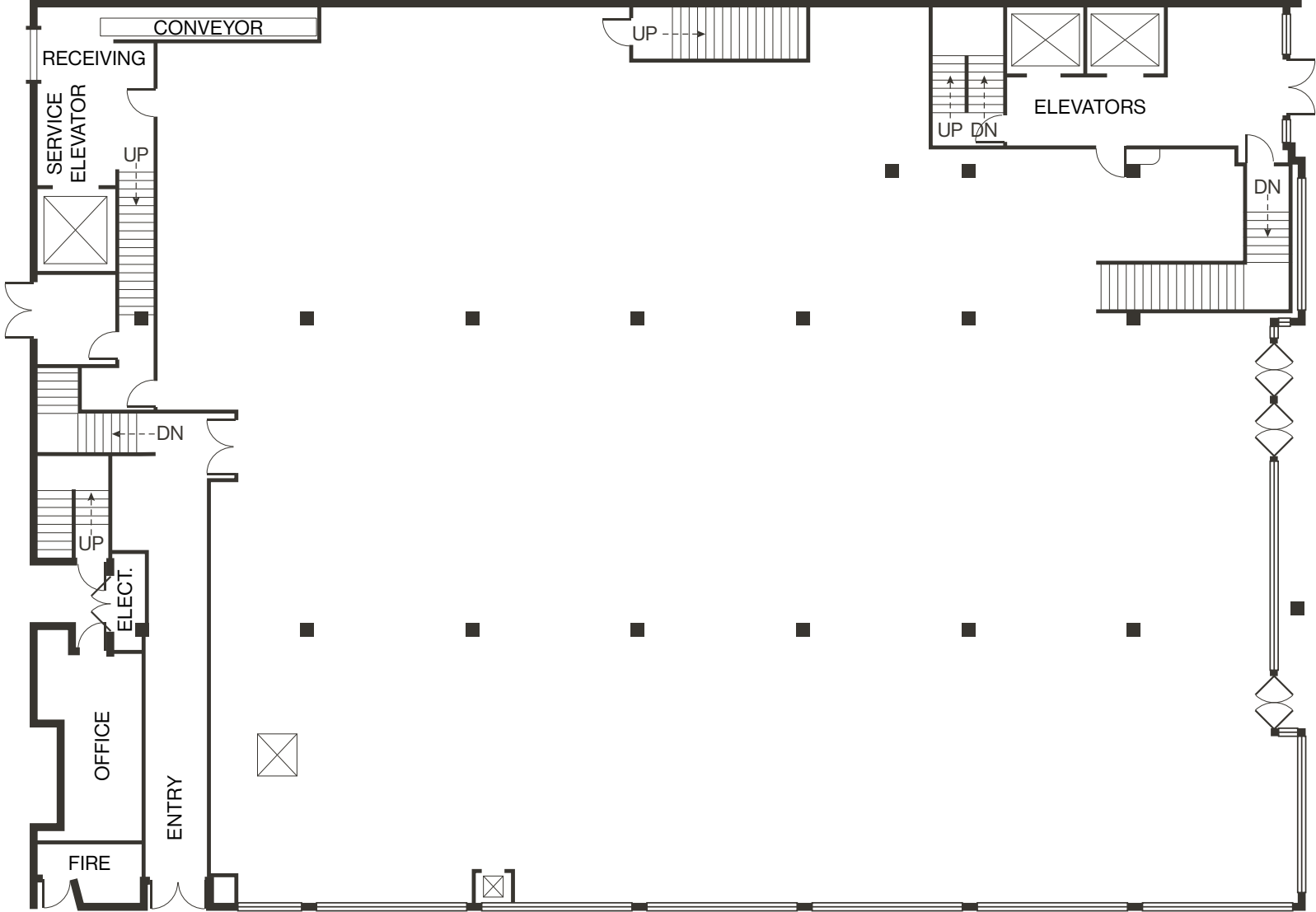

# Property Photos



# LOGIC Commercial Real Estate

## Specializing in Brokerage and Receivership Services



Join our email list and  
connect with us on LinkedIn

The information herein was obtained from sources deemed reliable; however LOGIC Commercial Real Estate makes no guarantees, warranties or representation as to the completeness or accuracy thereof.

For inquiries please reach out to our team.

**Ian Cochran, CCIM**

Partner  
775.225.0826  
icochran@logicCRE.com  
B.0145434.LLC

**Greg Ruzzine, CCIM**

Partner  
775.450.5779  
gruzzine@logicCRE.com  
BS.0145435

**Grace Keating**

Associate  
775.870.7806  
gkeating@logicCRE.com  
S.0198962