



MIDWAY BUSINESS PARK

12 Buildings Total | 258,846 SF Total | 2,000-40,000 SF Available

OFFERING SUMMARY

Midway Business Park is a premier industrial development spanning 258,846 square feet across twelve versatile buildings in the heart of Richland Hills, Texas. Strategically located in central Tarrant County, this dynamic business hub offers exceptional freeway visibility and immediate access to major highways, placing tenants just minutes from downtown Fort Worth and DFW International Airport. Surrounded by a robust and diverse labor pool, Midway Business Park is designed to accommodate a wide range of tenant needs, with flexible suite sizes from 2,000 to 40,000 square feet. Whether you're a growing business or an established enterprise, Midway Business Park delivers the accessibility, visibility, and workforce proximity essential for success.

Owned by:

Ackerman & Co.

Leased by:

HPI

2,016 SF FOR LEASE

MBP | MIDWAY
BUSINESS
PARK

7336B Dogwood Park, Richland Hills, TX 76118

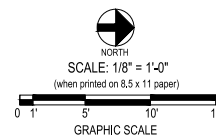
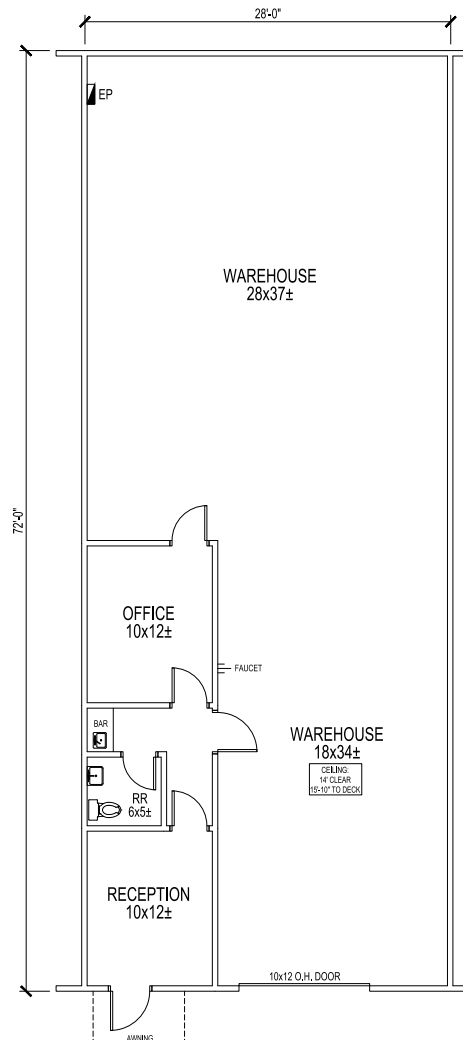

TABULATIONS:

AREA:	SQ. FT.:
OFFICE	352
WAREHOUSE	1,664
TOTAL:	2,016

FLOOR PLAN - 2,016 S.F.
MIDWAY BUSINESS PARK
7336B DOGWOOD PARK DRIVE
RICHLAND HILLS, TEXAS
Revised: 8/14/25

HIGHLIGHTS

2,016 Total SF	14' Clear Height
1,664 SF Warehouse	Ample Parking
352 SF Office	Prime Location with Close Proximity to Highway 121, Loop 820, and I-35W
One (1) 10x12 Grade Level Door	



FOR LEASE

MBP | MIDWAY BUSINESS PARK



FOR LEASE

MBP | MIDWAY BUSINESS PARK

