

# Office/Warehouse Space for Lease

# Loveland



## FEATURES

- **2,700 SF Office Available**
- **540+/- SF Storage Room with Garage Door Available (Air Conditioned)**
- 100% Air Conditioned
- Attractive modern building
- New parking lot
- New Roof - March 2024
- New access road
- Seconds from I-275
- **No Earnings Tax!**

## LOCATION

**394 Wards Corner Road  
Suites 130 & 140  
Loveland, OH 45140**

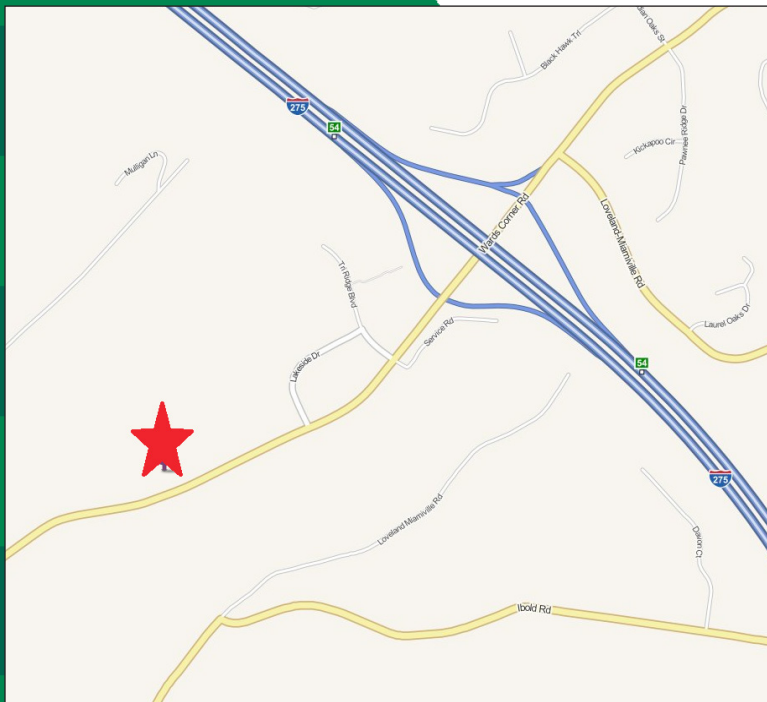

## CONTACT

**Frank Torbeck, SIOR**  
frank.torbeck@everestrealstate.com  
513/769-2505

The information submitted is not guaranteed. Although obtained from reliable sources, it is subject to errors, omissions, prior sale and withdrawal from the market without notice.



COMMERCIAL REAL ESTATE SERVICES

WEB [www.everestrealstate.com](http://www.everestrealstate.com) TEL 513-769-2500 FAX 513-769-2512

9902 Carver Road, Sycamore Office Park, Suite 105, Cincinnati, Ohio 45242

# 394 Wards Corner Rd.

<b>Address/City/County:</b>	394 Wards Corner Road Loveland/Miami Twp./Clermont Cty.
<b>Building Size:</b>	27,000 SF Total
<b>Available Suites:</b>	Suite 140 - 2,700 SF Office Space (6) fully furnished private offices (2) conference rooms (one is shared with unit 150)  Storage Room - Rear of Suite 150 540 SF Storage Room with Garage Door (Air Conditioned)
<b>Land Size:</b>	2.33 acres
<b>Date of Construction:</b>	1988
<b>Type of Construction:</b>	Frame and brick facade
<b>Zoning:</b>	Light Industrial
<b>Clearance Height:</b>	14'
<b>Dock Door:</b>	Dock opening glassed in
<b>Lighting:</b>	LED Lighting
<b>Parking:</b>	3/1,000 SF
<b>Electric:</b>	Single & three phase
<b>Roof:</b>	New Membrane Roof
<b>Heat &amp; A/C:</b>	Forced air with AC (office & warehouse); gas units (warehouse)
<b>Lease Rate:</b>	\$10.00 PSF + \$4.20 PSF Operating Expenses



[www.everestrealstate.com](http://www.everestrealstate.com)

TEL 513-769-2500

FAX 513-769-2512

9902 Carver Road

Sycamore Office Park

Suite 105

Cincinnati, Ohio 45242

## FOR MORE INFORMATION, CONTACT

**Frank Torbeck, SIOR**

[frank.torbeck@everestrealstate.com](mailto:frank.torbeck@everestrealstate.com)

513/769-2505