

**EXISTING CONDITION
FLOOR PLAN**

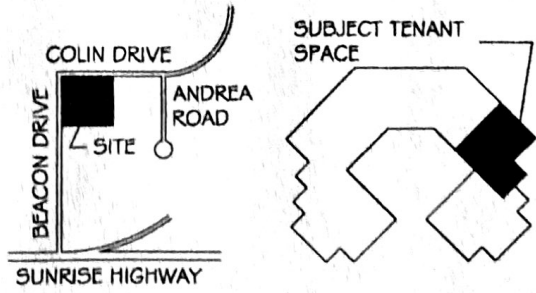
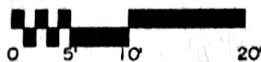

THESE DRAWINGS ARE AN INSTRUMENT OF SERVICE, AND AS SUCH ARE THE PROPERTY OF JOSEPH T. MATTHEWS, ARCHITECT, P.C. ANY UNAUTHORIZED USE OF THESE DOCUMENTS IS A VIOLATION OF SECTION 7209 SUB-DIVISION 2 OF THE N.Y. STATE EDUCATION LAW.

ISSUED FOR REVIEW

7-10-14

EXISTING CONDITION PLAN FOR :
90-9B COLIN DRIVE
 SHERWOOD CORPORATE CENTER BUILDING 6
 90 COLIN DRIVE
 HOLDBROOK NEW YORK

JOSEPH T. MATTHEWS, ARCHITECT P.C.



3480-8 VETERANS MEMORIAL HIGHWAY
 BOHEMIA, N.Y. 11718
 (831) 348-4500
 (831) 348-4508 Fax

NO:	
BY:	
DATE:	
PAGE:	1 of 1