



FOR LEASE

**3090 INDEPENDENCE DRIVE,
LIVERMORE**

UP TO 34,586±SF OF CLASS A OFFICE AVAILABLE

LISTING AGENTS:

SIMON VOGT

925.905.1112

SIMON.VOGT@KIDDER.COM

LIC.ID# 01879314

JESSE LUCAS

510.903.7607

JLUCAS@LEE-ASSOCIATES.COM

LIC.ID# 01264756

4695 Chabot Drive, Suite 110 | Pleasanton, CA 94588 | 925-460-6200 | lee-associates.com



FOR LEASE

3090 INDEPENDENCE DRIVE, LIVERMORE



BUILDING FEATURES

- ±1,764 RSF up to ±34,586 RSF available for lease
- Class A finishes
- New Ownership
- Built in 2001 with extensive improvements completed in 2015
- Parking: 3.9/1,000

CALL BROKERS FOR TOURS AND PRICING

LISTING AGENTS:

SIMON VOGT
925.905.1112

SIMON.VOGT@KIDDER.COM
LIC.ID# 01879314

JESSE LUCAS
510.903.7607

JLUCAS@LEE-ASSOCIATES.COM
LIC.ID# 01264756

LOCATION OVERVIEW

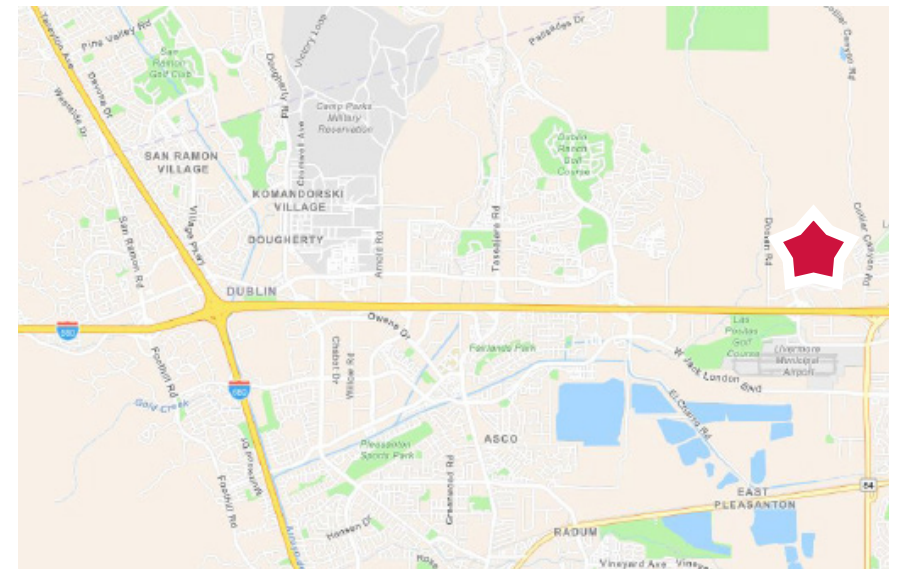

PROPERTY PHOTOS



FOR LEASE

3090 INDEPENDENCE DRIVE, LIVERMORE



CALL BROKERS FOR TOURS AND PRICING

LISTING AGENTS:

SIMON VOGT

925.905.1112

SIMON.VOGT@KIDDER.COM

LIC.ID# 01879314

JESSE LUCAS

510.903.7607

JLUCAS@LEE-ASSOCIATES.COM

LIC.ID# 01264756

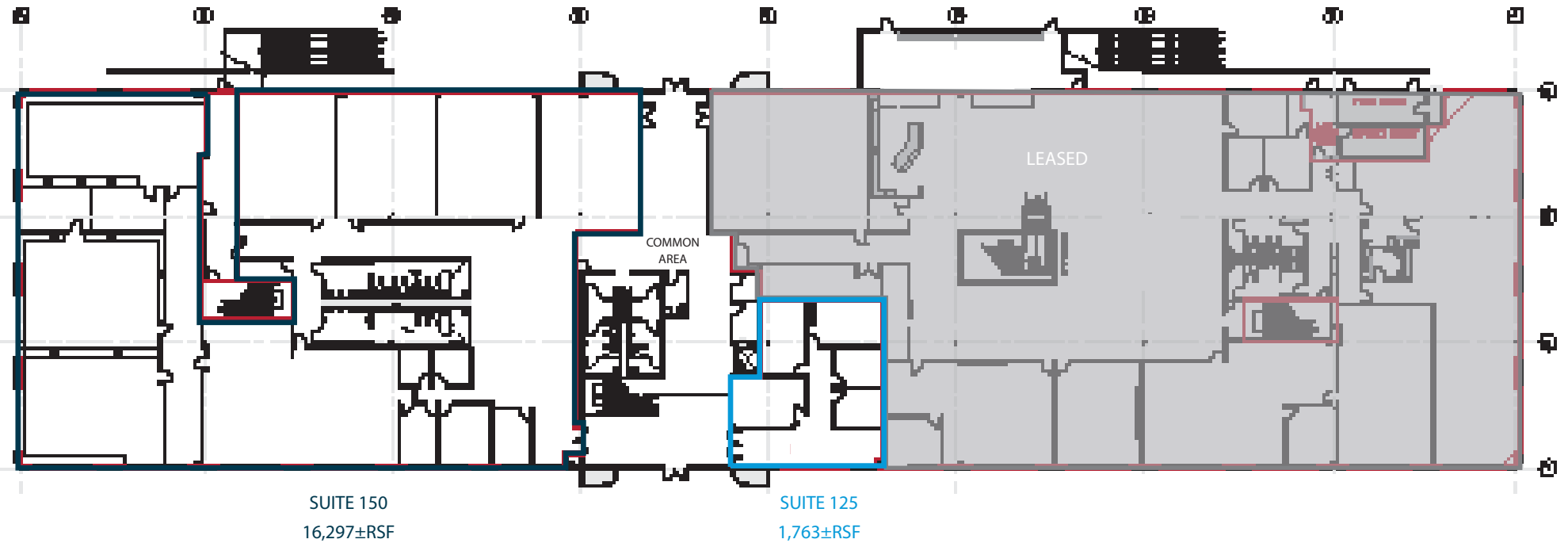

CALL BROKERS FOR TOURS AND PRICING

LISTING AGENTS:

SIMON VOGT

925.905.1112

SIMON.VOGT@KIDDER.COM

LIC.ID# 01879314

JESSE LUCAS

510.903.7607

JLUCAS@LEE-ASSOCIATES.COM

LIC.ID# 01264756

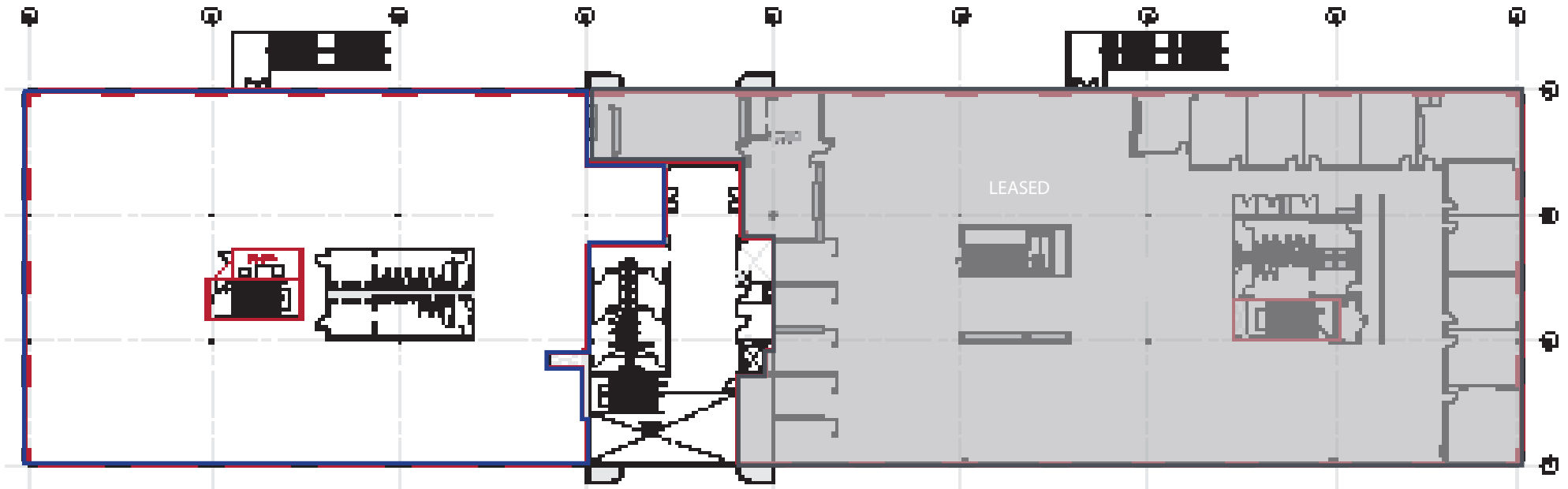

SUITE 250
16,525±RSF

CALL BROKERS FOR TOURS AND PRICING

LISTING AGENTS:

SIMON VOGT

925.905.1112

SIMON.VOGT@KIDDER.COM

LIC.ID# 01879314

JESSE LUCAS

510.903.7607

JLUCAS@LEE-ASSOCIATES.COM

LIC.ID# 01264756