

INDUSTRIAL SUITE FOR LEASE



±3,500 SF available

Reception Area

Open Bullpen Area

Two (2) private offices

One (1) restroom

Warehouse with Three (3) Grade Level Roll Up Doors

Eight (8) Parking Spaces

Street Signage Available

Easy Access to Highway 78

Call to Show

Lease Rate: \$1.30 / SF + \$0.10/SF CAM Fee (Tenant is responsible for paying separately metered utilities including trash service)

*For More Information
Please Contact*

JOHN WITHERALL 760.815.9004 | john.witherall@kidder.com | LIC N° 01759453

KIDDER.COM

This information supplied herein is from sources we deem reliable. It is provided without any representation, warranty, or guarantee, expressed or implied as to its accuracy. Prospective Buyer or Tenant should conduct an independent investigation and verification of all matters deemed to be material, including, but not limited to, statements of income and expenses. Consult your attorney, accountant, or other professional advisor.

SUITE A | FLOOR PLAN

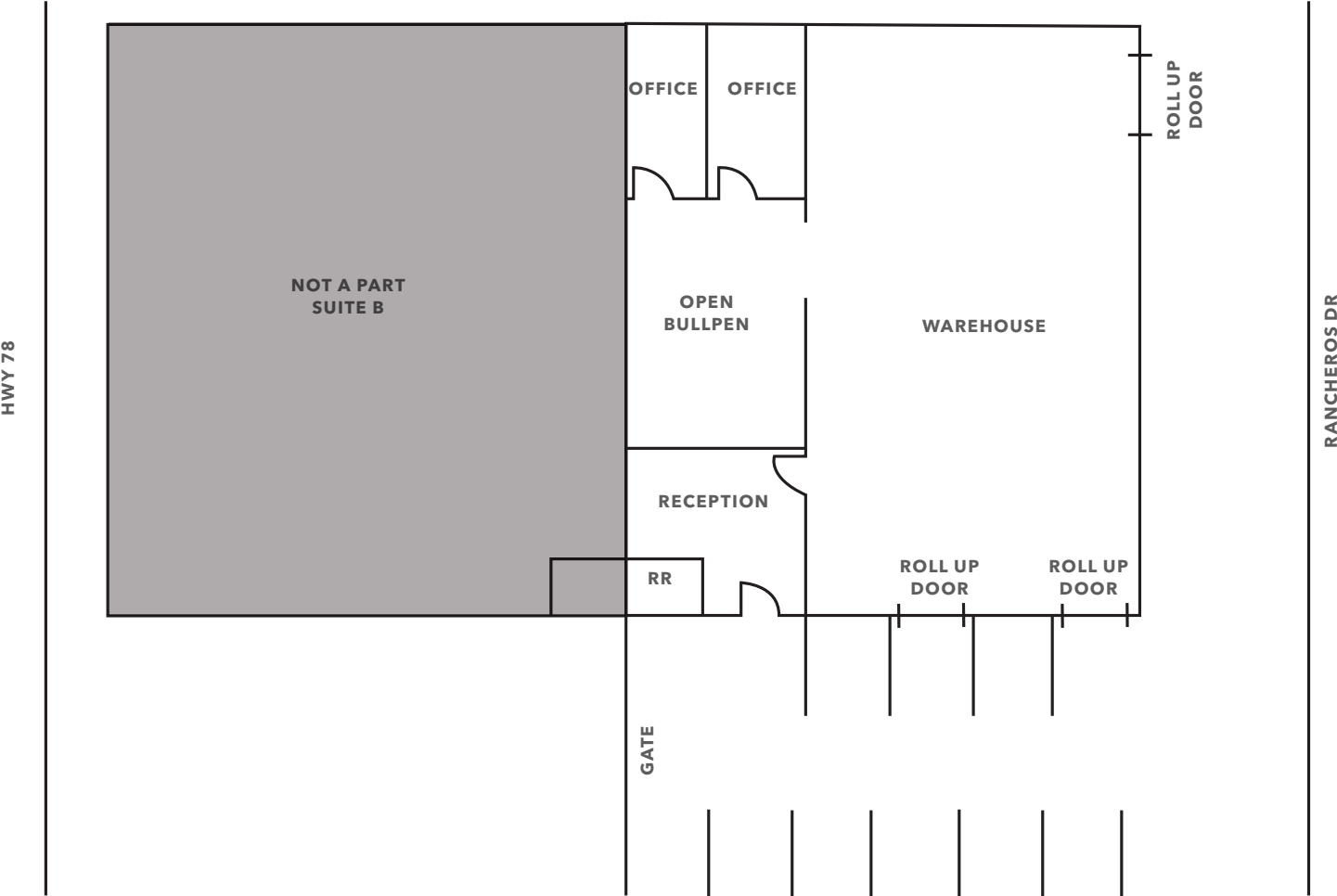

*For More Information
Please Contact*

JOHN WITHERALL 760.815.9004 | john.witherall@kidder.com | LIC N° 01759453

KIDDER.COM

This information supplied herein is from sources we deem reliable. It is provided without any representation, warranty, or guarantee, expressed or implied as to its accuracy. Prospective Buyer or Tenant should conduct an independent investigation and verification of all matters deemed to be material, including, but not limited to, statements of income and expenses. Consult your attorney, accountant, or other professional advisor.



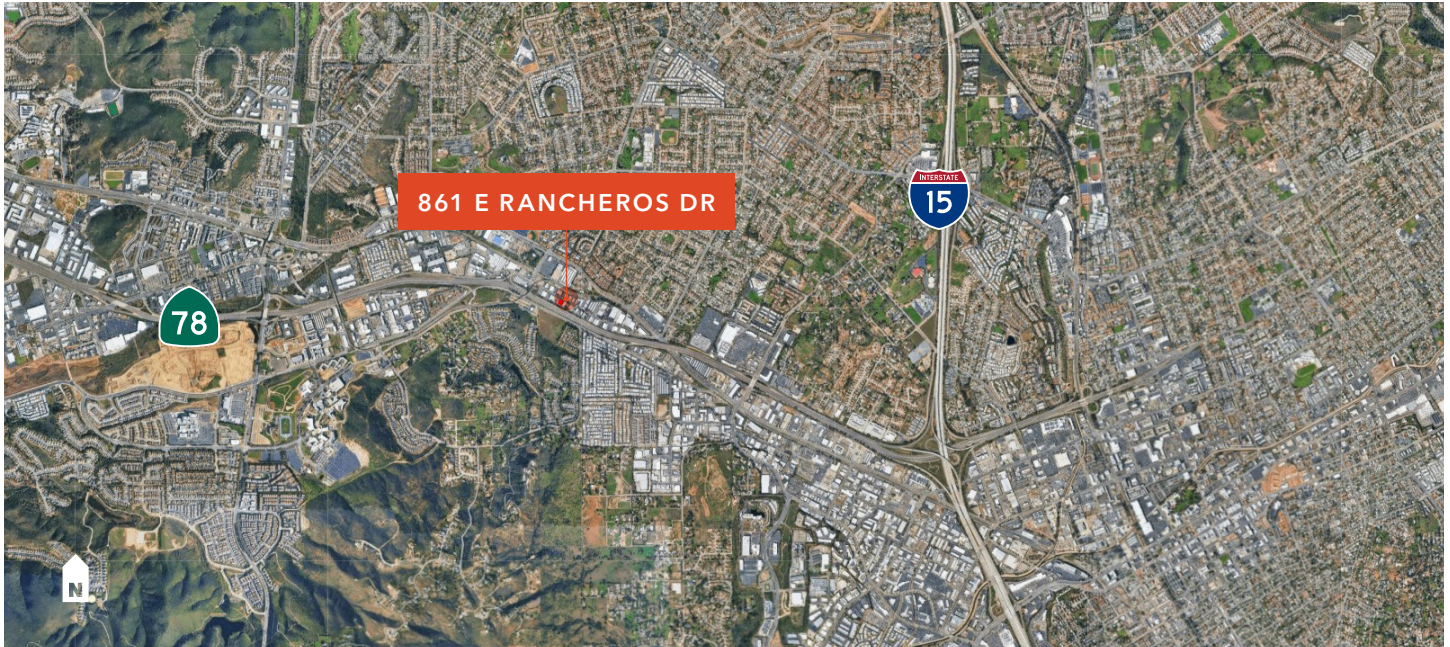

KIDDER.COM

This information supplied herein is from sources we deem reliable. It is provided without any representation, warranty, or guarantee, expressed or implied as to its accuracy. Prospective Buyer or Tenant should conduct an independent investigation and verification of all matters deemed to be material, including, but not limited to, statements of income and expenses. Consult your attorney, accountant, or other professional advisor.

