

FOR LEASE



DORIN REALTY
COMPANY, INC.

9,700 SQ FT Industrial Building



654 S Anderson St, Los Angeles, CA 90023

**Fantastic Corner Building Located Immediately Adjacent to the
Downtown Arts District**

- Wood Bow Truss Ceiling / Skylights
- Clear Span Secure Fenced Car Parking for 4 Cars
- Dock High Loading
- Sprinklered
- 800 Amp, 240 Volt, 3 Phase Power (Well Distributed)
- 14'-20' Clearance

**This Outstanding Opportunity Offered at
\$1.13 SF/ \$10,950/ Month Modified Gross**



DORIN REALTY
COMPANY, INC.

Lic. No. 00531646

Contact exclusive agent:

Mark Whitman

Lic. No. 00918875

mwhitman@dorinrealty.com

213-627-0007 Ext 124

4555 Pacific Blvd., Vernon, CA 90058-2207

Industrial and Commercial Real Estate Specialists
Since 1959

www.dorinrealty.com

The information contained herein is from sources we believe to be reliable but, we do not guarantee its accuracy. All measurements & dimensions are approximations and are not to scale. Clients are encouraged to verify their accuracy.

654 S. Anderson Street Los Angeles, CA 90023

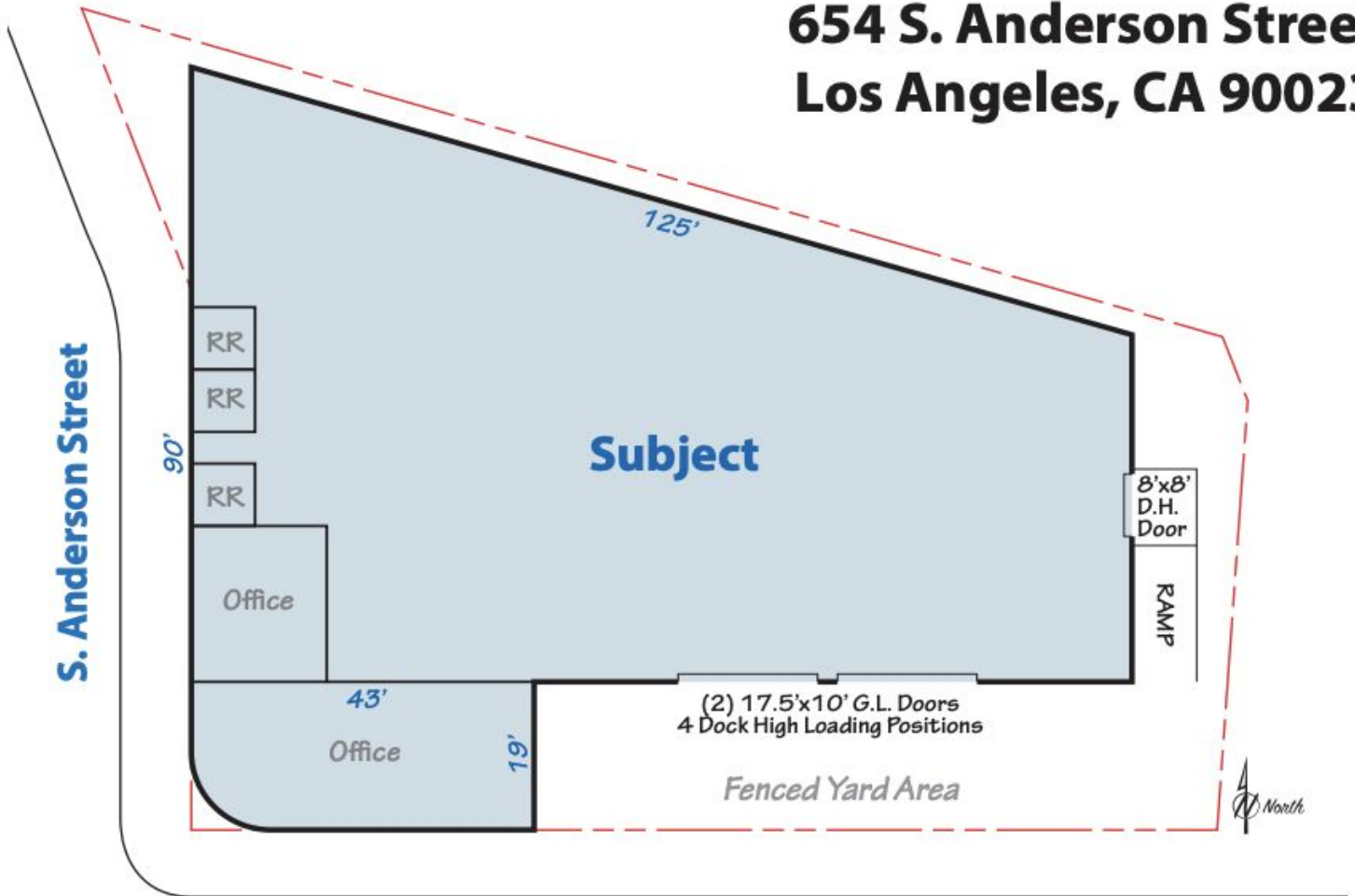

Jesse Street



Contact exclusive agent:

Mark Whitman

Lic. No. 00918875

mwhitman@dorinrealty.com

213-627-0007 Ext 124

4555 Pacific Blvd., Vernon, CA 90058-2207

Industrial and Commercial Real Estate Specialists

Since 1959

www.dorinrealty.com

The information contained herein is from sources we believe to be reliable but, we do not guarantee its accuracy. All measurements & dimensions are approximations and are not to scale. Clients are encouraged to verify their accuracy.



DORIN REALTY
COMPANY, INC.

Lic. No. 00531646

