

FOR SUBLEASE
1850 Diplomat
Farmers Branch, TX 75234



33,800 SF AVAILABLE

PROPERTY FEATURES



33,800 SF

OVERALL (OFFICE SF TBD)

22'

CLEAR HEIGHT

SUBLEASE TERM

THROUGH 07/31/2025

**THREE (3) DOCKS
ONE (1) W/ LEVELER**

100% HVAC

PINWELD THROUGHOUT

**AVAILABLE
ASAP**

1850 DIPLOMAT FLOOR PLAN

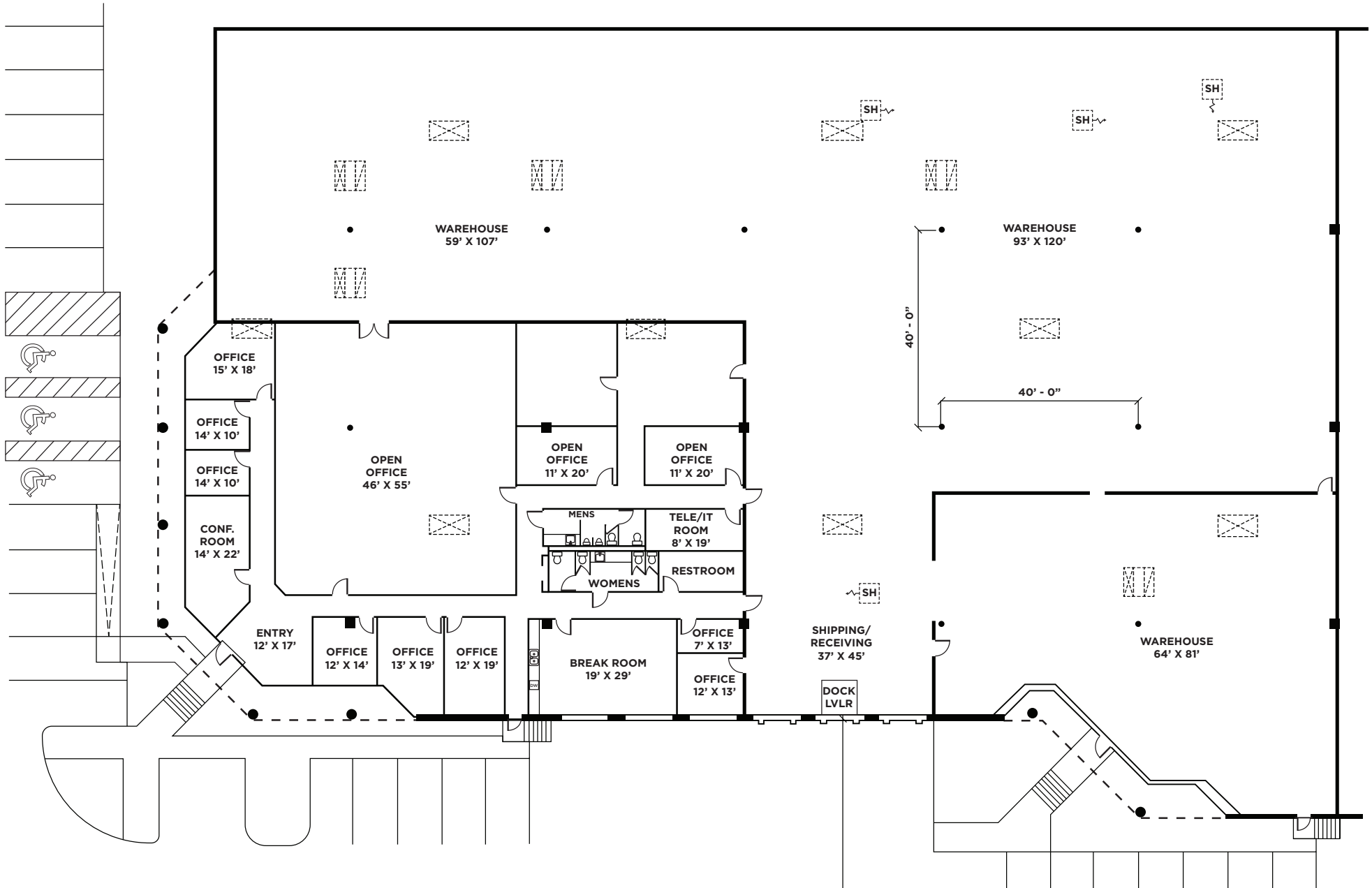

← N SUITE 100

PROPERTY PHOTOGRAPHY



1850 DIPLOMAT AERIAL MAP

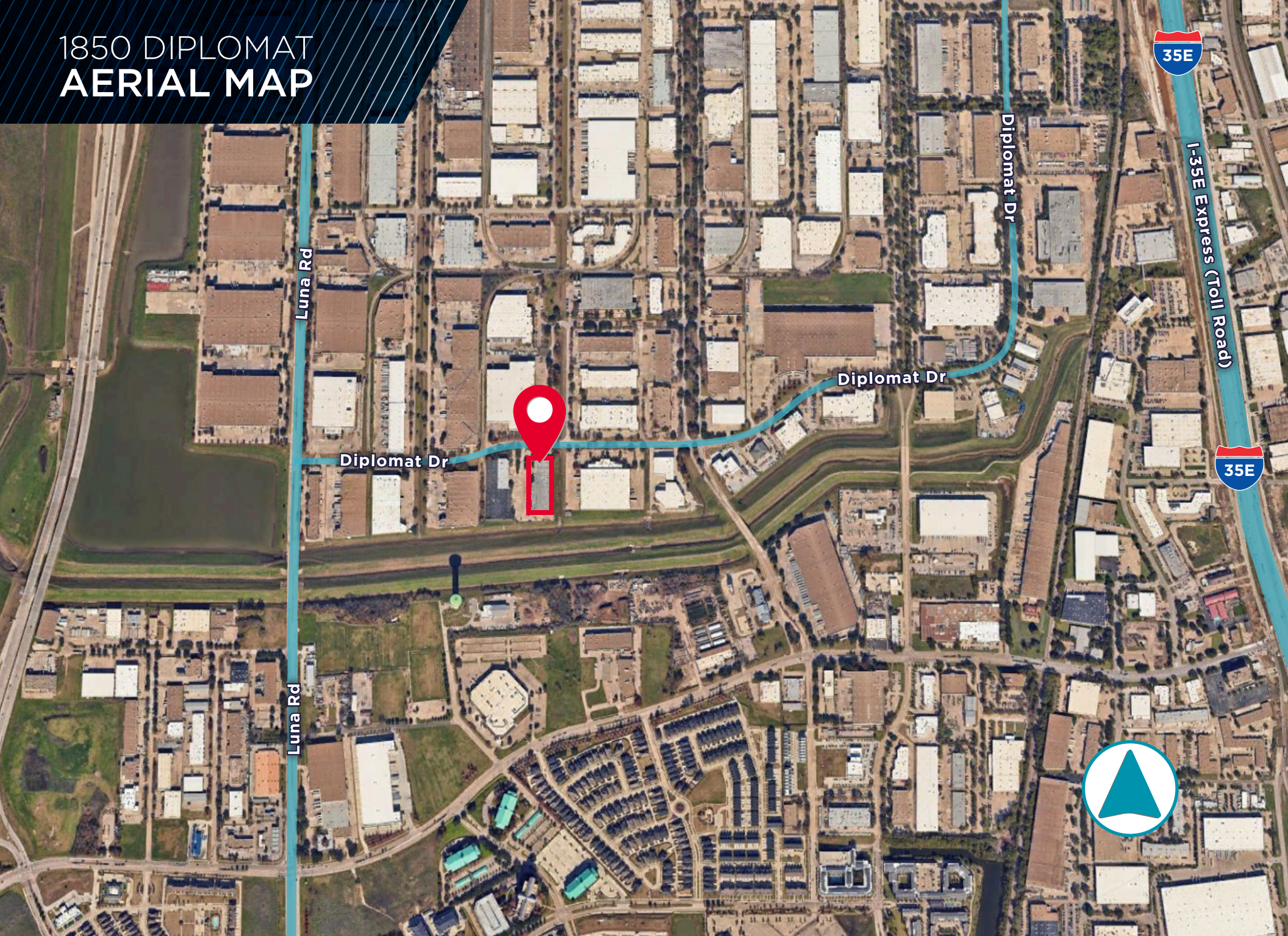

Jay Benner

Director
+1 205 864 7086
jay.benner@cushwake.com

David Eseke, SIOR

Vice Chairman
+1 972 663 9852
david.eseke@cushwake.com

Clay Balch, SIOR

Executive Director
+1 972 663 9853
clay.balch@cushwake.com