

FOR LEASE

Office Suite

140 PRESTON EXECUTIVE DRIVE

Cary, NC 27513

PRESENTED BY:

JOHN POWELL

O: 919.948.7229

john.powell@svn.com

KARA BLUE

O: 919.760.4800

kara.blue@svn.com

PROPERTY SUMMARY



OFFERING SUMMARY

SUITE AVAILABLE:	100D
ZONING:	O&I
LOCATION:	Prime Preston location near Cary Parkway & Davis Drive
LEASE RATE:	\$550/Month (1-year minimum)

PROPERTY DESCRIPTION

Located in the heart of Cary's Preston area, 140 Preston Executive Drive offers a professional office setting ideal for small businesses or solo practitioners. Suite 100E features an efficient layout within a well-maintained building surrounded by established residential neighborhoods, retail, and major thoroughfares. With simple pricing, a flexible floorplan, and convenient access to Cary Parkway, Davis Drive, and High House Road, this space provides an excellent opportunity for anyone seeking an affordable Cary address in a highly desirable submarket.

PROPERTY HIGHLIGHTS

- Prime Preston location near Cary Parkway & Davis Drive
- Great for small businesses or solo professionals
- Well-kept building with ample parking
- Close to retail, dining, and residential neighborhoods

JOHN POWELL
O: 919.948.7229
john.powell@svn.com

KARA BLUE
O: 919.760.4800
kara.blue@svn.com

FLOOR PLAN

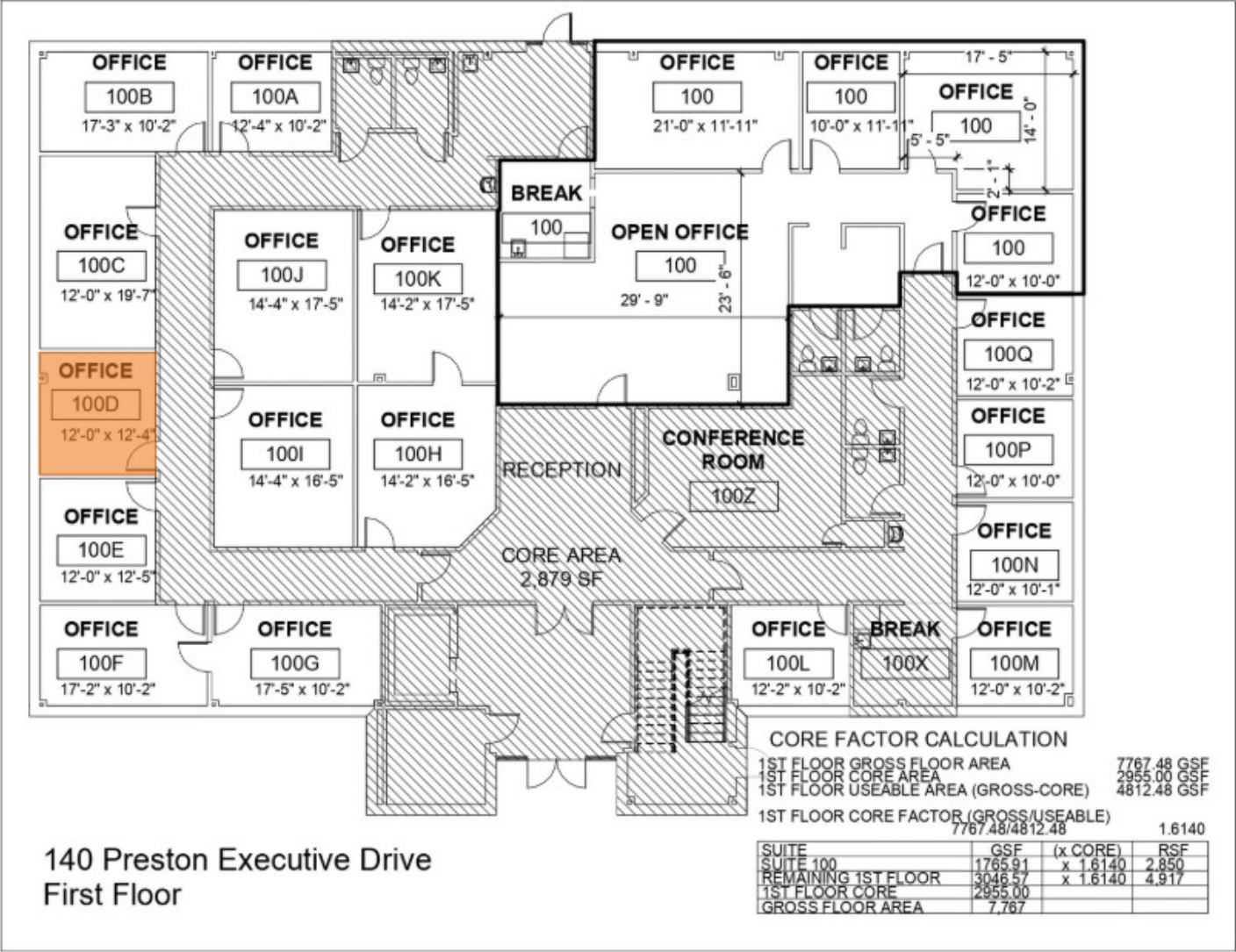

JOHN POWELL

O: 919.948.7229

john.powell@svn.com

KARA BLUE

O: 919.760.4800

kara.blue@svn.com

LOCATION MAP



JOHN POWELL

O: 919.948.7229

john.powell@svn.com

KARA BLUE

O: 919.760.4800

kara.blue@svn.com