

FORMER FAMILY DOLLAR

4002 N 50th St | Tampa, FL 33610
Freestanding Retail For Sublease



LQ Commercial
REAL ESTATE SERVICES

LQCRE.COM



CALL FOR
RATES



8,320 SF
SIZE



2014
BUILT

- Located on a hard corner, lighted intersection with excellent visibility, access and parking.
- Close proximity to NetPark Tampa Bay with 1M square feet of prime office space, Pepin Distribution, and the Hard Rock Hotel & Casino.
- Major area tenants include Ikea, Publix, Lifetime Fitness and Sprouts.
- Prominent facade and monument sign available.

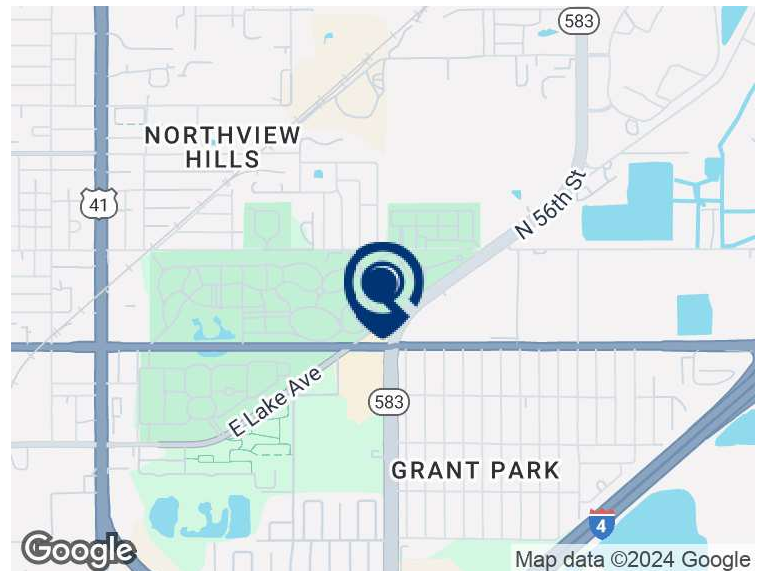

PROPERTIES.LQCRE.COM/FAMILY-DOLLAR-TAMPA-EAST



TOTAL POPULATION
245,232



5-YR POP. INCREASE
1.9%



AVERAGE HH INCOME
\$86,724



5601 Mariner St #220
Tampa, FL 33609
LQCRE.COM

Lynda Nagy
Principal, Senior Associate
D: 813.288.0020 x121
C: 561.961.9958
lnagy@lqcre.com

FORMER FAMILY DOLLAR

4002 N 50th St | Tampa, FL 33610
Freestanding Retail For Sublease



LQ Commercial
REAL ESTATE SERVICES

LQCRE.COM

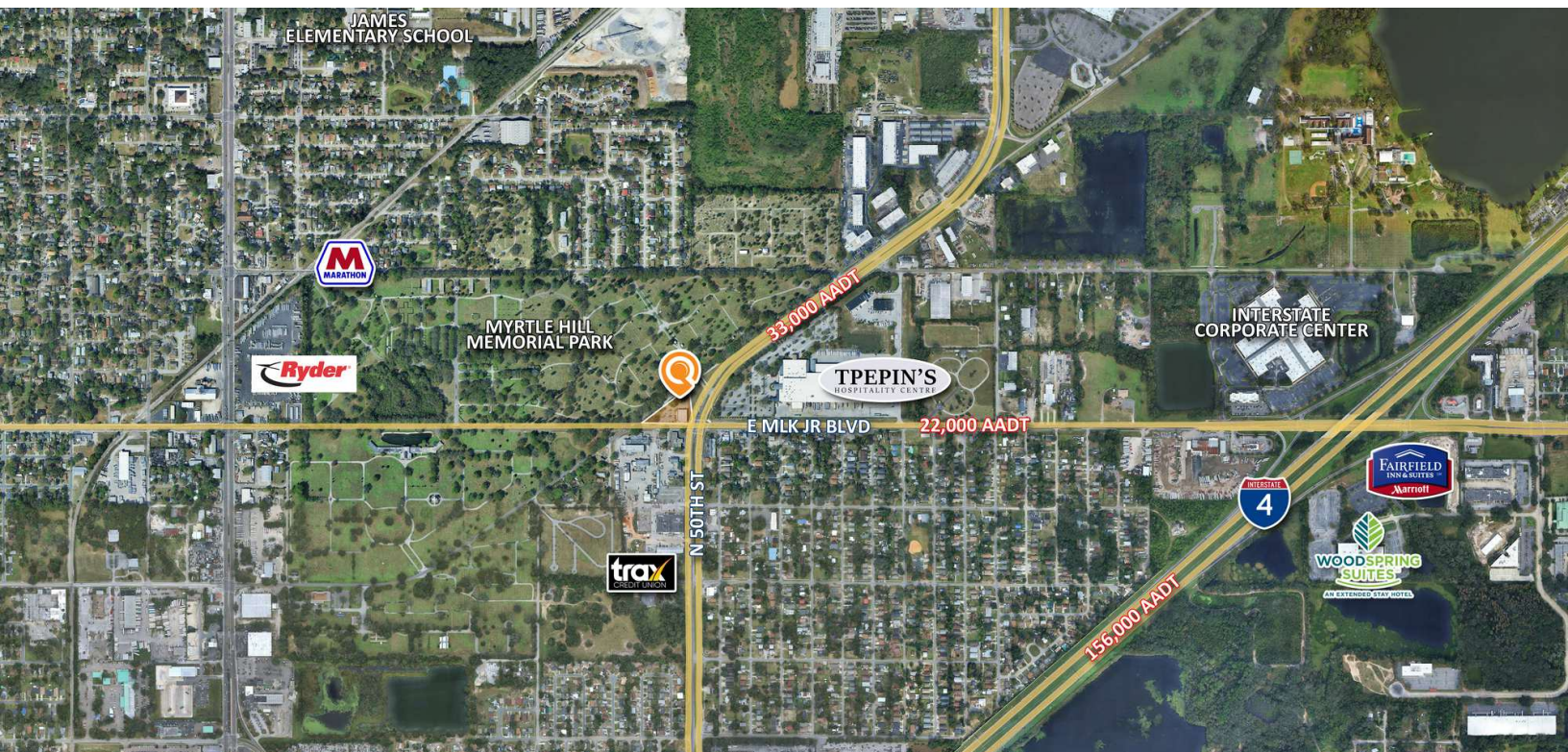
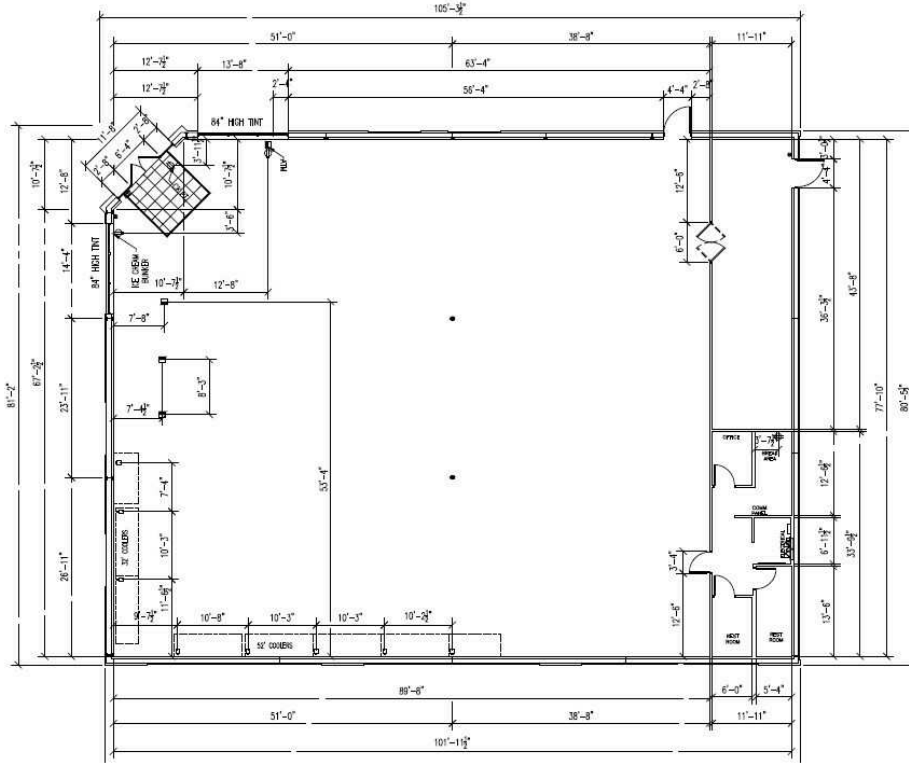

LQ Commercial
REAL ESTATE SERVICES

5601 Mariner St #220
Tampa, FL 33609
LQCRE.COM

Lynda Nagy
Principal, Senior Associate
D: 813.288.0020 x121
C: 561.961.9958
lnagy@lqcre.com

Information obtained from owner(s) or other sources deemed reliable. We have no reason to doubt its accuracy, but cannot guarantee it. All properties subject to change or withdrawal without notice.