



4908 BUENA VISTA ROAD

1,956 SF RETAIL \$2,100/MO

1,734 SF WAREHOUSE \$1,500/MO

PROPERTY HIGHLIGHTS

1,956 SF OF RETAIL SPACE NEIGHBORING DOMINO'S. LARGE SHOWROOM UPON ENTRY WITH A LARGE, ENCLOSED CHECKOUT COUNTER WITH GLASS DIVIDERS. IN THE REAR OF THE SPACE IS A STORAGE ROOM AND RESTROOM. CAN BE COMBINED WITH THE CONTIGUOUS WAREHOUSE SPACE FOR A TOTAL OF 3,690 SF.

1,734 SF OF WAREHOUSE SPACE WHICH INCLUDES A LARGE SERVICE BAY WITH TWO 12' ROLL UP DOORS, STORAGE ROOM, AND BATHROOM.

AMPLE PARKING ON SITE AND TWO ACCESS POINTS TO SHOPPING CENTER OFF OF BUENA VISTA ROAD. TRAFFIC COUNTS EXCEED 30,000 CARS PER DAY.



Chris Wightman
CHRIS WIGHTMAN
(706)-326-2053
(706)-327-1990
CHRIS@FCRCOMMERCIAL.COM



Diane Russell
DIANE RUSSELL
(706)-888-0561
(706)-327-1990
DIANE@FCRCOMMERCIAL.COM



Marty Flournoy
MARTY FLOURNOY
(706)-326-4877
(706)-327-1990
MARTY@FCRCOMMERCIAL.COM

4908 BUENA VISTA ROAD



Flournoy
& Calhoun
Realtors

RETAIL SPACE

1,956 SF

\$2,100 PER MONTH

WAREHOUSE

1,734 SF

\$1,500 PER MONTH

Flournoy
& Calhoun
Realtors

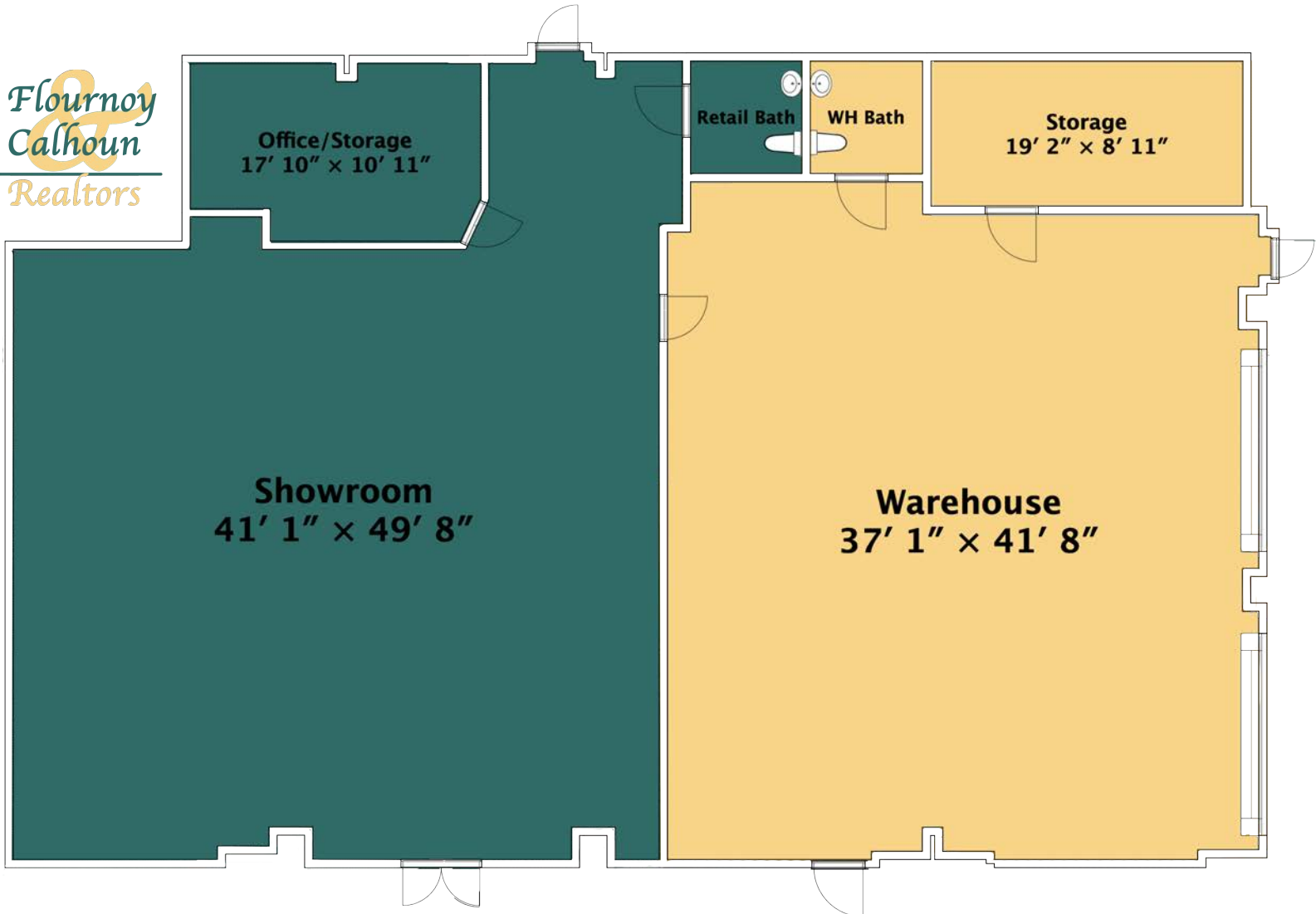

Chris Wightman
CHRIS WIGHTMAN
(706)-326-2053
(706)-327-1990
CHRIS@FCRCOMMERCIAL.COM



Diane Russell
DIANE RUSSELL
(706)-888-0561
(706)-327-1990
DIANE@FCRCOMMERCIAL.COM



Marty Flournoy
MARTY FLOURNOY
(706)-326-4877
(706)-327-1990
MARTY@FCRCOMMERCIAL.COM