

GEORGIA INNOVATION PARK

2460 MOUNTAIN INDUSTRIAL BOULEVARD, TUCKER, GA, 30084



CBRE



VIEW VIRTUAL TOUR



Property Highlights

Rare opportunity to own or lease a second generation lab building in Atlanta MSA

- Two Story Office/Laboratory Building
- Existing Space: 61,024 RSF
- Pad Site (Included): Can Accommodate an Additional 232,000 RSF
- Total Potential Space: 293,024 RSF
- Total Site: Approximately 6.96 Acres
- Parking: 156 Surface Spaces 2.56/1,000 SF
- Zoning: M (Light Industrial)
- Building Completed: Q4 2016
- Tilt-Up Slab Construction
- Generator and UPS

DISTANCE TO:

4.8 miles

MERCER UNIVERSITY

9.9 miles

EMORY UNIVERSITY

14.9 miles

GEORGIA STATE UNIVERSITY

16.3 miles

GEORGIA TECH

19.0 miles

SPELMAN COLLEGE

19.1 miles

MOREHOUSE COLLEGE

30.1 miles

HARTSFIELD-JACKSON INT'L AIRPORT



CLIA & CAP
Certified Lab

Existing Site Plan



Proposed Site Plan

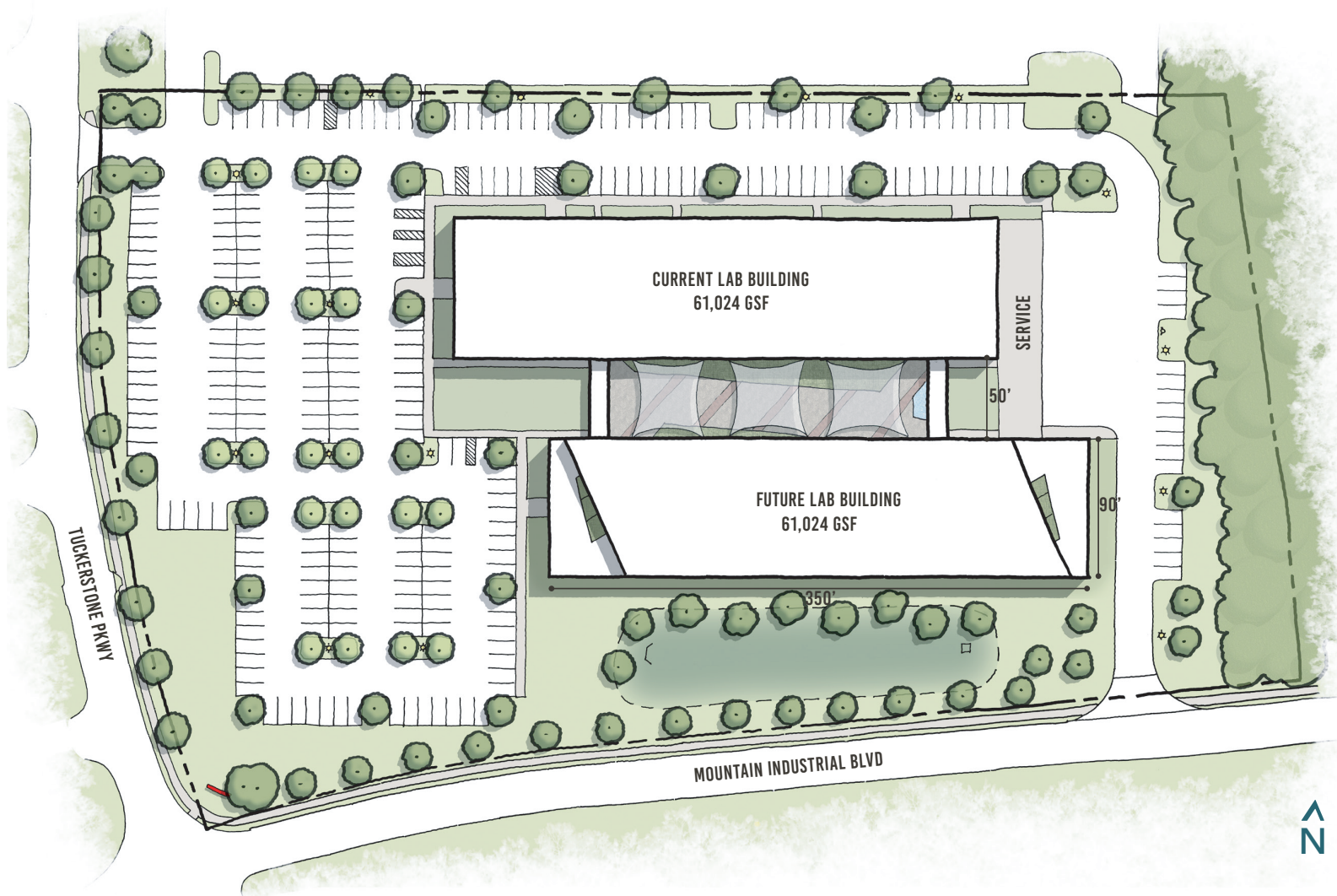

Floor Plan

FIRST FLOOR

VIEW VIRTUAL TOUR

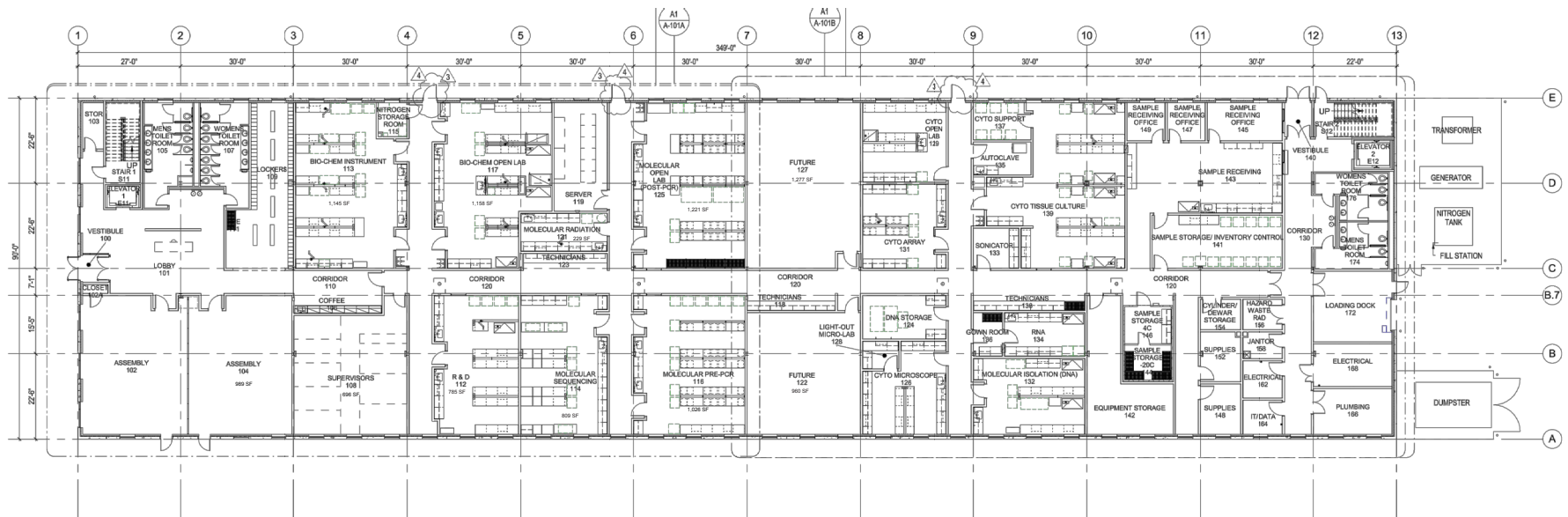

SECOND FLOOR

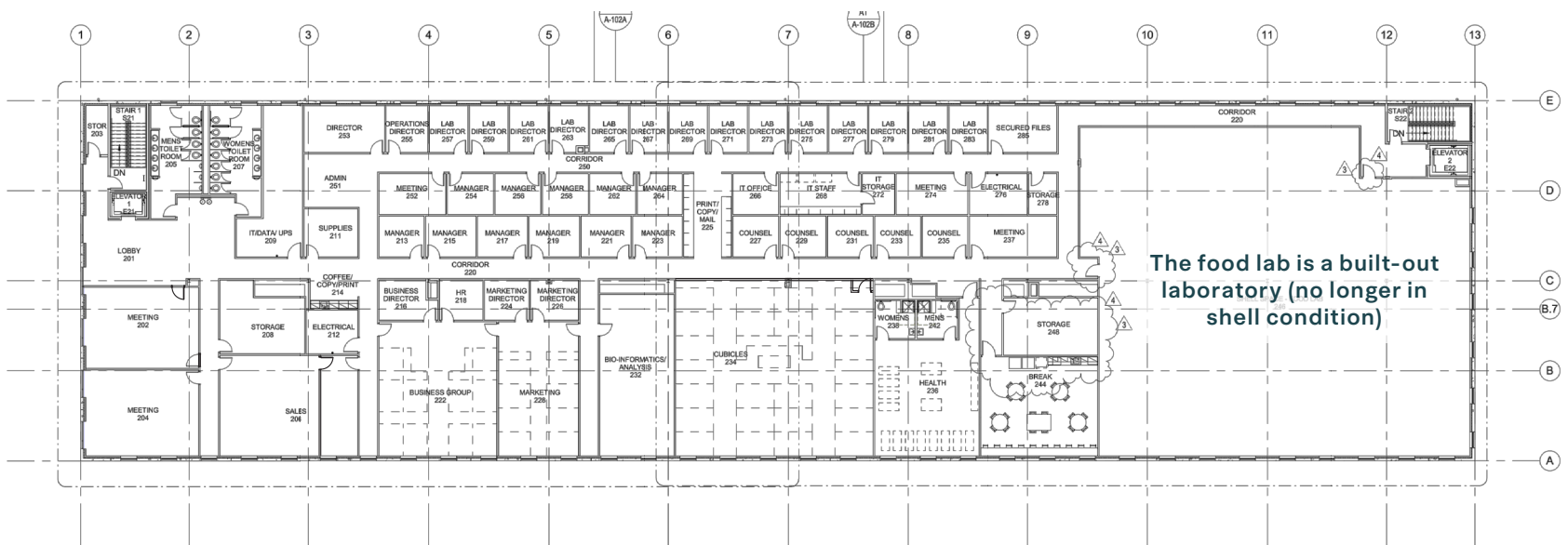

The food lab is a built-out laboratory (no longer in shell condition)

GEORGIA INNOVATION PARK

[VIEW VIRTUAL TOUR](#)



CONTACT US:

ADAM BUTLER
First Vice President
T +1 404 923 1257
C +1 404 434 9699
adam.butler@cbre.com

R. DALE LEWIS, CCIM
Senior Vice President
T +1 404 812 5123
C +1 404 307 1960
dale.lewis@cbre.com

CBRE, INC.
+1 404 504 7900
3550 Lenox Road NE
Suite 2300
Atlanta, GA 30326

© 2024 CBRE, Inc. All rights reserved. This information has been obtained from sources believed reliable, but has not been verified for accuracy or completeness. You should conduct a careful, independent investigation of the property and verify all information. Any reliance on this information is solely at your own risk. CBRE and the CBRE logo are service marks of CBRE, Inc. All other marks displayed on this document are the property of their respective owners, and the use of such logos does not imply any affiliation with or endorsement of CBRE. Photos herein are the property of their respective owners. Use of these images without the express written consent of the owner is prohibited.

CBRE