

7733 Jefferson Ave

Detroit, MI

- Suites from 5,000 RSF to 50,000 RSF
Available For Lease
- Suites Available for Educational,
General Office or Medical Uses
- Located on Pristine 18-Acre
Campus
- Spectacular Views of the
Detroit River
- Close Proximity to Grosse
Pointe & Downtown Detroit

OFFICE BUILDING FOR LEASE

FOR MORE INFORMATION:

Al Iafrate, SIOR
Senior Vice President
248.637.7791
aiafrate@LMCap.com

Mason L. Capitani, SIOR
Managing Partner
248.637.7795
MLcapitani@LMCap.com

248.637.9700 | LMCap.com

Information contained herein was obtained from sources deemed to be reliable but is not guaranteed. Subjects to prior sales, changes of price or withdrawal.



L. MASON CAPITANI

CORFAC INTERNATIONAL

CELEBRATING 60 YEARS

7733 Jefferson Ave

Detroit, MI



L. MASON CAPITANI

CORFAC INTERNATIONAL

CELEBRATING 60 YEARS

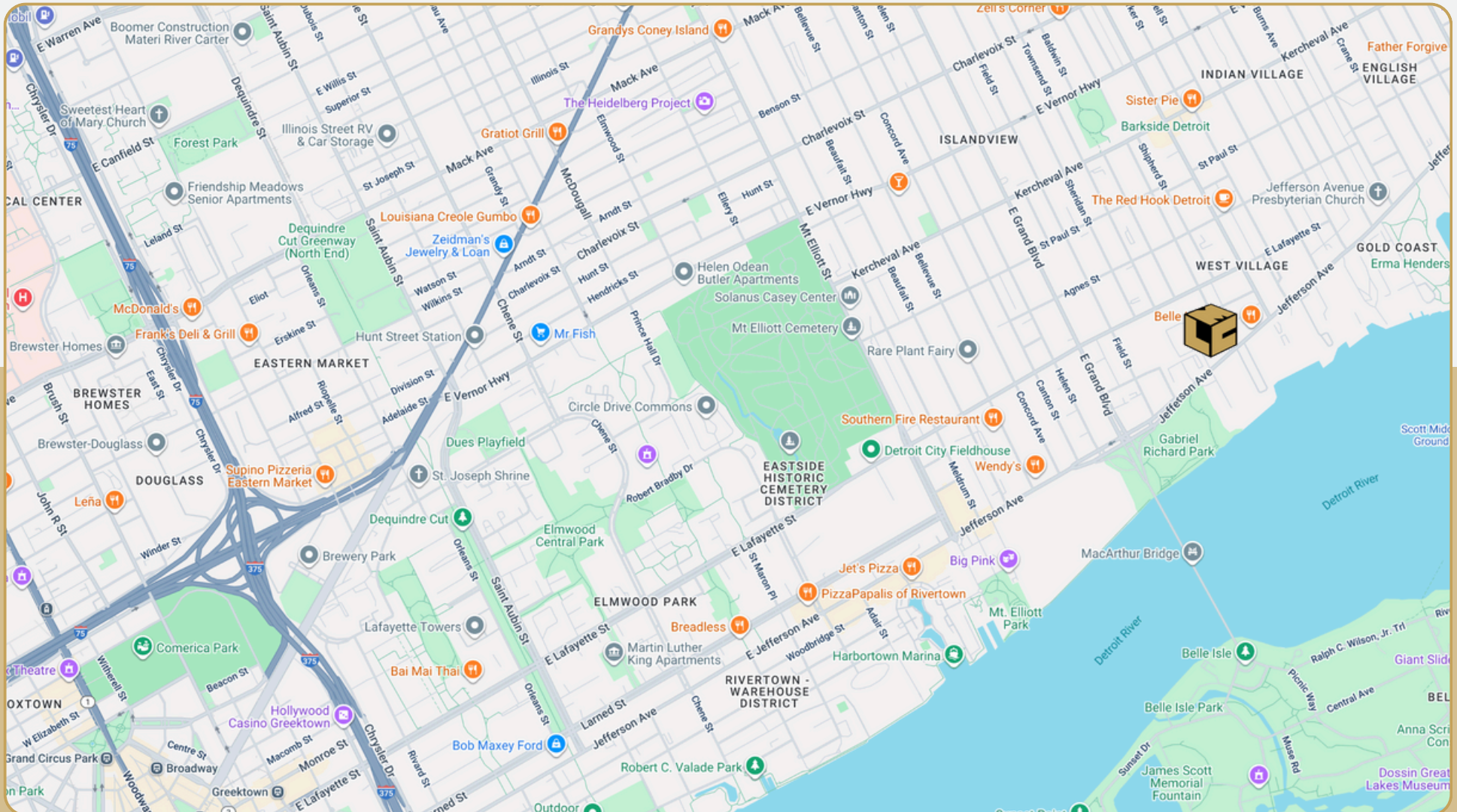

248.637.9700 | LMCap.com

Information contained herein was obtained from sources deemed to be reliable but is not guaranteed. Subjects to prior sales, changes of price or withdrawal.

7733 Jefferson Ave

Detroit, MI



L. MASON CAPITANI

CORFAC INTERNATIONAL

CELEBRATING 60 YEARS

Office Property Details:

Details:

Location Description: E Jefferson Ave & Van Dyke

Building Type: Medical

Class: B

Zoning: General Office

Floors: 7

Year Built: 1986

Year Renovated: -

Gross SF: 325,000 SF

Total Rentable SF: 325,000 SF

Available SF: 110,000 SF

Min/Max SF: 5,000 SF - 60,000 SF

Acres: 18.00

Multitenant: Yes

Parcel ID: 17-0000-404

Property Description: Located on a pristine 18-acre campus with spectacular view of the Detroit River. Suites from 5,000 square feet to full floor 60,000 square foot suites available for a multitude of uses from educational, general office or medical.

Economic:

Min/Max Rental Rate: \$11.95/SF

Rental Terms: NNN

Annual Escalations: 3%

Load Factor: TBD

Occupancy: Immediate

Parking: 1,108 Spaces

Partition Allowance: Negotiable

Signage: Yes

Status: Existing

Operating Expenses: \$10.50

248.637.9700 | LMCap.com

Information contained herein was obtained from sources deemed to be reliable but is not guaranteed. Subjects to prior sales, changes of price or withdrawal.

7733 Jefferson Ave

Detroit, MI



L. MASON CAPITANI

CORFAC INTERNATIONAL

CELEBRATING 60 YEARS

Available Suites:



1st Floor: 5,000 - 50,000 SF

Suite 201: 10,000 SF

Suite 202: 8,500 SF

248.637.9700 | LMCap.com

Information contained herein was obtained from sources deemed to be reliable but is not guaranteed. Subjects to prior sales, changes of price or withdrawal.

7733 Jefferson Ave

Detroit, MI



L. MASON CAPITANI

CORFAC INTERNATIONAL

CELEBRATING 60 YEARS

First Floor Vacancies



Suite Number	Square Footage
1st Floor	5,000 - 50,000 SF

248.637.9700 | LMCap.com

Information contained herein was obtained from sources deemed to be reliable but is not guaranteed. Subjects to prior sales, changes of price or withdrawal.

7733 Jefferson Ave

Detroit, MI



L. MASON CAPITANI

CORFAC INTERNATIONAL

CELEBRATING 60 YEARS

Second Floor Vacancies

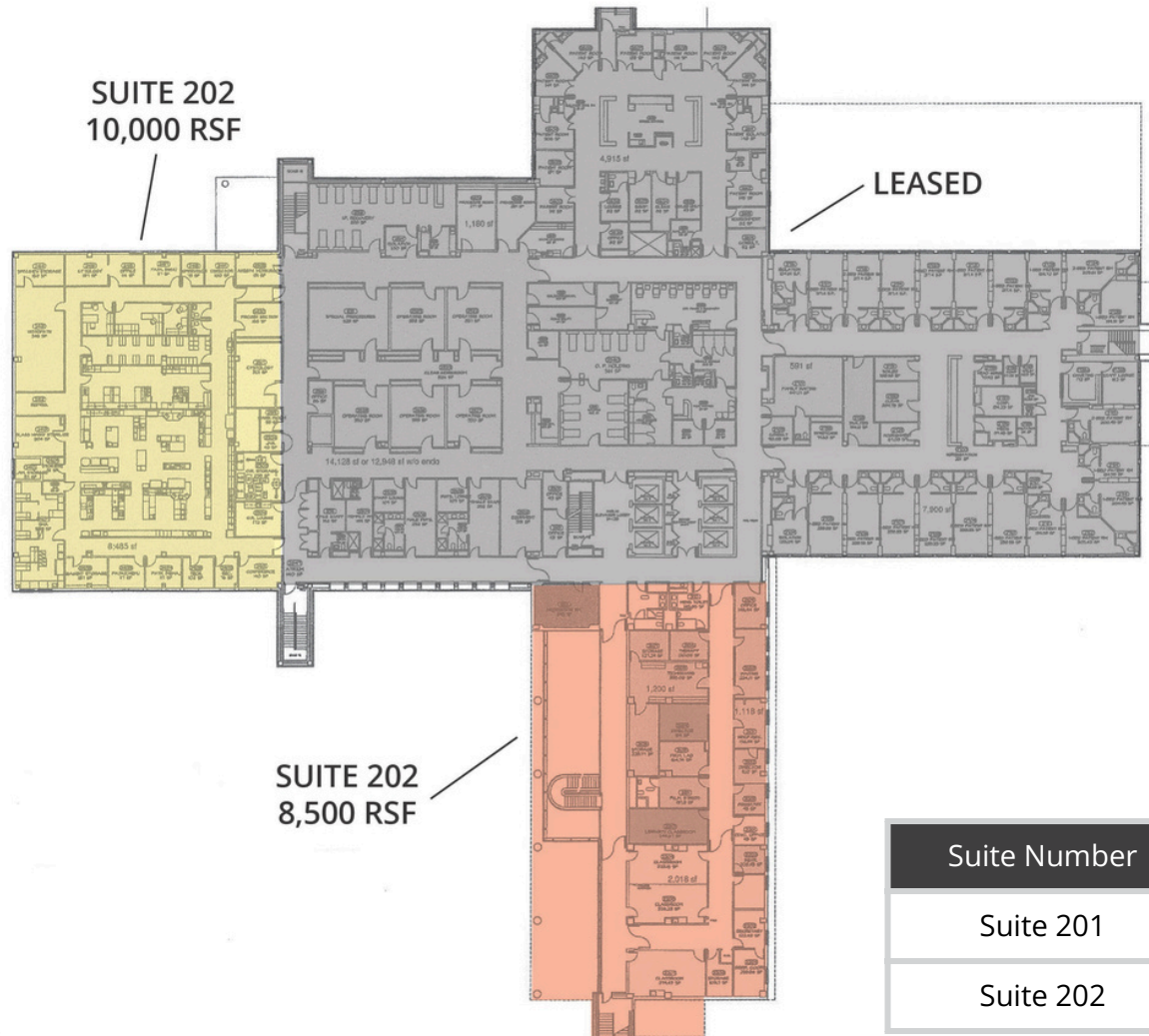

Suite Number	Square Footage
Suite 201	10,000 SF
Suite 202	8,500 SF

248.637.9700 | LMCap.com

Information contained herein was obtained from sources deemed to be reliable but is not guaranteed. Subjects to prior sales, changes of price or withdrawal.

7733 Jefferson Ave

Detroit, MI

Site Plan



L. MASON CAPITANI

CORFAC INTERNATIONAL

CELEBRATING 60 YEARS

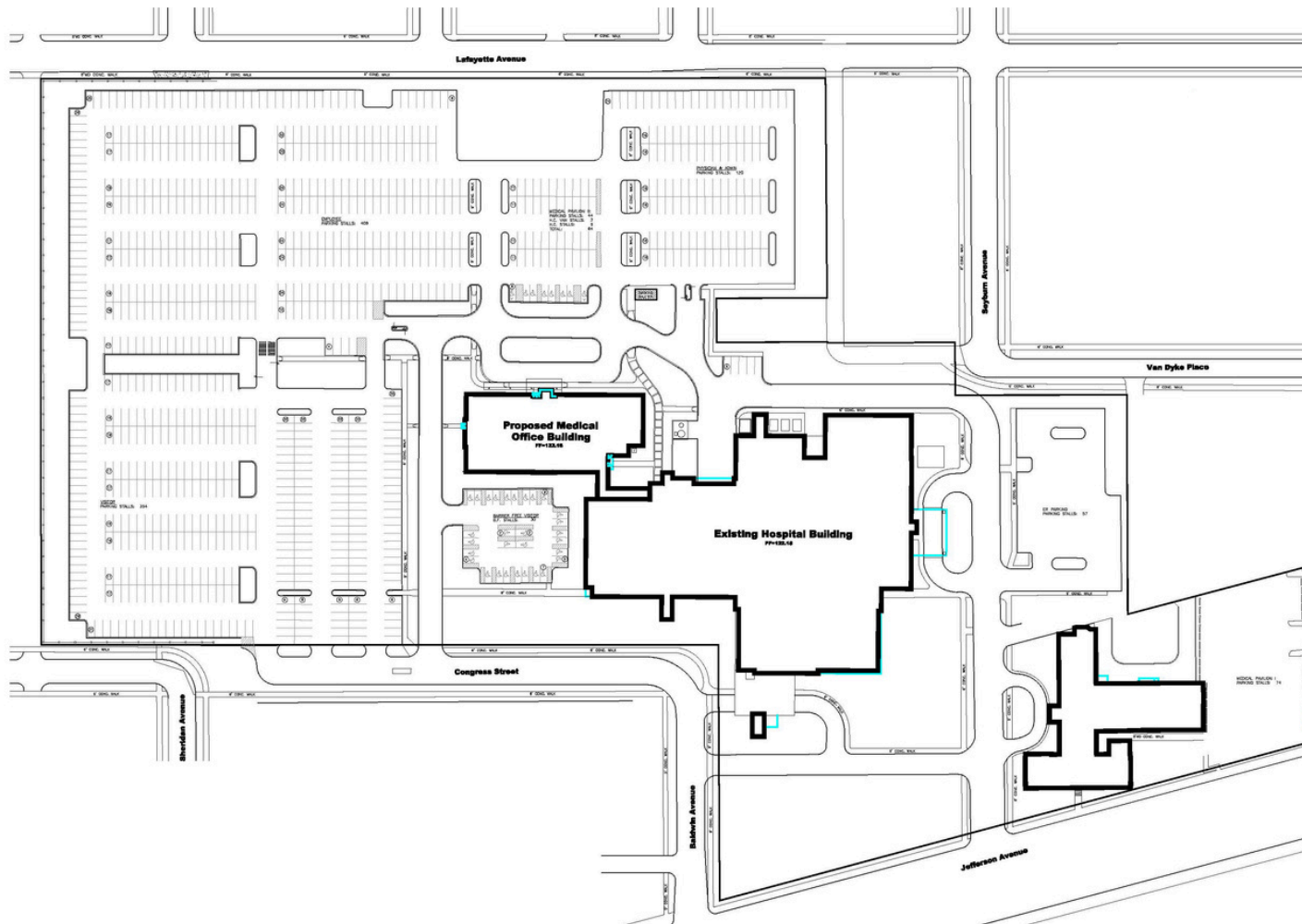

248.637.9700 | LMCap.com

Information contained herein was obtained from sources deemed to be reliable but is not guaranteed. Subjects to prior sales, changes of price or withdrawal.