

For Sublease 800 North Brand Blvd

GLENDAL, CA 91203 | UP TO ±66,989 SF

800
NORTH
BRAND

800

NEWMARK

Will Adams
Executive Managing Director
t 213-596-2232
will.adams@nmrk.com
CA RE Lic. #01131941

Michael Rudis
Transaction Director
t 310-625-9779
michael.rudis@nmrk.com
CA RE Lic. #01990499

800 NORTH BRAND BLVD | FOR SUBLEASE

800 North Brand Blvd

LARGE BLOCK FOR SUBLEASE

Location

800 North Brand Blvd, Glendale, CA 91203

Size

Up to ±66,989 SF

Asking Rate

\$X.XX/SF/Month, Full Service

Sublease Term

Through July 31, 2026

Possession

Immediately

Parking

On Site Garage

- \$100 / unreserved
- \$140 / reserved



Space	Description	Asking Rate	Square Feet
2nd Floor	Partial 2nd floor. Raw space. TI allowance available.	\$X.XX FSG	15,708 SF
10th Floor	Entire 10th floor. Traditional office buildout.	\$X.XX FSG	25,897 SF
11th Floor	Entire 11th floor. Traditional office buildout.	\$X.XX FSG	25,384 SF
Total Available			66,989 SF

Fitness Center



State of the art, 12,000-square-foot fitness center located on the second floor, exclusively for tenants.

Food



7,000 square feet of on-site food options and easy access to downtown Glendale restaurants and bars.

Basketball



Half-court basketball located behind the building, next to the parking garage.

Lounge



Brand new tenant lounge with amphitheater style seating, kitchen and media features.

Fresh Air



Enjoy multiple areas of patio seating off the tenant lounge or in the front courtyard.

Parking



Easy access to the private parking garage with EV charging.

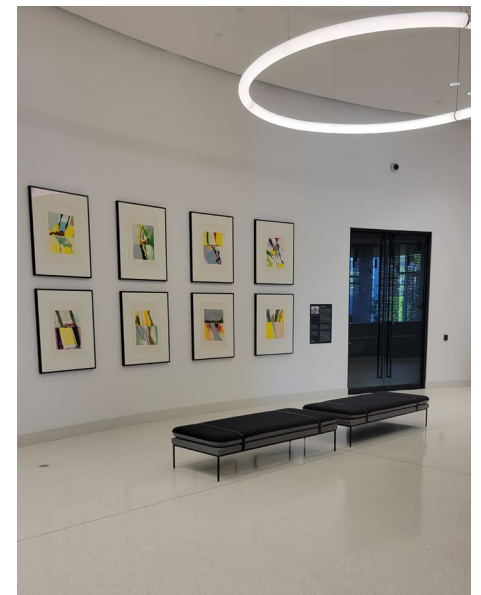

2nd Floor (Hypothetical Buildout)

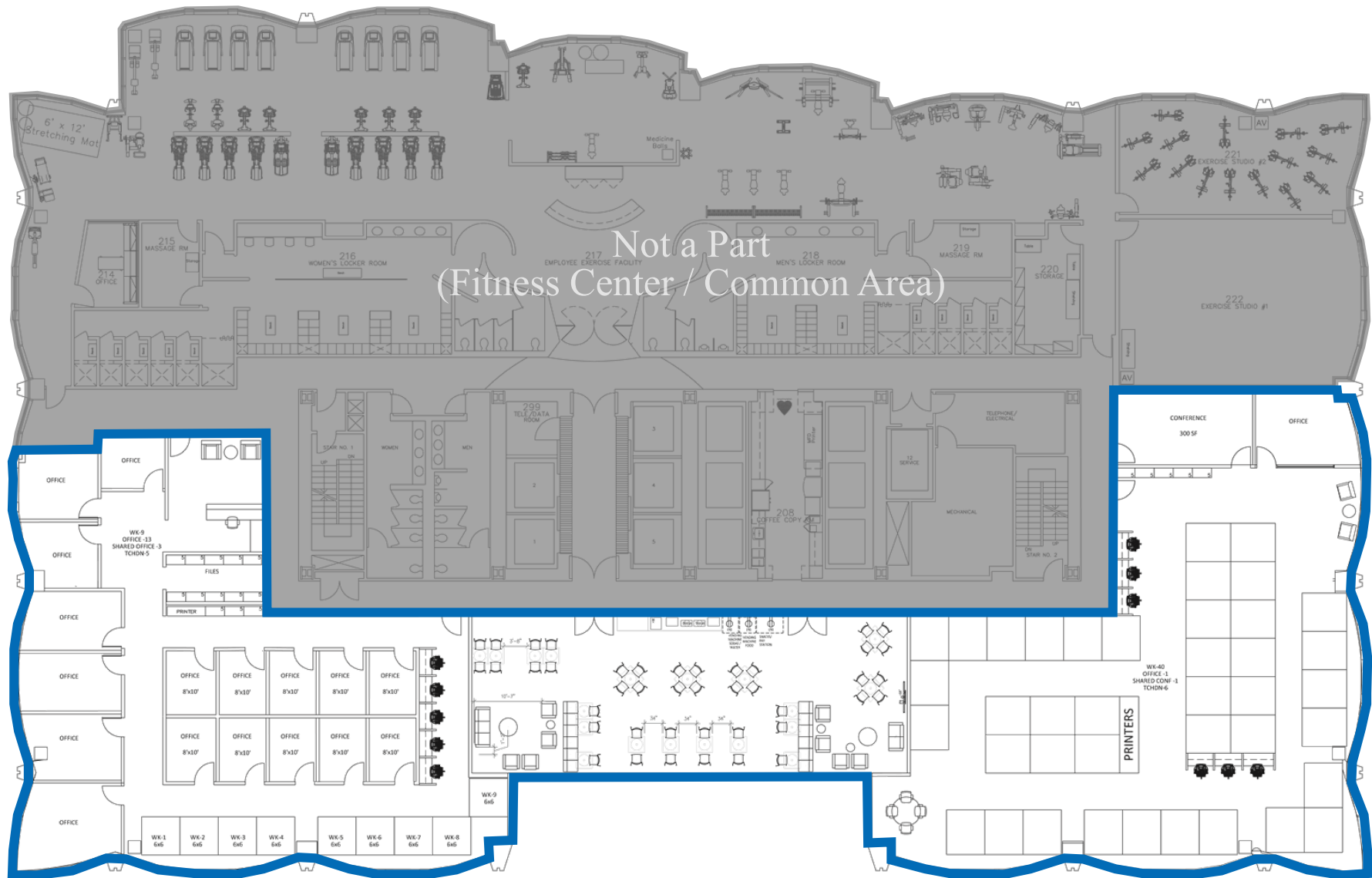

10th Floor

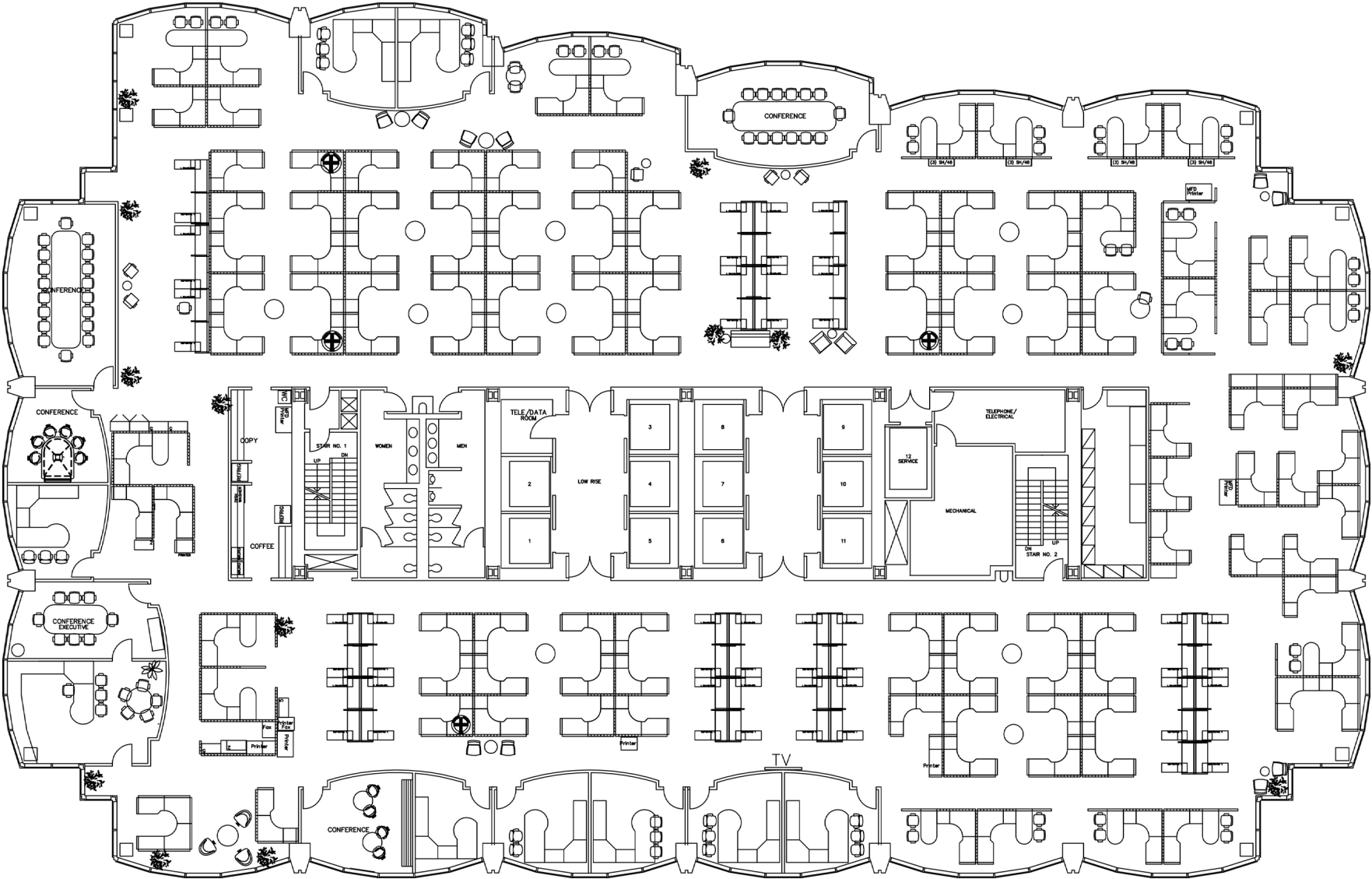

Floor plans are for illustrative purposes only and may not reflect current conditions. Lessee to verify and satisfy itself with all current conditions.

11th Floor

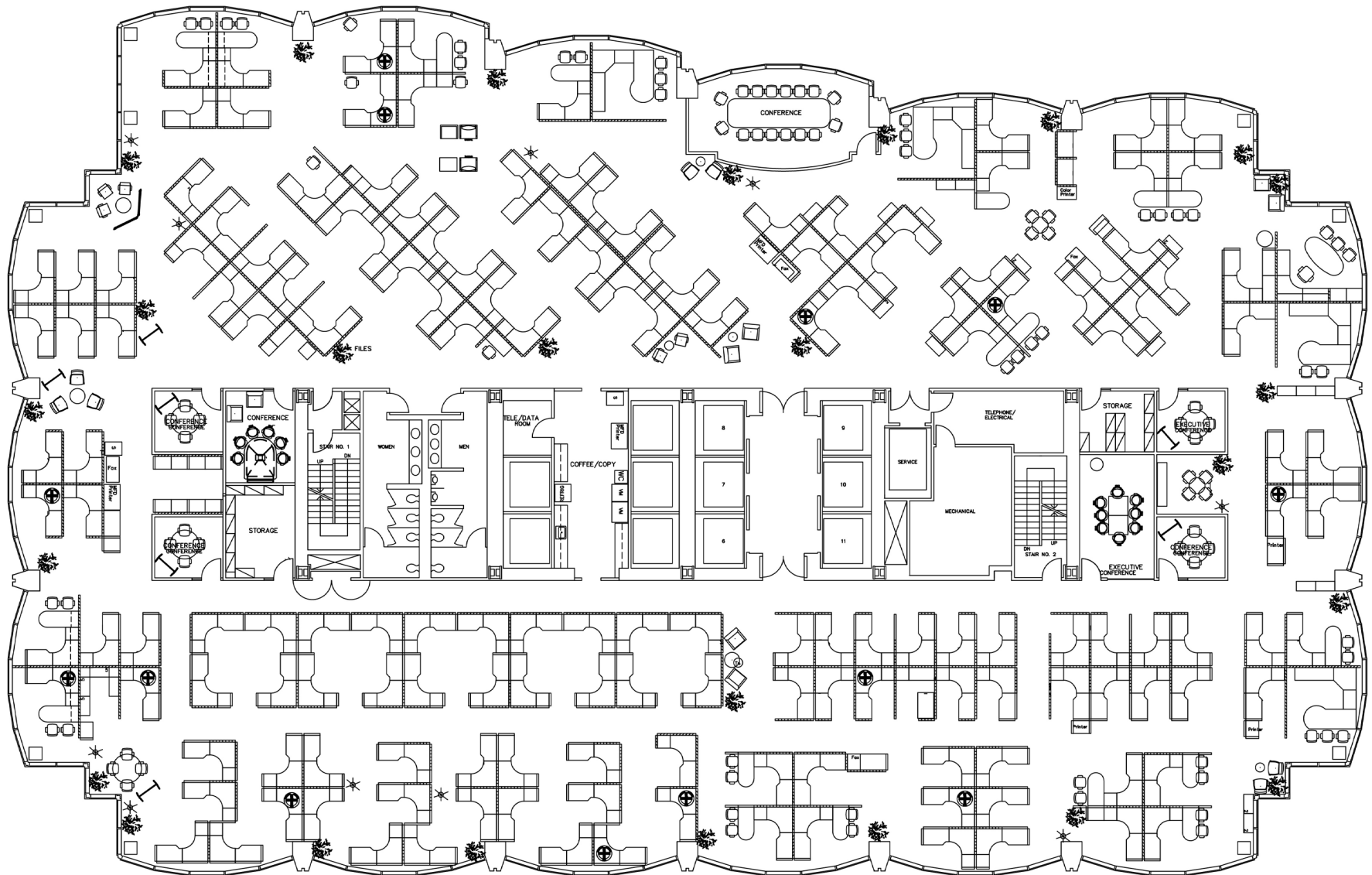

800 NORTH BRAND BLVD | FOR SUBLEASE



800 North Brand Blvd Glendale, CA 91203

Prepared by:

Will Adams
Executive Managing Director
t 213-596-2232
will.adams@nmrk.com
CA RE Lic. #01131941

Michael Rudis
Transaction Director
t 310-625-9779
michael.rudis@nmrk.com
CA RE Lic. #01990499

The broker for a sublessee of the property shall be entitled to receive a real estate commission only in the event that broker and the sublessor execute a written commission agreement containing the manner of calculation of that commission and all conditions to its payment, and the satisfaction of those conditions. Absent a written agreement to the contrary between that broker and Newmark, that broker shall not look to Newmark for payment of such a commission or any other compensation.

Although all information furnished regarding property for sale, lease, or financing has been obtained from sources deemed to be reliable, that information has not been verified by Newmark and no express representation is made nor is any to be implied as to the accuracy thereof. That information is subject to errors, omissions, change of price, rental or other conditions, prior sale, lease or financing, or withdrawal without notice and to any special conditions imposed by Newmark client. The purchaser must independently verify any information on which it intends to rely.

Corporate License #1355491