

Land Active
MLS# 828363

286 State Rte 130, Valparaiso, IN 46385

\$249,900

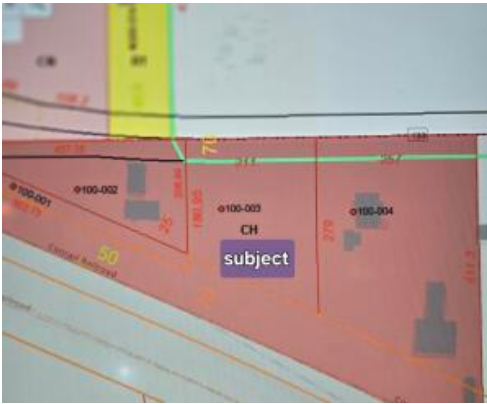

SubType:	Unimproved Land	Parcel #:	640916100003000003	DOM/CDOM:	0/0
Lot Acres:	1.1	Zoning:	Commercial	County:	Porter
Lot Size:	47,916	Assoc:	No	Township:	Center
SqFt:		Assoc Fee:		School Dist:	Valparaiso
LP/Acre:	\$5,000	Waterfront:	No	Elem:	
Number Of:	1	Water Body:		Mid/Jr:	
Lots:				High Sch:	
Avail Date:				Subdiv:	
Inclusions:				Tax Annual:	\$473
				Tax Yr:	2024

Public Remarks: "Prime commercial land Zoned High Intensity Commercial CH District. Just Over 1 acre of vacant land located on a major road, W St. Rd 130, in Valparaiso, IN, offering excellent visibility and accessibility for your business. This is the perfect location to build your commercial establishment and take advantage of the high traffic count and convenient location. Don't miss out on this opportunity to secure your business's future success!" NWI is a booming market for the Entrepreneur to achieve their goals. Nearby Public transportation, Major Highways, nearby downtown and historical district of the hustling and bustling City of Valparaiso Indiana, the Heart of Porter County Indiana.

Private Remarks:

Tax Legal Description: PARC IN E211 W847.5 N279 N OF RR NW 16-35-6 1.1A DR491 P23

Directions: Rt 30 to N375w to 130 e to property on the south side of street next to gas station.

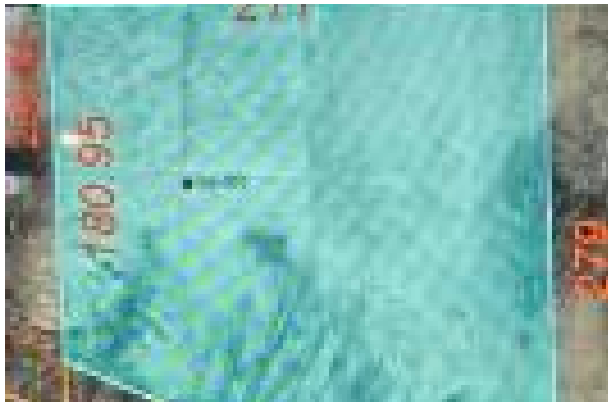
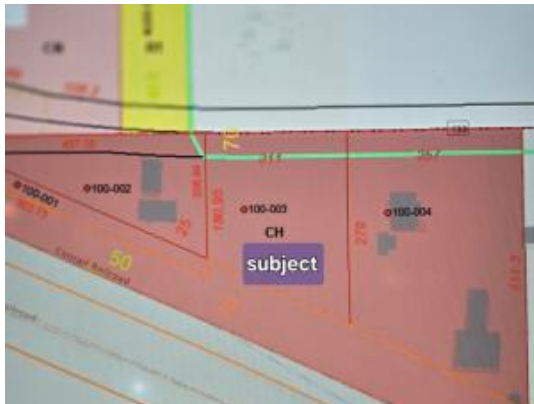



Information is deemed to be reliable, but is not guaranteed. © 2025 [MLS](#) and [FBS](#). Prepared by Nancy Frigo, Nancy Frigo Team Of Coldwell Banker Realty on Friday, September 26, 2025 1:08 AM. The information on this sheet has been made available by the MLS and may not be the listing of the provider.