

2017 Fisher Arch, Virginia Beach, VA

Medical | Professional OFFICE & RETAIL SITE FOR LEASE



ABOUT PROPERTY

- ± 3,645 RSF For Lease
- Zoning: O-2
- Located just off the intersection of Sandbridge Rd. and Princess Anne Rd.
- Conveniently near Lago Mar, Sandbridge, Asheville Park, Heritage Park and Red Mill residential neighborhoods
- 21,196 VPD along Princess Anne Road
- Space Delivered: Warm Lit Shell Condition
- ASKING RENT: \$26.50 psf (excluding electric & interior janitorial)

POPULATION (2023):		
1-mi. 7,548	3-mi. 44,562	5-mi. 71,550

HOUSEHOLDS (2023):		
1-mi. 2,522	3-mi. 14,886	5-mi. 24,585

AVG. HOUSEHOLD INCOME (2023):		
1-mi. \$167,252	3-mi. \$141,680	5-mi. \$133,681

For more information:
PETER D. ABRAHAM, CCIM
 757.640.8226
PeterAbraham@HarveyLindsay.com

999 Waterside Drive • Suite 1400
 Norfolk, Virginia 23510
 757-640-8700
www.HarveyLindsay.com

HARVEY LINDSAY
 COMMERCIAL REAL ESTATE

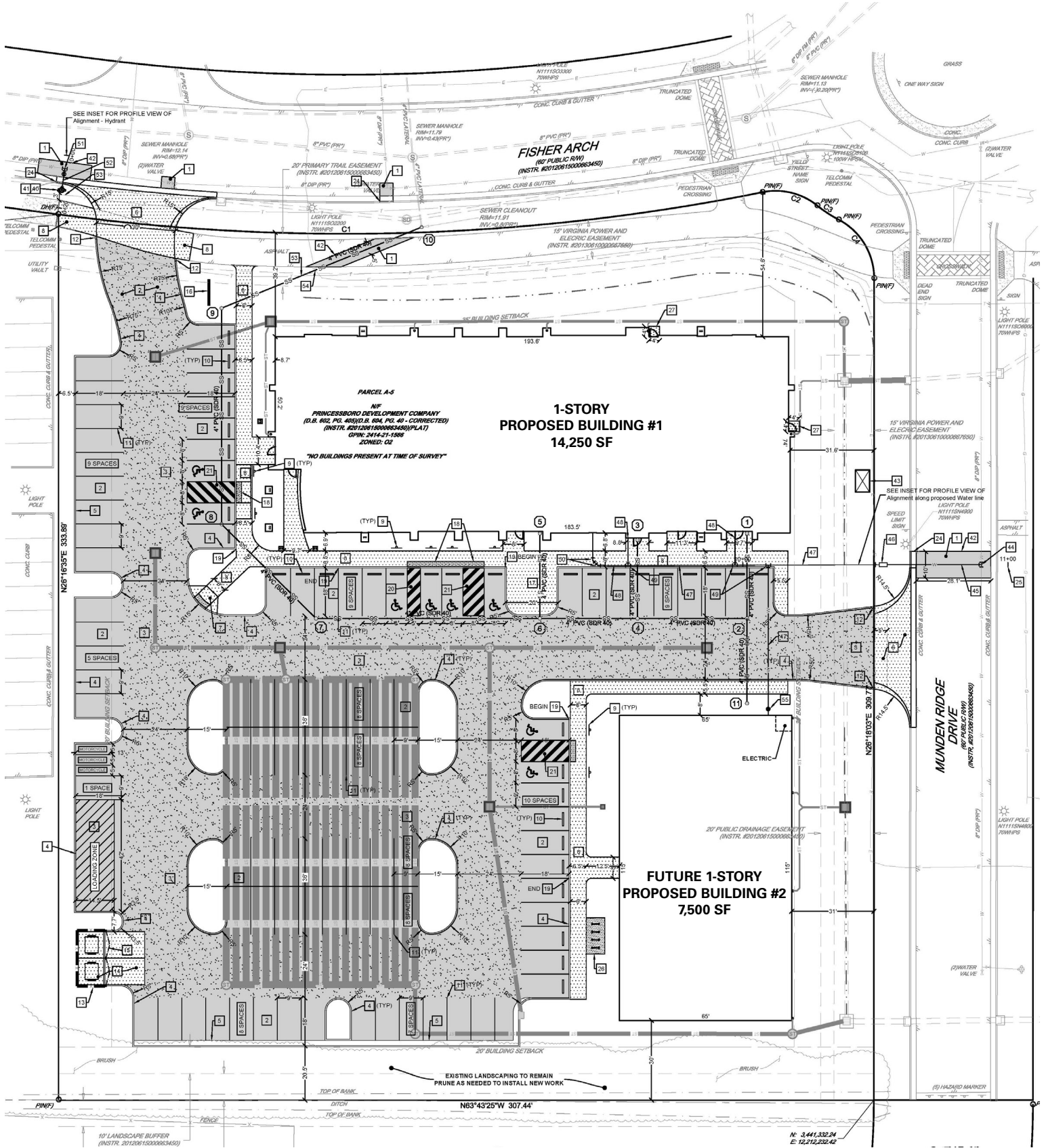

For more information:
PETER D. ABRAHAM, CCIM
 757.640.8226
 PeterAbraham@HarveyLindsay.com

999 Waterside Drive • Suite 1400
 Norfolk, Virginia 23510
 757-640-8700
www.HarveyLindsay.com

HARVEY LINDSAY
 COMMERCIAL REAL ESTATE