

FOR LEASE

1,604-5,306 SF

High Profile New Retail/Restaurant Space

1025 SE Cleveland Square Loop, Bend, OR 97702



PROPERTY DETAILS

- Suite A:** 2,091 SF - \$60/SF/Yr. NNN
- Suite B:** 1,604 SF - \$40/SF/Yr. NNN
- Suite C:** 1,611 SF - \$40/SF/Yr. NNN
- CAMs:** Est. at \$9.00/SF/Yr.
- Bldg. Size:** 5,612 SF
- Zoning:** General Commercial District (CG)

HIGHLIGHTS

- Excellent high visibility restaurant/retail opportunity
- Easy access to Hwy 97 and Reed Market South
- Three retail spaces available with Suite A providing option for drive-thru
- High traffic counts of 20,125 AADT (2025) on SE 3rd Street
- 23 onsite parking spaces

Russell Huntamer, CCIM | Jay Lyons, CCIM, SIOR
Eli Harrison, Broker

600 SW Columbia St., Ste. 6100 | Bend, OR 97702
541.383.2444 | www.CompassCommercial.com

COMPASS
COMMERCIAL

REAL ESTATE SERVICES

FOR LEASE

1,604-5,306 SF

High Profile New Retail/Restaurant Space

1025 SE Cleveland Square Loop, Bend, OR 97702

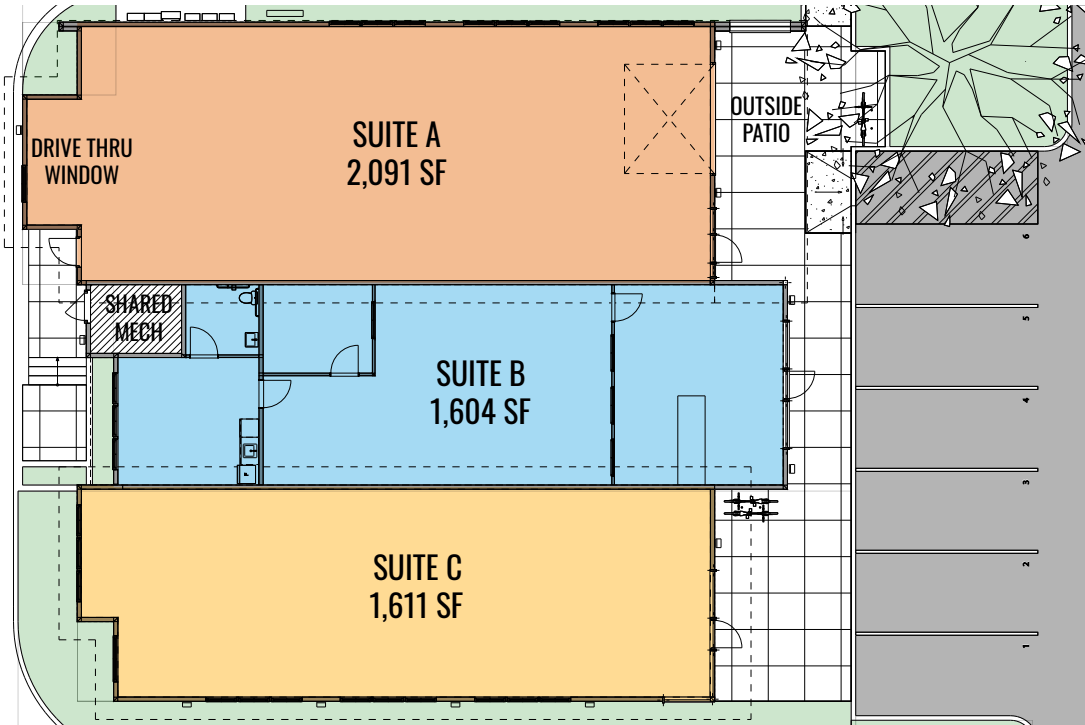

Brokers are licensed in the state of Oregon. This information has been furnished from sources we deem reliable, but for which we assume no liability. This is an exclusive listing. The information contained herein is given in confidence with the understanding that all negotiations pertaining to this property be handled through Compass Commercial Real Estate Services. All measurements are approximate.



Russell Huntamer, CCIM
Partner, Principal Broker
Cell 541.419.2634
rh@compasscommercial.com



Jay Lyons, SIOR, CCIM
Partner, Principal Broker
Cell 541.410.6519
jlyons@compasscommercial.com



Eli Harrison
Broker
Cell 541.977.2890
eharrison@compasscommercial.com

COMPASS COMMERCIAL
REAL ESTATE SERVICES