



PREMIER INDUSTRIAL SALE OR LEASE
OPPORTUNITY IN SANTA MARIA, CA

2105 S BLOSSER RD, SANTA MARIA, CA 93458



TABLE OF CONTENTS

Exclusively Listed by

BENTLEY MCKEAN, CCIM
Kidder Mathews
805.626.7120
bentley.mckean@kidder.com
LIC N° 02080641

ABEL CONTRERAS
InvestSLO
805.295.2719
abel@investslo.com
LIC N° 02062620

JEFFREY M. CROCKER
Kidder Mathews
805.626.6550
jeffrey.crocker@kidder.com
LIC N° 01457097



KIDDER.COM

INVESTSLO.COM

The information contained in the following Marketing Brochure is proprietary and strictly confidential. It is intended to be reviewed only by the party receiving it from Kidder Mathews and should not be made available to any other person or entity without the written consent of Kidder Mathews.

This Marketing Brochure has been prepared to provide summary, unverified information to prospective purchasers, and to establish only a preliminary level of interest in the subject property. The information contained herein is not a substitute for a thorough due diligence investigation. Kidder Mathews has not made any investigation, and makes no warranty or representation, with respect to the income or expenses for the subject property, the future projected financial performance of the property, the size and square footage of the property and improvements, the presence or absence of contaminating substances, PCB's or asbestos, the compliance with State and Federal regulations, the physical condition of the improvements thereon, or the financial condition or business prospects of any tenant, or any tenant's plans or intentions to continue its occupancy of the subject property. The information contained in this Marketing Brochure has been obtained from sources we believe to be reliable; however, Kidder Mathews has not verified, and will not verify, any of the information contained herein, nor has Kidder Mathews conducted any investigation regarding these matters and makes no warranty or representation whatsoever regarding the accuracy or completeness of the information provided. All potential buyers must take appropriate measures to verify all of the information set forth herein.

This information has been secured from sources we believe to be reliable. We make no representations or warranties, expressed or implied, as to the accuracy of the information. References to square footage or age are approximate. Recipient of this report must verify the information and bears all risk for any inaccuracies.

01
EXECUTIVE
SUMMARY

02
PROPERTY
OVERVIEW

03
LOCATION
OVERVIEW

04
PROPERTY
PHOTOS

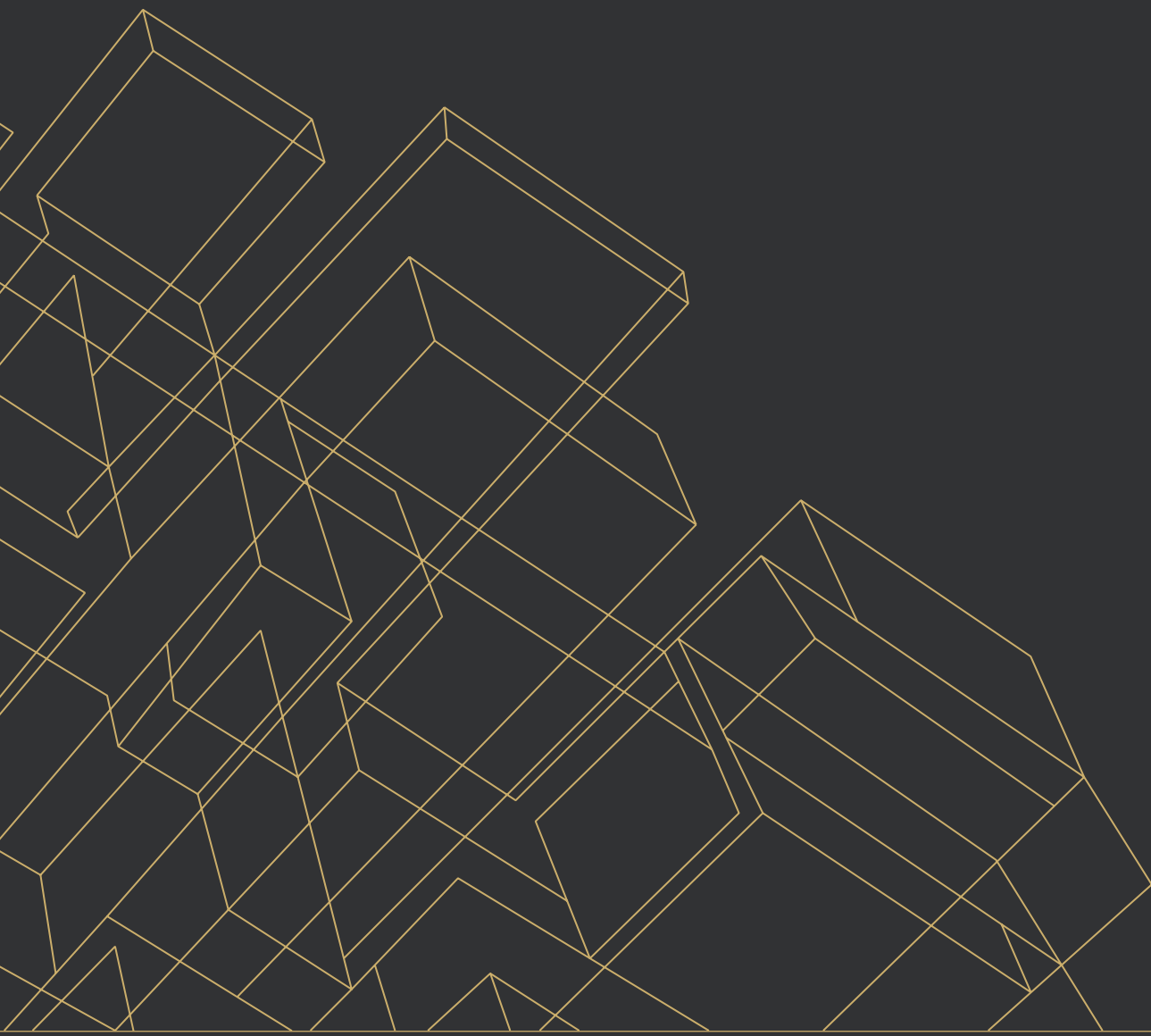

EXECUTIVE SUMMARY

PREMIER SANTA MARIA INDUSTRIAL BUILDING

Kidder Mathews and InvestSLO, as exclusive advisors, are pleased to present the opportunity to lease or acquire an industrial building with an existing buildout catering to the R&D, Aerospace, and Biotech sectors with the flexibility to accommodate a wide range of uses.

Equipped with separate entrances leading to the upstairs and a spacious two-acre lot, this opportunity offers owner-users the option to lease out excess space and grow into the rest of the facility, or occupy the entire premises.

ADDRESS	2105 S Blosser Rd, Santa Maria CA 93458
SALE PRICE	\$3,275,000
LEASE RATE	\$18,400/mo
RBA	23,000 SF
LOT SIZE	2 AC (87,120 SF)
ZONING	PD/M1/CM

\$142

PRICE / SF

\$0.80

LEASE RATE (NNN)

1984

YEAR BUILT

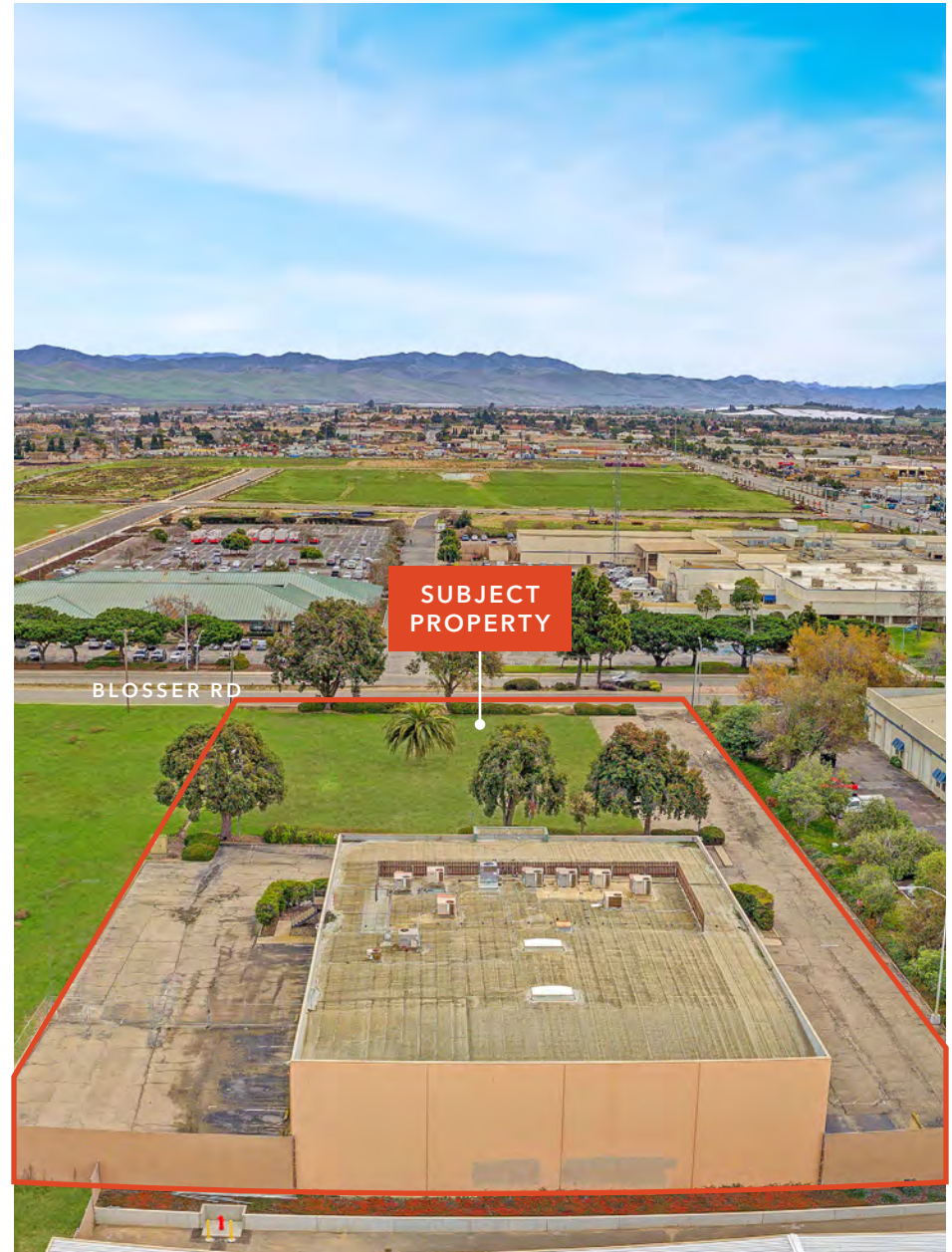

INVESTMENT HIGHLIGHTS

Ideal Industrial Location

SBA Financing Available

Buildout Clean Room

Operational Elevator

Business Friendly and Rapidly Growing Santa Maria

Great workforce demographics



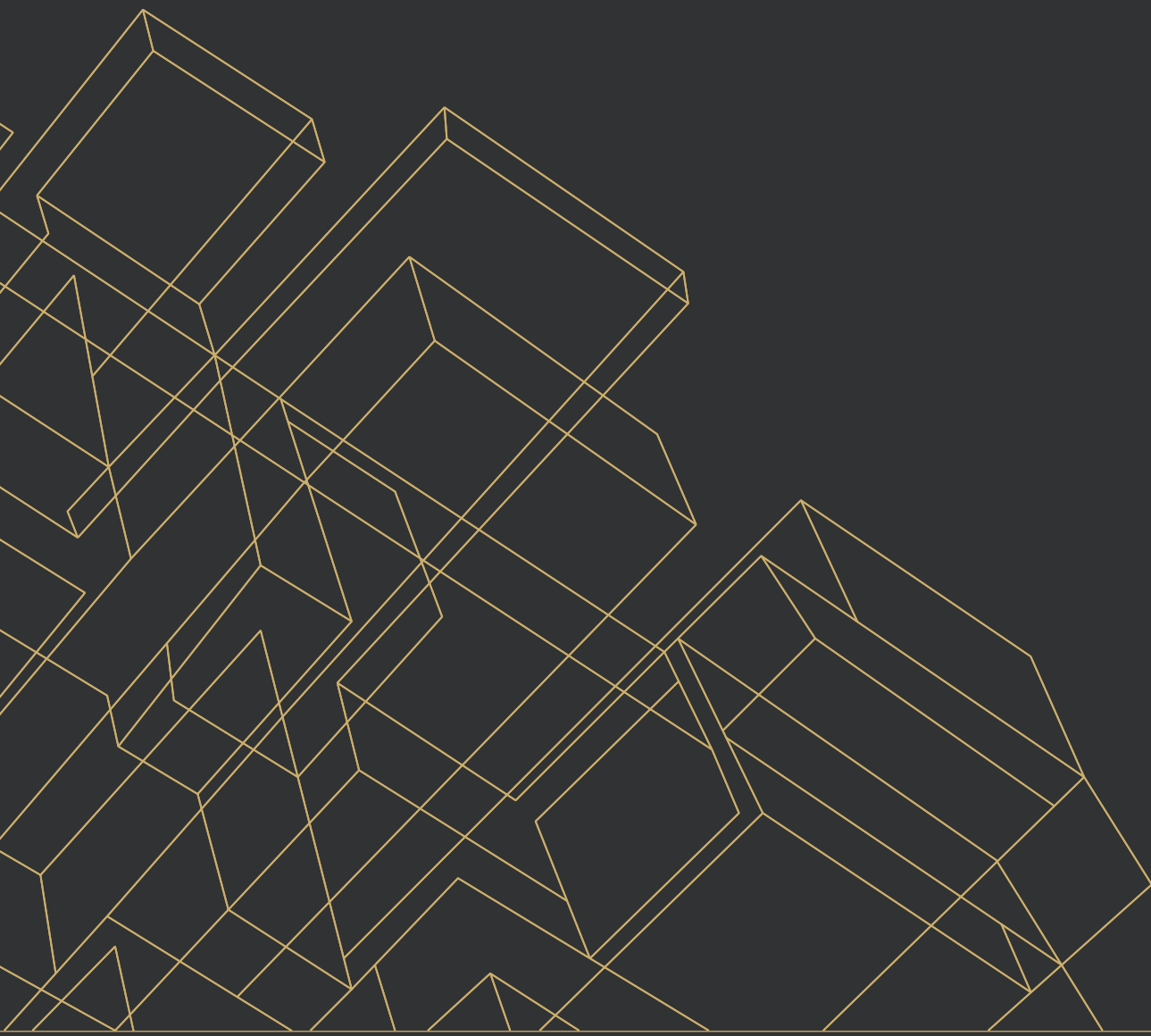

PROPERTY OVERVIEW

PROPERTY INFORMATION

PROPERTY OVERVIEW

ADDRESS	2105 S Blosser Rd, Santa Maria CA 93458
CONSTRUCTION	Concrete
PRICE	\$3,275,000
PRICE / SF	\$142/SF
BUILDING AREA	23,000 SF
SECOND STORY AREA	9,500 sf
APN	117-770-018
DOORS	2 (20' x 14') roll ups
POWER	600A, 240V, 3P



23,000

TOTAL RSF

PD/M1/CM

ZONING

2

LOT AC

28'

CLEAR HEIGHT

87,120

LOT SF

1984

YEAR BUILT

FIRST FLOOR PLAN

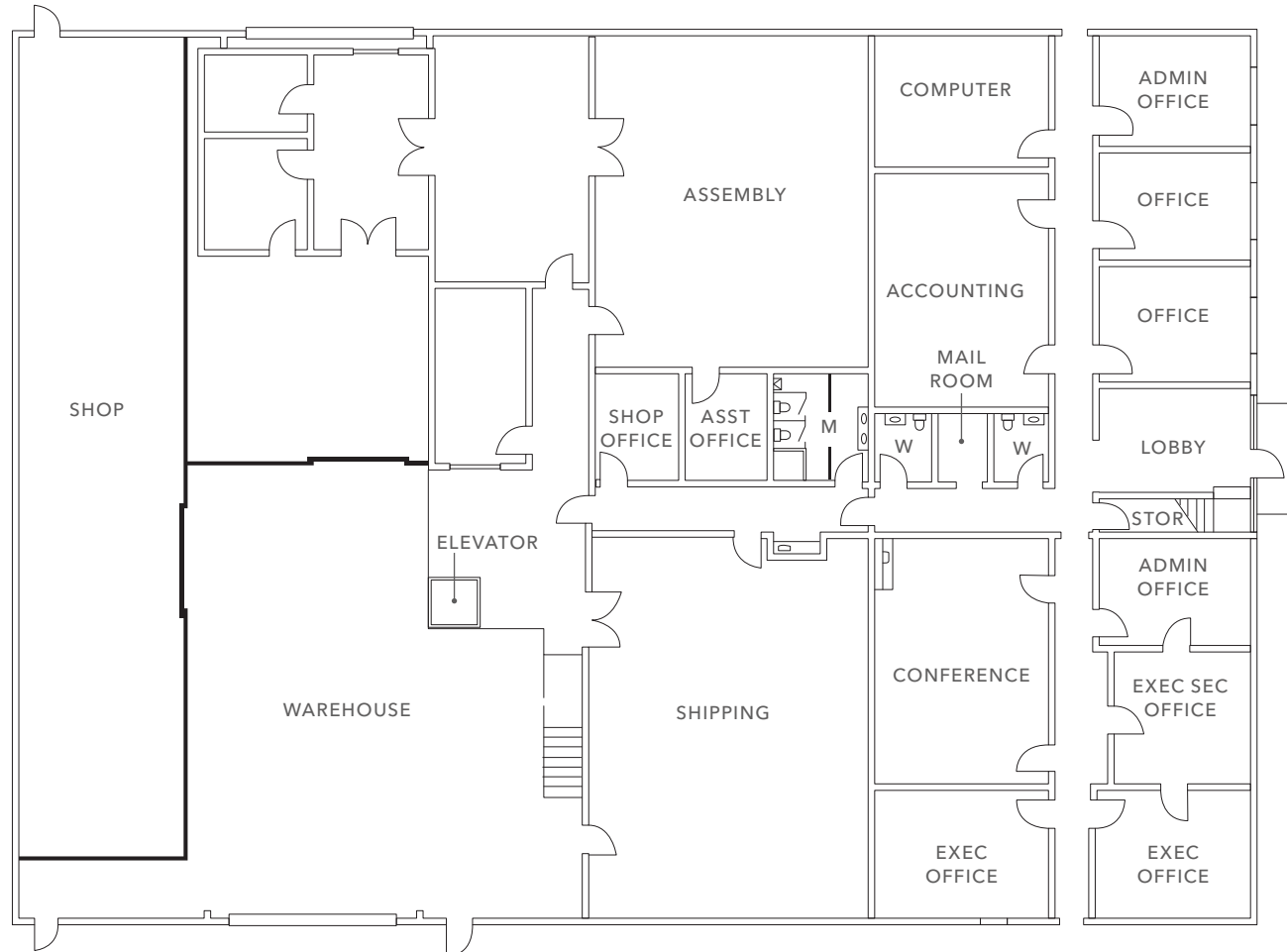

*Not to scale

SECOND FLOOR PLAN

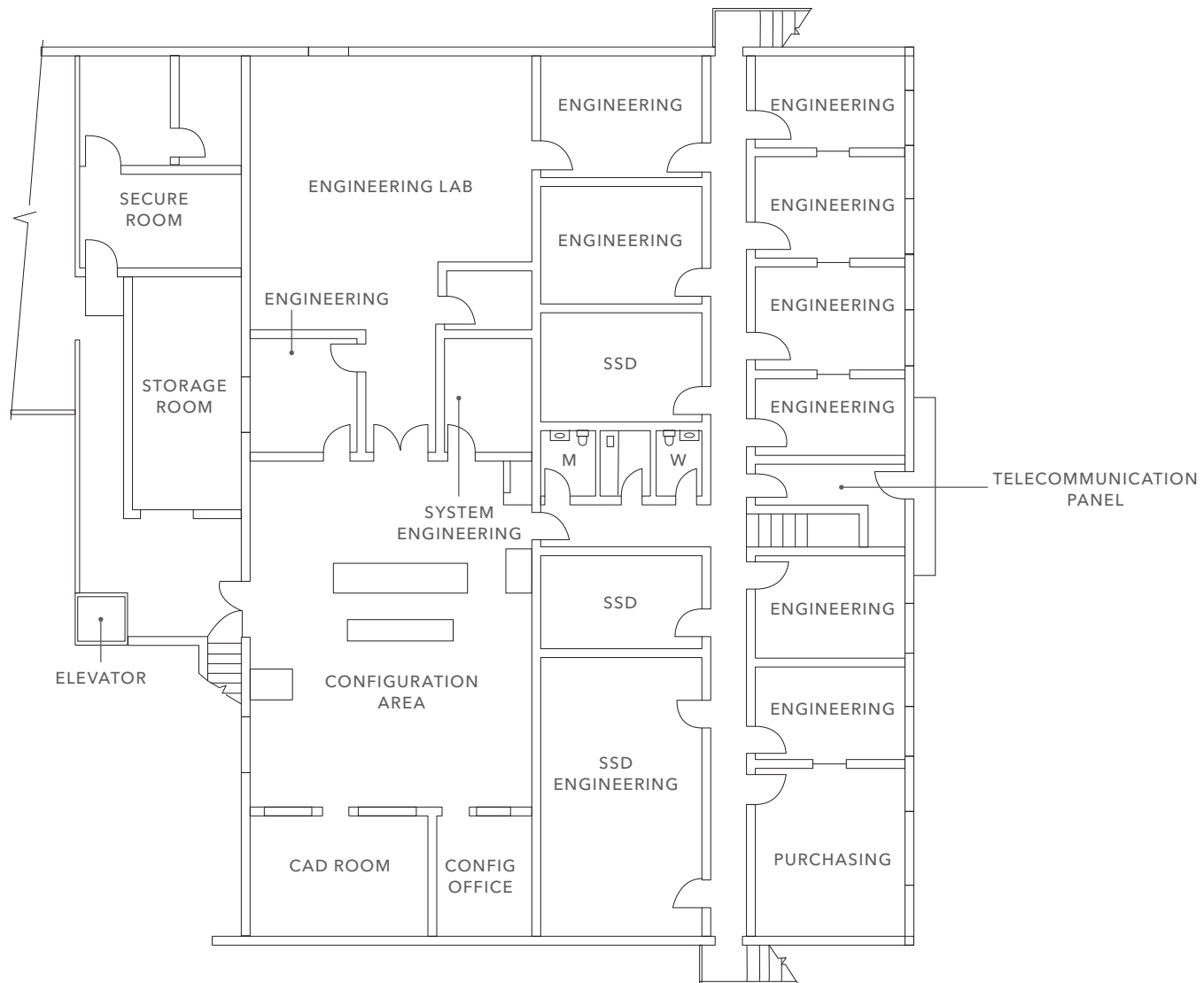

*Not to scale

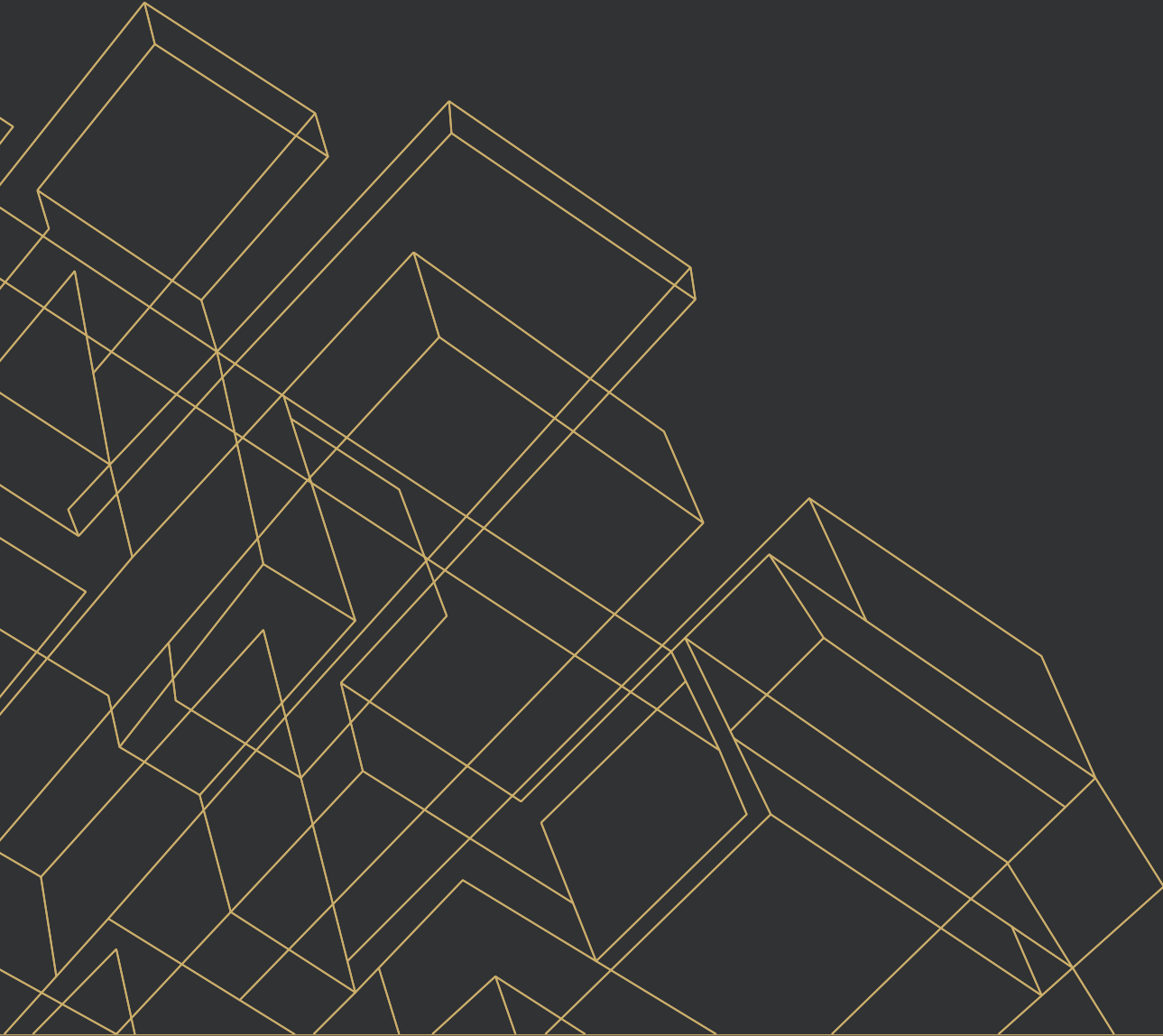

LOCATION OVERVIEW

LOCATION OVERVIEW



KIDDER MATHEWS

DEMOGRAPHICS

ESTIMATED POPULATION

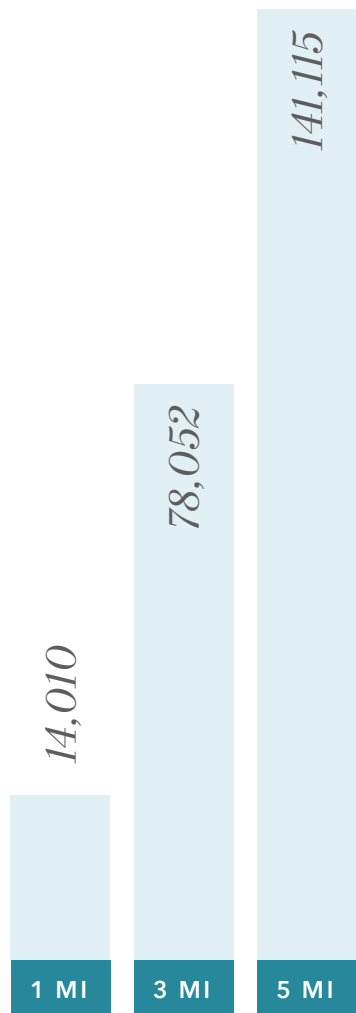

AVERAGE HOUSEHOLD INCOME

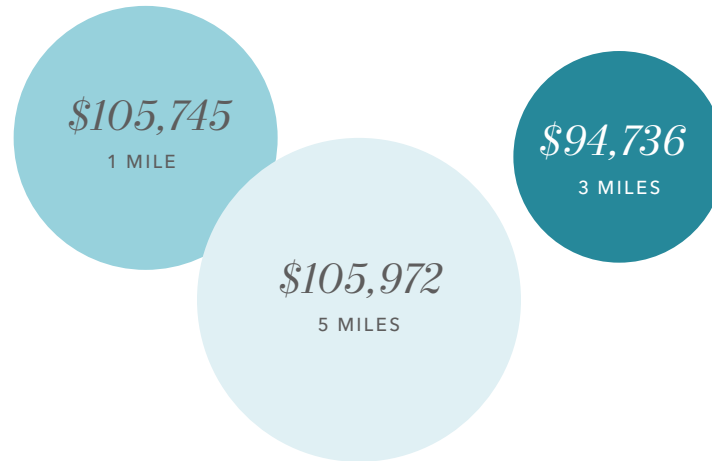

BLUE COLLAR

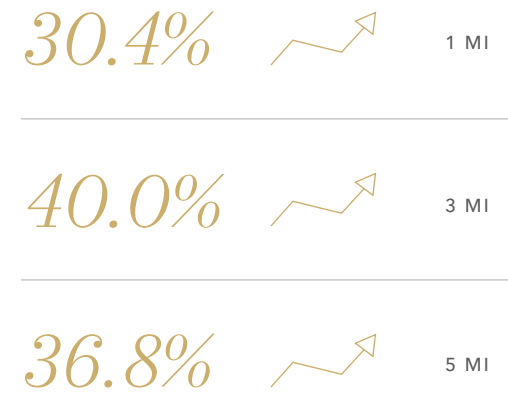

MEDIAN AGE

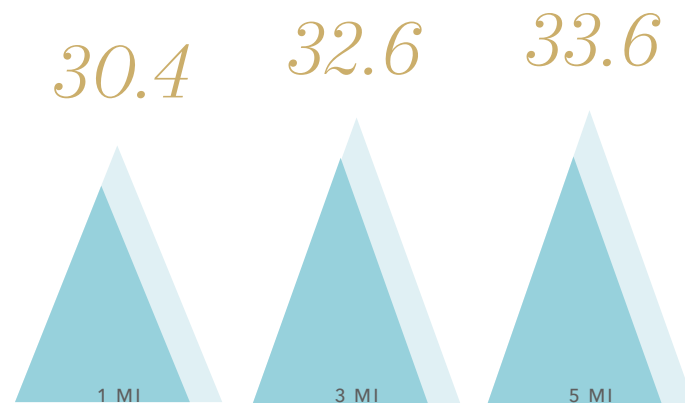

ESTIMATED EMPLOYEES

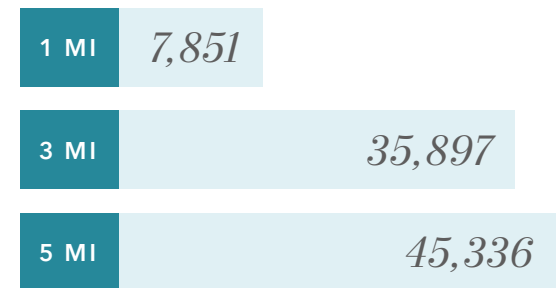

Data Source: ©2023, Sites USA

MAJOR LOCAL BUSINESSES INCLUDE:

Lifecore Biomedical

Agro-Jal Farms, Inc.

Boeing Co

Nutrien AG Solutions

United Healthcare

Primus Laboratories

Silvas Oil Co Inc

Coca-Cola Bottling Company

Pepsi Beverages Co

Quintron Systems Inc

Golden State Water

Gibbs Truck Center

Zodiac Aerospace

American Ethanol Inc

Adaptive Concepts Inc

Space Information Labs



DRIVE TIME MAP

15 MIN DRIVE



30 MIN DRIVE



60 MIN DRIVE



	ACCESS TO POPULATION
15 Min	154,000
30 Min	1,361,000
60 Min	4,967,000



LOCATION OVERVIEW

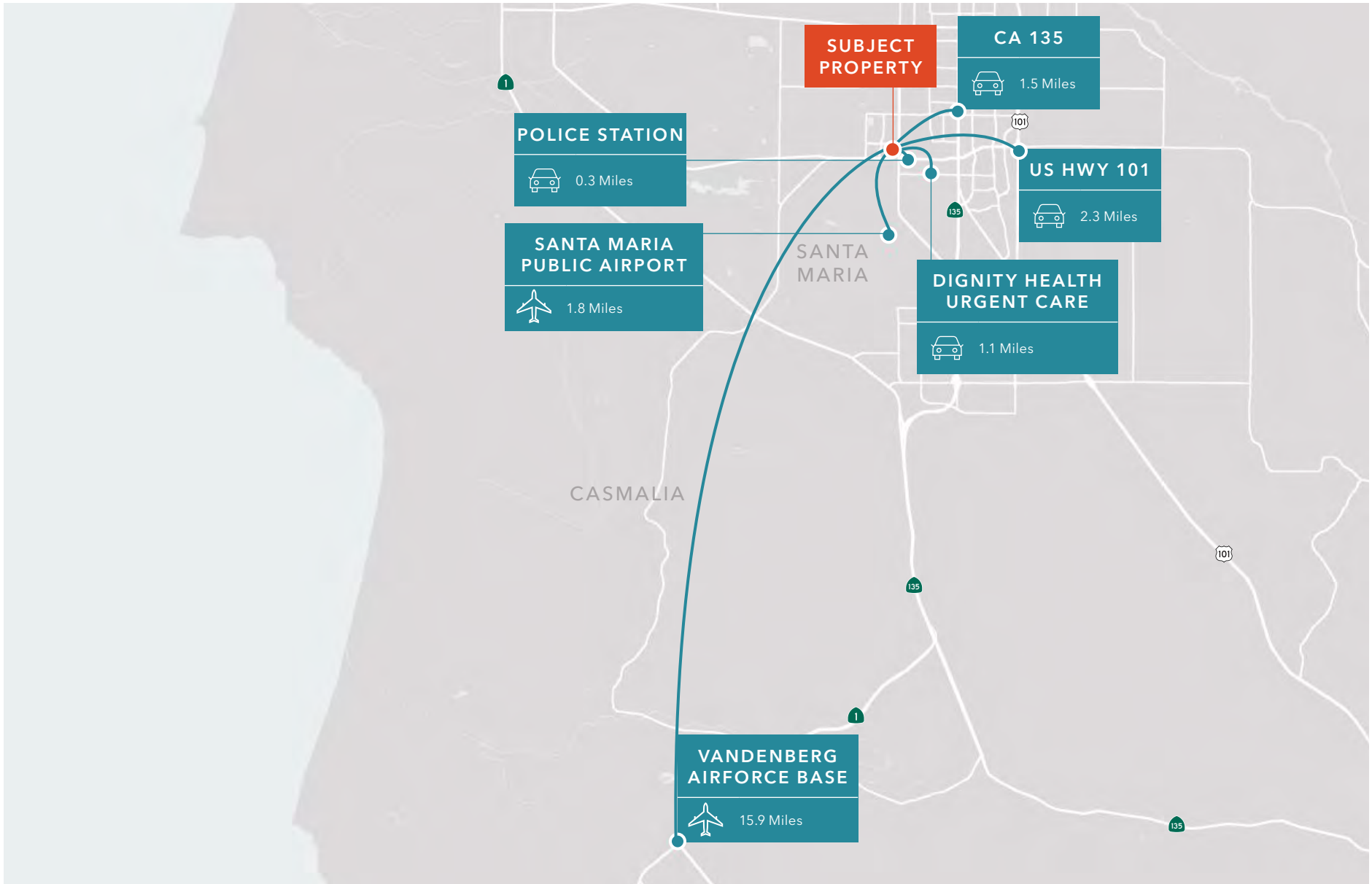

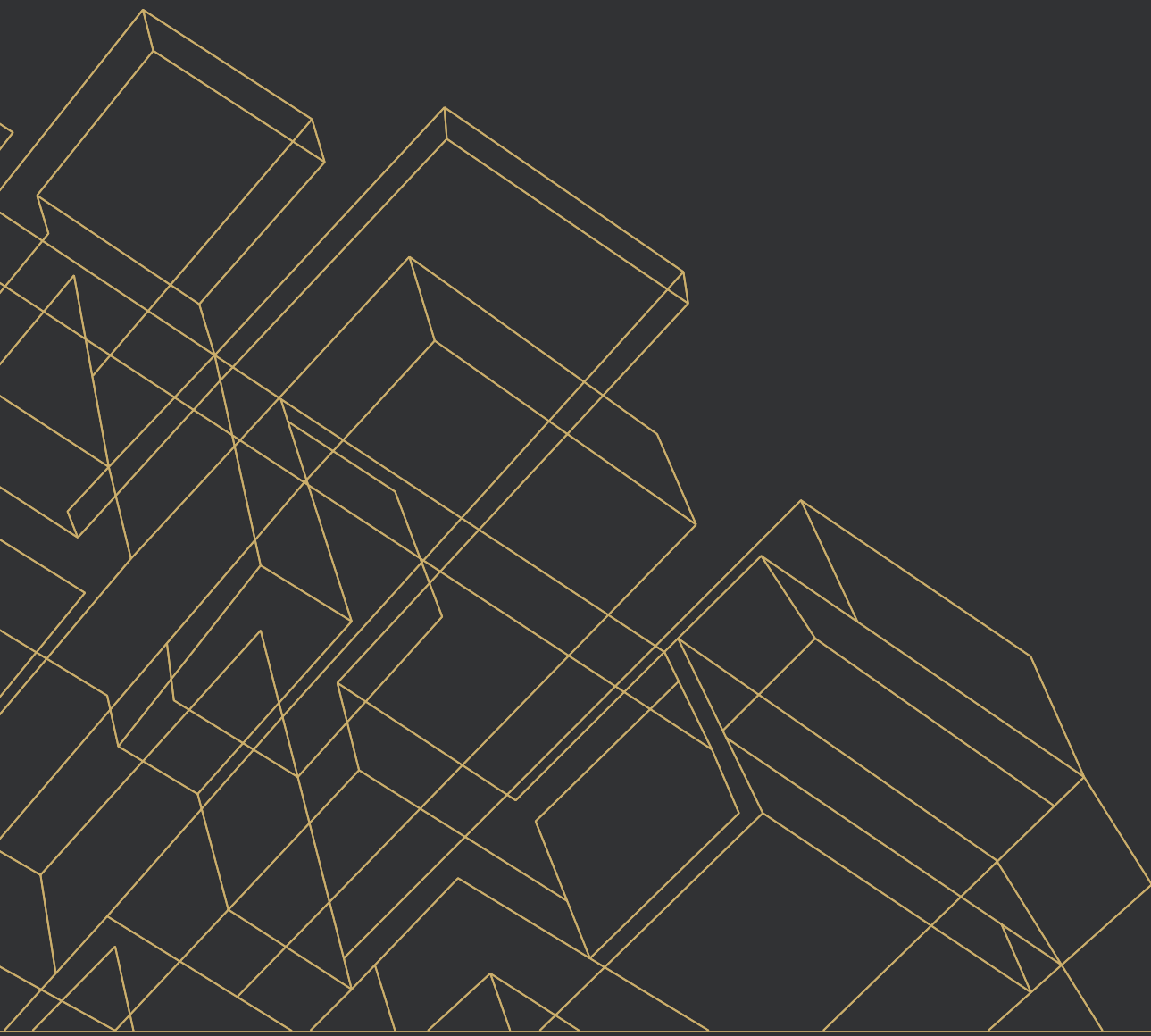

PROPERTY PHOTOS



PROPERTY PHOTOS



KIDDER MATHEWS



OFFERING MEMORANDUM • 2105 S BLOSSER RD 18

PROPERTY PHOTOS



PROPERTY PHOTOS



PROPERTY PHOTOS



PROPERTY PHOTOS



Exclusively listed by

BENTLEY MCKEAN, CCIM
Kidder Mathews
805.626.7120
bentley.mckean@kidder.com
LIC N° 02080641

JEFFREY M. CROCKER
Kidder Mathews
805.626.6550
jeffrey.crocker@kidder.com
LIC N° 01457097



KIDDER.COM

ABEL CONTRERAS
InvestSLO
805.295.2719
abel@investslo.com
LIC N° 02062620



INVESTSLOW.COM

