

# FOR LEASE

# 20969 VENTURA BLVD

20969 VENTURA BLVD. WOODLAND HILLS CA 91364





23  
La Belle Vie  
MedSpa

Head Extern  
wellness



# AVAILABLE SPACES- FIRST FLOOR

SPACE	RSF	USE	RATE	NNNs
<b>SUITE 5</b>	± 881 RSF	RETAIL	\$4/SF + NNNs	\$1/SF
<b>*SUITE 11</b> <small>*Can be combined with Suite 21</small>	± 692 RSF	RETAIL	\$4/SF + NNNs	\$1/SF
<b>*SUITE 21</b> <small>*Can be combined with Suite 11</small>	± 782 RSF	RETAIL	\$4/SF + NNNs	\$1/SF
<b>SUITE 19</b>	± 750 RSF	RETAIL / MEDISPA	\$4/SF + NNNs	\$1/SF
<b>SUITE 26</b>	± 766 RSF	RETAIL / FOOD / FITNESS	\$4/SF + NNNs	\$1/SF
<b>SUITE 101</b>	± 1,301 RSF	CAFE / BAR / RETAIL	\$4.50/SF + NNNs	\$1/SF

# AVAILABLE SPACES- SECOND FLOOR

SPACE	RSF	USE	RATE (MODIFIED GROSS)	MONTHLY RATE
<b>SUITE 209</b> <small>*Can be combined with Suite 211</small>	± 1,136 RSF	OFFICE	\$2.85	\$3,237.60
<b>SUITE 211</b> <small>*Can be combined with Suite 209</small>	± 974 RSF	OFFICE	\$3.00	\$2,922.00
<b>SUITE 215</b>	± 1,310 RSF	OFFICE	\$2.85	\$3,733.50
<b>SUITE 224</b>	± 755 RSF	OFFICE	\$3.00	\$2,265.00
<b>SUITE 230</b>	± 1,265 RSF	OFFICE	\$2.85	\$3,605.25

# Ground Floor

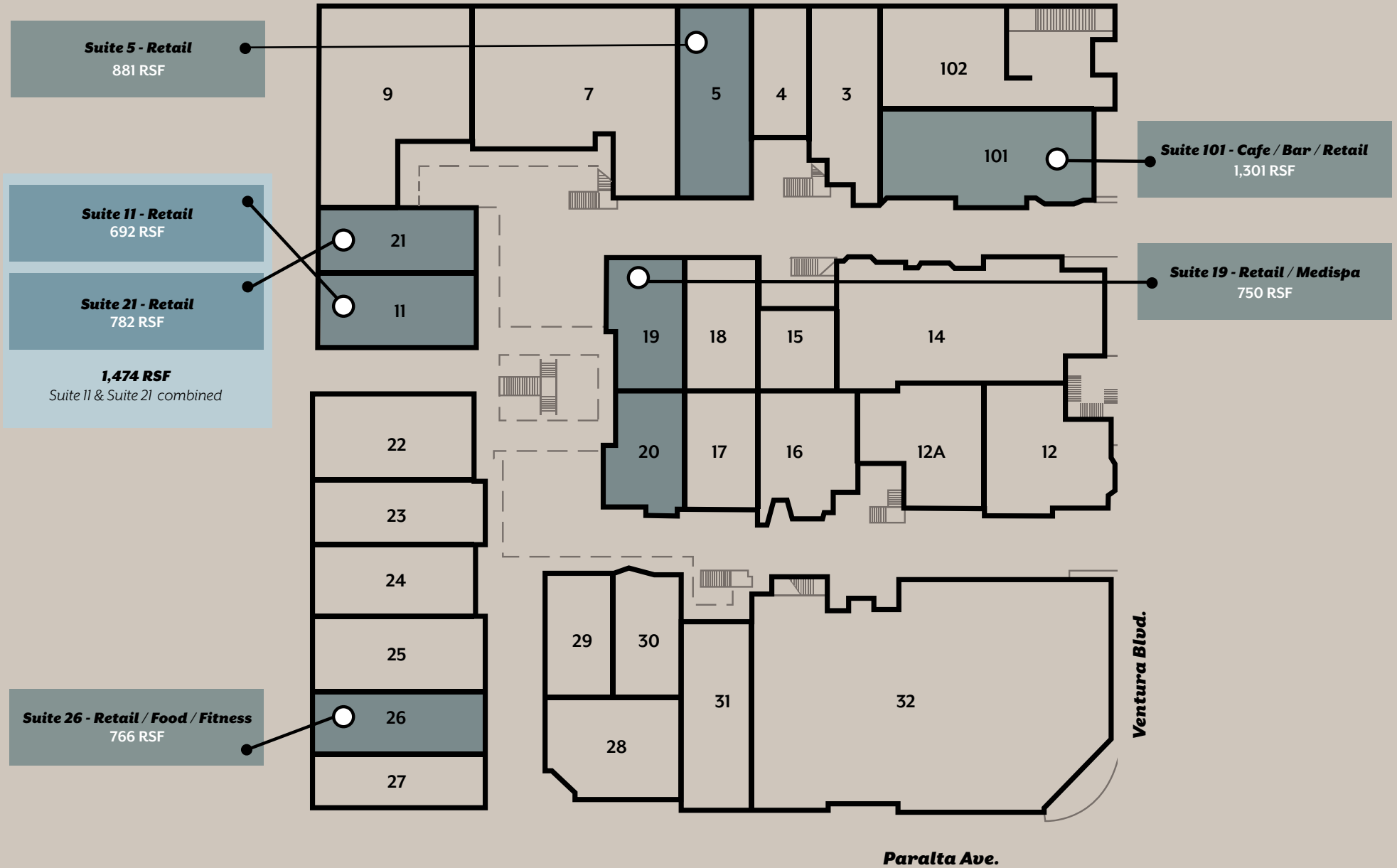

# Second Floor

## OFFICE SPACES



# Exterior Photos

---



# Interior Photos

---



# Interior Photos



# Map Overview



THE BROTHERS SUSHI

MARU RAMEN

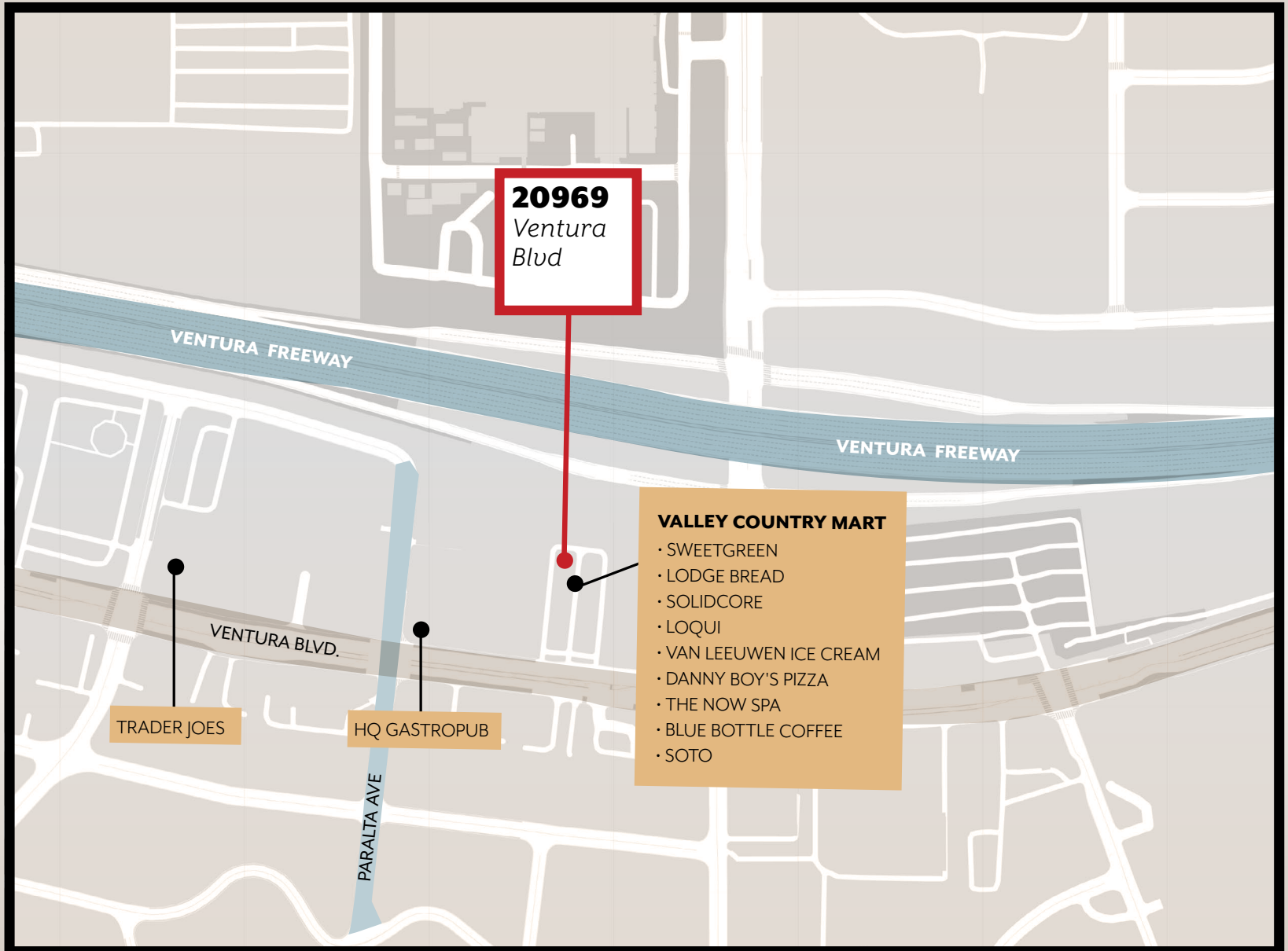



# Neighboring Tenants

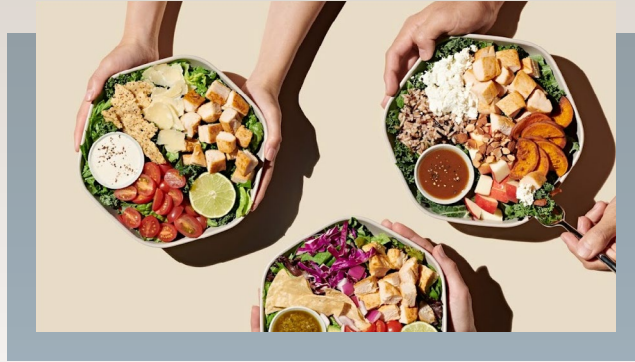

*Sweetgreen*

Sweetgreen is a fast-casual restaurant chain known for its healthy, plant-forward, and customizable salads and warm bowls, emphasizing sustainability, local sourcing, and cooking from scratch with real ingredients, aiming to build healthier communities through transparent food systems and innovative practices - Sweetgreen



*Solidcore*

[solidcore] is a high-intensity, low-impact strength training workout on a custom-built reformer machine. It utilizes slow, controlled movements to push your muscles to the point of failure in order to build back stronger - Classpass



*Blue Bottle Coffee*

Blue Bottle Coffee is a premier specialty coffee brand and a benchmark for "third wave" coffee, characterized by its focus on quality, craftsmanship, and minimalist design.-Blue Bottle Coffee



*Loqui*

A popular, modern Mexican taqueria chain in the Los Angeles area known for its flavorful, ingredient-focused tacos on house-made tortillas, offering options like chicken, mushroom, and beef in a casual, contemporary setting, a beloved casual dining spot. -Loqui

# Neighboring Tenants



*Van Leeuwen Ice Cream*

Van Leeuwen Ice Cream is a popular artisanal brand known for its rich, French-style dairy ice cream (made with lots of egg yolks and high butterfat) and a popular line of vegan ice creams, using simple, high-quality ingredients. - Google



*Trader Joes*

Trader Joe's is known for its fun, quirky, and affordable grocery experience, offering unique private-label products. - Google



*Bunda*

Bunda is a lower body focus workout studio that integrates half stair master and half strength training. - Bunda



*The Now Spa*

A popular, design-focused massage boutique chain offering customizable, high-quality Swedish-inspired massages and unique enhancements in a relaxing, nature-inspired setting, aiming to make self-care accessible with a modern, elevated experience, memberships, and branded products. - Google



*Lodge Bread*

A popular Los Angeles artisanal bakery known for its naturally leavened, whole-grain sourdough breads, pastries, and Mediterranean-influenced breakfast/lunch dishes like shakshuka. They emphasize local grains, slow fermentation, and community, serving high-quality, rustic breads and items like croissant sandwiches, with a strong focus on quality and a unique, soulful vibe. - Google



*HQ Gastropub*

A lively, music-themed gastropub known for its energetic atmosphere, extensive craft beer and cocktail selection, and diverse menu featuring burgers, sushi mashups, steaks, and comfort food, with a focus on good vibes, sports on TVs, and community involvement. - Google

# Contact Us



## **Steve Ravan**

TEL - 323-782-1262  
STEVERAVAN@SOUTHPARKGROUP.COM  
DRE LICENSE #01747222

## **Sasha Soofer**

TEL - 424-888-3695  
SASHA@SOUTHPARKGROUP.COM  
DRE LICENSE #02221169

## **Mane Ajaryan**

TEL - 818-523-4997  
MANE@SOUTHPARKGROUP.COM  
DRE LICENSE #02099173