

**FOR LEASE
STAND ALONE
OFFICE BUILDING**



131 S. Village Center Drive, Southlake, TX 76092



PROPERTY HIGHLIGHTS

- Move in Ready! Available Now
- Stand Alone Office Building in the Heart of Southlake
- Class "A" Office Finish Out
- Minutes from Restaurants, Retail and Southlake Town Square and City Hall



PROPERTY HIGHLIGHTS	
Address	131 S. Village Center Drive Southlake, TX 76092
Space For Lease	5,275 SF
Year Built	2017
Zoning	Commercial Office Zoning
Acreage Of Property	.74 Acres
Great Location	Convenient Access to Highway 114, SH26, SH121, & Southlake Blvd.
Rent Rate	\$26.00/SF plus NNN
Site Highlights	<ul style="list-style-type: none">• Move in Ready!• This beautifully-designed office spaces suit any size of team• Centrally Located Office Building in Prime Location• Easy Ingress/Egress to Major Roads
Excellent Demographics	Primed to serve Southlake affluent, rapidly growing community with households boasting an average income of \$176,385/year in 2 mile radius
Parking	Plenty Surface Parking Spaces

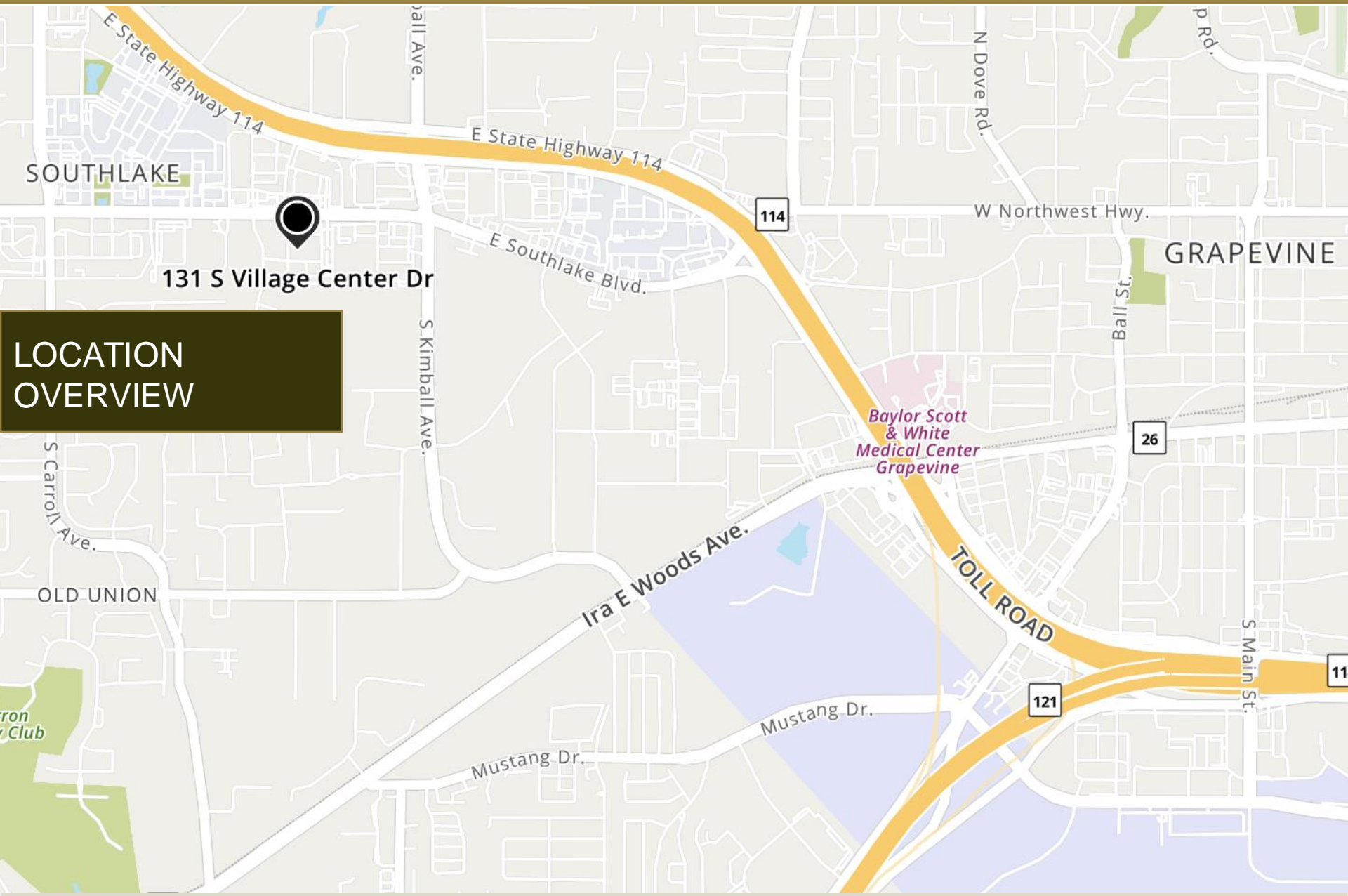

LOCATION OVERVIEW

FLOOR PLAN

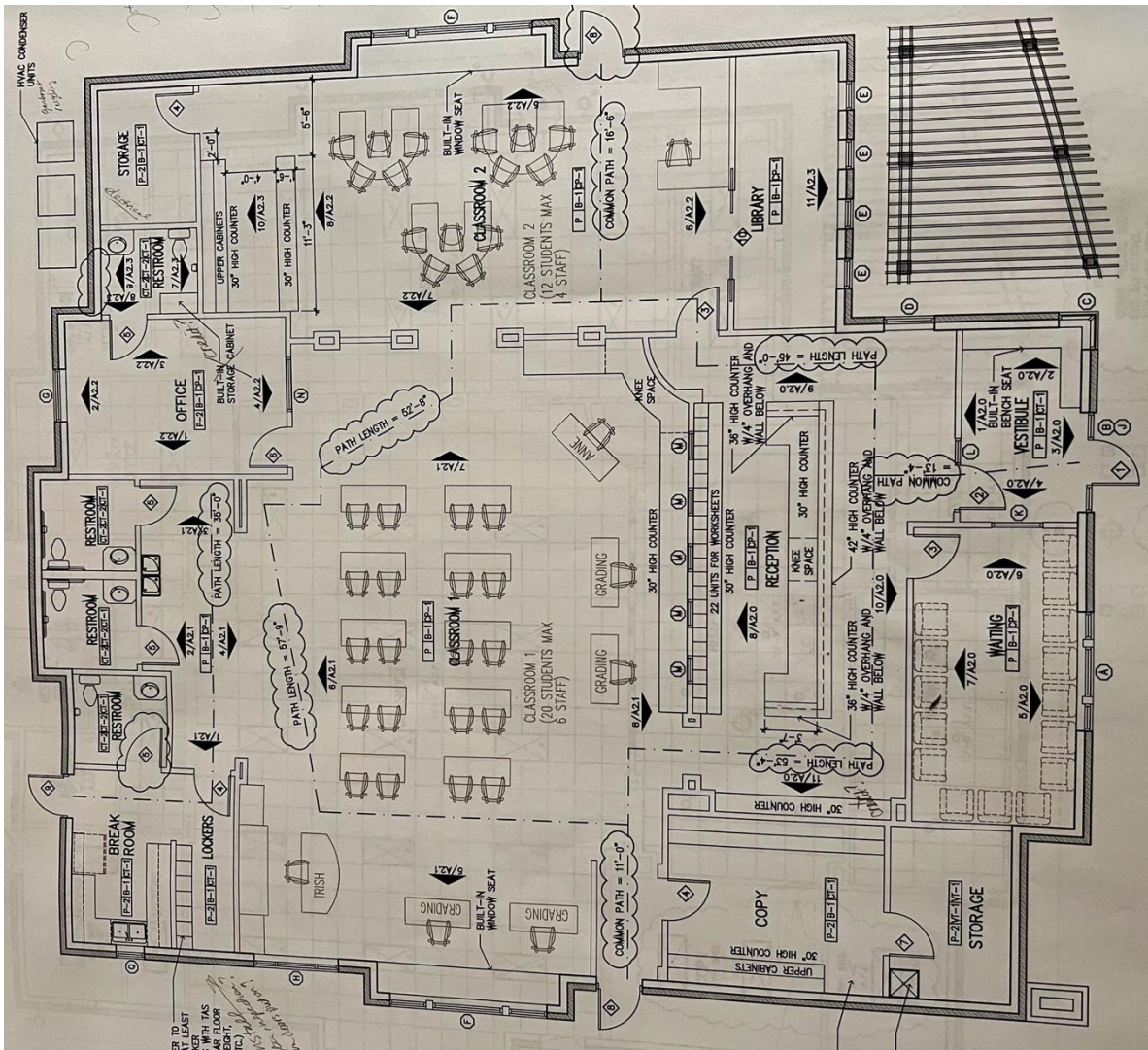



INTERIOR
PHOTOS



CONTACT INFORMATION



PAUL BLIGHT

Partner

C: 214.682.7192

O: 214.637.4300

pblight@glaciercommercial.com



STACEY YEARIAN

Vice President

C: 618.530.3550

O: 214.637.4300

yearian@glaciercommercial.com

131 S. Village Center Drive, Southlake, TX 76092
OFFICE FOR LEASE



glaciercommercial.com

©2024 Glacier Commercial Realty L.P.

All rights reserved. The information contained herein was obtained from sources believed to be reliable. It is subject to verification. The presentation of this property is submitted subject to errors, omissions, change of price or conditions, prior to sale or lease, or withdrawal without notice